

TIPS:

In order to keep the stand stable 2 screws must be installed on the 2 black marked holes this needs to be removed first.

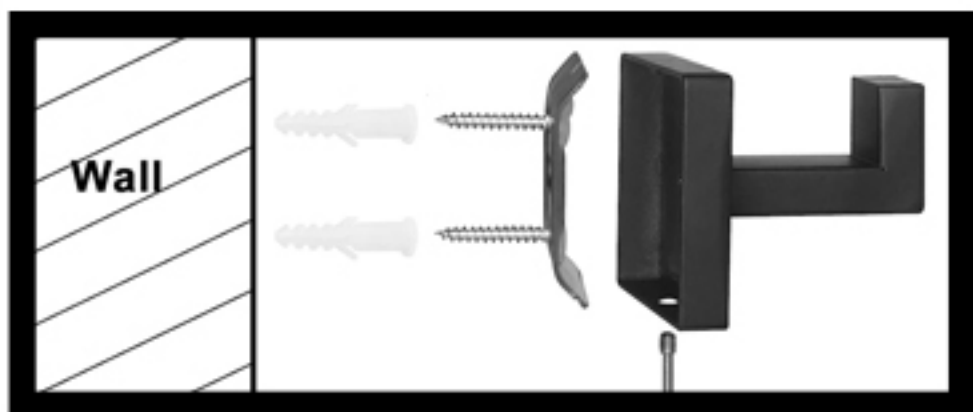

1 Determine the desired height and position and mark it.



2 Use the supplied to mark the location of the installation holes.



3 Drill screw mounting holes on the wall.



4 Using a hammer to hit the anchor into the holes.



5 Fix the gasket of the product on the wall with phillips screwdriver.

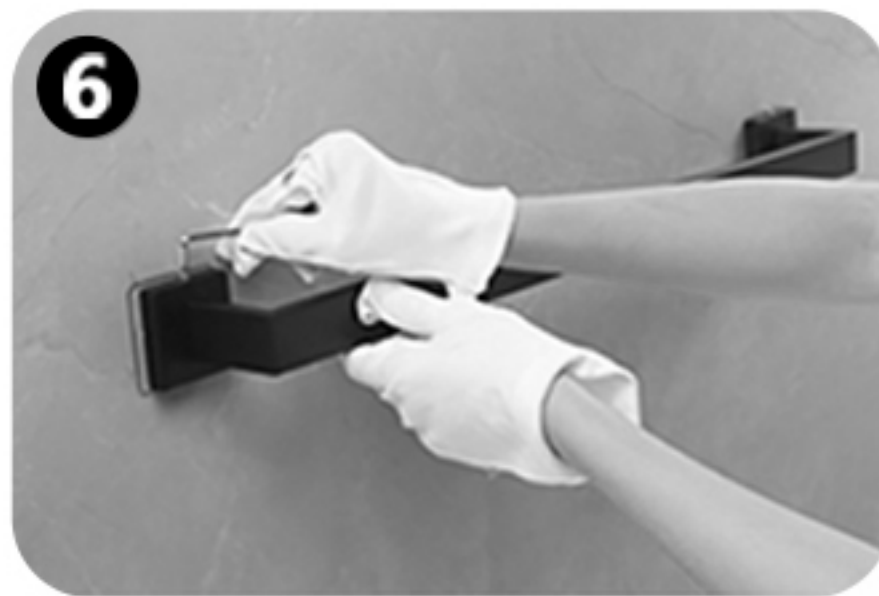

6 Using the "L" tool to install the other parts of the products.