

H. Troubleshooting:

Read this **BEFORE** you call for service.

Please review this easy to use "Troubleshooting Check List" for the most frequently encountered situations, which may not be the result of defective workmanship or materials.

PROBLEM	POSSIBLE CAUSE/SOLUTION
Microwave does not operate	House fuse has blown or circuit breaker has tripped. Check and/or replace fuse or reset circuit breaker.
	Microwave cord/plug not plugged properly into the control box. Make sure cord plug is plugged tightly into control box.
	Power box not plugged properly into power outlet.
	Power outage. Check house lights to be sure.

I. Service & Warranty:

Pioneering Technology Corp. warrants that the product is free from defects in materials and workmanship when operated and maintained according to the instructions provided for a period of one (1) year from date of purchase.

This warranty does not cover physical damage caused by improper installation, misuse, neglect or accident.

This warranty is VOID if this product has been altered or modified in any way.

For service under this warranty contact your Safe-T-sensor™ distributor or Pioneering Technology Corp. at:

Pioneering Technology Corp. Service Dept.

220 Britannia Rd. E
Mississauga, Ontario
Canada L4Z 1S6
Tel: 1 (800) 433-6026 ext 228 or (905) 712-2061 ext 228
Email: service@pioneeringtech.com
www.pioneeringtech.com

THERE ARE NO OTHER WARRANTIES. PIONEERING TECHNOLOGY CORP. DISCLAIMS ALL OTHER WARRANTIES, EITHER EXPRESSED OR IMPLIED. THIS WARRANTY GIVES YOU SPECIFIC LEGAL RIGHTS. YOU MAY HAVE OTHERS WHICH VARY FROM STATE TO STATE.

EXCEPT AS STATED HEREIN, IN NO EVENT SHALL PIONEERING TECHNOLOGY CORP. BE LIABLE FOR ANY DAMAGES WHATSOEVER WHETHER BASED ON CONTRACT, TORT, WARRANTY OR OTHER EQUITABLE GROUNDS, INCLUDING, WITHOUT LIMITATION, OR OTHER PECUNIARY LOSS, ARISING OUT OF THE USE OF OR INABILITY TO USE THIS PRODUCT, EVEN IF PIONEERING TECHNOLOGY CORP. HAS BEEN ADVISED OF THE POSSIBILITY OF SUCH DAMAGES. BECAUSE SOME STATES DO NOT ALLOW THE EXCLUSION OR LIMITATION OF LIABILITY FOR CONSEQUENTIAL OR INCIDENTAL DAMAGE, THE ABOVE LIMITATION MAY NOT APPLY TO YOU.

Pioneering Technology's entire liability and your exclusive remedy shall be at Pioneering Technology's option, either (a) return of the price paid for the product or (b) repair or replacement of the product that does not meet Pioneering Technology's Limited Warranty and which is returned to Pioneering Technology. In no event shall Pioneering Technology's liability exceed the purchase price of the product.

safe T sensor™

helps prevent microwave fires & false alarms

Installation Instructions and Care & Use Manual



* Disconnecting use only.

**NOT DESIGNED AS A REPLACEMENT FOR A SMOKE DETECTOR
IMPORTANT! READ ALL INSTRUCTIONS BEFORE INSTALLATION AND KEEP THIS
MANUAL NEAR THE Safe-T-sensor™ FOR FUTURE REFERENCE.
NOT FOR COMMERCIAL USE**

Microwave Cooking Safety Tips from the NFPA

- **Never leave cooking unattended.**
- Never leave cooking unattended.
- Read the manufacturer's instructions before using a microwave oven.
- Plug the oven directly into an outlet. Never use an extension cord because it may overload the circuit and cause a fire.
- Use only microwave-safe cookware (containers or dishes).
- Open microwave food slowly, away from the face. Hot steam escaping from a container or the food itself can cause burns.
- Never use aluminum foil or metal objects in a microwave oven.
- If you have a fire in your microwave, turn it off immediately and keep the door closed. Never open the door until the fire is completely out. Have the oven checked and/or serviced before being used again.

Note: National Fire Protection Association (NFPA) does not test, label or approve any products.

A. Introduction:

This product is designed to help prevent microwave oven fires & false alarms.

B. Features:

- Automatic shut-off - power to microwave interrupted (shut-off and reset) at first sign of smoke.
- Auto-reset - power is automatically restored after cooking process stopped.
- Easy to install & use - plug control box into outlet; plug microwave into control box; mount magnetic Sensor to microwave just above vent slots.
- No batteries required.

C. Power Rating/Product Type:

120VAC, 60Hz, 15Amps (maximum load)
Product Type: NM

This product is not recommended for use on:

1. Built-in microwaves unless the exhaust vents are exposed.
2. Microwaves with a manual dial-timer.

D. Components:

The Safe-T-sensor™ has two components:

- "Sensor" (smoke sensor) and
- "Control box" (power supply box)



E. Installation:

1. Plug the "Control box" into a grounded 120VAC receptacle, then plug in the microwave power cord into the "Control box".
2. Attach the "magnetized Sensor" to the microwave unit just above or beside the exhaust vent slots. The Sensor has a built-in magnetic mounting.

IMPORTANT:

Microwave oven vents have been designed & slanted to expel smoke in a specific direction. It is important that the magnetized Sensor be positioned above or besides these exhaust vents to ensure that the expelled smoke to pass directly over/into the Sensor.

Refer to these sample images to correctly position the Sensor on the microwave.

A. Side vent Installation:

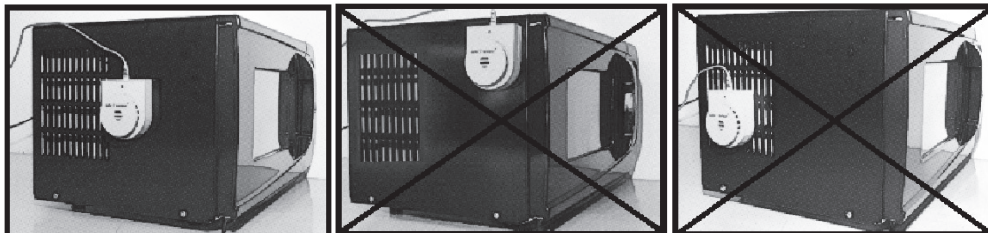

Warning! There are no serviceable parts inside Safe-T-sensor™. Do not open the Safe-T-sensor™.

Refer to Section: G "Care" for instructions on how to clean Sensor.

In some instances the microwave vents may be located underneath or at the back of the microwave (do not confuse the air-intake holes on the back as the exhaust vents). Again the Sensor should be positioned so that the expelled smoke will pass directly over/into the sensor.

1. Remove the Sensor cover.

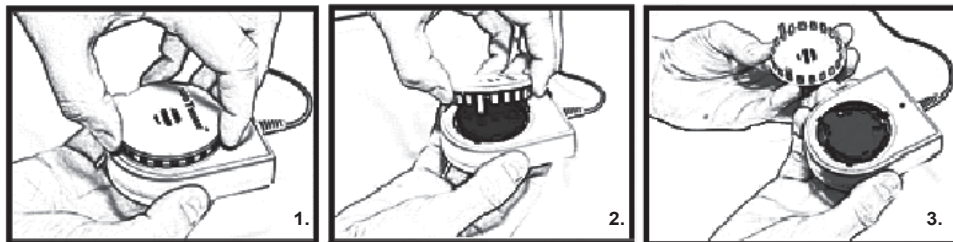

Safe-T-sensor™ should not be exposed to high humidity (80%) and ambient conditions exceeding 30 degrees C(90 degrees F) or occasionally exposed to water.

2. Place the Sensor underneath the microwave base where the exhaust vent slots are located.



B. Back or Underneath Installation

Please ensure that microwave is not sitting directly on top of the Safe-T-sensor™ to prevent possible damage.

G. Care

THE Safe-T-sensor™ must be tested periodically to ensure proper operation and optimum performance.

Ensure that the red LED on the Sensor is lit, which indicates that it is receiving power.

Clean the Sensor module at least once a year for proper operation. Ensure the slots are free from any debris. The Sensor cover is removable for cleaning.

Steps to clean Safe-T-sensor™:

1. Unplug the microwave and Safe-T-sensor™ from the power outlet.
2. Gently remove the Sensor cover from the Sensor case. (Fig. 1 to 3)
3. Clean any dust or debris by using a tissue. (Fig. 4 to 5)
4. Place the Sensor cover back on the Sensor case so it clicks back into place. (Fig. 6 to 7)
5. Plug the microwave into Safe-T-sensor™ control box then, plug the control box back into the power outlet.
6. Position the Sensor near the microwave's exhaust vent.
7. For Sensor that is mounted underneath the microwave base, clean the Sensor as shown in Fig.4 above.

