

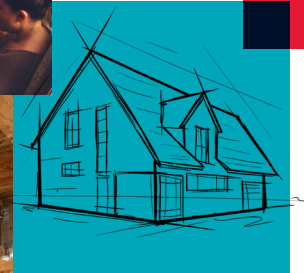

ROCKWOOL SAFE'n'SOUND®

Rock-Solid I-Joist Compliance

2012 IRC Section R 501.3 I-Joist compliance using ROCKWOOL stone wool for residential basement applications.



Code compliance with one simple solution.

As of November, 2014, local jurisdictions in Maine, Pennsylvania, Ohio, Delaware, Tennessee, Arkansas, California, D.C., Georgia, Kentucky, Louisiana, Maryland, Montana, Rhode Island, South Carolina, Utah, Virginia, Washington and Massachusetts have adopted the more stringent fire protection of I-Joist code. However, research firm Forest Economic Advisor projects about 60% of jurisdictions will do so by 2017.

SAFE'n'SOUND 6" for floor and ceiling applications is now available in 16" and 19.2" I-joist sizes as well as 16" and 24" dimensional lumber sizes.

SAFE'n'SOUND® Features & Benefits:

- Non-combustible stone wool insulation with melting point of approx. 2150 °F (1177 °C)
- Chemically inert
- Cuts easily
- Water and moisture resistant; does not absorb moisture to maintain insulating value
- Excellent sound absorbency
- Does not rot, promote mildew, fungi, or bacterial growth
- High density batts provide for better sound absorption at low frequencies
- CFC- and HCFC-free product and process
- Fire-resistant due to its high melting temperature
- Made from natural and recycled materials

Contact your ROCKWOOL Sales Representative today at 1-800-265-6878 for more details.

ROCKWOOL stone wool insulation installed between I-Joists is an excellent fire suppresser. It does not develop smoke or promote flame spread, even when directly exposed to fire up to 2150°F.

Mineral Wool Insulation

The following assembly was tested and approved to provide alternate fire resistance per the 2012 IRC, section R 501.3, exception 4. The system was tested per ICC Acceptance Criteria AC-14 section 4.4, following ASTM E119.

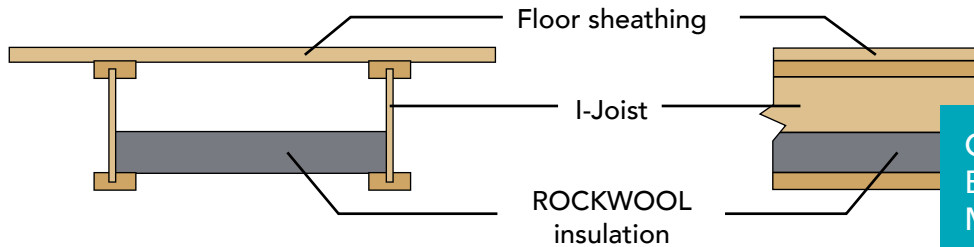

GLASS FIBER MAY NOT BE SUBSTITUTED FOR MINERAL WOOL.

Mineral wool requirements:

3" thick mineral wool insulation with a minimum density of 2.5 lbs/ft³. ROCKWOOL SAFE'n'SOUND® wood stud and steel stud meet the requirements and are approved for I-Joist Fire Protection.



Easy homeowner
DIY idea!
Get your basement
fire code ready in an
afternoon.

Installation Instructions:

1. Follow ROCKWOOL instructions on personal protection equipment.
2. Install batts between joist webs, on top of the bottom flanges. Use batt widths that correspond to joist spacing.
3. Install batts snug around any pipes located in the cavity.
4. Use rigid stay wires between bottom flanges, 24" on center and no more than 4" from ends of batts.

Publication date-edition: 06/2021



ROCKWOOL
8024 Esquesing Line
Milton, Ontario L9T 6W3
Tel: 1 800 265 6878
rockwool.com