

Installation Guide

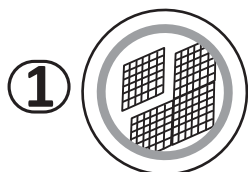

Your mosaic is a semi-artisanal product. Opening all the mosaic sheets, spreading them out and ensuring the compliance of a complaint after installation will unfortunately not be accepted.

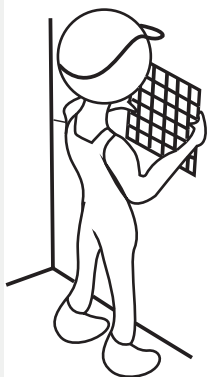

Ensure that the surfaces are dry, smooth and clean. For installation in a humid space (example: shower), a sealing solution must be applied beforehand. The wefts of the sheets can be cut using simple scissors.

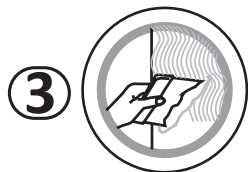

Glue the support with a white C2S or epoxy type tile adhesive (see manufacturer's instructions)

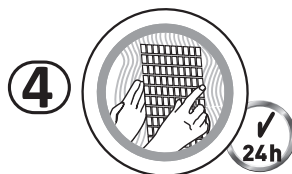

Position the sheets on the glued support, use a trowel or a bat for a flat and uniform laying. Use spacers to ensure even spacing between sheets. Respect the recommended drying time.



Grout with a thin sealant.



Clean the joints before complete drying with a slightly damp sponge.