



**72 inch Painted Steel
Roller Cabinet**

**Model:
RX723019RC-250
250 lbs. Slides**

Extreme Tools, Inc.
740 Frontenac Road
Naperville, Illinois 60563
630.369.9303
www.ExtremeTools.net

Roller Cabinet Parts List

RX723019RC-250

250 lbs. Slides

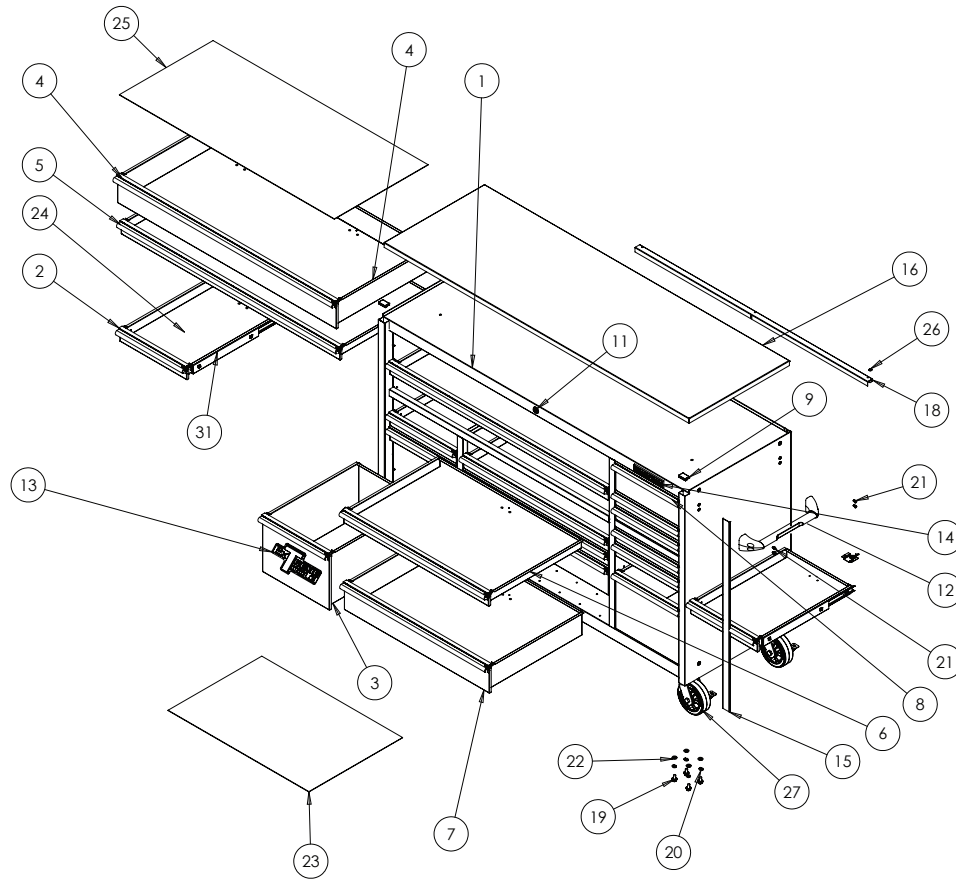

Replacement keys may be ordered using the code that appears on the face of the lock.

To order replacement parts, have the part number, tool box color and quantity ready.

If under warranty, the serial number is **REQUIRED** to get replacement parts.

Not all parts are available under warranty and may be purchased separately.

PARTS LIST - RX723019RC-250

ITEM NO.	PART NUMBER	DESCRIPTION	QTY.
1	RX7230-00	BODY WELDMENT	1
2	RXQDR-3A-250	DRAWER 3 ASSY	8
3	RXQDR-4A-250	DRAWER 4 ASSY	2
4	RXQDR-1A-250	DRAWER 1 ASSY	1
5	RXQDR-2A-250	DRAWER 2 ASSY	2
6	RXQDR-5A-250	DRAWER 5 ASSY	3
7	RXQDR-6A-250	DRAWER 6 ASSY	2
8	RXQDR-7A-250	DRAWER 7 ASSY	1
9	Z-ECRX	PLASTIC END CAP	2
10	Z-LBA7200	LB ASSY 7200RC	3
11	304005	SEE KEY CODE ON LOCK	1
12	Z-GW24	24" TUBULAR HANDLE	1
13	Z-LGL	EXTREME TOOLS LOGO	1
14	Z-LGS	EXTREME TOOLS NAMEPLATE	1
15	Z-TRF979	ALUM. VERTICAL TRIM - 979 MM	2
16	Z-WT7230	LAMINATE TOP	1
17	Z-KBRX7230-38	KEYBAR ASSEMBLY	1
18	Z-CNRX7225-10	CONNECTING BAR (72)	1
19	Z-BTM1020MM	M10 CASTER SCREWS	4
20	Z-WAM10S	SPLIT LOCK WASHERS	4
21	Z-M6-1.0-30	M6-1.0 X 30 SOCKET HEAD SCREW	4
22	Z-MS L ALLEN	MS "L" SHAPED ALLEN WRENCH	1
23	Z-DL55-7230M	5530/7230 DRWR LINER-MED	1
24	Z-DL55-7230S	5530/7230 DRWR LINER-SM	1
25	Z-DL55-7230L	5530/7230 DRWR LINER-LG	1
26	Z-PNM6	6mm PUSH NUT	3
27	Z-CA6SB(CRX)	6 X 2 Mag CASTER (S/B)	4
28	Z-M6-1CB	M6-1 CARRIAGE BOLT	3
29	Z-M6-1FN	M6-1 FLANGE NUT	3
30	Z-CA6R(CRX)	6 X 2 Mag CASTER (RIGID)	2
31	Z-SL723019R/L-250	BALL BEARING SLIDE- 26.2"	25

ASSEMBLY

Handle Installation

NOTE: Assemble the handle first to make it easier to move the tool cabinet.

Position the handle over the holes in the cabinet and attach with the provided (4) M6-1.0 x 30 socket head screws. Tighten securely.

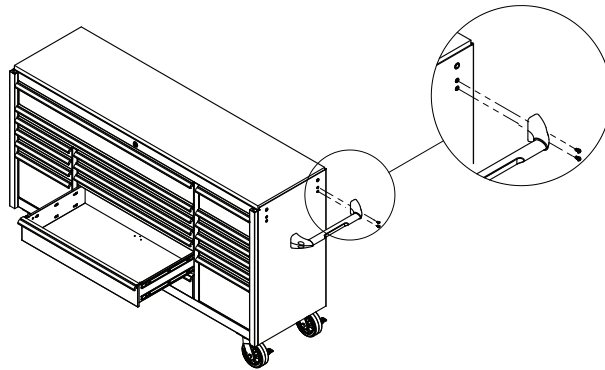

OPERATING PROCEDURE

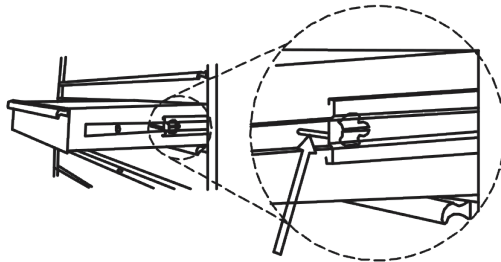

Drawer Removal

Pull drawer out so that it is almost fully extended.

Push up on the black lever on one drawer side and at the same time push down on the lever on the other side.

With the levers in these positions, pull the drawer out until it releases from the drawer slides.

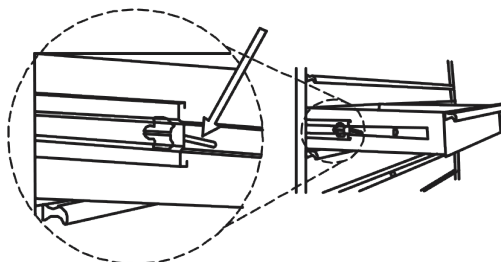

Drawer Replacement

Extend the drawer slides.

Careful align the brackets on the sides of the drawers with the slots of the cabinet slides. Insert the brackets on the side of each drawer into the slots of the cabinet slides.

Once properly inserted, completely close the drawer to set the slides into their properly functioning positions.

MAINTENANCE

Lubricate the casters once a year with high quality ball bearing grease.

Lubricate the slides twice a year with high quality, petroleum-based lubricant. This may be required more often if operating the tool box in colder climates.

Use mild detergent and water to clean drawer fronts, drawer trim and other surfaces.

Grease and oil can be removed with standard, non-abrasive, non-flammable cleaning products.

Auto wax will help preserve the unit's high gloss finish. Follow directions as provided.

SAFETY



WARNING

Do not attempt to lift the cabinet by its side handle using chains, ropes or lifting device. Side handle may fail resulting in personal injury or damage to the product!
Use a forklift or similar lifting device with forks placed under the bottom of the tool box to move if tool box cannot be moved by two people.

Close the drawers and lock the tool box before moving this product! If drawers are not locked they could open and make the product unstable and tip which may cause personal injury or damage to the product.

Do NOT stand on this product or lean on the drawer or work top.

Wear safety glasses when removing or repositioning the slides. The tool box could slip resulting in personal injury.

Do NOT mount this product on a truck bed or other moving object. This may cause personal injury or product damage. Mounting this product on any surface will void the warranty.

Do NOT tow with power equipment. The product could tip which may cause personal injury or product damage.

Do NOT alter this product in any manner or attach electrical equipment. This may cause personal injury or product damage and will void the warranty.

If using the combination top chest and roller cabinet, the top chest MUST be secured to the roller cabinet by following the directions provided. Not securing the top chest to the roller cabinet may cause the product to become unstable which may cause personal injury or damage to the product.



CAUTION - IMPORTANT PRODUCT INFORMATION

DRAWERS MUST BE CLOSED AND TOOL BOX LOCKED USING KEYS BEFORE MOVING!

The maximum weight for each drawer should not exceed 250 lbs. (113 kg) for single slides and 500 lbs. (226 kg) for drawers with double slides.
Maximum overall weight should not exceed 3,600 lbs. (1,632 kg.)

Use caution when closing the chest lid. Remove hands from the area before closing to prevent personal injury.

Do NOT pull this product. Push the product to prevent personal injury.

ENGAGE THE BRAKES when not moving this product. Locked casters prevent the product from rolling which may result in personal injury or damage to the product.

This product may become unstable and tip if more than one drawer is open at a time. To prevent personal injury or damage to product, OPEN ONLY ONE DRAWER AT A TIME.

Lock product and properly secure before moving with a forklift or other device.

Keep the product on a level surface. The product could become unstable and tip if stored or moved on an uneven surface which may result in personal injury or product damage.

Remove the work surface from the roller cabinet before installing top chest.