



UT1

Replacement Transformer

Instructions:

1. To Replace a Transformer with a Connector that is the same as on the New Transformer:

- Unplug the old transformer from the Power Outlet.
- Connect the new transformer onto the timer connector and then plug into a 110V AC wall outlet.

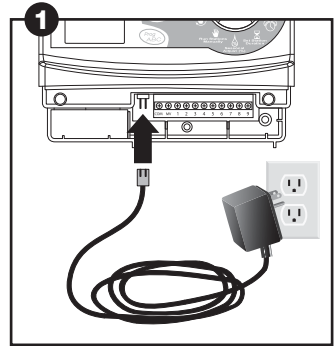

2. To Replace a Transformer without a Connector:

- Unplug the old transformer from the Power Outlet.
- Disconnect the wires from the old transformer of the timer.
- Cutoff the connector on the transformer by cutting the wire approximately 3 inches from the connector end. Strip the wire ends of the new transformer and connect the new transformer onto the same screw terminals to which the old transformer was connected (screw terminals may be labeled AC or 24VAC).

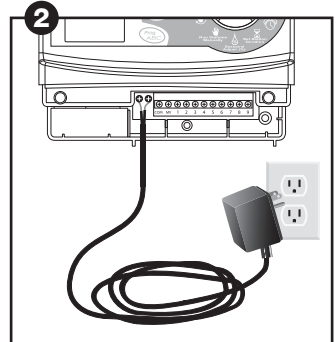

3. To Replace a Transformer with a Connector that is Different from the New Transformer:

- Unplug the old transformer from the Power Outlet.
- Cut the wires of the old transformer, about 3 inches from the connector and strip the wire ends (about 1/2 inch).
- On the new transformer, cut the connector off about 3 inches from the connector and strip the wire ends.
- Twist together the stripped wires of the old connector with the stripped wires of the new transformer and twist the wire nuts (included) onto the joined wires.

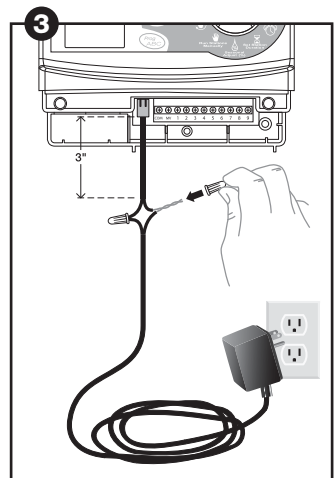

Rain Bird Corporation
Consumer Products Division
Customer Service Center
6991 E. Southpoint Rd. Bldg#1
Tucson, AZ 85706

