

Item # 1007 928 273  
Model # GFS60014A

# HAMPTON BAY®

## USE AND CARE GUIDE

---

### STEEL GAZEBO WITH HEAT TRANSFER FRAME

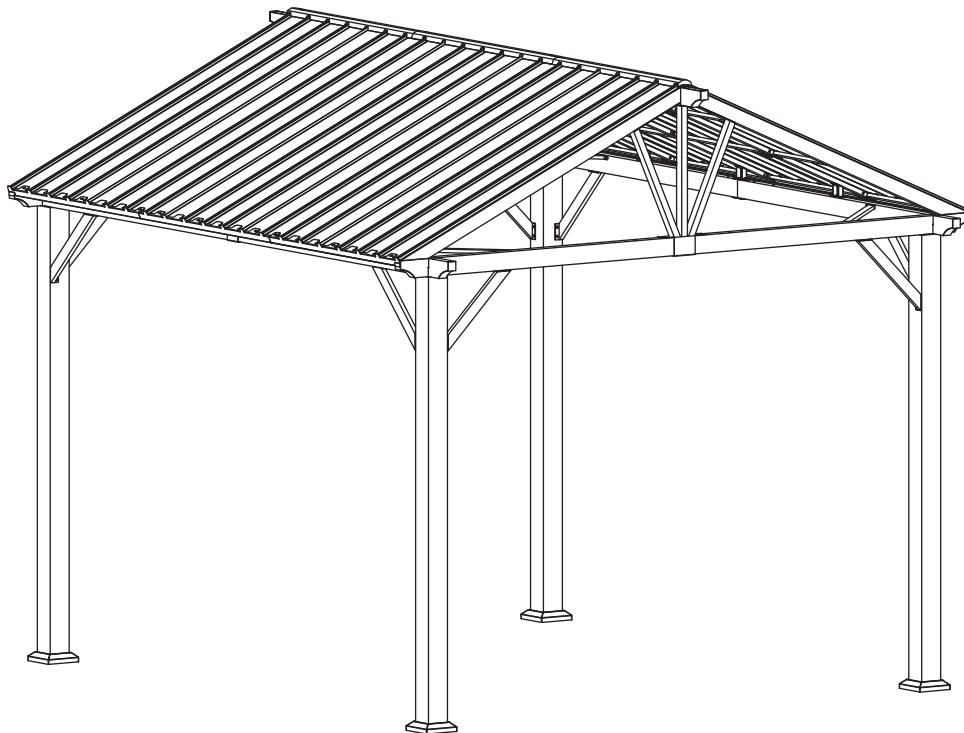

Questions, problems, missing parts? Before returning to the store,  
call Hampton Bay Customer Service  
8 a.m. - 7 p.m., EST, Monday – Friday, 9 a.m. – 6 p.m., EST, Saturday

**1-855-HD-HAMPTON**

**HAMPTONBAY.COM**

---

#### THANK YOU

*We appreciate the trust and confidence you have placed in Hampton Bay through the purchase of this gazebo. We strive to continually create quality products designed to enhance your home. Visit us online to see our full line of products available for your home improvement needs. Thank you for choosing Hampton Bay!*

# Table of Contents

Table of Contents . . . . .	2	Pre-Assembly . . . . .	3
Important Safety Instructions . . . . .	2	Planning Assembly . . . . .	3
Product Caution . . . . .	2	Hardware Included . . . . .	3
Safety Warnings . . . . .	2	Package Contents . . . . .	4
Warranty . . . . .	2	Assembly . . . . .	5
What is covered . . . . .	2	Care and Cleaning . . . . .	35
What is not covered . . . . .	2		

## Important Safety Instructions

### PRODUCT CAUTION

This gazebo was made for the explicit purpose of providing outdoor functions and is not to be used as a toy. This product is intended for normal outdoor use; however, the manufacturer recommends storing and / or covering this gazebo when any formidable / severe weather is approaching. Do not locate this product near open flames. Do not use this product as support. Do not shake, lean or climb on the product. Children under the age of 10, near the product, should be supervised by a competent adult at all times. This product is NOT intended for commercial use and will void the warranty.

### SAFETY WARNINGS



**WARNING:** Please keep children out of the assembly area before assembly.



**WARNING:** This gazebo unit is heavy, and may require two adults for safe assembly.



**WARNING:** Keep all flame and heat sources away from this gazebo fabric.



**WARNING:** The application of any foreign substance to the gazebo fabric may render the flame resistant properties ineffective.



**CAUTION :** Do not locate the product near any heat source.



**CAUTION:** When not in use, secure the product in a cool and covered location.

## Warranty

### 1 YEAR LIMITED WARRANTY

#### WHAT IS COVERED

We warrant the frame to be free of manufacturing defects to the original purchaser for one year.

#### WHAT IS NOT COVERED

It remains the customer's responsibility for freight and packaging charges to and from our service center. This warranty does not cover commercial use, hardware, acts of nature, fire, freezing and abusive use. In addition, purchased parts are not covered under this warranty. We reserve the right to make substitutions with similar merchandise, if the model in question is no longer in production.

Contact the Customer Service Team at 1-855-HD-HAMPTON or visit [www.HamptonBay.com](http://www.HamptonBay.com).

# Pre-Assembly

## PLANNING ASSEMBLY

Read all instructions before assembly.

To avoid damaging this product, assemble it on a soft, non-abrasive surface such as carpet or cardboard.



**NOTE:** More than one person may be required to assemble this product.

## HARDWARE INCLUDED



**NOTE:** Hardware not shown to actual size.

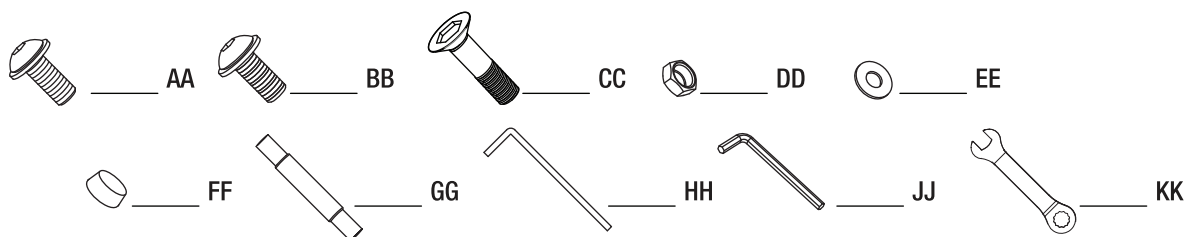

Part	Description	Quantity
AA	M6x15 Combination Bolt	170+5
BB	M6x10 Combination Bolt	12+1
CC	M6x20 Countersunk Bolt	8+1
DD	Nut	4+1
EE	Washer	4+1
FF	Nut Cap	4+1
GG	Stud	4+1
HH	Stake	8+1
JJ	Hex Wrench	1
KK	Wrench	1

# Pre-Assembly (continued)

## PACKAGE CONTENTS

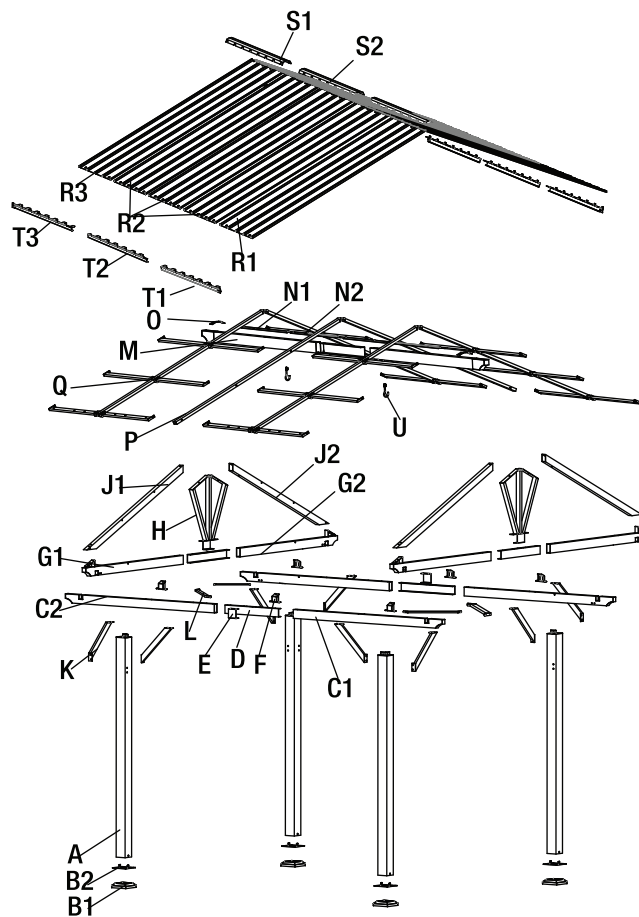

Part	Description	Quantity
A	Post Leg	4
B1	Foot Plate Cover	4
B2	Foot Plate	4
C1	Long Side Left Beam	2
C2	Long Side Right Beam	2
D	Lining Ring Beam	5
E	Beam Center Cover	2
F	Middle Inclined Beam Connector	6
G1	Short Side Left Beam	2
G2	Short Side Right Beam	2
H	Triangular Support Pipe	2
J1	Oblique Left Beam	2
J2	Oblique Right Beam	2
K	Corbel	8
L	Crossbeam Support Bracket	4
M	Top Beam	2
N1	Roof Panel Connector 1	2

Part	Description	Quantity
N2	Roof Panel Connector 2	2
O	Top Beam Plate	2
P	Corner Rafter	2
Q	Rafter Branch Assembly	4
R1	Roof Panel 1	2
R2	Roof Panel 2	6
R3	Roof Panel 3	2
S1	Top Cover 1	2
S2	Top Cover 2	1
T1	Edge Roof Cap 1	2
T2	Center Roof Edge Cap 2	2
T3	Edge Roof Cap 3	2
U	Chandelier Hook	2

# Assembly

## 1 Attaching the Foot Plate Covers and the Foot Plates to the Post Legs

- Insert the foot plate cover (B1) into the post leg (A) from the bottom.
- Attach the post leg (A) to the foot plate (B2) using M6x15 combination bolts (AA).
- Fully tighten the bolts using the hex wrench (JJ).
- Repeat this step for the other three post legs (A).

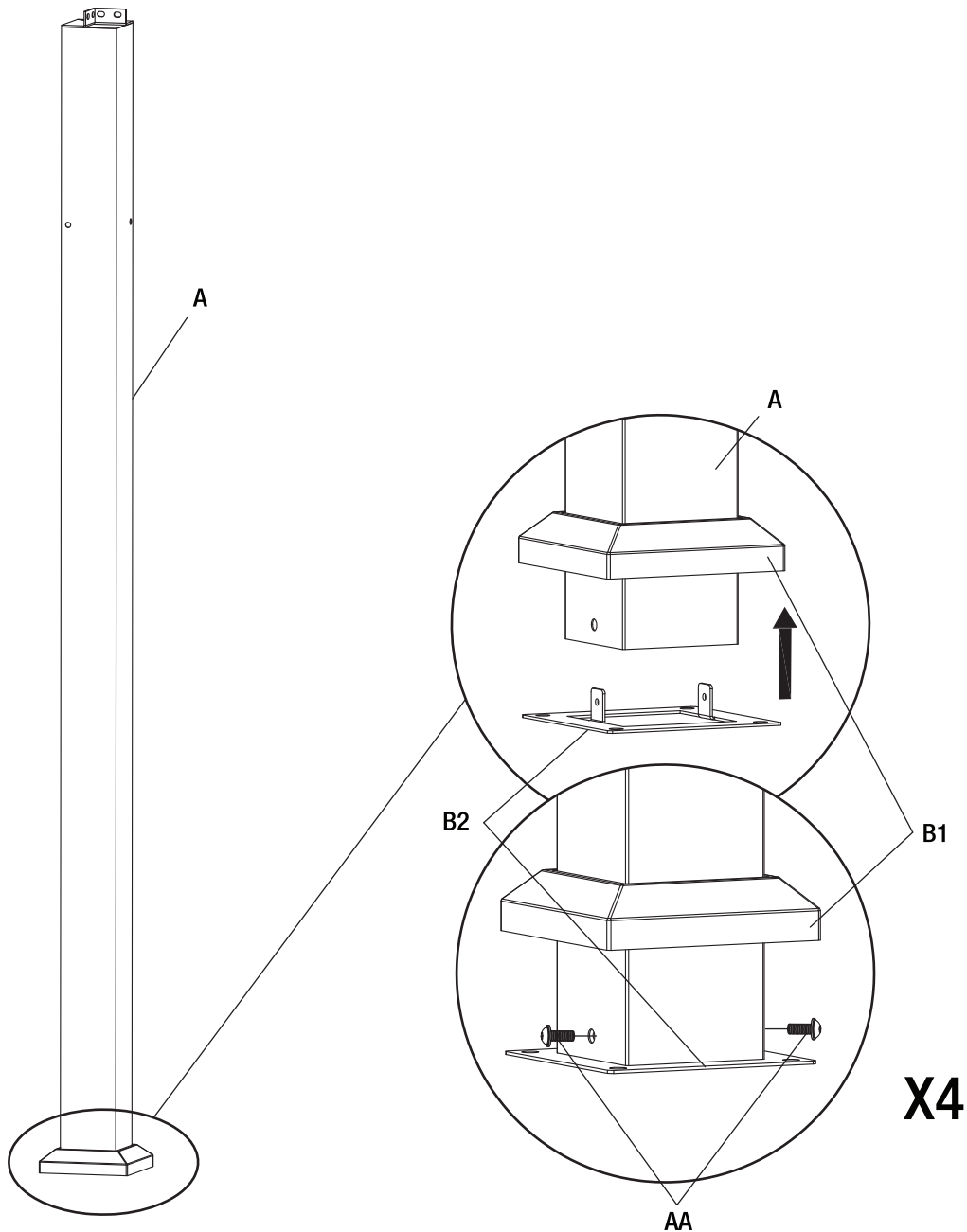

## Assembly (continued)

### 2 Inserting the Lining Ring Beam into the Long Side Left Beam and Long Side Right Beam

- Insert the lining ring beam (D) into the long side left beam (C1) and long side right beam (C2) using M6x15 combination bolts (AA).
- Fully tighten the bolts using the hex wrench (JJ).
- Repeat this step for the other long side left beam (C1) and long side right beam (C2).

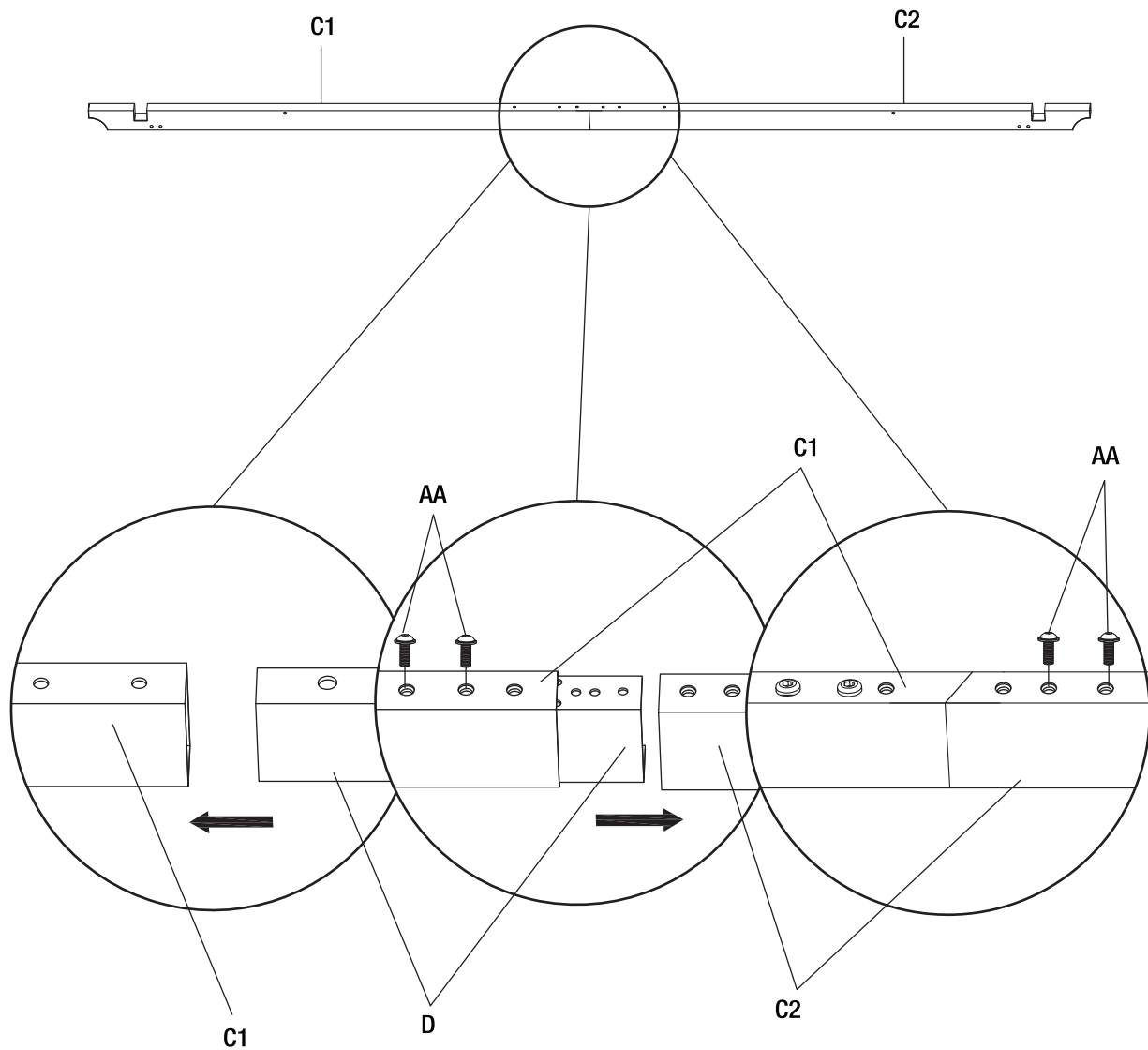

**X2**

## Assembly (continued)

### 3 Attaching the Beam Center Cover and the Middle Inclined Beam Connectors to the Assembled Long Side Beam

- Attach the beam center cover (E) to the middle of assembled long side beam (C1&C2), then attach the middle inclined beam connector (F) to the beam center cover (E), align the hole and secure with M6x15 combination bolts (AA) as shown below.
- Attach the middle inclined beam connector (F) to the long side left beam (C1) directly using M6x15 combination bolts (AA).
- Attach the middle inclined beam connector (F) to the long side right beam (C2) directly using M6x15 combination bolts (AA).
- Fully tighten the bolts using the hex wrench (JJ).
- Repeat above steps for the other assembled long side beam (C1&C2).

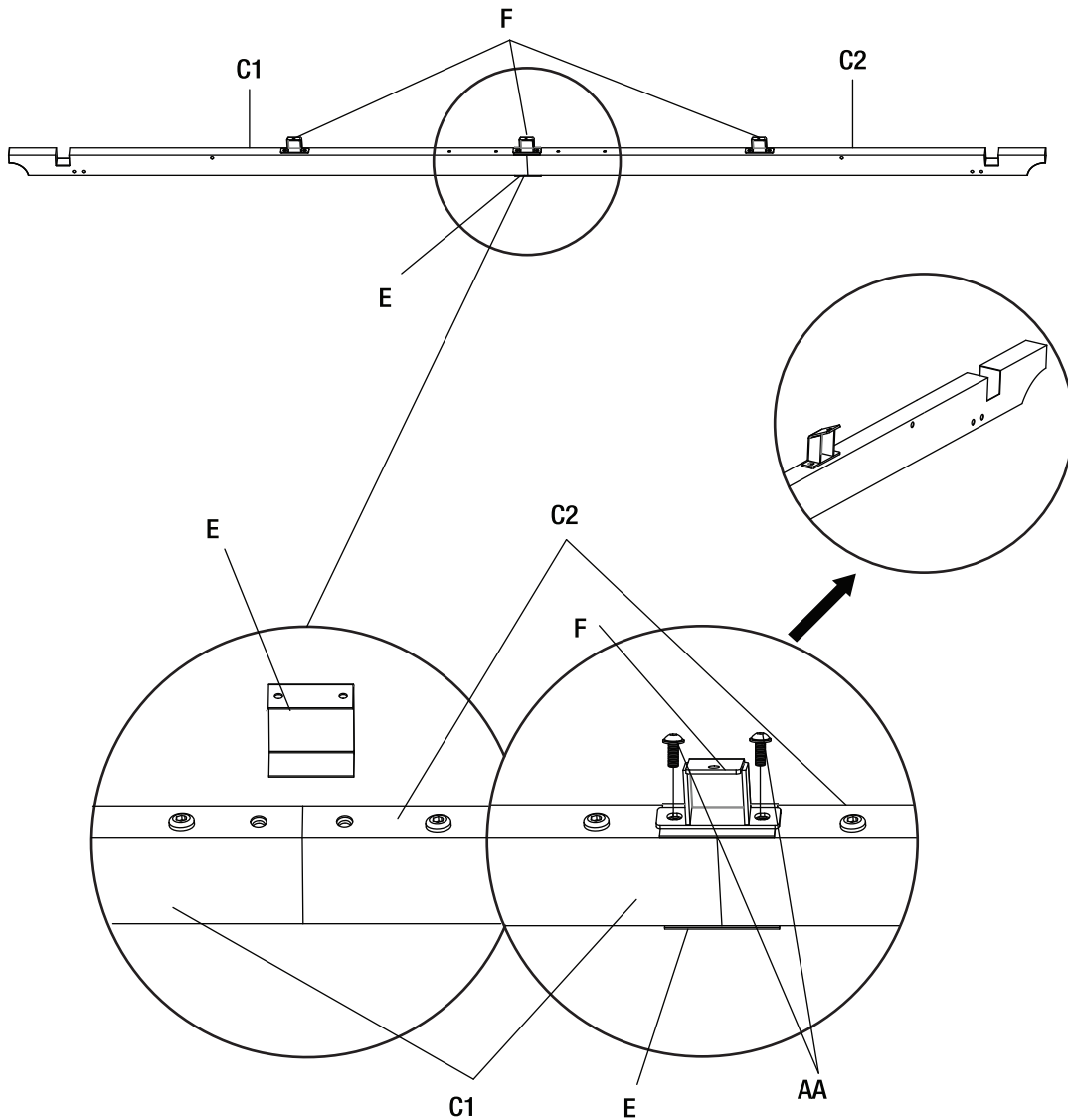

## Assembly (continued)

### 4 Attaching the Assembled Long Side Beam to the Post Legs

- Attach the assembled long side beam (C1&C2) to the two post legs (A) using M6x15 combination bolts (AA).
- Fully tighten the bolts using the hex wrench (JJ).
- Repeat this step for the other two post legs (A).

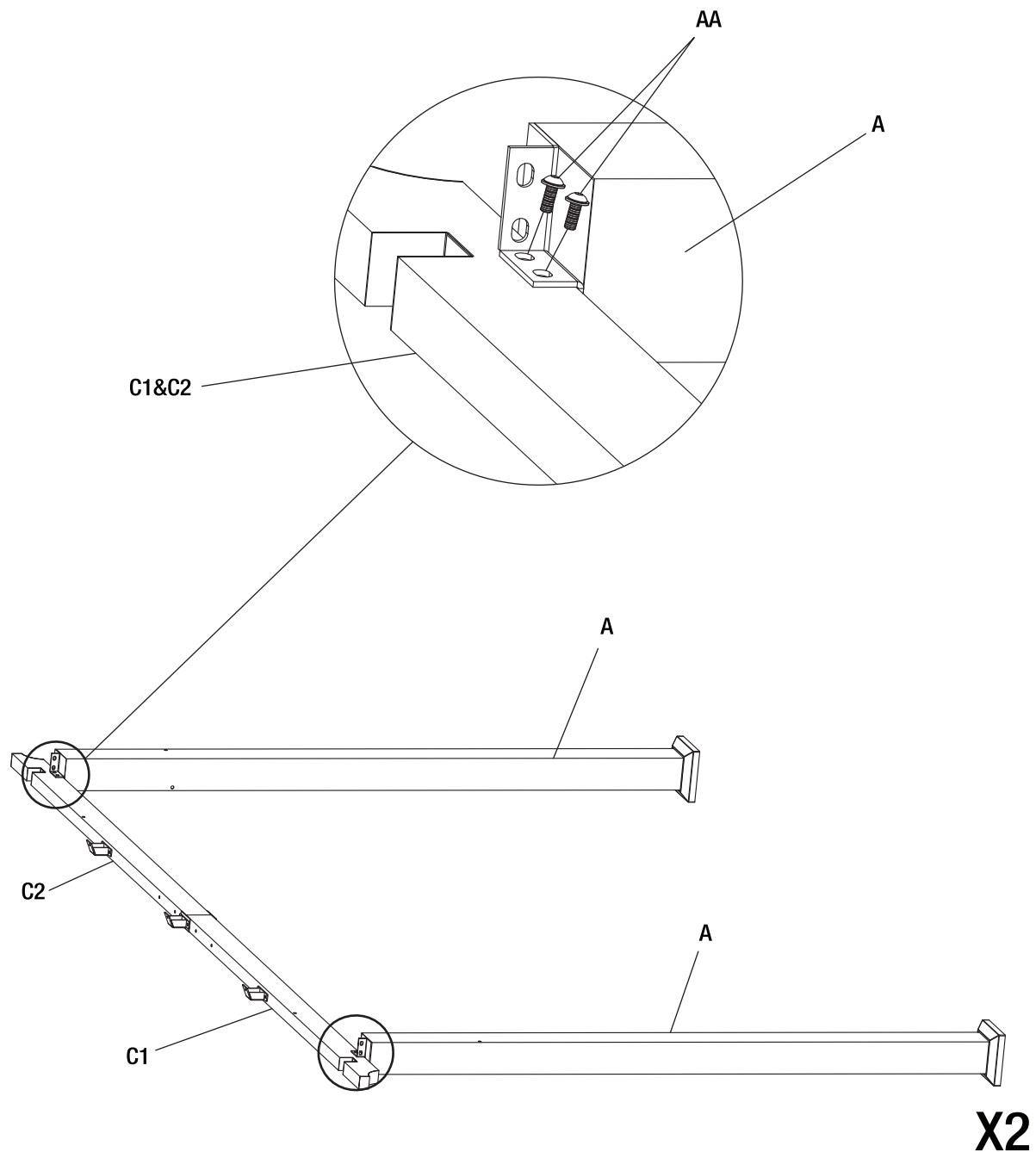



## Assembly (continued)

### 5 Inserting the Lining Ring Beam into the Short Side Left Beam and Short Side Right Beam

- Insert the lining ring beam (D) into the short side left beam (G1) and short side right beam (G2) using M6x15 combination bolts (AA).
- Fully tighten the bolts using the hex wrench (JJ).
- Repeat this step for the other short side left beam (G1) and short side right beam (G2).

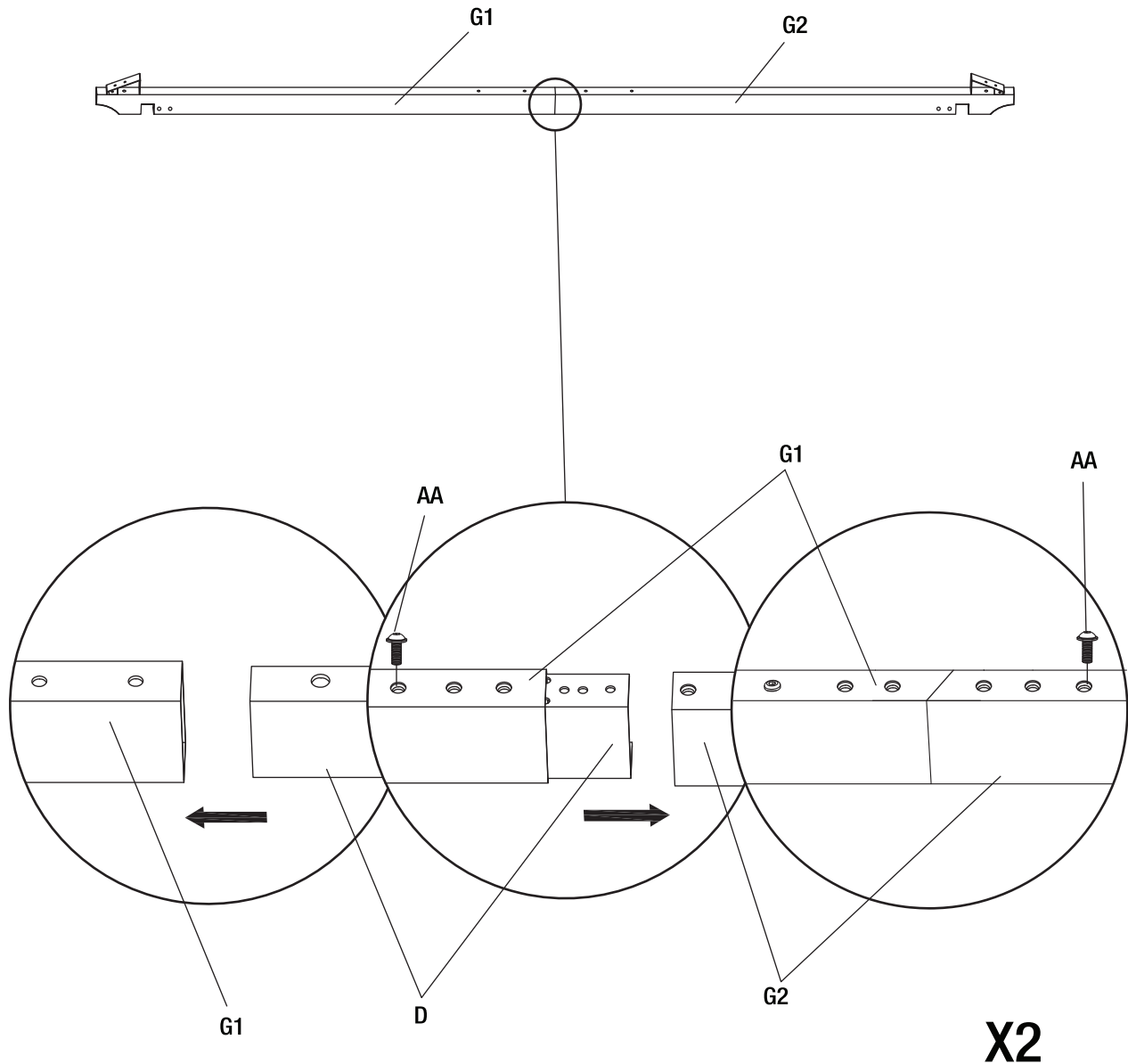

## Assembly (continued)

### 6 Attaching the Triangular Support Pipe to the Assembled Short Side Beam

- Attach the triangular support pipe (H) to the assembled short side beam (G1&G2) using M6x15 combination bolts (AA), as shown below.
- Fully tighten the bolts using the hex wrench (JJ).
- Repeat this step for the other triangular support pipe (H).



**NOTE:** The triangular support (H) should insert from the side of the assembled short side beam (G1&G2) without hole to the side with hole.

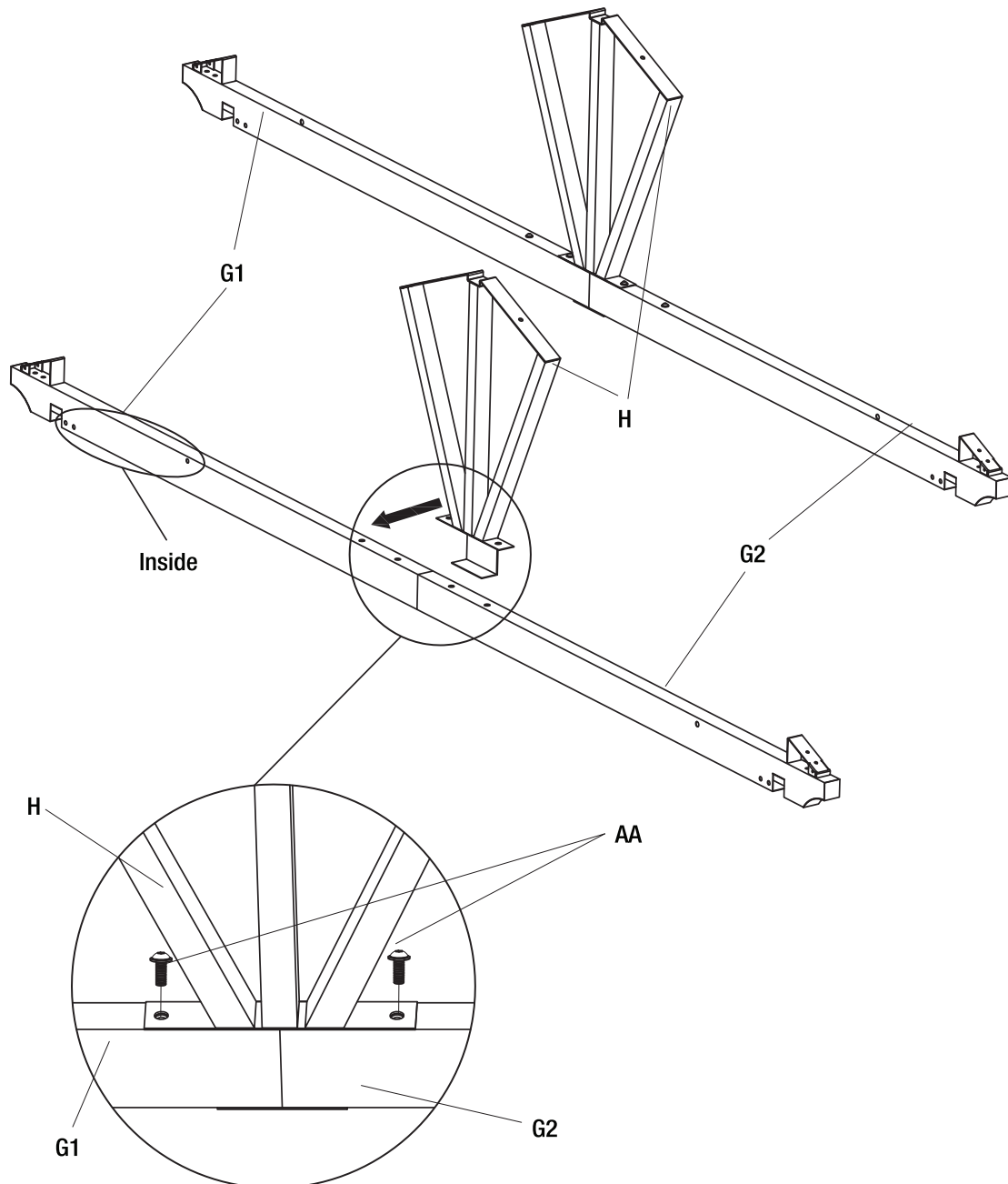

## Assembly (continued)

### 7 Attaching the Oblique Beams to the Assembled Short Side Beam and Triangular Support Pipe

- Attach the oblique left beam (J1) and the oblique right beam (J2) to the assembled short side beams (G1&G2) and triangular support pipe (H) using M6x15 combination bolts (AA).
- Fully tighten the bolts using the hex wrench (JJ).
- Repeat this step for another oblique left beam (J1) and the oblique right beam (J2).



**NOTE:** The front of the oblique beams (J1&J2) should be aligned with the front of short side beams (G1&G2).

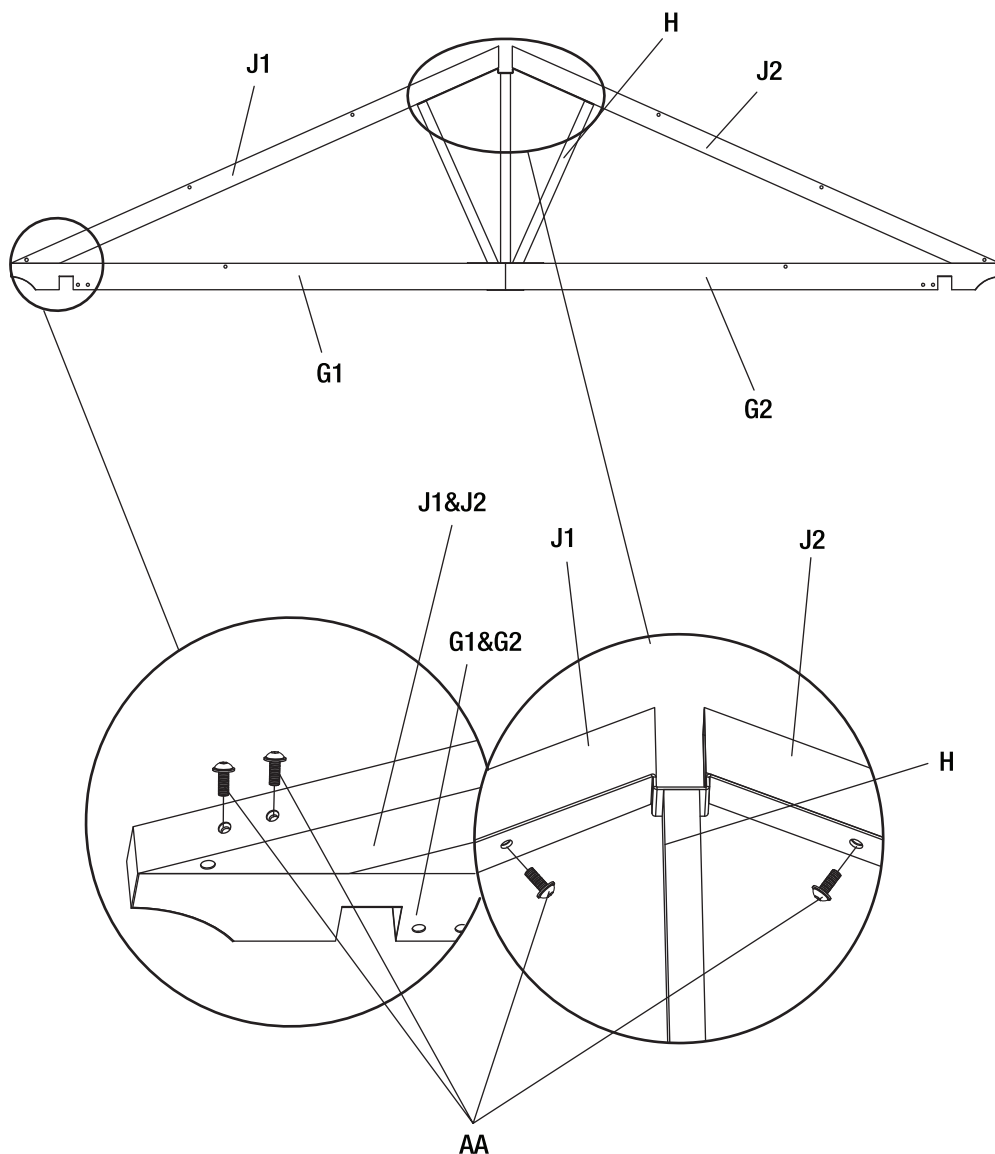

## Assembly (continued)

### 8 Connecting the Assembled Short Side Beams to the Assembled Long Side Beams and Post Legs

- Attach the assembled short side beams (G1&G2) to the assembled long side beams (C1&C2) using M6x15 combination bolts (AA), as shown below.
- Fully tighten the bolts using the hex wrench (JJ).

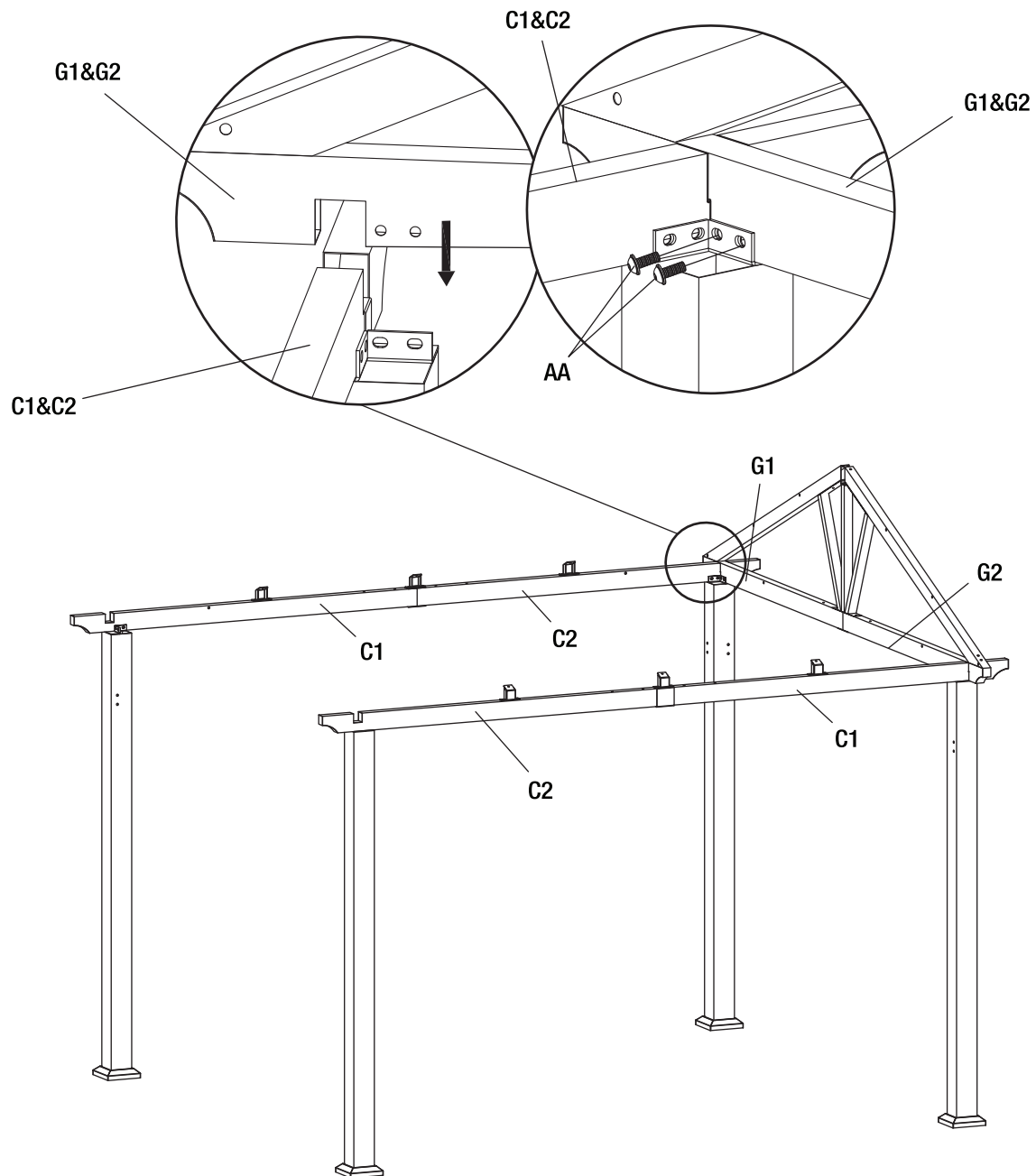

## Assembly (continued)

### 9 Connecting the Other Assembled Short Side Beams to the Assembled Long Side Beams and Post Legs

- Attach the other assembled short side beams (G1&G2) to the assembled long side beams (C1&C2) using M6x15 combination bolts (AA), as shown below.
- Fully tighten the bolts using the hex wrench (JJ).

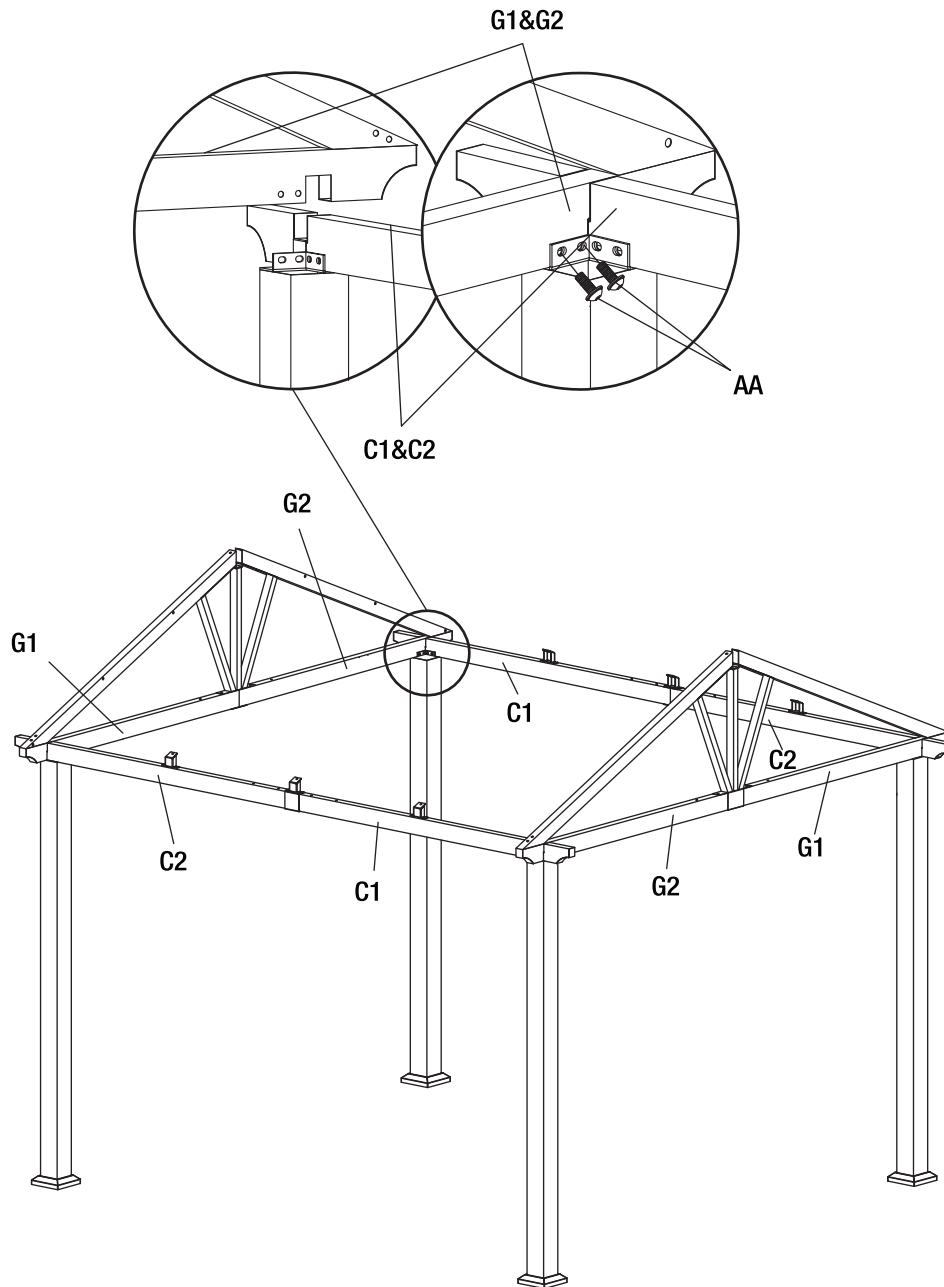

## Assembly (continued)

### 10 Attaching the Corbels to the Beams and the Post Legs

- Attach four corbels (K) to the assembled long side beams (C1&C2) and post legs (A) using M6x15 combination bolts (AA).
- Attach the other four corbels (K) to the assembled short side beams (G1&G2) and post legs (A) using M6x15 combination bolts (AA).
- Fully tighten the bolts using the hex wrench (JJ).

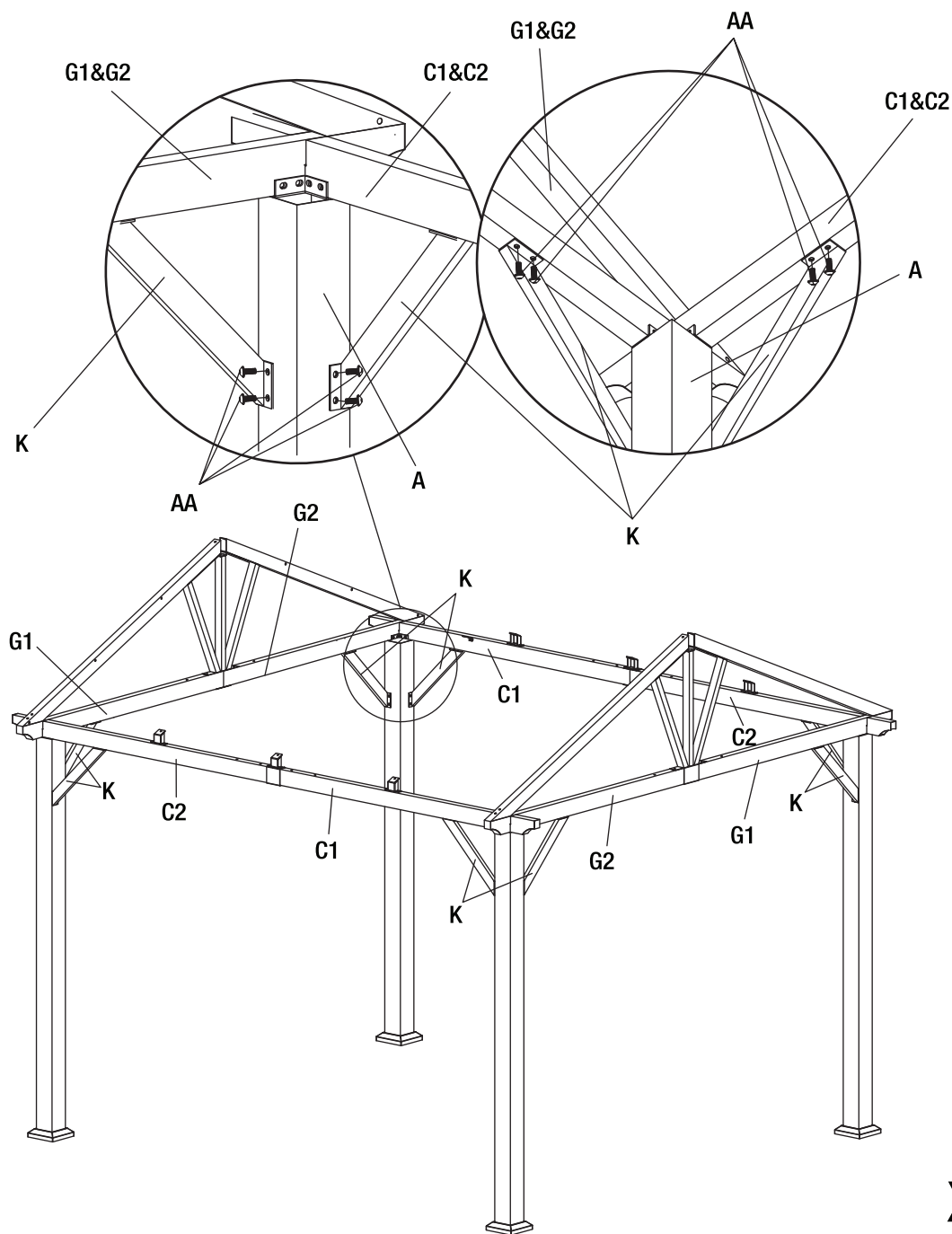

## Assembly (continued)

### 11 Attaching the Crossbeam Support Brackets to the Long Side Beams and the Short Side Beams

- Attach the crossbeam support brackets (L) to the assembled long side beam (C1&C2) and the short side beam (G1&G2) using M6x15 combination bolts (AA).
- Fully tighten the bolts using the hex wrench (JJ).

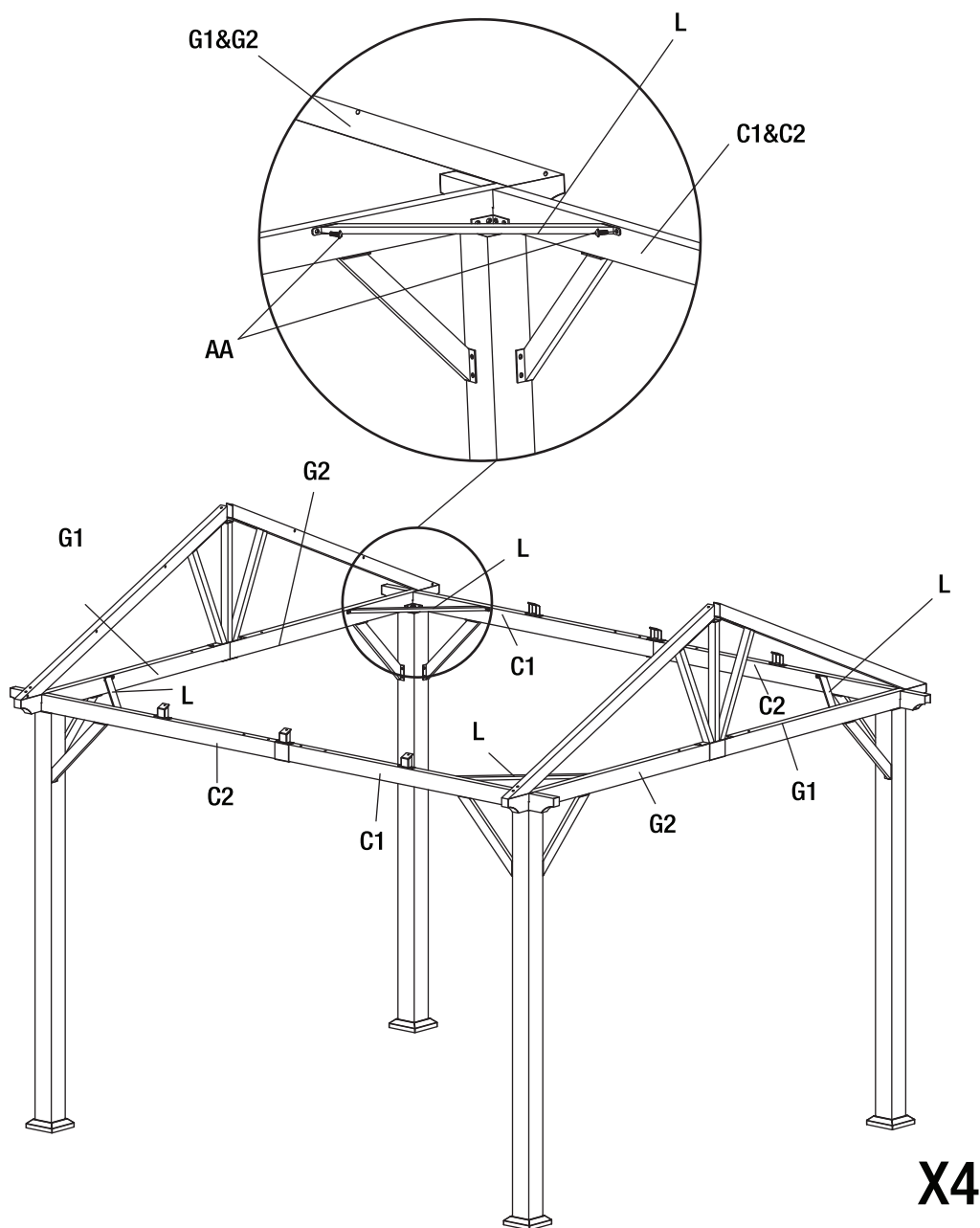

## Assembly (continued)

### 12 Attaching the Studs to the Top Beam

- Screw the studs (GG) to the top beam (M), as shown below.
- Repeat this step for the other top beam (M).



**NOTE:** Pay attention to tighten the correct holes.

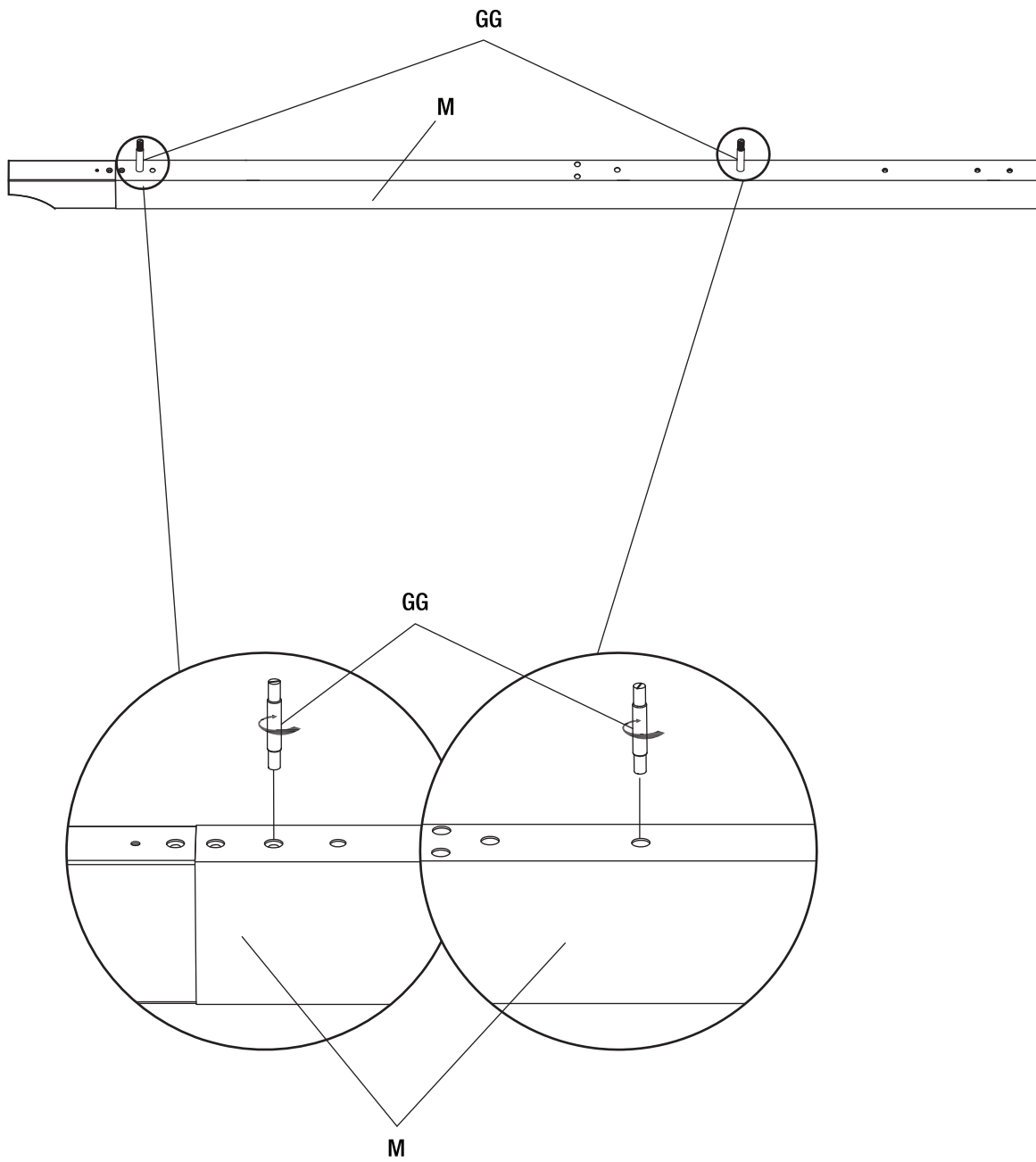



## Assembly (continued)

### 13 Inserting Lining Ring Beam into the Top Beams

- Insert the lining ring beam (D) into two top beams (M) using M6x15 combination bolts (AA), as shown below.
- Fully tighten the bolts using the hex wrench (JJ).

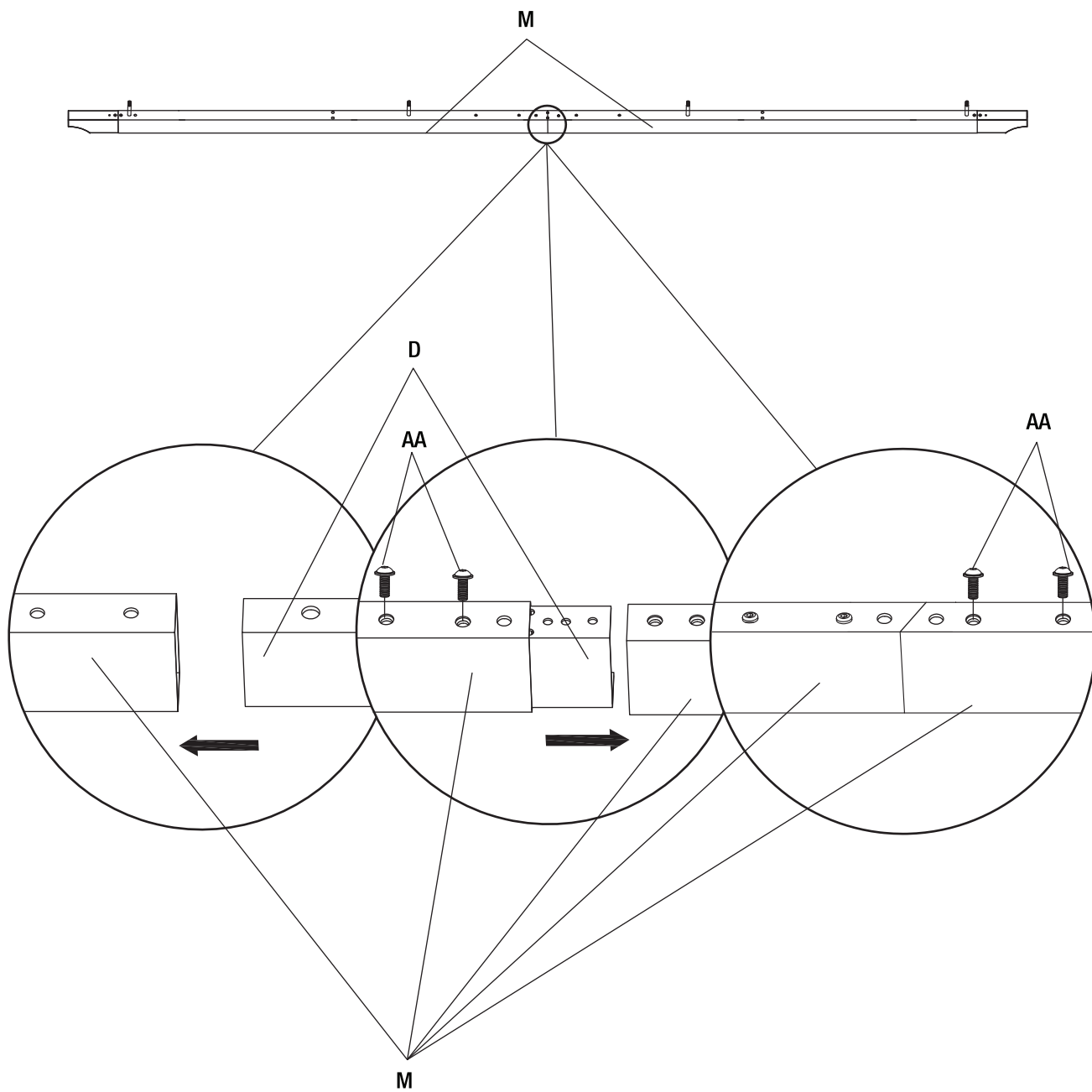

## Assembly (continued)

### 14 Attaching the Roof Panel Connectors to the Top Beams

- Attach the roof panel connector 1 (N1) and roof panel connector 2 (N2) to the top beams (M) using M6x20 countersunk bolts (CC), as shown below.
- Fully tighten the bolts using the hex wrench (JJ).

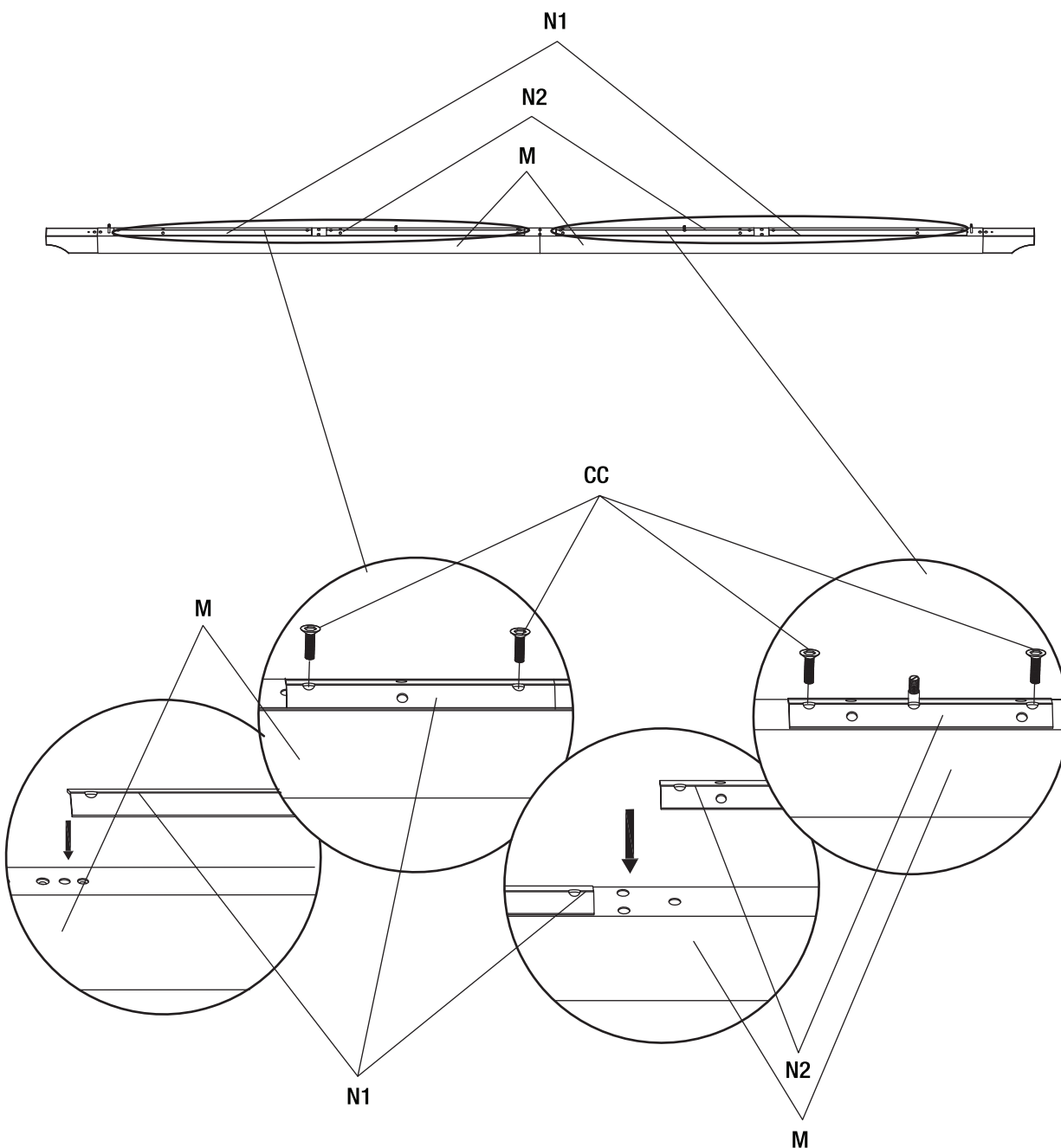

## Assembly (continued)

### 15 Attaching the Chandelier Hooks to the Top Beams

- Screw the chandelier hooks (U) clockwise to the top beams (M), as shown below.

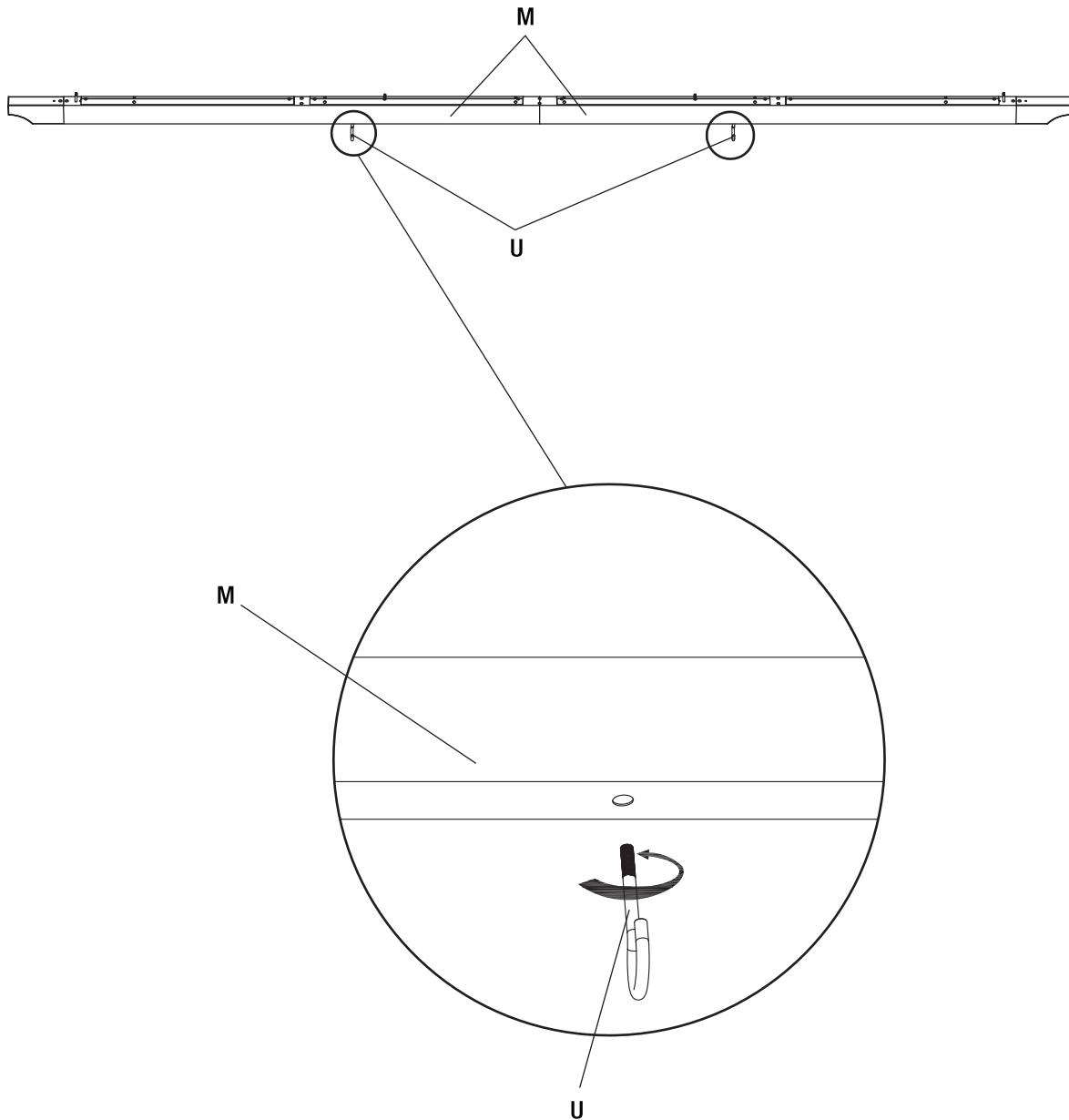

## Assembly (continued)

### 16 Inserting the Top Beams to the Oblique Beams and Attaching the Top Beam Plates to the Oblique Beams and Top Beams

- Insert the assembled top beams (M) to the oblique left beams (J1) and oblique right beams (J2), as shown below.
- Attach the top beam plates (O) to the top beams (M) and the oblique beams (J1&J2), align the holes and secure with M6x15 combination bolts (AA).
- Fully tighten the bolts using the hex wrench (JJ).

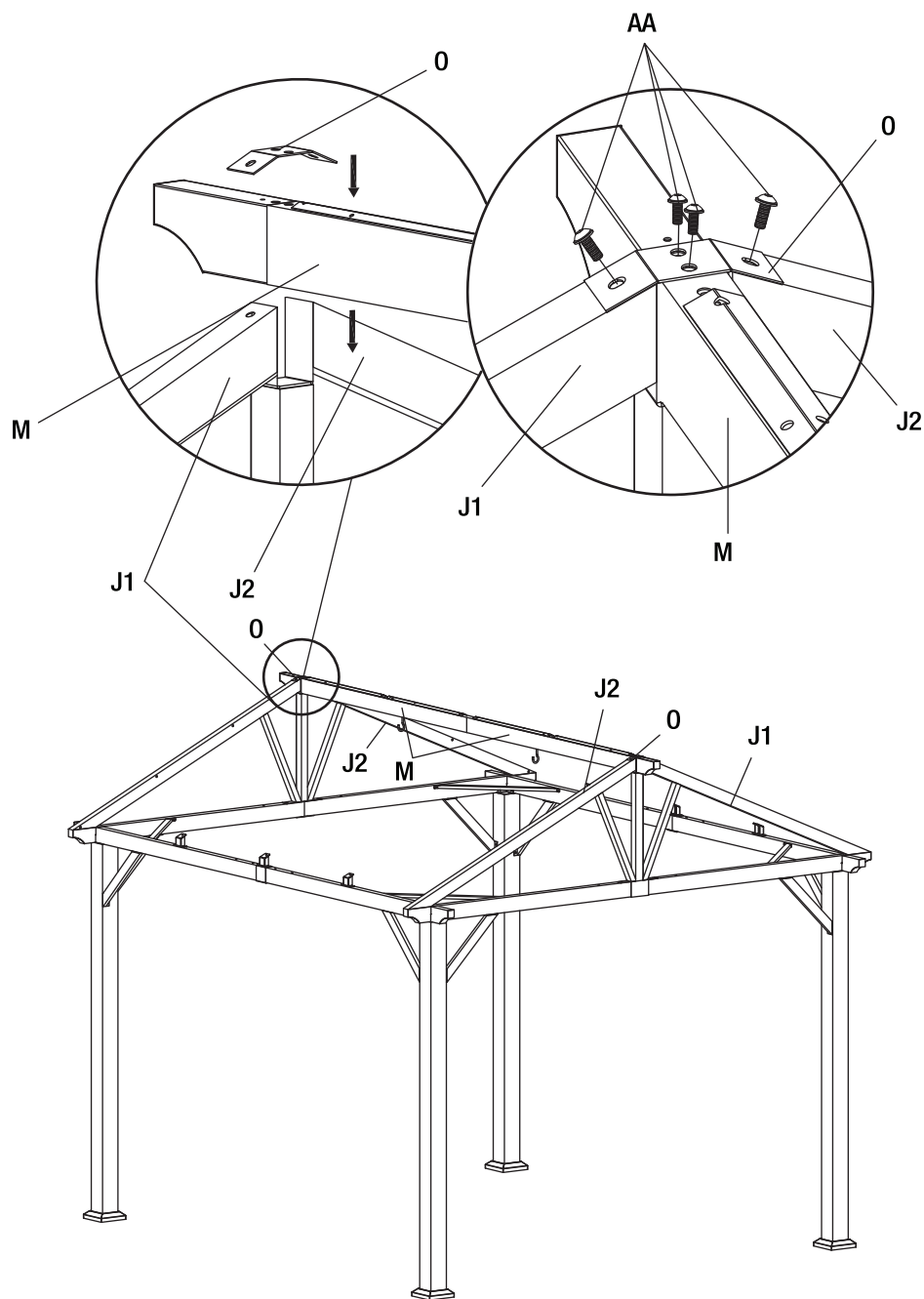

## Assembly (continued)

### 17 Attaching the Corner Rafters to Top Beams and the Assembled Long Side Beams

- Attach the corner rafters (P) to the top beams (M) and the middle inclined beam connectors (F) in the assembled long side beam using M6x15 combination bolts (AA), as shown below.
- Fully tighten the bolts using the hex wrench (JJ).

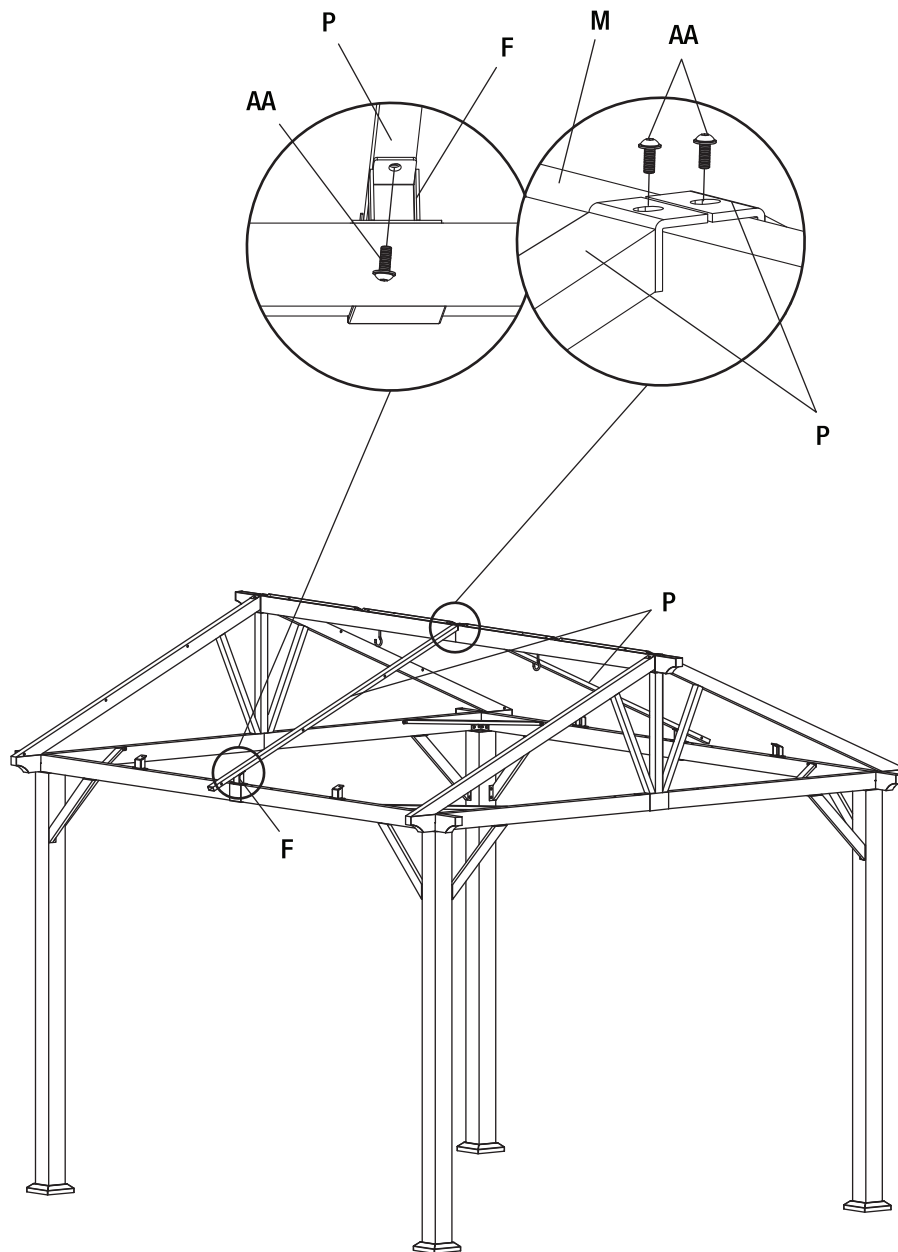

**X2**

## Assembly (continued)

### 18 Unfolding the Rafter Branch Assemblies

- Unfold the four rafter branch assemblies (Q), as shown below.

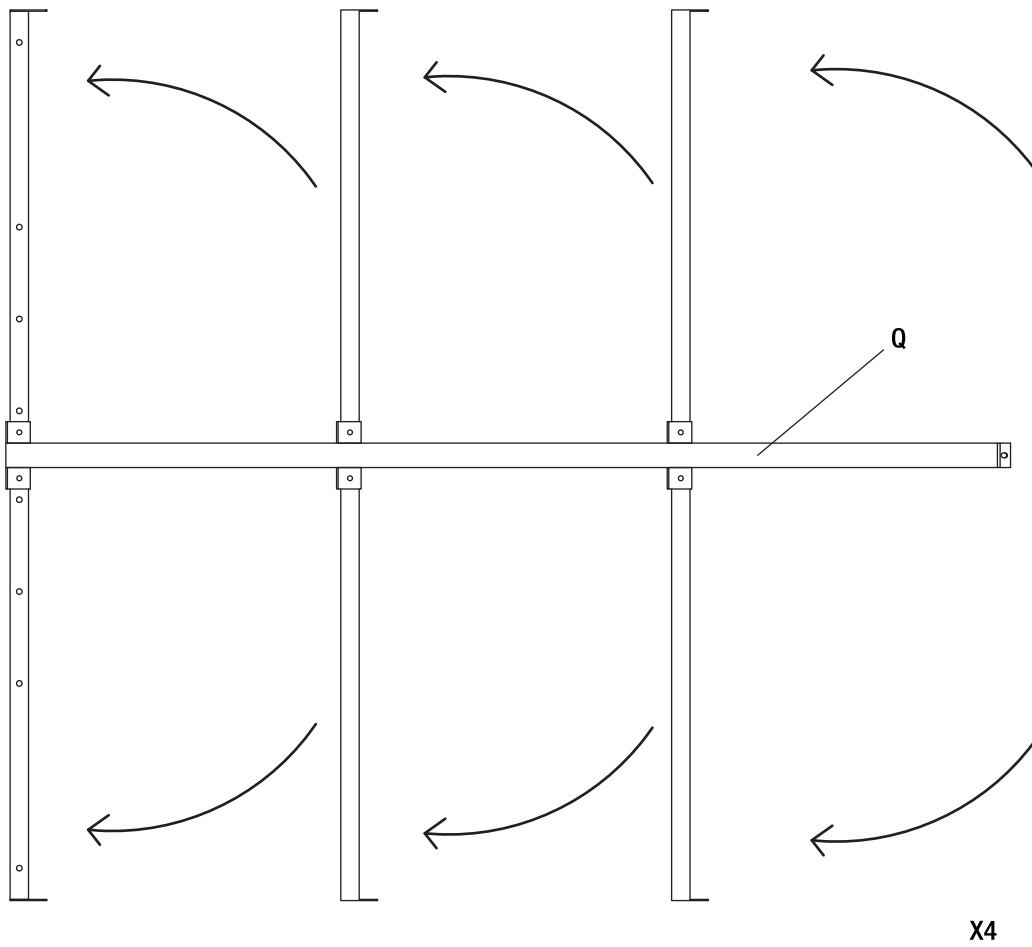

## Assembly (continued)

### 19 Attaching the Unfolded Rafter Branch Assemblies

- Put the rafter branch assemblies (Q) to the side of the corner rafters (P), attach the unfolded rafter branch assemblies (Q) to the top beams (M) and the middle inclined beam connectors (F) using M6x15 combination bolts (AA). Then attach the corner rafters (P) and the oblique beams (J1&J2) using M6x15 combination bolts (AA), as shown below.
- Fully tighten the bolts using the hex wrench (JJ).

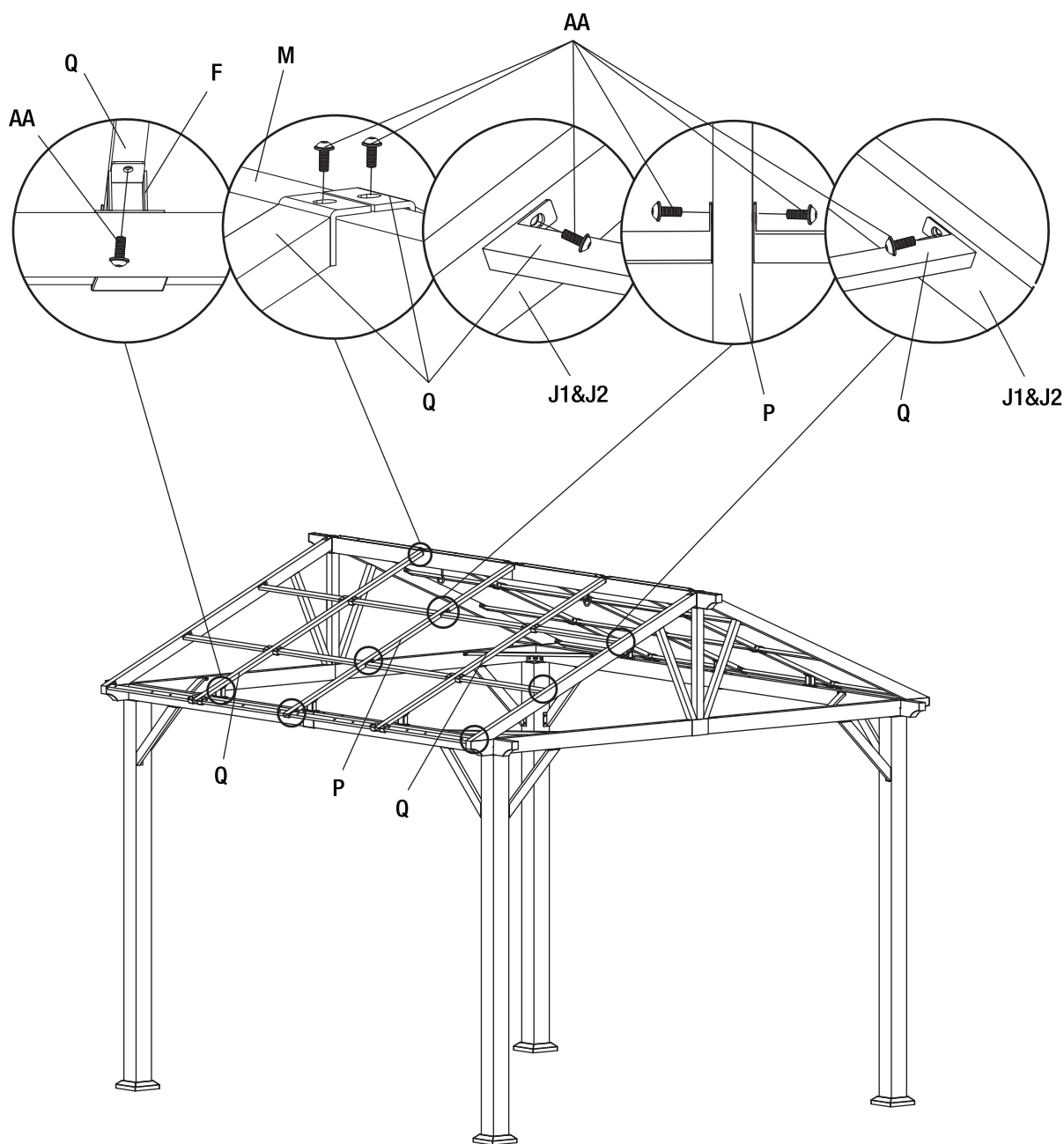

## Assembly (continued)

### 20 Attaching the Roof Panels

- Attach the roof panels 1 (R1) to the roof panel connector 1 (N1) using M6x10 combination bolts (BB), as shown below.
- Fully tighten the bolts using the hex wrench (JJ).

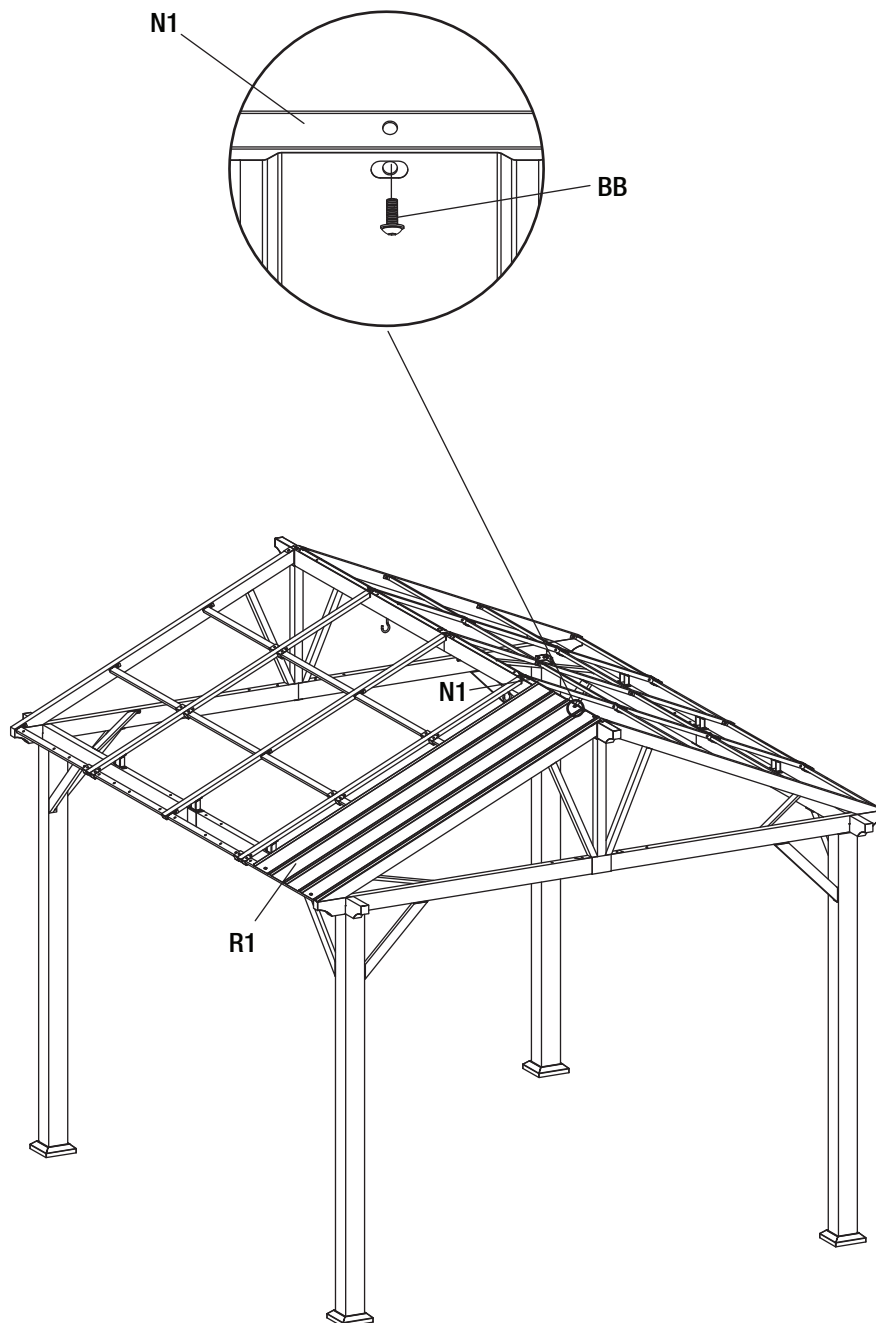



## Assembly (continued)

### 21 Attaching the Roof Panels

- Insert one roof panel 2 (R2) into the groove of the roof panel 1 (R1).
- Insert another roof panel 2 (R2) into the groove of the roof panel 2 (R2).
- Insert the third roof panel 2 (R2) into the groove of the roof panel 2 (R2).
- Attach roof panels 2 (R2) to roof panel connector 2 (N2) using M6x10 combination bolts (BB), as shown below.
- Fully tighten the bolts using the hex wrench (JJ).

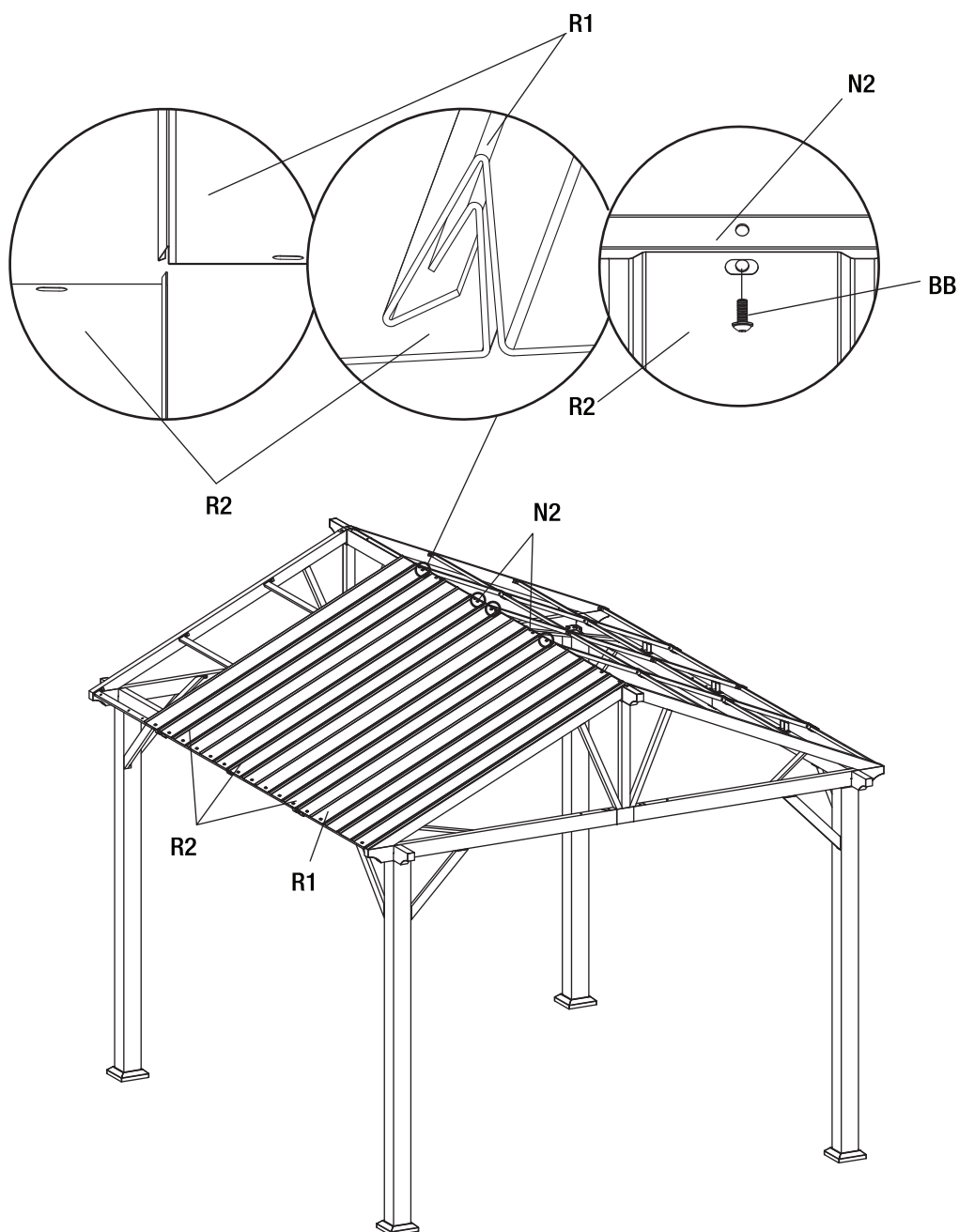

## Assembly (continued)

### 22 Attaching the Roof Panel

- Insert the roof panel 3 (R3) into the groove of the roof panel 2 (R2), then attach roof panel 3 (R3) to roof panel connector 1 (N1) using M6x10 combination bolts (BB), as shown below.
- Fully tighten the bolts using the hex wrench (JJ).

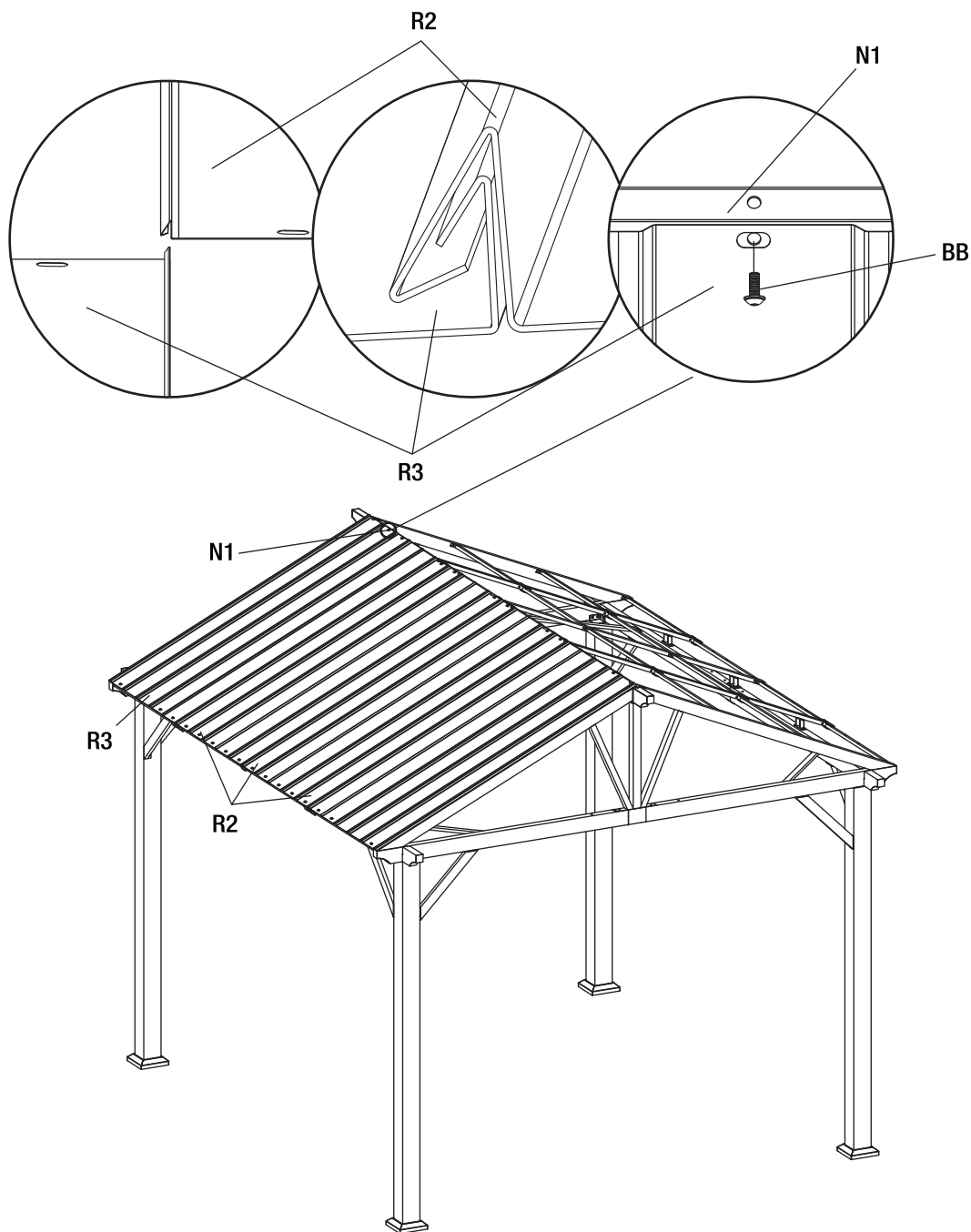

## Assembly (continued)

### 23 Attaching the Edge Roof Cap 1, the Center Roof Edge Cap 2 and the Edge Roof Cap 3

- Attach the edge roof cap 1 (T1), the center roof edge cap 2 (T2) and the edge roof cap 3 (T3) to the roof panel 1 (R1), the roof panel 2 (R2) and roof panel 3 (R3) in turn using M6x15 combination bolts (AA), as shown below.
- Fully tighten the bolts using the hex wrench (JJ).

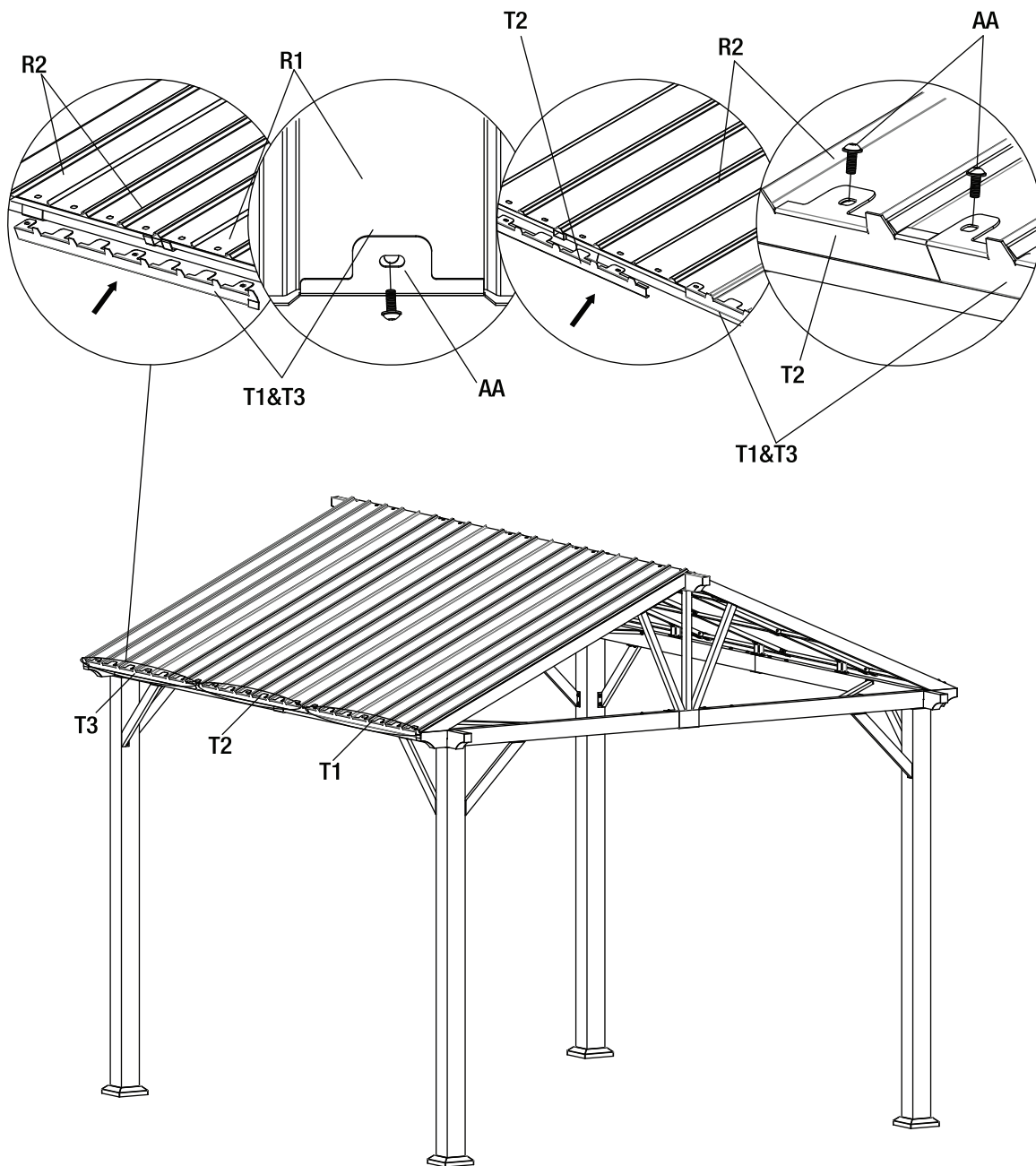

## Assembly (continued)

### 24 Attaching the Roof Panel

- Attach the roof panel 1 (R1) to the roof panel connector 1 (N1) using M6x10 combination bolts (BB), as shown below.
- Fully tighten the bolts using the hex wrench (JJ).



**NOTE:** When assembly roof panel 1 (R1), the opposite is the assembled roof panel 3 (R3).

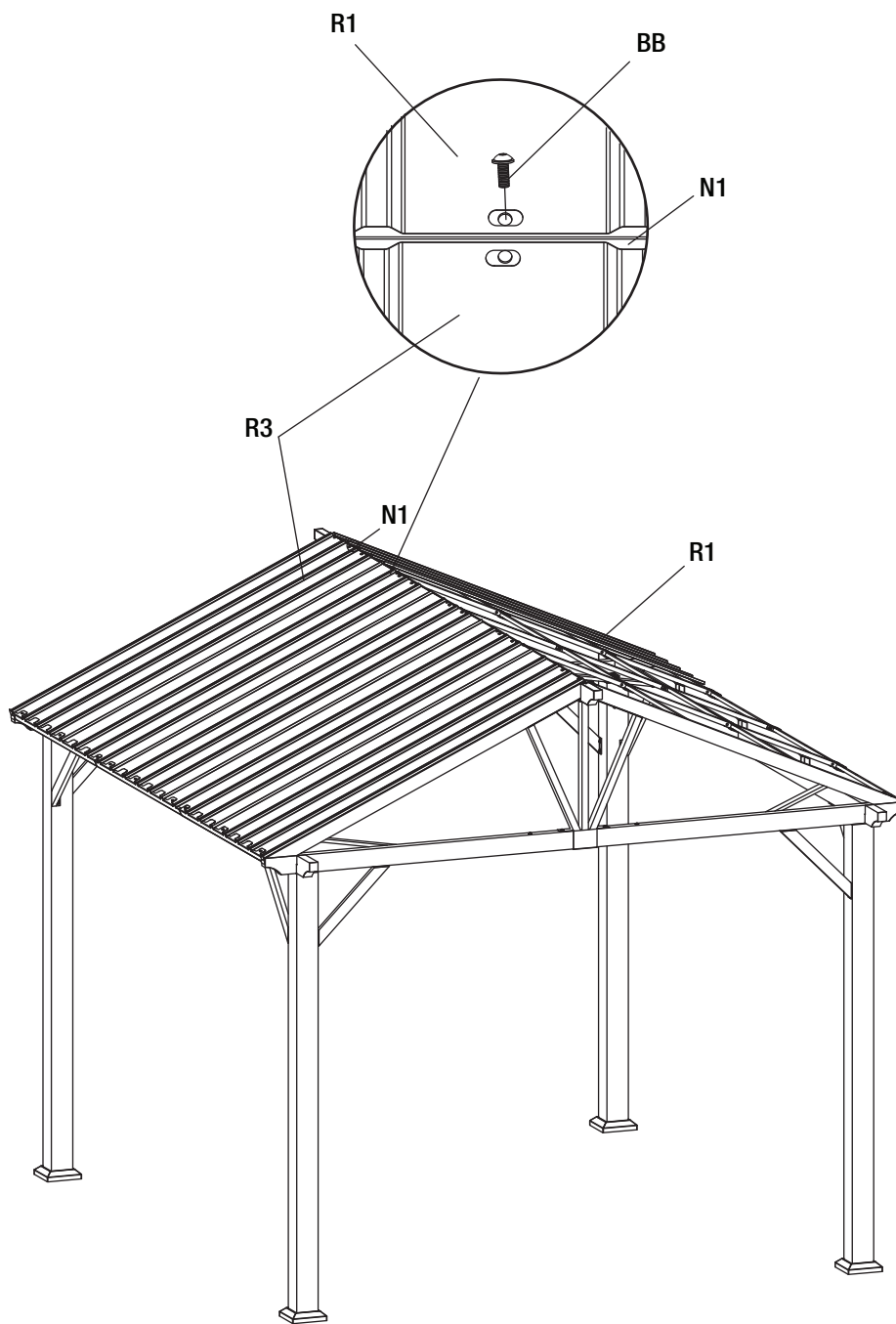

## Assembly (continued)

### 25 Attaching the Roof Panels and Top Covers

- Insert the roof panel 2 (R2) into the groove of the roof panel 1 (R1), then attach roof panel 2 (R2) to roof panel connector 2 (N2) using M6x10 combination bolts (BB).
- Attach the top cover 1 (S1) to the roof panels (R1&R2&R3) using a nut (DD), a washer (EE) and a nut cap (FF), as shown below.
- Fully tighten the bolts using the hex wrench (JJ) and wrench (KK).



**NOTE:** Make sure to place the washer (EE) first, and then screw on the nut (DD).

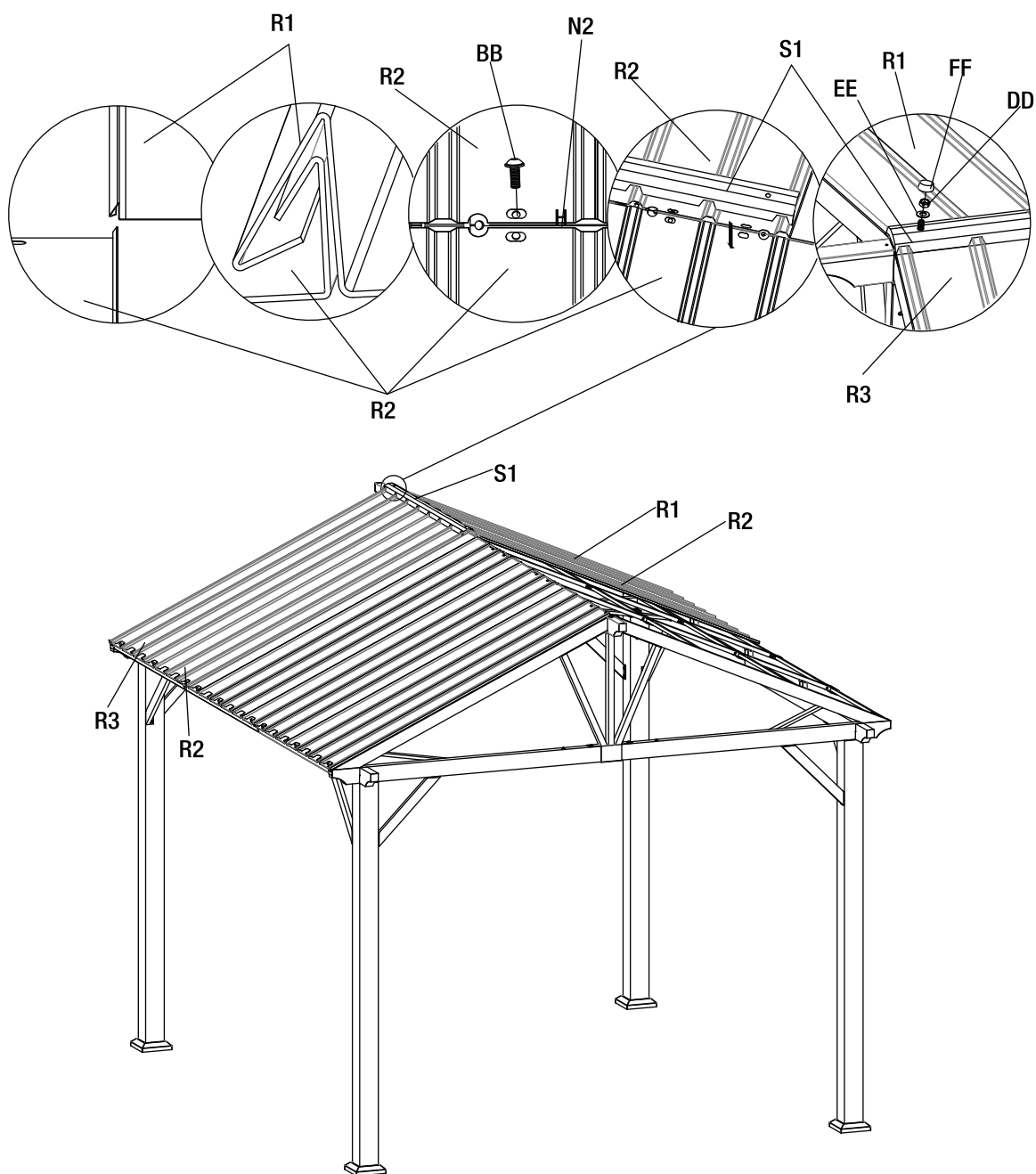

## Assembly (continued)

### 26 Attaching the Roof Panels and Top Covers

- Insert another roof panel 2 (R2) into the groove of the roof panel 2 (R2), then attach roof panel 2 (R2) to roof panel connector 2 (N2) using M6x10 combination bolts (BB).
- Attach the top cover 2 (S2) to the roof panel 2 (R2) using a nut (DD), a washer (EE) and a nut cap (FF), as shown below.
- Fully tighten the bolts using the hex wrench (JJ).



**NOTE:** Make sure to place the washer (EE) first, and then screw on the nut (DD).

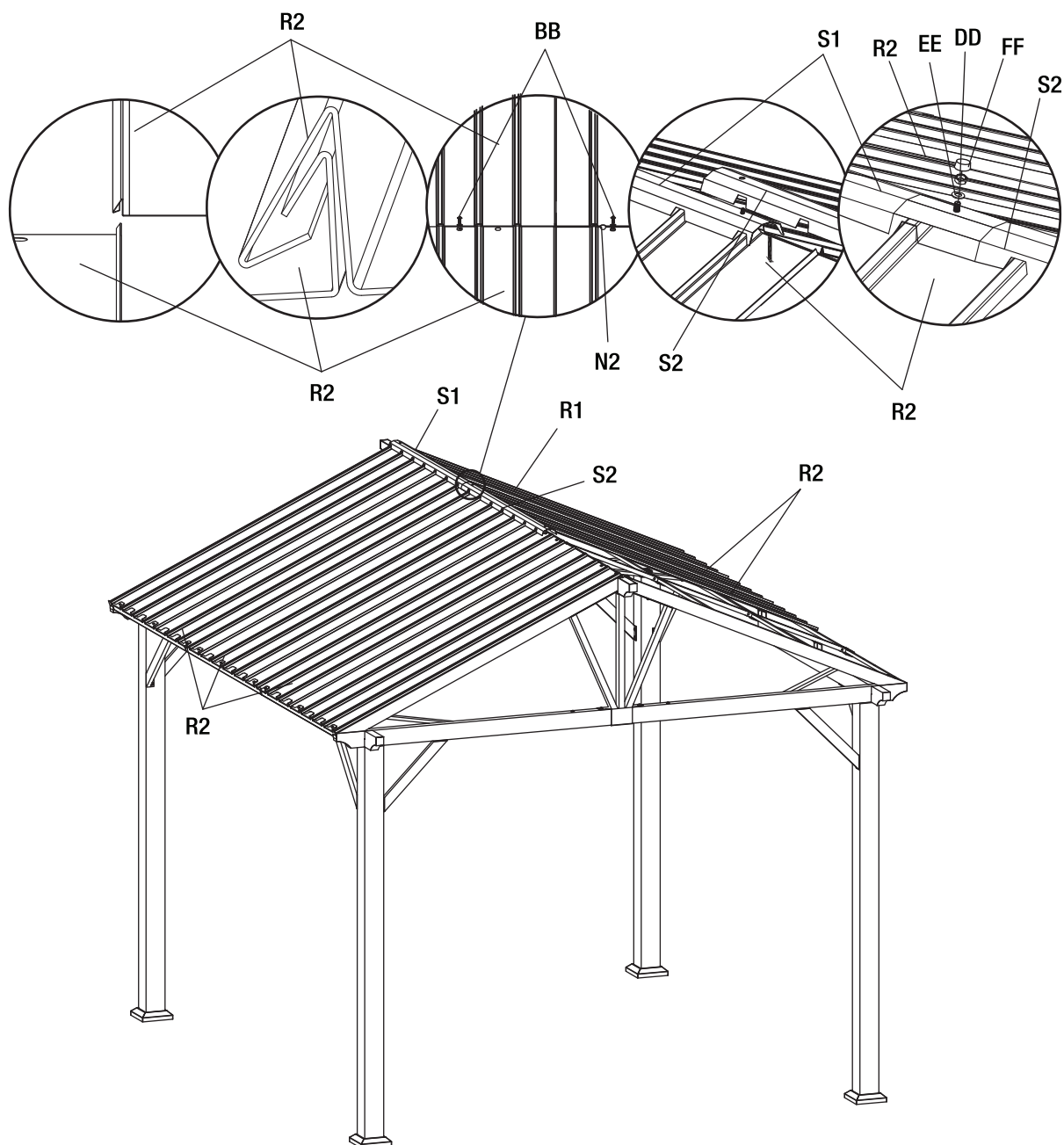

## Assembly (continued)

### 27 Attaching the Roof Panel

- Insert the third roof panel 2 (R2) into the groove of the roof panel 2 (R2), then attach the roof panel 2 (R2) to the roof panel connector 2 (N2) using M6x10 combination bolts (BB).
- Fully tighten the bolts using the hex wrench (JJ) and wrench (KK).

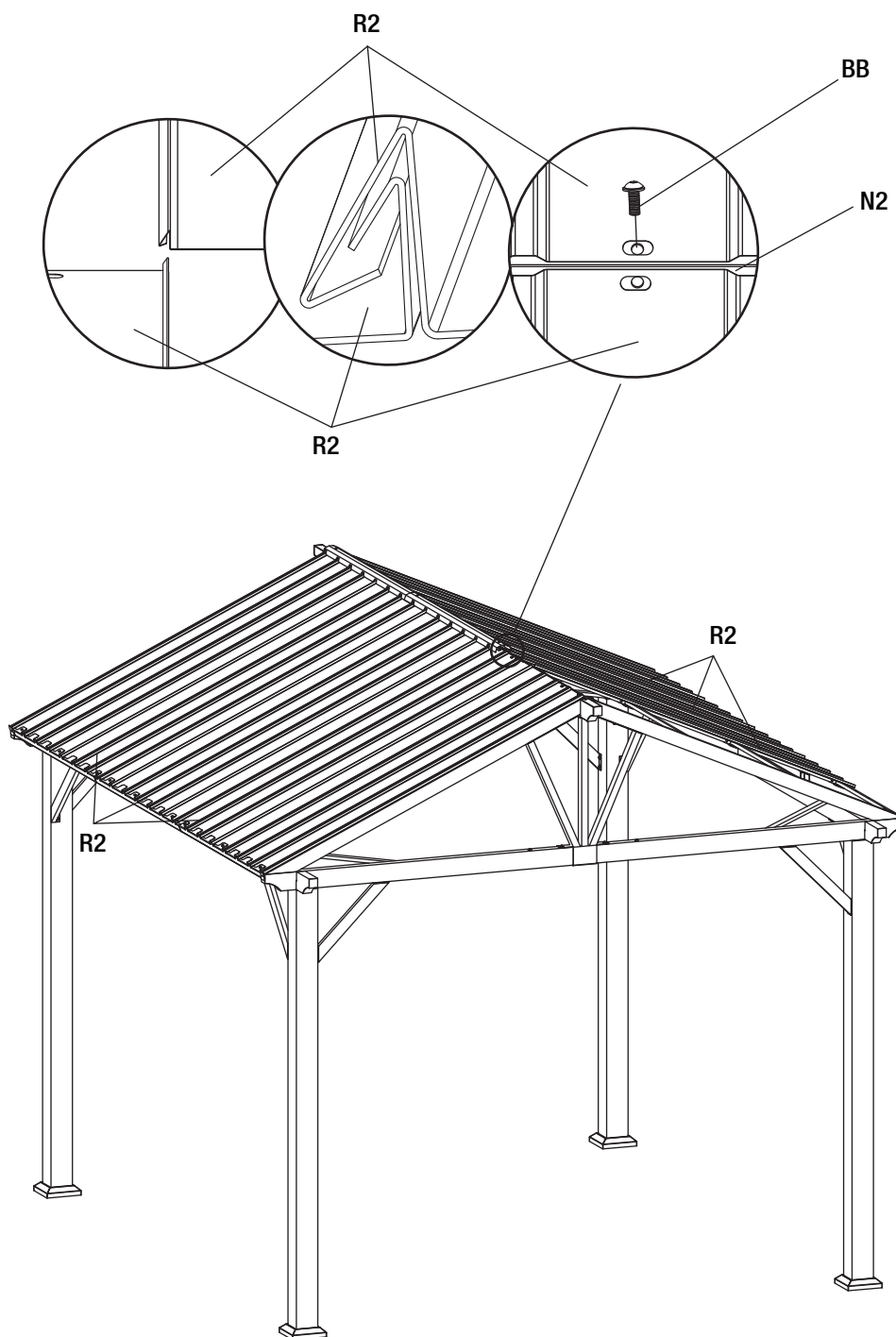

## Assembly (continued)

### 28 Attaching the Roof Panels and Top Covers

- Insert roof panel 3 (R3) into the groove of the roof panel 2 (R2), then attach roof panel 2 (R2) to roof panel connector 2 (N2) using M6x10 combination bolts (BB).
- Attach the top cover 1 (S1) to the roof panels (R1&R2&R3) using nuts (DD), washers (EE) and nut caps (FF), as shown below.
- Fully tighten the bolts using the hex wrench (JJ) and wrench (KK).



**NOTE:** Make sure to place the washer (EE) first, and then screw on the nut (DD).

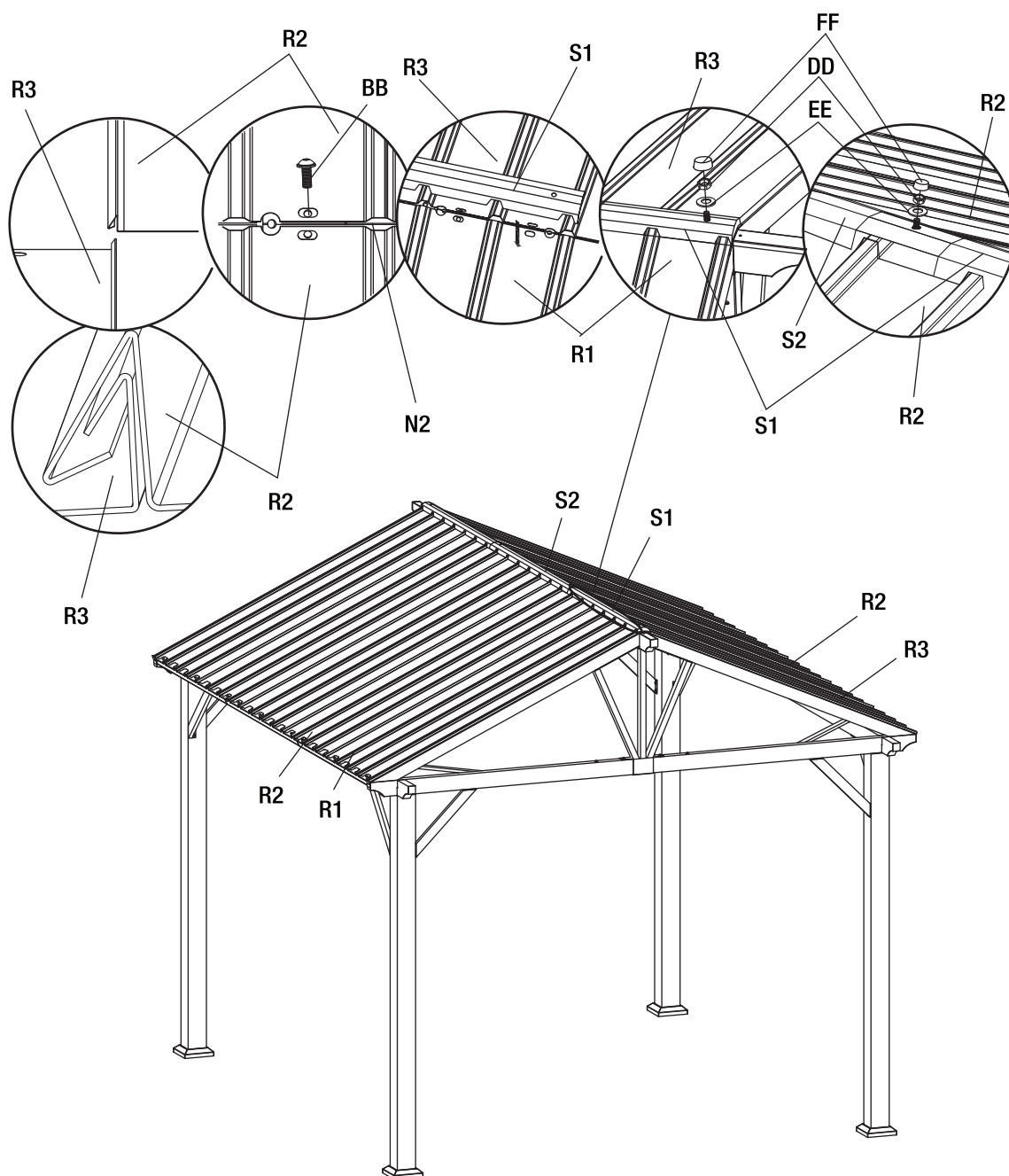



## Assembly (continued)

### 29 Attaching the Edge Roof Cap 1, the Center Roof Edge Cap 2 and the Edge Roof Cap 3

- Attach the edge roof cap 1 (T1), the center roof edge cap 2 (T2) and the edge roof cap 3 (T3) to the roof panel 1 (R1), the roof panel 2 (R2) and roof panel 3 (R3) in turn using M6x15 combination bolts (AA), as shown below.
- Fully tighten the bolts using the hex wrench (JJ).

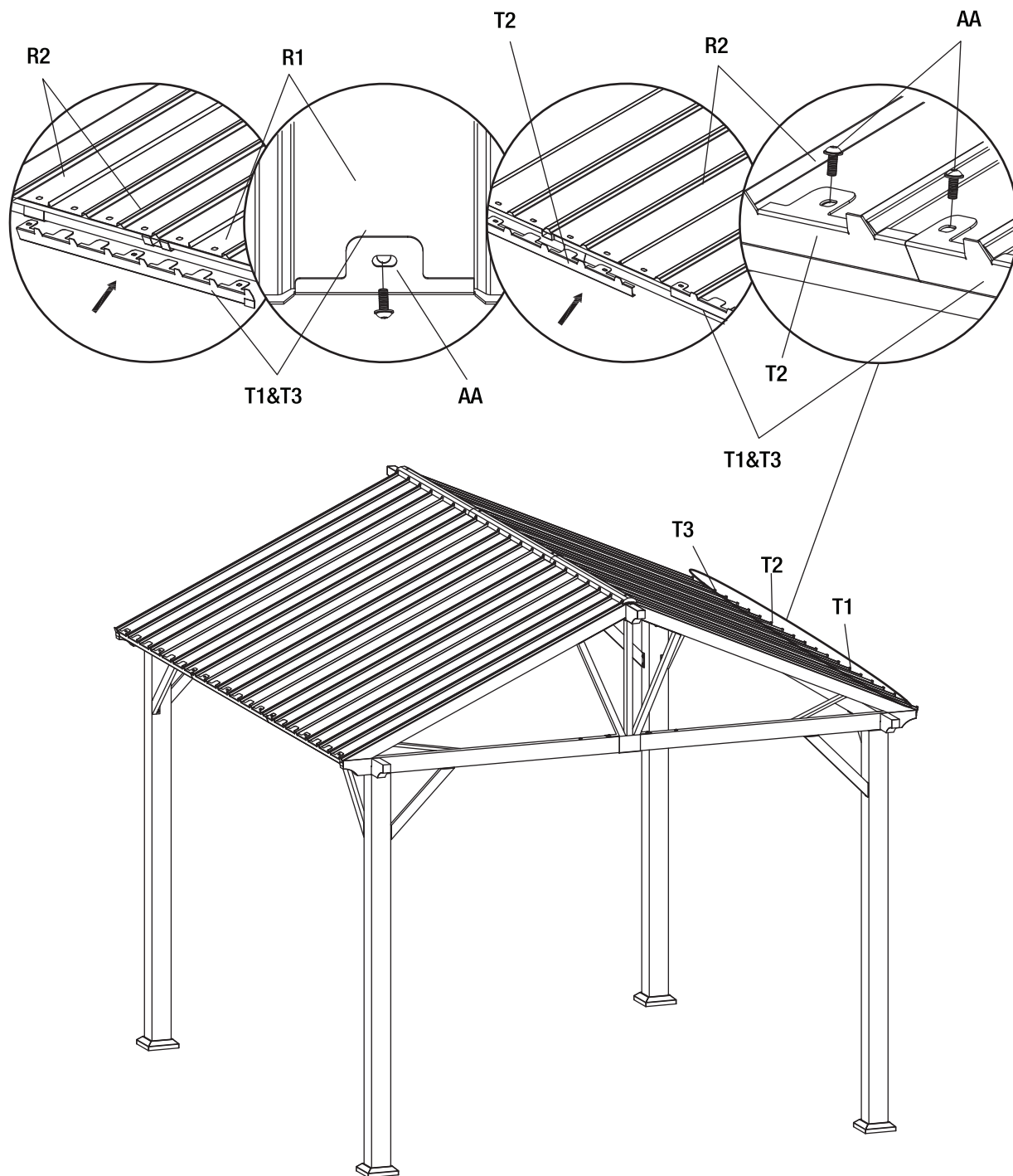

## Assembly (continued)

### 30 Inserting the Stakes

- Lift the foot plate covers (B1) first.
- Insert the stakes (HH) through the foot plates (B2) into the ground.

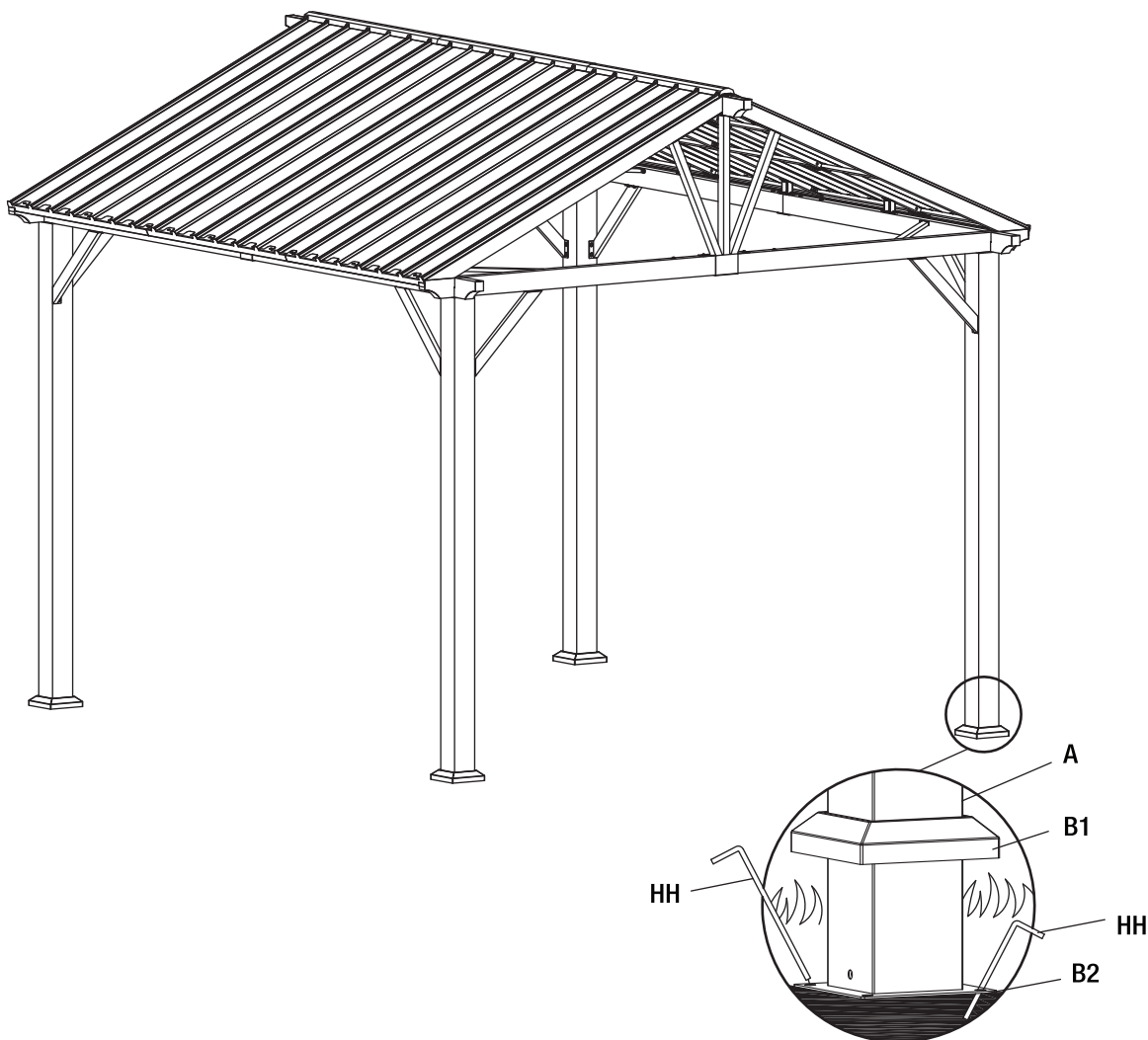

## Care and Cleaning

---

- For best results, clean the gazebo with a damp cloth and dry thoroughly. This will help prevent mildew by removing dirt particles that may accumulate.
- Do not clean with abrasive materials, bleach or solvents.
- Keep the gazebo away from fire, extreme heat, freezing conditions, and inclement weather such as rain, hail, sleet, snow, or wind.

# HAMPTON BAY®

Questions, problems, missing parts? Before returning to the store,  
call Hampton Bay Customer Service.  
8 a.m. - 7 p.m., EST, Monday - Friday, 9 a.m. - 6 p.m., EST, Saturday

**1-855-HD-HAMPTON**

**HAMPTONBAY.COM**

Retain this manual for future use.