



Smarter Pest Control®



HOW TO USE REUSABLE FLY TRAPS!



▼ SETUP ▼

ADD BAIT POUCH.



ADD WATER TO FILL LINE.

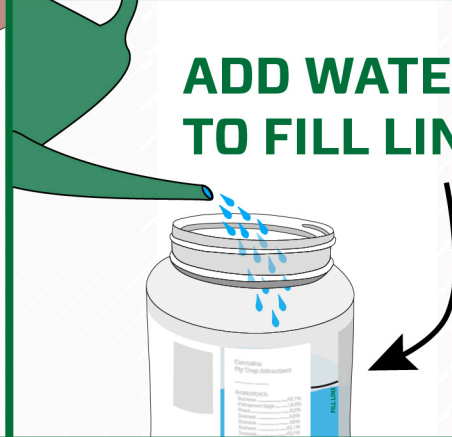

POP OPEN CAP.



*ADD YOUR HANGER.

▼ INSTALL ▼

SET AWAY FROM HOUSE & PATIO.



*SET AT LEAST 20FT FROM OUTDOOR LIVING SPACES.



THE ODOR LURES FLIES.

▼ EMPTY & REUSE ▼

SNAP!

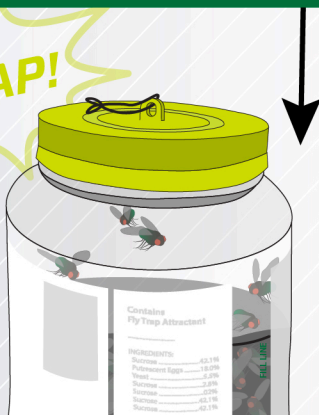

CLOSE TOP CAP.

*ALLOW FLIES TO DROWN BEFORE OPENING.

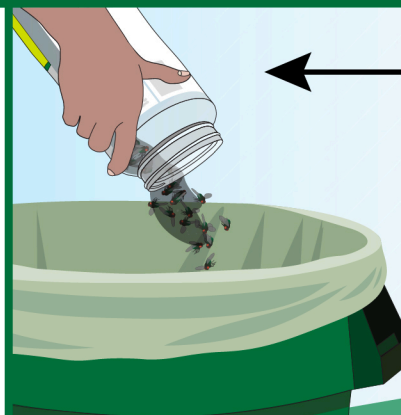

POUR OUT FLIES. REFILL WITH NEW PACKET AND WATER.