

Figure -"A"

NOTES:

- The stud opening for knock down frames should be 2" bigger in width and 1 1/2" in height from frame rebate (Figure -"A"). (i.e. for 3'0" x 6'8" door frame, stud opening should be minimum 38" x 81.500")
- A minimum of 3" is required from crossed wall to stud opening on partition wall (Figure -"B").

TYPICAL PARTITION WALL CONDITION

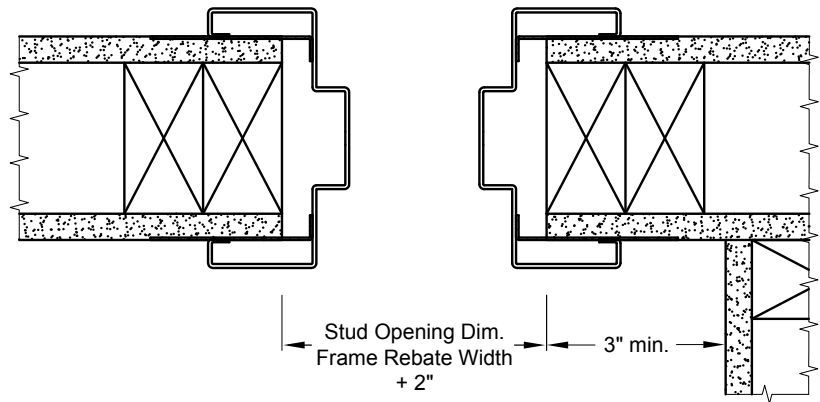
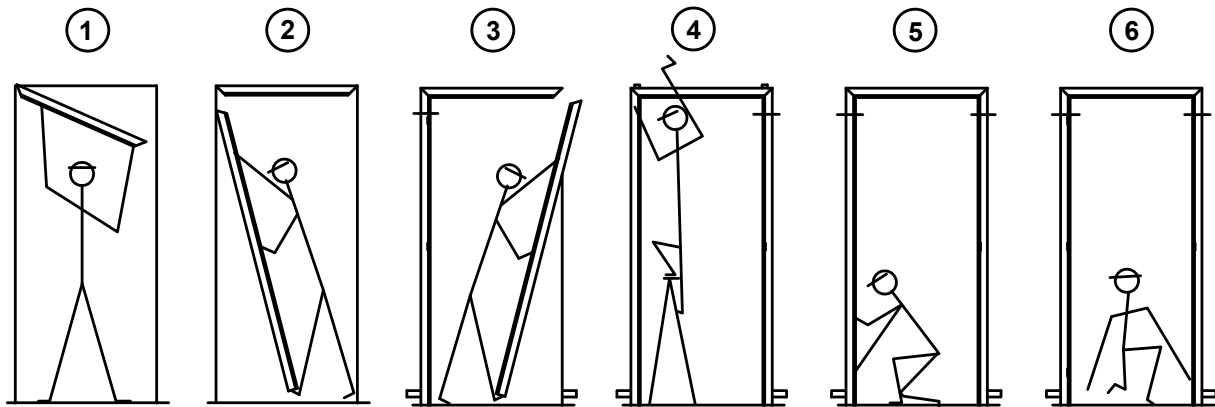

Figure -"B"

INSTALLATION DETAILS



1 Install header.

2 Install hinge jamb. Ensure tabs on jamb are located through slots in header.

3 Install strike jamb in same manner as hinge jamb.

4 Pull down header and secure by bending over the jambs tabs.

5 Plumb hinge jamb, adjust tension anchor and secure strap and base anchors to studs.

6 Adjust strike jamb and head size. Square and adjust tension anchor. Secure strap and base anchors to studs.