

## INSTALLATION INSTRUCTIONS FOR 1" CEILING ROD

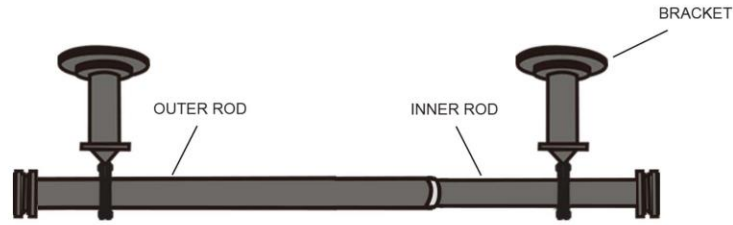

- 1** Place brackets against ceiling at desired locations. Mark screw holes with a pencil. Be sure marks are level across opening. Keep in mind that at least one bracket will be mounted on inner rod and outer rod to prevent rod movement when sliding curtain.

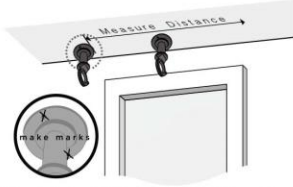

- 2** If screws are going directly into wood trim or ceiling studs, drill a 1/8" pilot hole at pencil marks. If screwing into drywall, follow drywall anchor instructions at the bottom of the page.

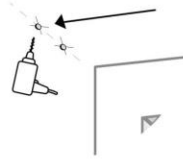

- 3** Insert screws through brackets, and tighten screws until you feel increased resistance. Ensure to mount at least one bracket, on each inner rod and outer rod to prevent rod movement when sliding curtain.



- 4** Assemble the rod by inserting and sliding the smaller diameter rod into the larger diameter rod. Ensure that finial inserts are exposed on each open end after rod assembly.

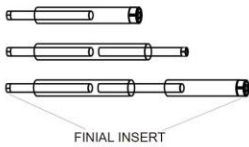

- 5** **ATTACHING INSERTS**  
There are two diameters of white inserts included. For a three piece rod, there is only one diameter of white insert. Skip this step if inserts are already attached to rod. Push corresponding insert into each end of rod with fin side going into the pole and flat end facing out.

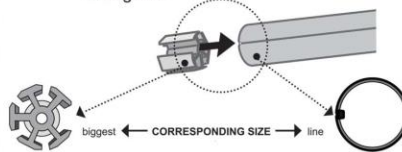

- 6** Slide curtains or curtain rings and assembled rods into brackets.



- 7** Attach finials by turning the end of the finial screw into the end of the plastic insert until completely snug. Rotate finial on rod for proper alignment if required.

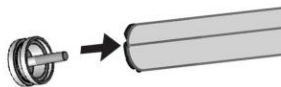

- 8** Tighten screws on brackets.

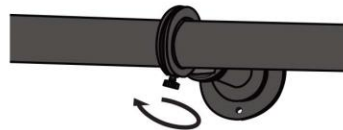

### DRYWALL ANCHOR INSTALLATION



If screws are going directly into wood trim or wall studs - drill 1/8" (3mm) holes and install screws through bracket. If screws are going into hollow wall - drill 3/16" (5mm) holes and push or lightly hammer plastic anchors into holes. Then install screws through brackets. Do not tighten screws too much - just snug is best.