



ELECTRIC TANKLESS WATER HEATER - POINT OF USE

INSTANT-FLOW® SR - STANDARD FLOW

APPLICATION: commercial, industrial, residential, lavatory, shower, kitchen/bar sink, service sink, scrub sink

PRODUCT FEATURES

- Unlimited hot water
- Saves water and energy - 99% energy efficient
- Vandal resistant rugged cast aluminum housing
- Space saving compact size:
6-1/4" (H) x 9-5/8" x 2-3/4"
(159 (H) x 244 x 70mm)
- Meets applicable building codes including ADA, UL, IAPMO, UPC, CSA.
- Environmentally friendly
- Made in the U.S.A.

Chronomite Instant-Flow® SR- Standard Flow models are manufactured to provide reliable point-of-use hot water. There is no pressure and temperature relief valve needed (unless required by code), saving time and money on installation.

Housing is fabricated from rugged cast aluminum alloy.

Element assembly is fabricated from Celcon plastic.

Heating coils are nichrome.

Faucet flow controls are supplied with each unit. 3/8" compression fittings are supplied (standard). Optional 1/2" and 3/4" male NPT water connections available.



Member of
U.S. Green
Building Council



Water
Conserving
Product



Made in
the USA



Instant-Flow® SR - Standard Flow

GUIDE SPECIFICATION

Tankless Water Heater shall be a Chronomite Laboratories Model

SR -

AMPS

/

VOLTS

OPTIONS

with

Amps

and

Volts

to heat 1.0 GPM (3.8 LPM) at a temperature rise of

°F

Unit shall be provided with Celcon waterways, and Nichrome heating coils

OPTIONS

- ☐ PA 765 ABS Housing (P)
- ☐ Satin Finish Stainless Steel Housing (SS)
- ☐ High Polish Finish Stainless Steel (SSP)
- ☐ Pressure & Temp Relief Valve Assembly (TP)
- ☐ 1/2" Male NPT (NPT08)
- ☐ Disconnect Switch, Rotary 40A - Lockable Nema 4X (2095-1)

For the model being selected, please place the corresponding amps, volts and temperature rise values in the Guide Specifications to the right.

MODEL	AMPS	VOLTS	WATTS	ACTIVATION GPM	°F TEMPERATURE RISE @		
					1.00 GPM	1.25 GPM	1.50 GPM
SR-30/208	30	208	6240	0.65	43	34	28
SR-30/240	30	240	7200	0.65	49	39	33
SR-30/277	30	277	8310	0.65	57	45	38
SR-40/208	40	208	8320	0.65	57	45	38
SR-40/240	40	240	9600	0.65	66	52	44

Complies
with
Standards
for:

LISTED TO:
UL STD 499

CERTIFIED TO:
CAN/CSA STD C22.2 NO. 88



CHRONOMITE LABORATORIES, INC.

17451 Hurley St. :: City of Industry, CA 91744 U.S.A.
Phone 800-447-4962 :: 626-937-4270
Fax 626-937-4279 :: www.chronomite.com

MEMBER OF



INSTANT-FLOW® SR - STANDARD FLOW

INSTANT-FLOW® SR - STANDARD FLOW METRIC CHART

MODEL	AMPS/PHASE	1 Ø VOLTAGE	WATTS	ACTIVATION LPM	°C TEMPERATURE RISE @		
					4.00 LPM	5.00 LPM	6.00 LPM
SR-30/208	30	208	6240	2.5	22	18	15
SR-30/240	30	240	7200	2.5	26	21	17
SR-30/277	30	277	8310	2.5	30	24	20
SR-40/208	40	208	8320	2.5	30	24	20
SR-40/240	40	240	9600	2.5	34	28	23

TECHNICAL DIMENSIONS

INSTANT-FLOW® SR - STANDARD FLOW

Dimensions:	159 (H) x 244 x 70mm
Weight:	2.27 Kg
Materials:	Rugged cast aluminum housing Celcon plastic element assembly with nichrome coils
Housing Color:	White
Minimum Operating Flow Rate:	2.5 LPM
Minimum Operating Pressure:	172 kPa
Maximum Operating Pressure:	552 kPa
Maximum Pressure:	1034 kPa
Maximum Water Temperature:	71°C
Maximum Ambient Operating Temperature:	60°C
Listing:	UL, IAPMO, UPC, ADA, ETL

GENERAL NOTES:

- 240V models when operated at 220V will have approximately a 15% temperature decrease.
- 120V models when operated 110V will have approximately a 15% temperature decrease.

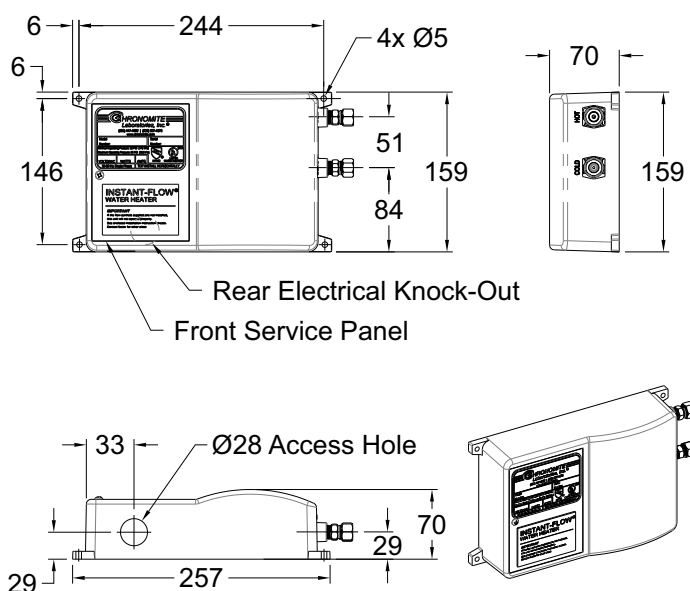

Chronomite Laboratories assumes no responsibility for use of void or suspended data. © Copyright Chronomite Laboratories, Inc.
Member of Morris Group International, City of Industry, CA Please visit www.chronomite.com for most current specifications.

SELECTION SUMMARY
& APPROVAL FOR
MANUFACTURING

Company _____	Quantity _____
Model Number & Options _____	
Contact _____	Title _____
Signature (Approval for Manufacturing) _____	Date _____

CHRONOMITE
LABORATORIES, INC.

PH. 800-447-4962

626-937-4270

FAX 626-937-4279

www.chronomite.com

INSTANT-FLOW® SR - STANDARD FLOW

TECHNICAL DIMENSIONS

INSTANT-FLOW® SR - STANDARD FLOW

Dimensions:	6-1/4" (H) x 9-5/8" x 2-3/4"
Weight:	5 lbs.
Materials:	Rugged cast aluminum housing Celcon plastic element assembly with nichrome coils
Housing Color:	White
Minimum Operating Flow Rate:	0.65 GPM
Minimum Operating Pressure:	25 PSI
Maximum Operating Pressure:	80 PSI
Maximum Pressure:	150 PSI
Maximum Water Temperature:	160°F
Maximum Ambient Operating Temperature:	140°F
Listing:	UL, IAPMO, UPC, ADA, ETL

GENERAL NOTES:

- 240V models when operated at 220V will have approximately a 15% temperature decrease.
- 120V models when operated 110V will have approximately a 15% temperature decrease.

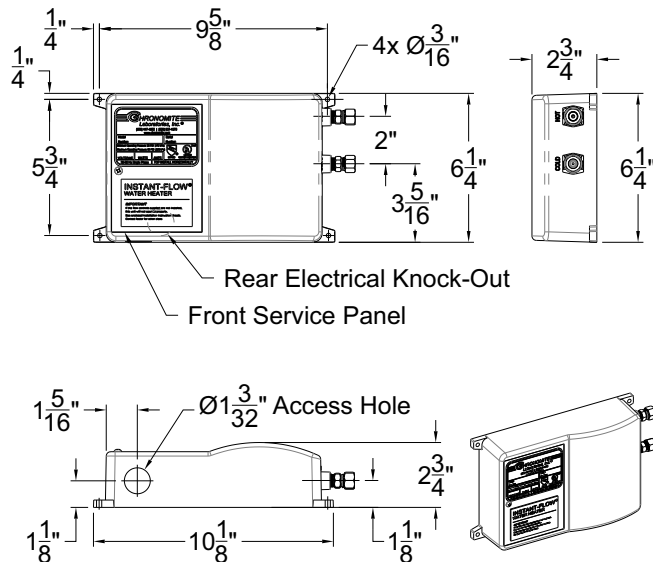

INSTALLATION DIAGRAM

Notes:

1. Heater to be installed below the level of all hot water outlets serviced by the heater.
2. Diagram shown with standard 3/8" Compression Fitting. Optional 1/2" Male NPT water connections available.

- 1 Instant-Flow SR Heater
- 2 Electrical Junction Supply Box (optional)
- 2A 2095-1 Disconnect Switch (optional)
- 3 Electrical Supply Conduit
- 4 Electrical Supply Wire
- 5 Dual outlet Stop, 3/8" Comp. Outlet Connections
- 6 3/8" Comp. x 1/4" NPT Fittings (supplied)
- 7 3/8" Hot Water Outlet
- 8 3/8" Cold Water Inlet

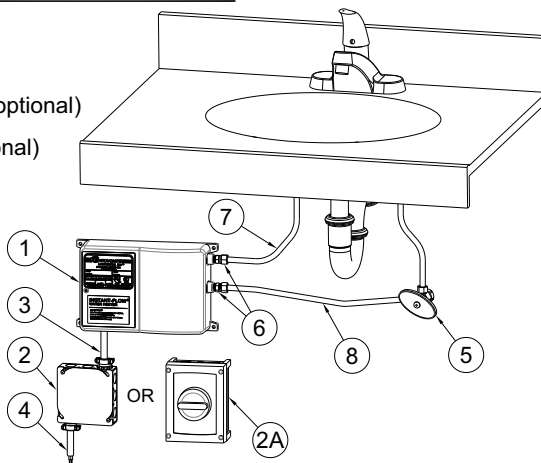

WIRING CONNECTION

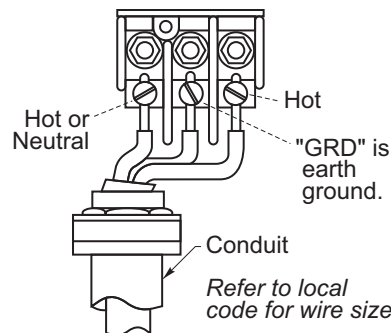

ATTENTION:
Unit must be hard wired.
NOTE: Heaters are single phase.
All tests are measured at the output of the heater.

Chronomite Laboratories assumes no responsibility for use of void or suspended data. © Copyright Chronomite Laboratories, Inc.
Member of Morris Group International, City of Industry, CA Please visit www.chronomite.com for most current specifications.

SELECTION SUMMARY
& APPROVAL FOR
MANUFACTURING

Company _____	Quantity _____
Model Number & Options _____	
Contact _____	Title _____
Signature (Approval for Manufacturing)	Date _____

CHRONOMITE
LABORATORIES, INC.

PH. 800-447-4962
626-937-4270
FAX 626-937-4279
www.chronomite.com