



LED Wall Pack Series



Product Manual

1. Specification

| | | |
|---------------------|--------------------|-----------|
| Input Voltage | 100-277VAC 50/60Hz | |
| Working Temperature | -25° ~ 55° | |
| Storage Temperature | -25° ~ 65° | |
| Life-span | >50000H | |
| Connecting Wire | Brown/Black | L Live |
| | Blue/White | N Neutral |
| | Yellow/Green | G Earth |
| Light Fixture Color | Black/Brown | |

2. Features

- * Energy saving more than 80%.
- * Unique patented thermal management design to ensure low LED junction temperature.
- * Extremely light weight for safety use and installation.
- * Ultra high power to give ultra high brightness.
- * Easy installation and maintenance, dust prevention and suitable for wet location, longer lifetime with high lumen efficiency.
- * Energy saving, no UV and IR radiations, emitting low heat.

3. Usage

Suitable for Warehouses, factories, workshops, Retail stores, Theme restaurants, Amusement parks, Indoor or outdoor stadiums and sport fields, or other industrial and commercial lighting applications.

4. Installation

1. Inspecting installation site: You should check whether the site can support the weight over 1.5 times of the lamp. Otherwise, do not install.
2. Fixed the lamp on the installation site: When the site is flat cement or concrete, Please select the suitable screws, using impact hand-drill set the hole as same as the installations. Put expansion screws fixed on the installation surface.



Wall Pack Install Instructions

1. Unscrew the two screws under the cover and remove the two waterproof plug (Outlet for water if it comes in)



4. Reconnect the terminal to the ground wire, mount the cover and screw the two screws.

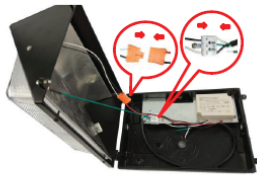

2. Press and hold the terminal spring, unplug the power supply and ground terminals, then separate the bottom cap and the cover.

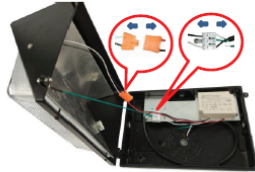

5. Terminals Instruction.

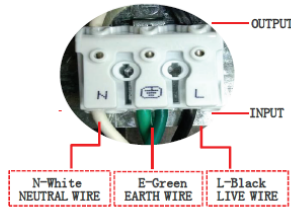

3. Select a appropriate outlet position, remove the plug and connect the waterproof connector into the outlet hole, drill through the three holes (holes are thickness and easy to penetrate) on the bottom and fix the light on the wall.

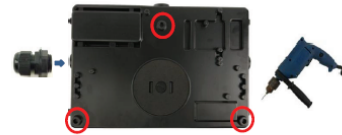

6. Wiring Instruction.

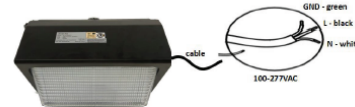

The connection way as follows:

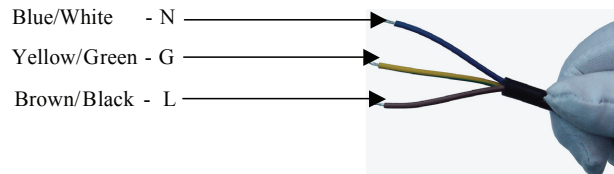

*Note: If the light is for outdoor usage, the wires need to prepare waterproof treatment in the joint.

5. Maintenance & repair instructions

a. Troubles Resolution:

Troubles and solutions: Observe the surface of LED light source whether there is discoloration, broken traces, with or without obvious fracture connectivity when you check. Please also check whether Power connection is loose & short-circuit, with or without obvious signs of damage. Please replace the light source and power if there is any obvious signs of damage.

| Phenomenon | Possible reasons | Solutions |
|---------------------|----------------------------------|--|
| LED lamp not bright | Lamp wire connection is abnormal | Loosen the screw and reconnect the power supply wire |
| | LED is damaged | Replace the LED |
| | Power supply failure | Replace the power supply |
| LED lamp twinkled | Power supply not connected well | Loose the screw and reconnect the power supply wire |
| | Input voltage waves large | Confirm the right input voltage |
| | Power supply failure | Replace power supply |

b. Maintenance, repair Note

1. Please make sure the light is power-off before the maintenance.
2. In order to maintain a good light transmittance; please clean the glass cover of the light regularly.
3. for maintaining good heat dissipation, please clean the dust on shell and the heat sink of the light timely.
4. Please do not use corrosive cleaning liquor to clean, preferably with a dry cloth.
5. you may open the rear cover with a screwdriver, cut off the power when you replace the power supply.