



Item #1007 540 564
Model #22HD20057

USE AND CARE GUIDE

7.5 FT REDVALE PINE ARTIFICIAL PRE-LIT TREE



Questions, problems, missing parts? Before returning to the store,
call Home Accents Customer Service
8 a.m. - 7 p.m., EST, Monday-Friday, 9 a.m. - 6 p.m., EST, Saturday

1-855-HDHOLIDAY (1-855-434-6543)

HOMEDEPOT.COM

THANK YOU

We appreciate the trust and confidence you have placed in Home Accents through the purchase of this Christmas tree. We strive to continually create quality products designed to enhance your home. Visit us online to see our full line of products available for your home improvement needs. Thank you for choosing Home Accents!

Table of Contents

Table of Contents	2	Installation	4
Safety Information	2	Operation	5
Warranty	3	Care And Storage	5
Pre-Assembly	3	Troubleshooting	5
Planning Assembly	3		
Package Contents	3		

Safety Information

IMPORTANT SAFETY INFORMATION. READ AND FOLLOW ALL SAFETY INSTRUCTIONS.

- This seasonal product is not intended for permanent installation or use.
- Do not secure the wiring of the product with staples or nails.
- Unplug the product when leaving the house, retiring for the night, or if left unattended.
- This transformer is rated at 120V, 60 Hz (input) and 29V, 0.28A, 8W (output).
- Do not hang ornaments or other objects from the cord, wire, or light string.
- Do not rest any object on power supply cord or wires. Avoid objects which might damage wires.
- This product is for decoration ONLY. This is not a toy. Keep small children away from this product.

 **WARNING:** Do not connect extra light sets, tree toppers, or any other electrical items to the existing light sets on your pre-lit tree. This will void the warranty.

 **WARNING:** Do not mount or place the tree near gas or electric heaters, fireplaces, candles or other similar combustible sources.

 **WARNING:** Do not use seasonal products outdoors unless marked suitable for indoor and outdoor use.

 **WARNING:** This device complies with Part 15 of the FCC Rules. Operation is subject to the following two conditions: (1) this device may not cause harmful interference, and (2) this device must accept any interference received, including interference that may cause undesired operation.

 **CAUTION:** Changes or modifications not expressly approved by the party responsible for compliance could void the user's authority to operate the equipment.

 **NOTE:** This equipment has been tested and found to comply with the limits for a Class B digital device, pursuant to Part 15 of the FCC Rules. These limits are designed to provide reasonable protection against harmful interference in a residential installation. This equipment generates, uses, and can radiate radio frequency energy and, if not installed and used in accordance with the instructions, may cause harmful interference to radio communications. However, there is no guarantee that interference will not occur in a particular installation. If this equipment does cause harmful interference to radio or television reception, which can be determined by turning the equipment off and on, the user is encouraged to try to correct the interference by one of more of the following measures:

- Reorient or relocate the receiving antenna.
- Increase the distance between the equipment and receiver.
- Connect the equipment into an outlet on a circuit different from that to which the receiver is connected.
- Consult the dealer or an experienced radio/TV technician for help.

SAVE THESE INSTRUCTIONS

Warranty

The manufacturer warrants this product against defects in materials or workmanship for a period of three years from the date of purchase. The manufacturer will replace defective parts on the product at no charge. This limited warranty does not cover damage resulting from accident, misuse, abuse, negligence or normal wear and does not apply to floor models or display trees.

To obtain warranty service, you must notify The Home Depot by calling the customer service number below. **NO WARRANTY CLAIMS WILL BE CONSIDERED WITHOUT ORIGINAL PROOF OF PURCHASE.** Replacement as provided by this warranty is the exclusive remedy of the consumer and does not place the manufacturer liable for any incidental or consequential damages.

Contact the Customer Service Team at 1-855-434-6543 or visit www.homedepot.com.

Pre-Assembly

PLANNING ASSEMBLY

Compare all parts with the Package Contents list. If any part appears missing or damaged, do not assemble and use this product. Contact Customer Service.

PACKAGE CONTENTS

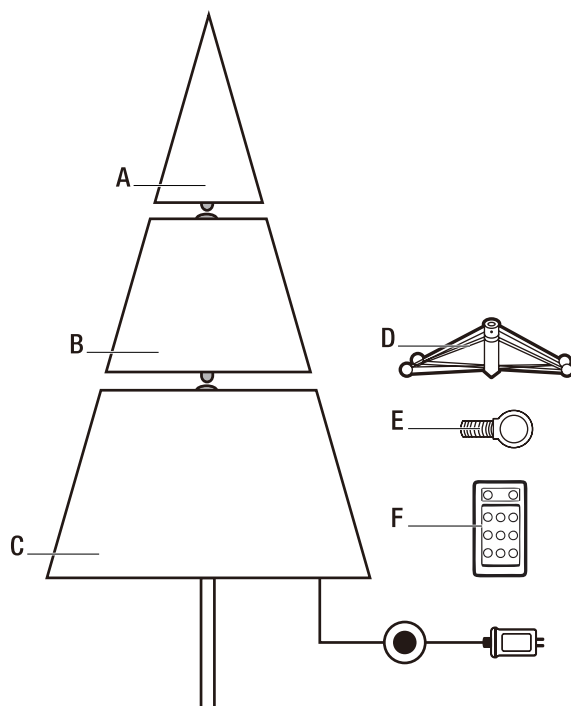

Part	Description	Quantity
A	Tree Section A	1
B	Tree Section B	1
C	Tree Section C (with plug)	1
D	Tree Stand	1
E	Eyebolt Screw	1
F	Remote Control	1

Installation

1 Preparing the tree and stand

- Lay each of the three tree sections gently on the ground in alphabetical order.
- Remove the plastic protective cap at the end of each pole. Save and re-use these protective caps when storing the tree.
- Open the metal stand (D) to form an "X" shape. Line up the holes on the tube of the stand.
- Thread the eyebolt screw (E) through the stand until you see or feel the end of the eyebolt flush with the inside of the tube.
- Locate the stand (D) on a stable and even space to ensure the stability of the tree.

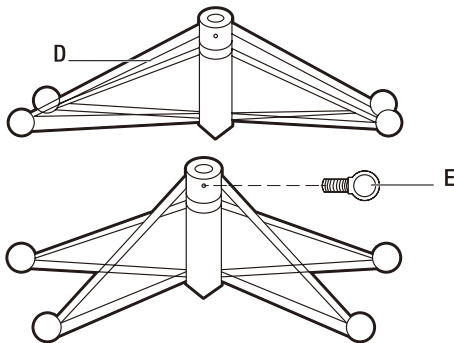

2 Assembling the tree

- Place tree section C firmly into the stand (D) and secure in place with the eyebolt (E). Ensure tree section C is standing straight in the stand.
- Insert tree section B into the top of tree section C, followed by tree section A.
- Shape the tree sections to create the desired appearance for your tree. For example, shape some tips downward and some tips upward to give shape to your tree and to fill in any gaps – giving your tree a fuller and fluffier appearance.

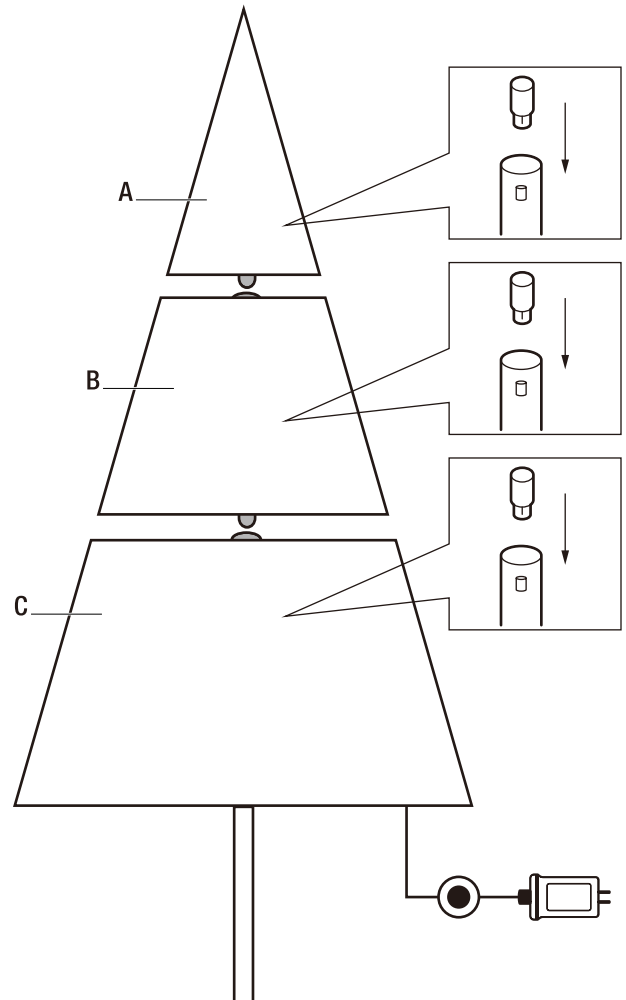

Operation

- To turn the lights on, simply plug the cord into an outlet.
- To operate the lights, you can either use the remote control or the foot pedal switch on the outlet cord:
 - To operate the lights using the foot pedal switch, press the foot pedal switch until it clicks. Press again to view the second lighting option and so on for all functions.

The available lighting options are:

- Steady Warm White
- Steady Multi
- Warm White to Multi
- Warm White & Multi Fading
- Warm White Glow
- Multi Glow
- Warm White Sparkle
- Multi Sparkle
- Demo/Repeat all 8 functions
- Off

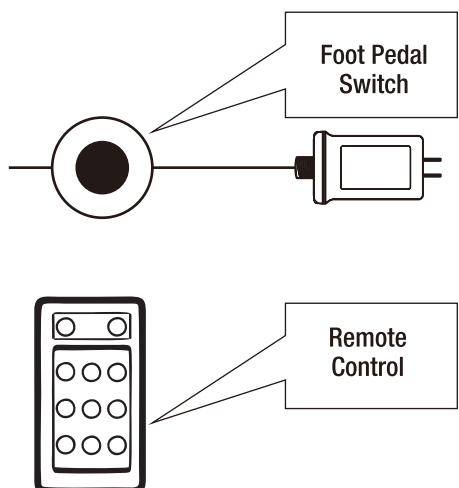

Care and Storage

- Before disassembling the tree, unplug the tree and remove all ornaments and decorations. When unplugging the tree, do not pull on the cord.
- Gently lift the tree top straight up to remove from the center section and fold all branches towards the pole. Repeat this step for the center and bottom tree sections.
- When storing the product, carefully remove the product from wherever it is placed, including tree, branches, or bushes, to avoid any undue strain or stress on the product conductors, connections, and wires.
- Use the protective caps to cover the poles to avoid damaging the internal parts.
- When not in use, store neatly in a cool, dry location protected from sunlight.
- Keep out of reach of pets and children.

Troubleshooting

Problem	Solution
The tree does not light when plugged in.	Check to ensure all tree sections are securely connected to each other. Press the On/Off button on either the remote control or the control box on the plug.



Questions, problems, missing parts? Before returning to the store,
call Home Accents Customer Service
8 a.m. - 7 p.m., EST, Monday-Friday, 9 a.m. - 6 p.m., EST, Saturday

1-855-434-6543

HOMEDEPOT.COM

Retain this manual for future use.