

If you have questions or comments, contact us.  
 Pour toute question ou tout commentaire, nous contacter.  
 Si tiene dudas o comentarios, contáctenos.

1-800-4-DEWALT • www.dewalt.com

INSTRUCTIVO DE OPERACIÓN, CENTROS DE SERVICIO Y PÓLIZA DE GARANTÍA. ADVERTENCIA: LEASE ESTE INSTRUCTIVO ANTES DE USAR EL PRODUCTO.

INSTRUCTION MANUAL  
 GUIDE D'UTILISATION  
 MANUAL DE INSTRUCCIONES

# DEWALT®

DWC860W Heavy-Duty 4-3/8" (110 mm) Wet/Dry Masonry Saw  
 Scie industrielle à maçonnerie à sec/à l'eau DWC860W de 110 mm (4-3/8 po)  
 Sierra industrial de 110 mm (4-3/8 pulg.) de corte húmedo o seco para mampostería DWC860W

DeWALT Industrial Tool Co., 701 Joppa Road, Baltimore, MD 21286  
 (JUN10) Part No. N073473 DWC860W Copyright © 2010 DeWALT

The following are trademarks for one or more DeWALT power tools: the yellow and black color scheme; the "D" shaped air intake grill; the array of pyramids on the handgrip; the kit box configuration; and the array of lozenge-shaped humps on the surface of the tool.

### Definitions: Safety Guidelines

The definitions below describe the level of severity for each signal word. Please read the manual and pay attention to these symbols.

**⚠ DANGER:** Indicates an imminently hazardous situation which, if not avoided, will result in **death or serious injury**.

**⚠ WARNING:** Indicates a potentially hazardous situation which, if not avoided, could result in **death or serious injury**.

**⚠ CAUTION:** Indicates a potentially hazardous situation which, if not avoided, may result in **minor or moderate injury**.

**NOTICE:** Indicates a practice **not related to personal injury** which, if not avoided, may result in **property damage**.

IF YOU HAVE ANY QUESTIONS OR COMMENTS ABOUT THIS OR ANY DeWALT TOOL, CALL US TOLL FREE AT: 1-800-4-DEWALT (1-800-433-9258).

 **WARNING:** To reduce the risk of injury, read the instruction manual.

### General Power Tool Safety Warnings

 **WARNING!** Read all safety warnings and instructions. Failure to follow the warnings and instructions may result in electric shock, fire and/or serious injury.

### SAVE THESE INSTRUCTIONS

#### WORK AREA

- **Keep your work area clean and well lit.** Cluttered benches and dark areas invite accidents.
- **Do not operate power tools in explosive atmospheres, such as in the presence of flammable liquids, gases, or dust.** Power tools create sparks which may ignite the dust or fumes.
- **Keep bystanders, children, and visitors away while operating a power tool.** Distractions can cause you to lose control.

#### ELECTRICAL SAFETY

- **Double insulated tools are equipped with a polarized plug (one blade is wider than the other.) This plug will fit in a polarized outlet only one way. If the plug does not fit fully in the outlet, reverse the plug. If it still does not fit, contact a qualified electrician to install a polarized outlet. Do not change the plug in any way.** Double insulation  eliminates the need for the three wire grounded power cord and grounded power supply system.
- **Avoid body contact with grounded surfaces such as pipes, radiators, ranges and refrigerators.** There is an increased risk of electric shock if your body is grounded.
- **Don't expose power tools to rain or wet conditions.** Water entering a power tool will increase the risk of electric shock.
- **Do not abuse the cord. Never use the cord to carry the tools or pull the plug from an outlet. Keep cord away from heat, oil, sharp edges or moving parts. Replace damaged cords immediately.** Damaged cords increase the risk of electric shock.
- **When operating a power tool outside, use an outdoor extension cord marked "W-A" or "W."** These cords are rated for outdoor use and reduce the risk of electric shock. When using an extension cord, be sure to use one heavy enough to carry the current your product will draw. An undersized cord will cause a drop in line voltage resulting in loss of power and overheating. The following table shows the correct size to use depending on cord length and nameplate ampere rating. If in doubt, use the next heavier gage. The smaller the gage number, the heavier the cord.

Minimum Gauge for Cord Sets						
Ampere Rating		Volts	Total Length of Cord in Feet (meters)			
		120V	25 (7.6)	50 (15.2)	100 (30.5)	150 (45.7)
More Than	Not More Than	240V	50 (15.2)	100 (30.5)	200 (61.0)	300 (91.4)
<b>AWG</b>						
0	6		18	16	16	14
6	10		18	16	14	12
10	12		16	16	14	12
12	16		14	12	Not Recommended	

#### PERSONAL SAFETY

- **Stay alert, watch what you are doing and use common sense when operating a power tool. Do not use tool while tired or under the influence of drugs, alcohol, or medication.** A moment of inattention while operating power tools may result in serious personal injury.
- **Dress properly. Do not wear loose clothing or jewelry. Contain long hair. Keep your hair, clothing, and gloves away from moving parts.** Loose clothing, jewelry, or long hair can be caught in moving parts. Air vents often cover moving parts and should also be avoided.
- **Avoid accidental starting. Be sure switch is off before plugging in.** Carrying tools with your finger on the switch or plugging in tools that have the switch on invites accidents.
- **Remove adjusting keys or wrenches before turning the tool on.** A wrench or a key that is left attached to a rotating part of the tool may result in personal injury.
- **Do not overreach. Keep proper footing and balance at all times.** Proper footing and balance enables better control of the tool in unexpected situations.
- **Use safety equipment. Always wear eye protection.** Dust mask, non-skid safety shoes, hard hat, or hearing protection must be used for appropriate conditions.

#### TOOL USE AND CARE

- **Use clamps or other practical way to secure and support the workpiece to a stable platform.** Holding the work by hand or against your body is unstable and may lead to loss of control.
- **Do not force tool. Use the correct tool for your application.** The correct tool will do the job better and safer at the rate for which it is designed.
- **Do not use tool if switch does not turn it on or off.** Any tool that cannot be controlled with the switch is dangerous and must be repaired.
- **Disconnect the plug from the power source before making any adjustments, changing accessories, or storing the tool.** Such preventative safety measures reduce the risk of starting the tool accidentally.
- **Store idle tools out of reach of children and other untrained persons.** Tools are dangerous in the hands of untrained users.
- **Maintain tools with care. Keep cutting tools sharp and clean.** Properly maintained tools, with sharp cutting edges are less likely to bind and are easier to control.
- **Check for misalignment or binding of moving parts, breakage of parts, and any other condition that may affect the tool's operation. If damaged, have the tool serviced before using.** Many accidents are caused by poorly maintained tools.
- **Use only accessories that are recommended by the manufacturer for your model.** Accessories that may be suitable for one tool, may become hazardous when used on another tool.

#### SERVICE

- **Tool service must be performed only by qualified repair personnel.** Service or maintenance performed by unqualified personnel could result in a risk of injury.
- **When servicing a tool, use only identical replacement parts. Follow instructions in the Maintenance section of this manual.** Use of unauthorized parts or failure to follow maintenance instructions may create a risk of electric shock or injury.

#### Additional Specific Safety Instructions for Masonry Saws

- **DANGER! Keep hands away from cutting area and blade. Keep your second hand on auxiliary handle or motor housing.** If both hands are holding the saw, they cannot be cut by the blade.
- **Do not reach underneath the workpiece.** The guard cannot protect you from the blade below the workpiece
- **Never hold piece being cut in your hands or across your leg. Secure the workpiece to a stable platform.** It is important to support the work properly to minimize body exposure, blade binding, or loss of control.
- **Hold tool by insulated gripping surfaces when performing an operation where the cutting tool may contact hidden wiring or its own cord.** Contact with a "live" wire will also make exposed metal parts of the power tool "live" and shock the operator.
- **Always use blades with correct size and shape (diamond versus round) of arbor holes.** Blades that do not match the mounting hardware of the saw will run eccentrically, causing loss of control.
- **Never use damaged or incorrect blade washers or bolt.** The blade washers and bolt were specially designed for your saw, for optimum performance and safety of operation.
- **Keep your body positioned to either side of the blade, but not in line with the saw blade.**
- **Blades coast after turn off.** Serious personal injury may result.
- **Don't unplug if plug or receptacle is wet.** Disconnect the fuse or circuit breaker that supplies power to the tool. Then unplug and examine for presence of water in the receptacle.
- **Wait for the saw to come to a complete stop.** An unprotected, coasting blade will cause the saw to walk backwards, cutting whatever is in its path. Be aware of the time it takes for the blade to stop after switch is released.
- **Do not use to cut wood or metal.**
- **Never use toothed blades.** This tool is not equipped with a lower guard.

**⚠ DANGER:** Keep hands away from cutting area and blade. Personal injury may result.

**⚠ WARNING:** Always plug extension cord into a GFCI protected outlet.

**⚠ WARNING:** To reduce the risk of electrocution, keep all connections dry and off the ground. Do not touch plug with wet hands.

**⚠ WARNING:** A Ground Fault Circuit Interrupter (GFCI) is provided on the cord set. Receptacles are available having built in GFCI protection and may be used for an added measure of safety. When using an extension cord, always plug into a GFCI protected receptacle or outlet.

**⚠ WARNING:** Test GFCI before each use:

1. Plug GFCI into power outlet. Indicator should turn red.
2. Press test button. Red indicator should disappear.
3. Press reset button for use. Do not use if above test fails.

**⚠ WARNING:** Never use saw with salt water or a conductive fluid.

**⚠ WARNING: DO NOT use wet cutting when using bonded abrasive blades.** Wheel rupture and personal injury may result.

**⚠ WARNING:** Some dust created by power sanding, sawing, grinding, drilling, and other construction activities contains chemicals known in the state of California to cause cancer, birth defects or other reproductive harm. Some examples of these chemicals are:

- lead from lead-based paints,
- crystalline silica from bricks and cement and other masonry products, and
- arsenic and chromium from chemically-treated lumber (CCA).

Your risk from these exposures varies, depending on how often you do this type of work. To reduce your exposure to these chemicals: work in a well ventilated area, and work with approved safety equipment, such as those dust masks that are specially designed to filter out microscopic particles.

- **Avoid prolonged contact with dust from power sanding, sawing, grinding, drilling, and other construction activities. Wear protective clothing and wash exposed areas with soap and water.** Allowing dust to get into your mouth, eyes, or lay on the skin may promote absorption of harmful chemicals.

**⚠ WARNING:** Use of this tool can generate and/or disburse dust, which may cause serious and permanent respiratory or other injury. Always use NIOSH/OSHA approved respiratory protection appropriate for the dust exposure. Direct particles away from face and body. Always operate tool in well-ventilated area and provide for proper dust removal. Use dust collection system wherever possible.

**⚠ WARNING: ALWAYS wear proper personal hearing protection during use.** Under some conditions and duration of use, noise from this product may contribute to hearing loss.

**⚠ WARNING: ALWAYS use eye protection.** All users and bystanders must wear eye protection that conforms to ANSI Z87.1.

The label on your tool may include the following symbols. The symbols and their definitions are as follows:

V..... volts	A ..... amperes
Hz..... hertz	W ..... watts
min ..... minutes	~ ..... alternating current
== ..... direct current	~ ..... alternating or direct current
Ⓛ ..... Class I Construction (grounded)	n <sub>o</sub> ..... no load speed
Ⓜ ..... Class II Construction (double insulated)	⊕ ..... earthing terminal
BPM..... beats per minute	▲ ..... safety alert symbol
RPM..... revolutions per minute	.../min ..... per minute
	IPM ..... impacts per minute



## COMPONENTS (Fig. 1)

- |                                     |                          |
|-------------------------------------|--------------------------|
| A. GFCI on cord set                 | M. Depth adjustment knob |
| B. On/Off Switch                    | N. Shoe                  |
| C. Lock-On button                   | O. Water valve lever     |
| D. Diamond blade                    | P. Cutting guide         |
| E. External flange                  | Q. Bevel adjustment knob |
| F. Clamping screw                   | R. Brush covers          |
| G. Water tubing                     | S. Brush assembly        |
| H. Tool inlet                       | T. Front handle          |
| I. Water tubing adapter             | U. Main handle           |
| J. Water pressure regulator (5 psi) | V. Flange wrench         |
| K. Screw                            | W. T-handle wrench       |
| L. Water nozzle                     |                          |

## ASSEMBLY

### Switch (Fig. 1, 2)

**▲ WARNING:** To avoid the possibility of the appliance plug or receptacle getting wet, position the saw to one side of a wall mounted receptacle to prevent water from dipping onto the receptacle or plug. The user should arrange a "drip loop" in the cord connecting the saw to a receptacle (Fig. 2). The "drip loop" is that part of the cord below the level of the receptacle, or the connector if an extension cord is used, to prevent water traveling along the cord and coming in contact with the receptacle.

**▲ CAUTION:** Before plugging in tool, always check to see that the switch actuates properly and returns to the OFF position when released.

1. Depress and hold the switch (B) to start operation.
2. For continuous operation, press the lock-on button (C) and release the switch. To disengage the locking button, depress then release the switch.

### To Install the Diamond Blade (Fig. 1, 3)

1. Place saw on a stable surface.
2. Place blade (D) on spindle.
3. Using the flange wrench (V) provided, hold the external flange (E)
4. Turn the clamping screw (F) counterclockwise to tighten. Use the T-handle wrench (W) provided to secure tightly.
5. To remove the blade, reverse this procedure.

### Mounting the Wet Cut System (Fig. 1)

**▲ WARNING:** Do not use wet cut system unless tool is protected by a GFCI.

This system minimizes airborne dust particles while improving cutting quality and blade life.

1. Loosen the depth adjustment knob (M) and pull shoe (N) to its minimum depth of cut position.
2. Using a screwdriver, remove the screw (K) located next to the depth adjustment knob mounted to the casting.
3. Position the water valve assembly such that the hole in the water valve assembly aligns with the screw hole located in the casting and the forked water valve (L) straddles the blade.
4. Secure in place with screw. DO NOT overtighten the screw; this could damage the water valve assembly.

### Water Valve Assembly (Fig. 1)

**▲ WARNING:** Never use water valve assembly without a properly functioning pressure regulator. This could cause damage to the water tubing if excessive pressure builds up.

1. Never use the saw over head. When using water, limit cutting to the horizontal position to reduce the risk of water entering the tool.
2. Prior to using the tool with the water valve assembly, inspect water tubing (G) for holes cracks or other damage. Replace with identical replacement parts if a potential weakened or damaged area is found. Check connections at the tool inlet (H), water valve and adapter (I) for leaks. If the connection is loose or the tubing is relaxed around barbs, disconnect tubing, trim tubing back approximately 1" (25.4 mm), then reconnect tubing. Ensure that tubing is pushed all the way past the barb(s). Check to ensure tight connection.
3. When using the water kit, always use the water pressure regulator (J) provided. Firmly attach the regulator to the water source, but do not overtighten. Be sure to use the filter washer (inside regulator intake end) to prevent contaminants from clogging water jet ports. If regulator is lost or damaged, replace with identical replacement parts.

### Use of Extension Cords

- Always plug extension cord into a GFCI receptacle.
- Use only extension cords that are intended for outdoor use. These extension cords are identified by a marking "Acceptable for use with outdoor appliance; store indoors while not in use."
- Use only extension cords having an electrical rating not less than the rating of the product.
- Do not use damaged extension cords. Examine extension cord before using and replace if damaged.
- Do not abuse extension cords and do not yank on any cord to disconnect.

### Motor

Be sure your power supply agrees with the nameplate marking. Voltage decrease of more than 10% will cause loss of power and overheating. All DEWALT tools are factory tested; if this tool does not operate, check the power supply.

- Keep cord away from heat and sharp edges.
- Always disconnect the extension cord from the receptacle before disconnecting the product from the extension cord.

## OPERATION

**▲ WARNING:** Use the appropriate blade. Do not use cracked, damaged or excessively worn blades. Do not use to cut wood or metal.

**▲ CAUTION:** Wait for the blade to reach the maximum speed and use a slow even feed for proper cutting.

**▲ CAUTION:** The DW860W should only be used on horizontal surfaces (see **Water Valve Assembly**).

**▲ CAUTION:** Use clamps or other practical way to secure and support the workpiece to a stable platform. Holding the work by hand or against your body is unstable and may lead to loss of control.

### Proper Hand Position (Fig. 8)

**▲ WARNING:** To reduce the risk of serious personal injury, Always use proper hand position as shown.

**▲ WARNING:** To reduce the risk of serious personal injury, always hold securely in anticipation of a sudden reaction.

Proper hand position requires one hand on the main handle (U) and the other hand on the front handle (T) as shown.

**NOTE:** Figure 8 shows the proper hand position for a left-handed person. For a right-handed person, reverse the hand positions.

### Depth of Cut Adjustment (Fig. 4)

1. Loosen the depth adjustment knob (M) to release.
2. Move the shoe (N) up or down to desired position.
3. Tighten the depth adjustment knob.

### WET CUT METHOD (FIG. 1, 4)

**▲ WARNING:** Do not use wet cut system unless tool is protected by the GFCI.

**▲ WARNING:** To reduce the risk of electric shock, ensure water will not enter into your tool. Do not touch plug with wet hands.

1. Follow the instructions described under **Mounting the Wet Cut System**.
2. To regulate the water flow, open the water valve by pivoting the lever (O) away from the unit.
3. To close water valve, push the lever toward the unit.
3. Proceed as described below for straight or angled cuts.

### STRAIGHT CUTS (FIG. 1)

1. Using a marker or grease pencil, mark the area to be cut.
2. Place the shoe of the saw on the workpiece ensuring that the blade does not touch the workpiece.
3. Align the external part of the cutting guide (P) with the cut outline on the workpiece.
4. Turn the tool on and wait for the blade to reach its maximum velocity.

FIG. 1

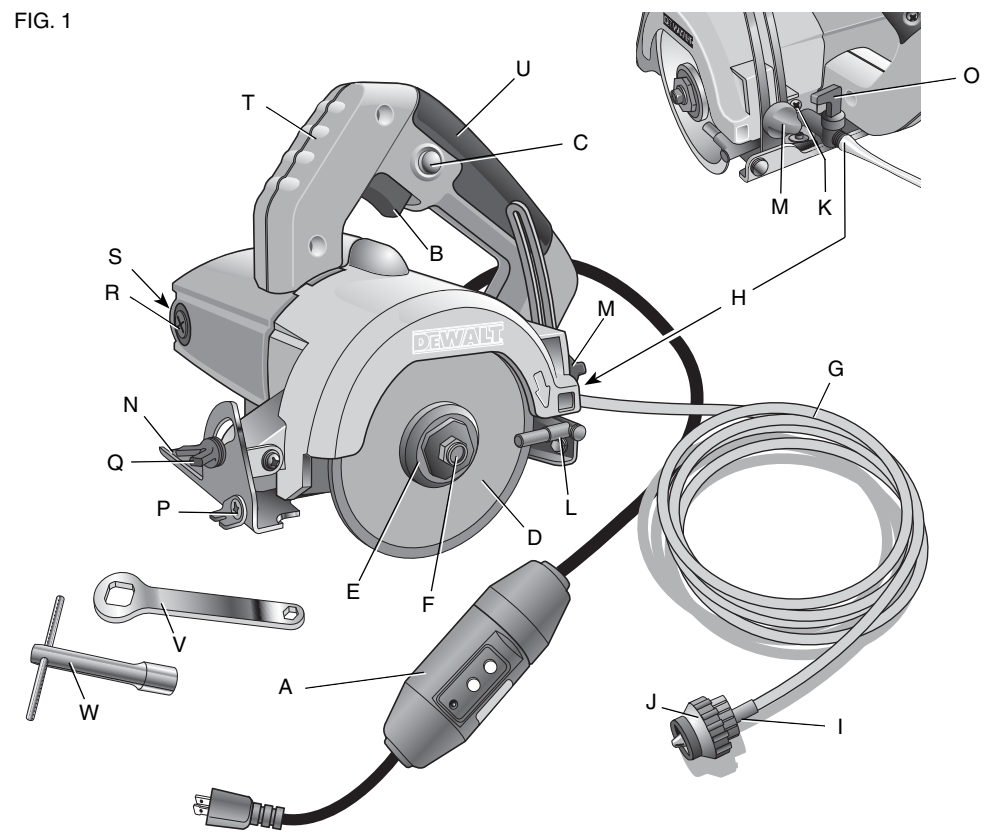

FIG. 2

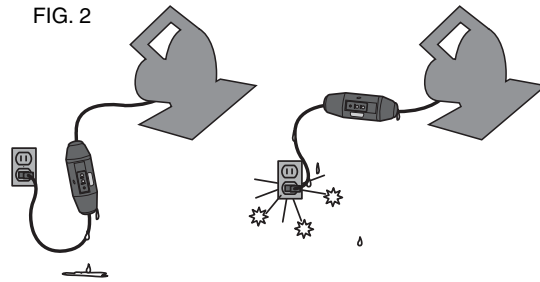

FIG. 3

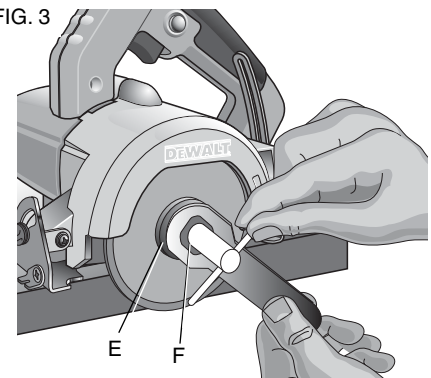

FIG. 4

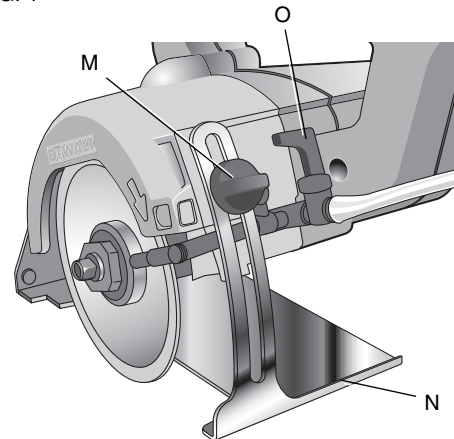

FIG. 5

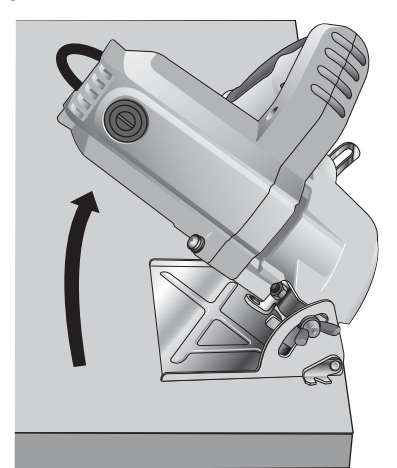

FIG. 6

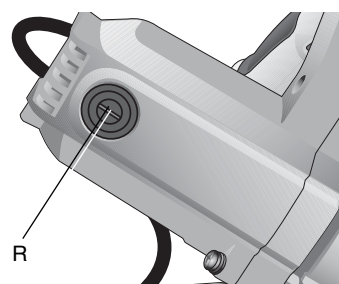

FIG. 7

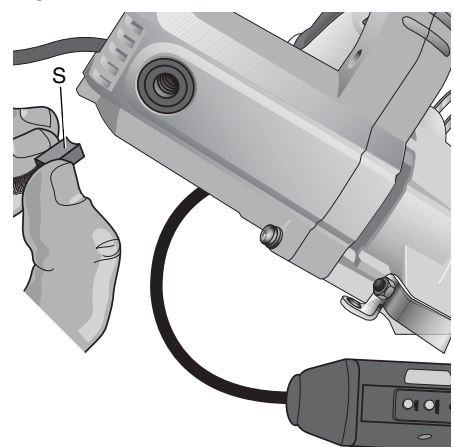
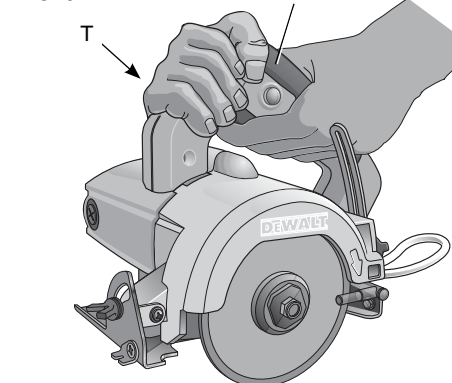

FIG. 8



5. Move the tool slowly and evenly forward, following the cut line.

### ANGLED CUTS (FIG. 1, 5)

1. Using a marker or grease pencil, mark the area to be cut.
2. Release the bevel adjustment knob (Q) and move it to the desired angle.
3. After selecting the desired angle, tighten the knob to secure the shoe.
4. Align the internal part of the cutting guide (P) with the cut line on the workpiece.
5. Turn the tool on and wait for the blade to reach its maximum velocity.
6. Move the tool slowly and evenly forward, following the cut line.

## MAINTENANCE

**▲ WARNING:** To reduce the risk of serious personal injury, turn tool off and disconnect tool from power source before making any adjustments or removing/installing attachments or accessories.

### Cleaning

**▲ WARNING:** Never use solvents or other harsh chemicals for cleaning the non-metallic parts of the tool. These chemicals may weaken the plastic materials used in these parts. Use a cloth dampened only with water and mild soap. Never let any liquid get inside the tool; never immerse any part of the tool into a liquid.

### Brushes (Fig. 6, 7)

**▲ WARNING:** To reduce the risk of serious personal injury, turn tool off and disconnect tool from power source before making any adjustments or removing/installing attachments or accessories.









## Póliza de Garantía

### IDENTIFICACIÓN DEL PRODUCTO:

Sello o firma del Distribuidor.

Nombre del producto: \_\_\_\_\_ Mod./Cat.: \_\_\_\_\_

Marca: \_\_\_\_\_ Núm. de serie: \_\_\_\_\_

(Datos para ser llenados por el distribuidor)

Fecha de compra y/o entrega del producto: \_\_\_\_\_

Nombre y domicilio del distribuidor donde se adquirió el producto: \_\_\_\_\_

Este producto está garantizado por un año a partir de la fecha de entrega, contra cualquier defecto en su funcionamiento, así como en materiales y mano de obra empleados para su fabricación. Nuestra garantía incluye la reparación o reposición del producto y/o componentes sin cargo alguno para el cliente, incluyendo mano de obra, así como los gastos de transportación razonablemente erogados derivados del cumplimiento de este certificado.

Para hacer efectiva esta garantía deberá presentar su herramienta y esta póliza sellada por el establecimiento comercial donde se adquirió el producto, de no contar con ésta, bastará la factura de compra.

### EXCEPCIONES

Esta garantía no será válida en los siguientes casos:

- Cuando el producto se hubiese utilizado en condiciones distintas a las normales;
- Cuando el producto no hubiese sido operado de acuerdo con el instructivo de uso que se acompaña;
- Cuando el producto hubiese sido alterado o reparado por personas distintas a las enlistadas al final de este certificado.

Anexo encontrará una relación de sucursales de servicio de fábrica, centros de servicio autorizados y franquiciados en la República Mexicana, donde podrá hacer efectiva su garantía y adquirir partes, refacciones y accesorios originales.

### Garantía limitada por tres años

DeWALT reparará, sin cargo, cualquier falla que surja de defectos en el material o la fabricación del producto, por hasta tres años a contar de la fecha de compra. Esta garantía no cubre fallas de las piezas causadas por su desgaste normal o abuso a la herramienta. Para mayores detalles sobre la cobertura de la garantía e información acerca de reparaciones realizadas bajo garantía, visítenos en [www.dewalt.com](http://www.dewalt.com) o dirígase al centro de servicio más cercano. Esta garantía no aplica a accesorios o a daños causados por reparaciones realizadas o intentadas por terceros. Esta garantía le otorga derechos legales específicos, además de los cuales puede tener otros dependiendo del estado o la provincia en que se encuentre.

Además de la garantía, las herramientas DeWALT están cubiertas por:

#### 1 AÑO DE SERVICIO GRATUITO

DeWALT mantendrá la herramienta y reemplazará las piezas gastadas por su uso normal, sin cobro, en cualquier momento durante un año a contar de la fecha de compra. Los artículos gastados por la clavadora, tales como la unidad de hoja y retorno del impulsador, no están cubiertas.

#### GARANTÍA DE REEMBOLSO DE SU DINERO POR 90 DÍAS

Si no está completamente satisfecho con el desempeño de su máquina herramienta, láser o clavadora DeWALT, cualquiera sea el motivo, podrá devolverlo hasta 90 días de la fecha de compra con su recibo y obtener el reembolso completo de su dinero – sin necesidad de responder a ninguna pregunta.

**AMÉRICA LATINA:** Esta garantía no se aplica a los productos que se venden en América Latina. Para los productos que se venden en América Latina, debe consultar la información de la garantía específica del país que viene en el empaque, llamar a la compañía local o visitar el sitio Web a fin de obtener esa información.

**REEMPLAZO GRATUITO DE LAS ETIQUETAS DE ADVERTENCIAS:** Si sus etiquetas de advertencia se vuelven ilegibles o faltan, llame al 1-800-4-DeWALT para que se le reemplacen gratuitamente.

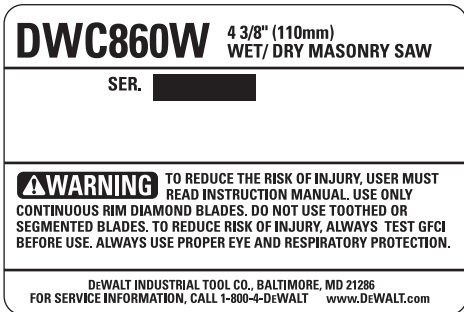

### ESPECIFICACIONES

#### DWC860W

Tensión de alimentación:	120 V AC ~
Consumo de corriente:	10,8 A
Frecuencia de alimentación:	60 Hz
Potencia nominal:	1 300 W
Rotación sin carga:	13 000/min

SOLAMENTE PARA PROPÓSITO DE MÉXICO:  
IMPORTADO POR: DeWALT S.A. DE C.V.  
BOSQUES DE CIDROS, ACCESO RADIATAS NO.42  
3A. SECCIÓN DE BOSQUES DE LAS LOMAS  
DELEGACIÓN CUAJIMALPA,  
05120, MÉXICO, D.F.  
TEL. (52) 555-326-7100  
R.F.C.: BDE810626-1W7

Para servicio y ventas consulte  
"HERRAMIENTAS ELECTRICAS"  
en la sección amarilla.

