

CLOSETMAID® ShelfTrack Elite Combo Kit

Installation Tips

6 Ft. Dark Cherry Closet

33018

12/20



What you will need:

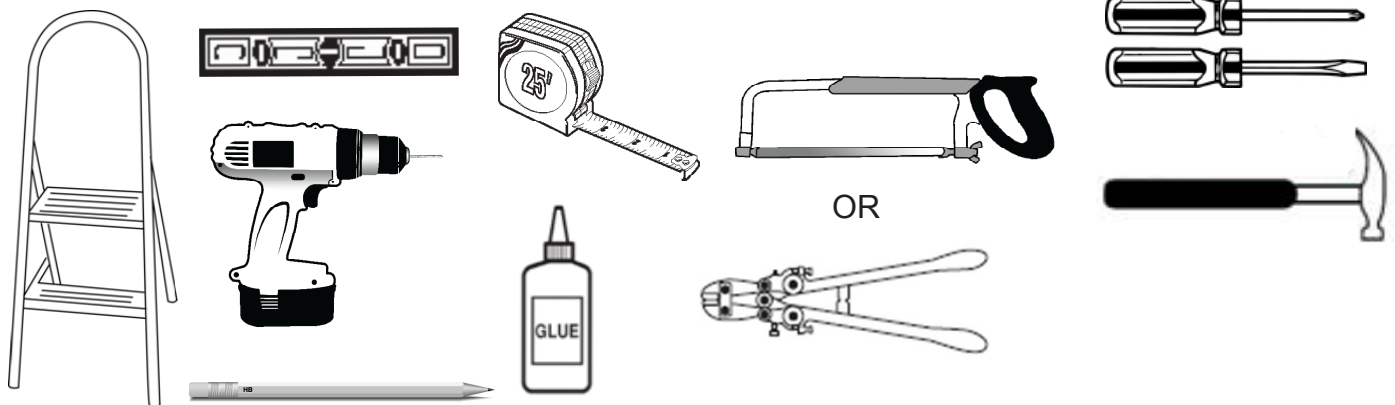

Installation Instructions

1. Use the Right Hardware

Select the hardware that is right for your wall type:

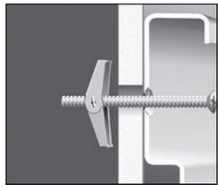

Drywall
Drill 1/2" holes and secure to the wall with toggle bolts.

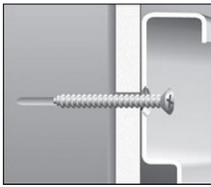

Studs
Secure to the wall with #12 x 2" pan head screws at stud locations.

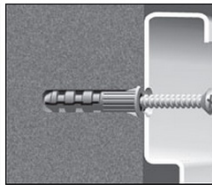

Concrete
Drill 1/4" holes. Insert #12 wall anchors and secure to the wall with #12 x 2" pan head screws.

2. Hang Track Location

Track can be installed at any height. However, for maximum adjustability and strongest installation, install Track flush to ceiling and screw into wood header behind wall board. Stud installation is recommended whenever possible for the strongest installation.

3. Determine Length and Spacing of Standards

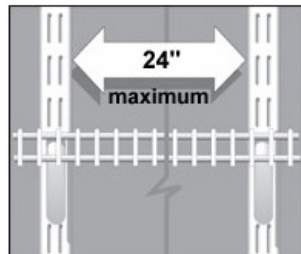

Standards are available in several lengths, depending on the number of shelves you want and the spacing between the shelves. The closer the Standards are placed together, the stronger the installation. Standards should be spaced no more than 24" apart, and no more than 4" from the end of the shelf.

4. Securing Standards



Each Standard must be secured to the wall with one screw at the closest hole to the center of the Standard. When using toggle bolts, remove toggle, put bolt through Standard and re-attach toggle to bolt before placing Standard on track.

5. Attaching Brackets

Attach brackets at desired shelf height.

Note: Always match bracket size to shelving depth except when using Shelf & Rod™ shelving. For this type of shelving, always use 12" brackets.

6. Cutting Shelving, Closet Rods, and Hang Tracks

Wire shelving can be cut using a bolt cutter or hacksaw. Closet Rods can be cut using a pipe cutter (recommended) or a hacksaw. Hang Tracks can be cut with a hacksaw.

7. Shelf Caps/Closet Rod Caps

Shelf Caps should be placed on the cut ends of shelving to protect clothing. Closet Rod Caps should be placed on the ends of Closet Rods to keep hangers in place.

7. Follow instructions for installation of ShelfTrack® Elite items

Included in product box. Instructions can also be found on HD.com.



Parts List



ShelfTrack Elite 8 in.
Deep Drawer



ShelfTrack Elite 3-Shelf
Kit Organizer



ShelfTrack 80 in.
Hang Track



ShelfTrack 30 in.
Standard



ShelfTrack Elite 2-Cube
Kit Organizer



6 ft. Wood Front Kit for
Wire Shelving



SuperSlide Closet
Rod Support



ShelfTrack 84 in.
Standard



Small End Caps for
Wire Shelving



SuperSlide Adjustable
Hang Rod 2-4 ft.



ShelfTrack 12 in.
Bracket



SuperSlide Closet Rod
End Caps



ShelfTrack Wall
Anchors (5 Pack)



SuperSlide 6 ft. W x 12
in. D Wire Shelf



ShelfTrack Mounting
Hardware (10 Pack)

