



INNOVATIONS FOR LIVING®

SOLSERENE 24" x 48" RECTANGLE ACOUSTICAL PANEL

PARTS LIST:

- Two (2) panels
- Six (6) Angled Impaling Clips (use three [3] per panel)
- Twelve (12) anchor screws

TOOL LIST:

- #2 Phillips screwdriver
- Level
- Painters tape (optional)
- 3/16" carbide tipped drill bit (for pre-drilling concrete, block, brick, or plaster)

CAUTION:

Clean, cut-resistant gloves should be worn as Angled Impaling Clips and anchor screws have sharp points.

MOUNTING:

- Determine the placement of the panel on the wall.
 - Tip: use painters tape to mark the wall.
- Attach recommended number of Angled Impaling Clips to wall, ensuring that they are at least three (3) inches away from all edges of panel.
 - Keep Angled Impaling Clips level to ensure the panel will engage all Angled Impaling Clips evenly.
- Position panel 5/8" above final placement position and lightly touching the points of the Angled Impaling Clips.
- With your hands placed flat on panel face, firmly push the panel down and toward the wall until it is firmly seated on the Angled Impaling Clips.
 - Position a wooden block on edge of panel and use a hammer to lightly tap for fine adjustment. If panel has to be adjusted up, remove and re-seat panel on clips, do not tap upwards.
- Inspect the edges of the panel where it meets the wall. The gap should be consistent around the entire perimeter of the panel.

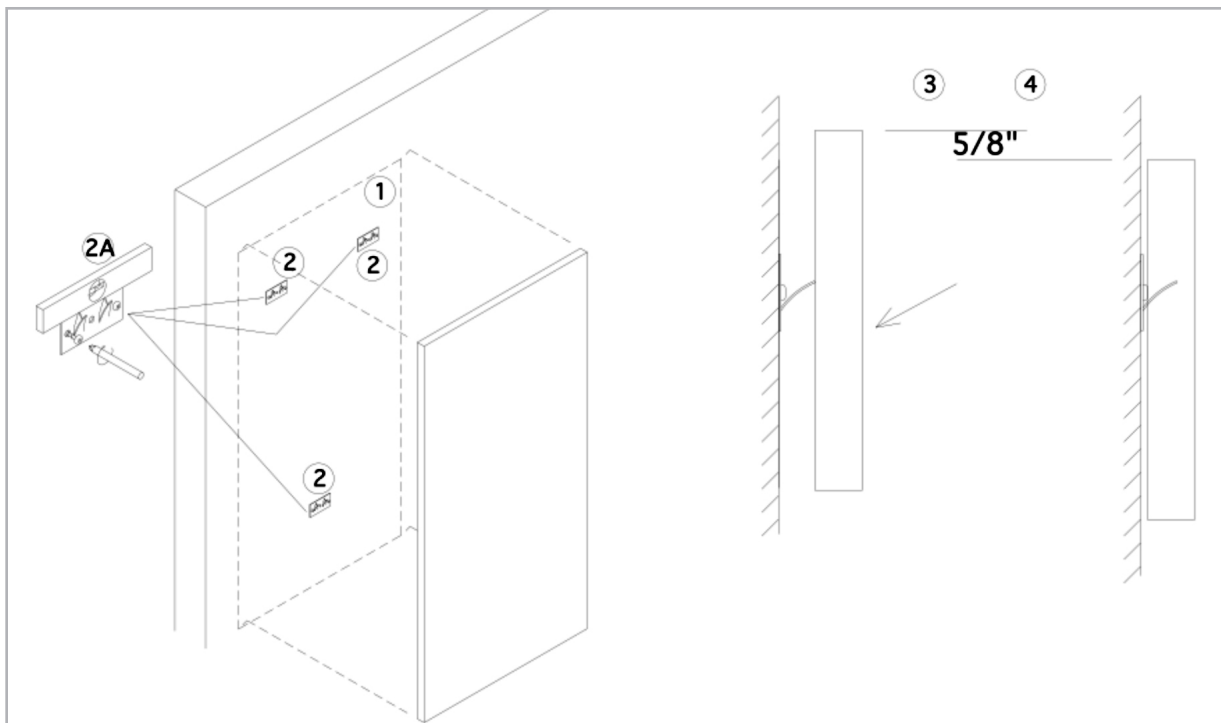

INNOVATIONS FOR LIVING®

CDC CORPORATION
800 Gustafson Road
Ladysmith, Wisconsin 54848

1-800-932-2383
www.occommercial.com

© 2014 Owens Corning. All Rights Reserved.

LEED is a registered trademark of U.S. Green Building Council.