

The logo features the word "Kraus" in a white, serif font with a registered trademark symbol (®) to the upper right. The letters are set against a dark, solid rectangular background.

INSTALLATION MANUAL

Zero-Radius Handmade Stainless Steel Kitchen Sinks (Pax™ and R0 PRO™ Series)

KHU15 & KHU15C / KHU19 & KHU19C / KHU23 &
KHU23C / KHU24L & KHU24CL / KHU29 & KHU29C
KHU32 & KHU32C / KHU322 & KHU322C

Thank you for your purchase

We would like to take this opportunity to thank you for choosing Kraus. We hope that you are completely satisfied with your purchase, and enjoy it for years to come. If you have any questions, or require technical assistance, please contact us at 800.775.0703 and one of our representatives will be happy to help.

For more information about Kraus products, please visit:

www.kraususa.com

In order to activate your warranty and get faster access to customer support, please register your new Kraus product at:

www.kraususa.com/registration

Sincerely,

Kraus USA Customer Service

Prior to Installation:

- Make sure that you have all necessary parts by checking the parts list. If any part is missing or damaged, please contact Kraus Customer Service at 800-775-0703 for a replacement
- Inspect the sink prior to installation to make sure that it has not been damaged or during shipping
- Use the cut-out template provided by Kraus
- Observe all plumbing and building codes according to your state requirements
- Not recommended to be installed with laminate countertop

For technical assistance or replacement parts, please contact Kraus Customer Service and one of our representatives will be happy to help:

Toll-Free: 800-775-0703 or Customerservice@kraususa.com

The step-by-step guidelines in the installation instructions are a general reference for installing a Kraus Sink. Should there be any discrepancies, Kraus cannot be held liable. It is recommended to install all Kraus products by hiring a licensed professional.

Tools you will need:



Safety Goggles



Drill

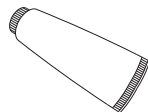

Silicone Adhesive

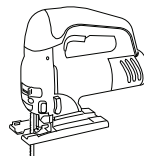

Jig Saw



Phillips Screwdriver



Putty Knife

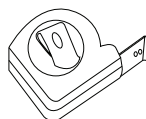

Tape Measure

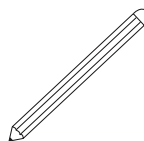

Pencil

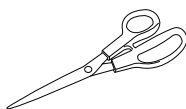

Scissors

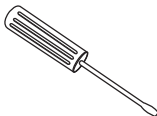

Screwdriver

NOTE: Specialized tools may be necessary to install Kraus Stainless Steel Undermount sinks with countertop materials other than wood, marble, or granite

Parts List

- Cut-Out Template
- Mounting Hardware
- Bottom Grids
- Drain
- Compatible with Kraus Exclusive garbage disposal adapter GDA-1 (not included with purchase)

NOTE: Bottom grids and drains are not included with C-series sinks

Dimensions

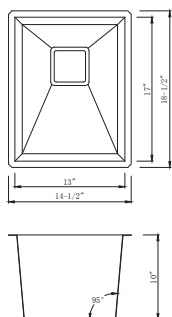

KHU15 & KHU15C
14.5" x 18.5" x 10"
Min Cabinet Size: 18"
Drain Model #: ST-3
Optional Drain#: GDA-1

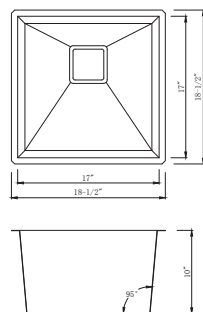

KHU19 & KHU19C
18.5" x 18.5" x 10"
Min Cabinet Size: 24"
Drain Model #: ST-3
Optional Drain#: GDA-1

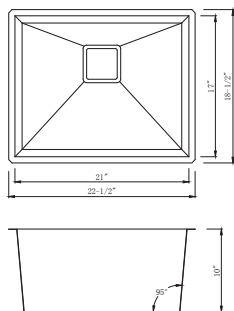

KHU23 & KHU23C
22.5" x 18.5" x 10"
Min Cabinet Size: 27"
Matching Grid: KBG-H23
Drain Model #: ST-3
Optional Drain#: GDA-1

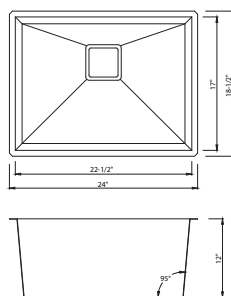

KHU24L & KHU24CL
24" x 18.5" x 12"
Min Cabinet Size: 27"
Drain Model #: ST-3
Optional Drain#: GDA-1

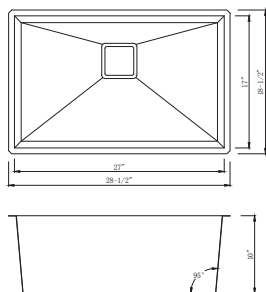

KHU29 & KHU29C

28.5" x 18.5" x 10"

Min Cabinet Size: 33"

Matching Grid: KBG-H29

Drain Model #: ST-3

Optional Drain#: GDA-1

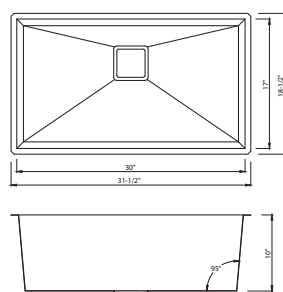

KHU32 & KHU32C

31.5" x 18.5" x 10"

Min Cabinet Size: 36"

Matching Grid: KBG-H32

Drain Model #: ST-3

Optional Drain#: GDA-1

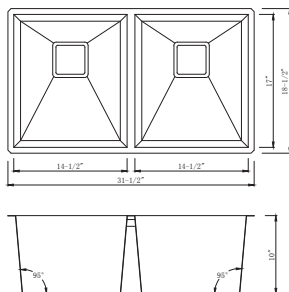

KHU322 & KHU322C

31.5" x 18.5" x 10"

Min Cabinet Size: 36"

Matching Grid: KBG-H322-1 & KBG-H322-2

Drain Model #: ST-3

Optional Drain#: GDA-1

1. Determine Reveal Type

Use scissors to cut along the line of the paper template for your desired reveal type (Negative, Positive, or Flushed Reveal)

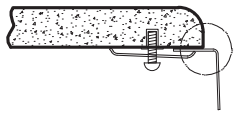

3/8" Positive Reveal

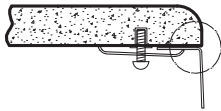

Flushed/Zero Reveal

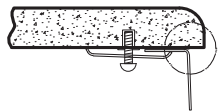

1/8" Negative Reveal

KRAUS Recommended Installation Type

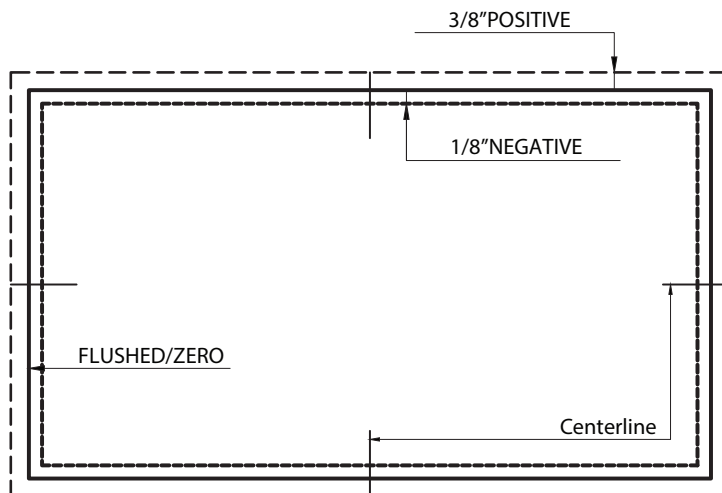

2. Position Template

- Check the cut-out template against the actual sink to ensure a proper sized cut-out
- Place the cut-out template in the desired location on the countertop

NOTE: Make sure clearance is suitable for backsplash, faucet, and plumbing for the sink

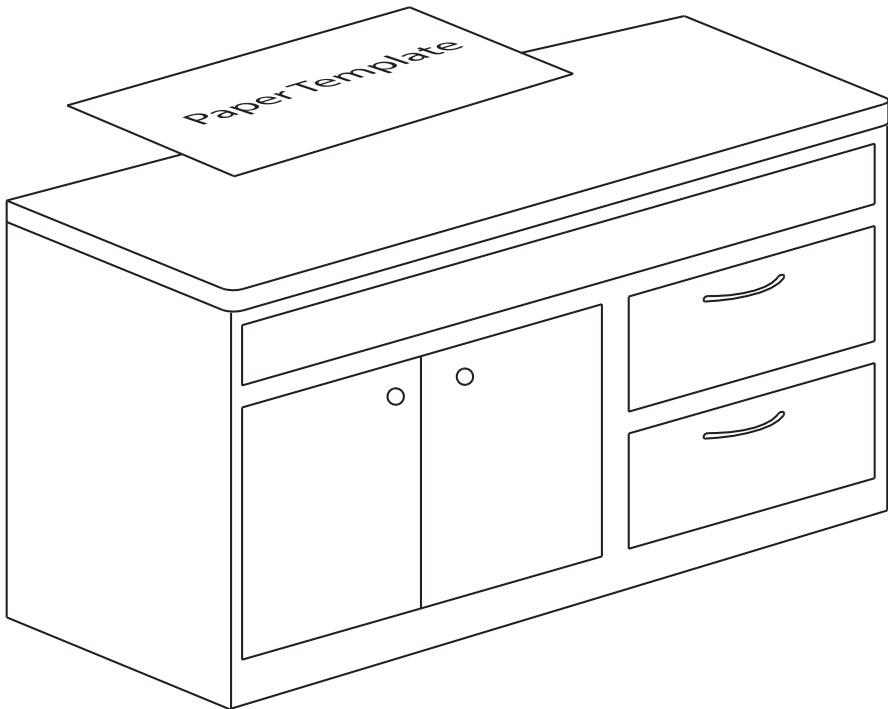

3. Trace Template

- Trace template on countertop with a pencil

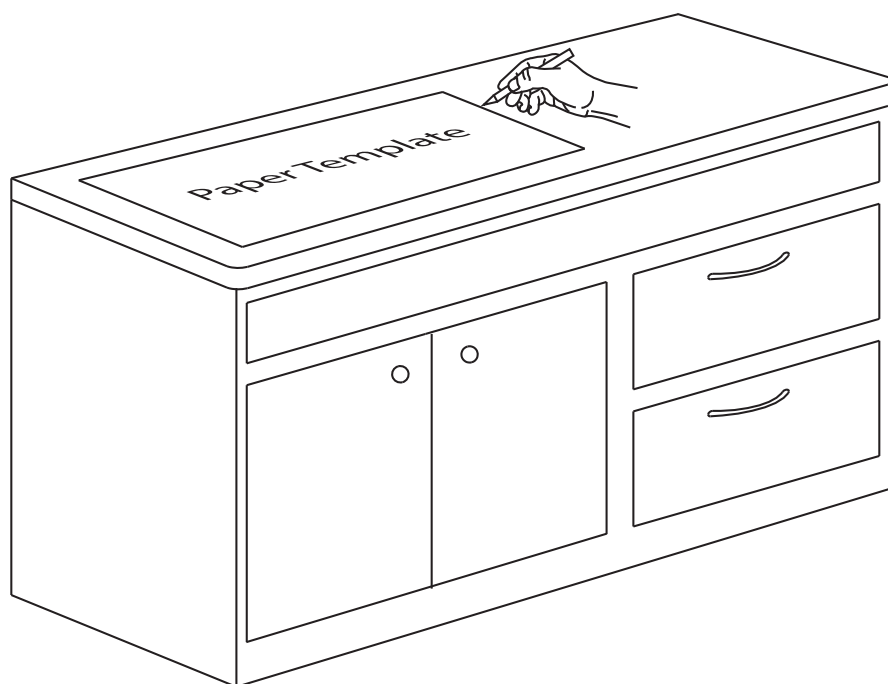

4. Cut Countertop

- Cut the opening in the countertop by carefully following the traced line

NOTE: Please use the appropriate saw that best fits your countertop material

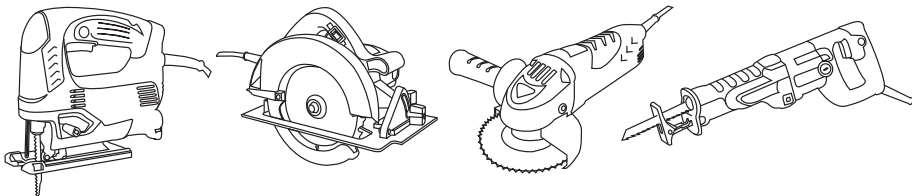
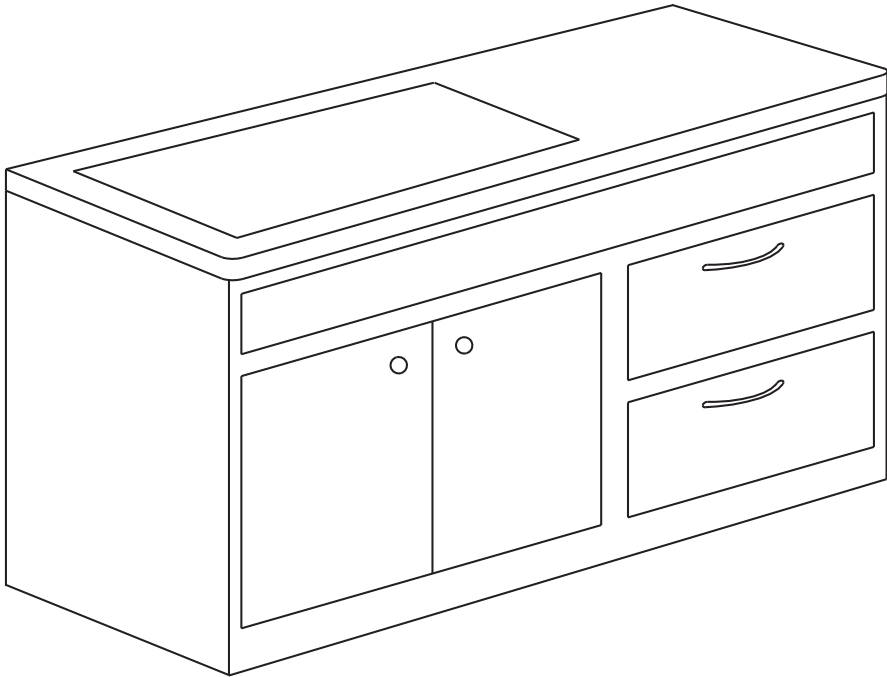

5. Set up Mounting Brackets

- Turn countertop over and align sink with countertop. Decide location for mounting brackets
- Mounting holes should be $\frac{1}{2}$ " from edge of sink

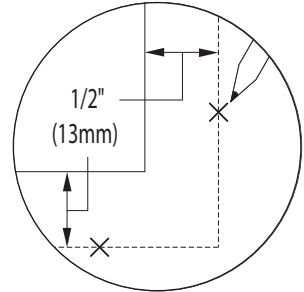
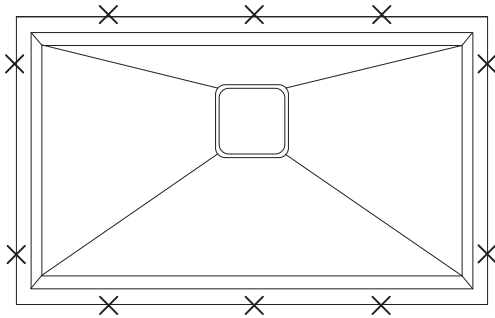

6. Drill Hole in Countertop

- Drill $\frac{3}{8}$ " diameter x $\frac{1}{2}$ " deep hole in the countertop

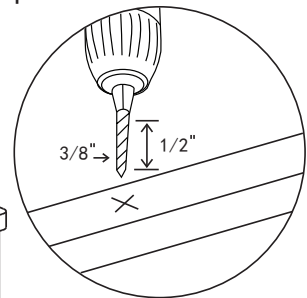
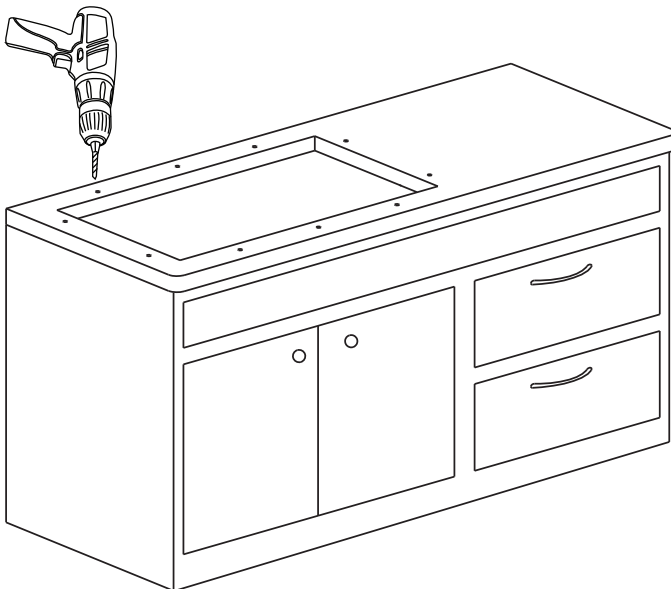

7. Install Anchors

- Insert anchors into drilled holes and lightly tap with a hammer until flush

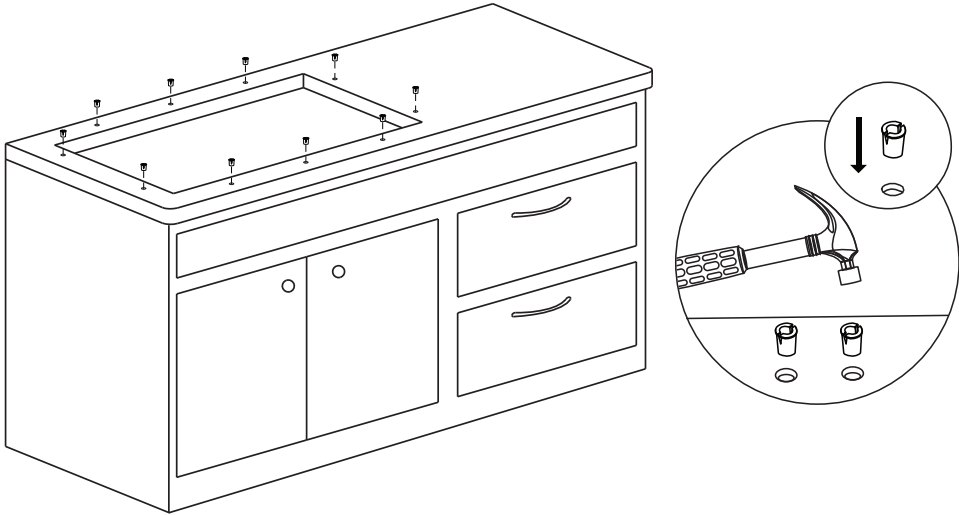

8. Secure Sink to Countertop

- Use a bead of silicone (or preferred adhesive) around the rim of the sink. Check the alignment of the sink to the cutout in the countertop. Place sink over cutout hole and press firmly

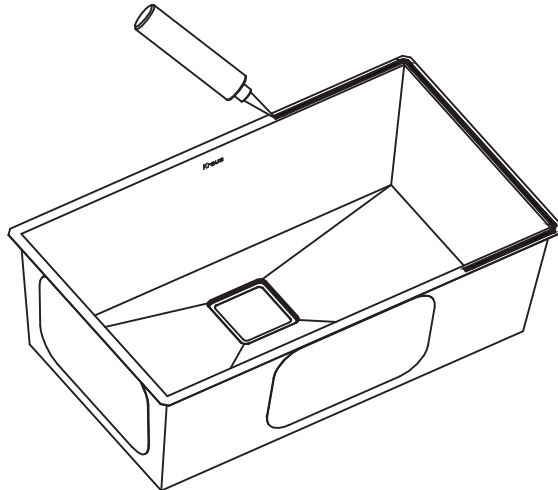

9. Attach Mounting Hardware

- Attach mounting hardware to secure bowl. Remove excess sealant from inside lip
- Allow sealant to set for 30 – 60 minutes

NOTE: Use acetone or rubbing alcohol to remove any excess sealant

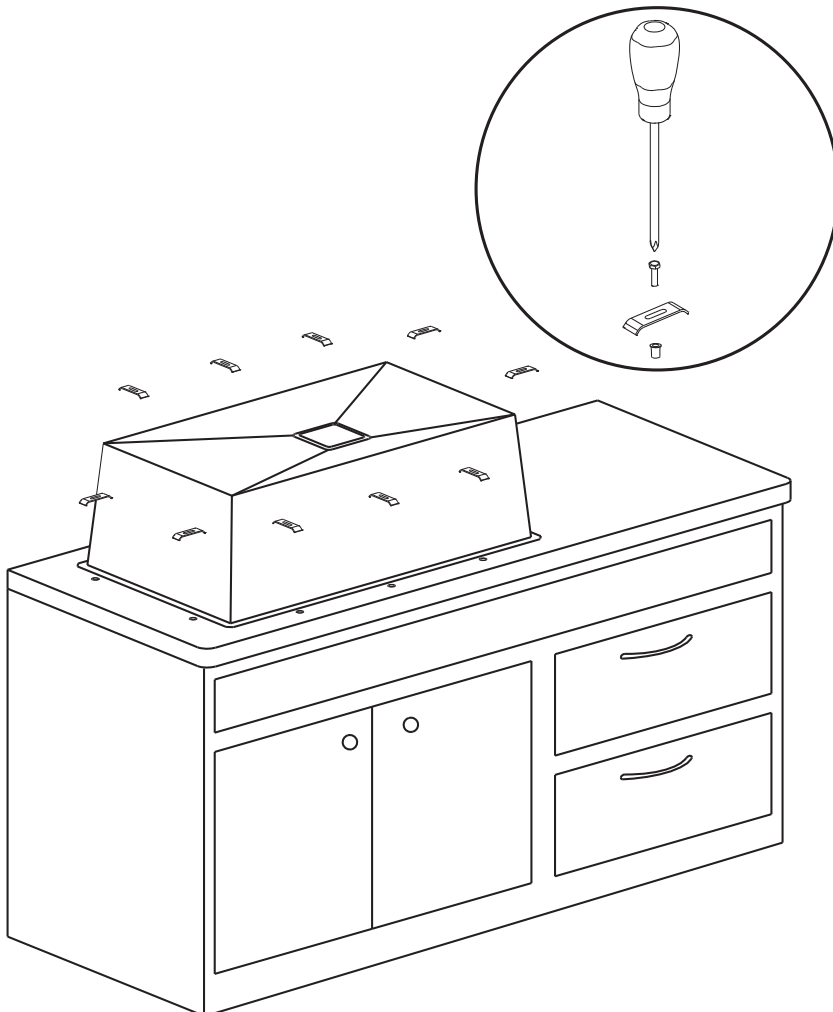

10. Install Plumbing Fixtures

- Connect drain to sink. Connect trap to drain. Connect water supply connections to faucet according to manufacturer's instructions
- Run water into sink and check for leaks

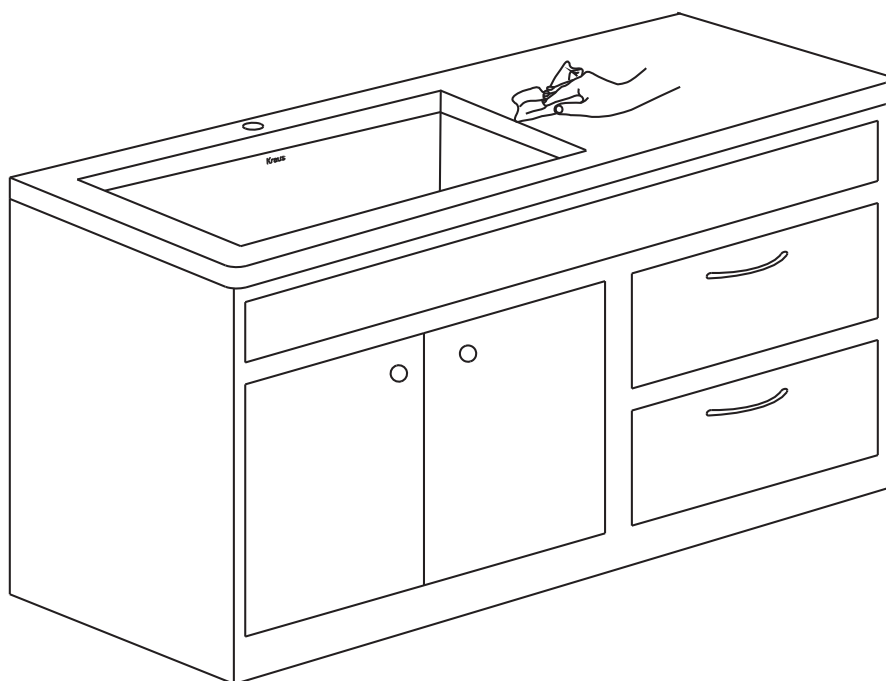

Codes/Standards Applicable:



HELP LINE

Our customer service hours are Monday – Friday, 9am – 8pm EST.
Be sure to visit our website at www.kraususa.com

If you are a HOMEOWNER please contact a Kraus Customer Service Representative at:

Kraus USA, Inc.
12 Harbor Park Drive
Port Washington, NY 11050
Toll-free 800-775-0703
Customerservice@kraususa.com

If you are a PLUMBING CONTRACTOR OR TRADE PROFESSIONAL please contact a Kraus Pro Representative at:

Kraus USA, Inc.
12 Harbor Park Drive
Port Washington, NY 11050
516-801-8955
Proservice@kraususa.com

If you are an AUTHORIZED PARTNER please contact a Partner Support Representative at:

Kraus USA, Inc.
12 Harbor Park Drive
Port Washington, NY 11050
516-801-8954
Partnersupport@kraususa.com

In requesting warranty service, please be ready to provide:

1. Proof of purchase.
2. A description of the problem.

REGISTER YOUR PRODUCT TODAY

Receive Proof of Ownership

Access Customer Care & Installation Help

Get Exclusive Kraus Offers & Promotions



Scan to Register Online
or visit <http://www.kraususa.com/registration>

We're always looking for ways to improve.

Please take a moment to share your experience.
Visit <http://www.kraususa.com/review> to let us know what you think
about your new Kraus product.

Contact Us to Learn More
1.800.775.0703 / www.kraususa.com / customerservice@kraususa.com
Like & Follow KrausUSA

Download the Kraus Care & Maintenance Guide at:
<http://www.kraususa.com/maintenance>



Kräus®

www.kraususa.com