



ASSEMBLY INSTRUCTIONS

To assemble mop system:

1. Hold the bucket base and grab the lid by the plastic divider between the Wash and Dry Chambers and gently pull lid up.
2. Remove bucket handle, mop head, and mop handle pieces from bucket.
3. Place bucket lid on bucket, lining up handle tab holes with holes on bucket.
4. Place handle onto bucket by positioning handle grip with ridges facing down (Figure 2) and securing handle tabs into holes on either side of bucket.

Figure 1

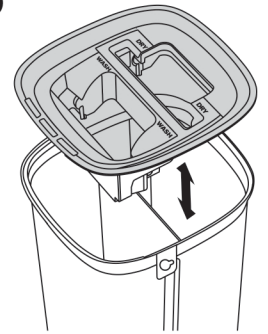
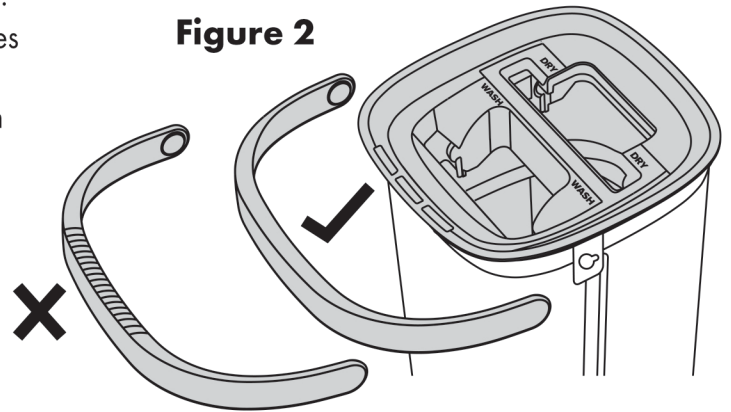
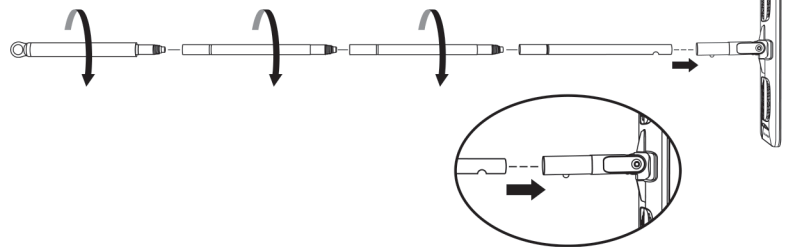

Figure 2



5. To attach **mop head**, align hole in **mop handle** piece with metal push tab on **mop head** and push together until tab clicks into place. Then connect the 3 remaining **mop handle** pieces and twist tight. See illustration.



**SCAN CODE TO
SEE HOW TO
ASSEMBLE AND
USE MOP SYSTEM**

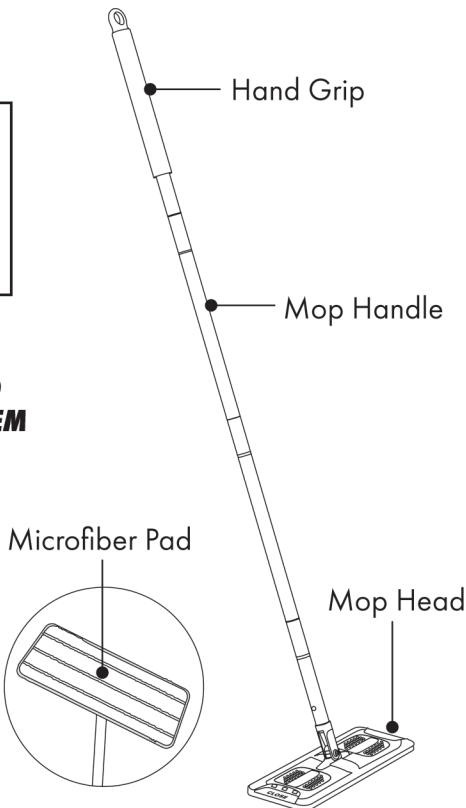

FULLY ASSEMBLED MOP

Wash Chamber
(Rinse)

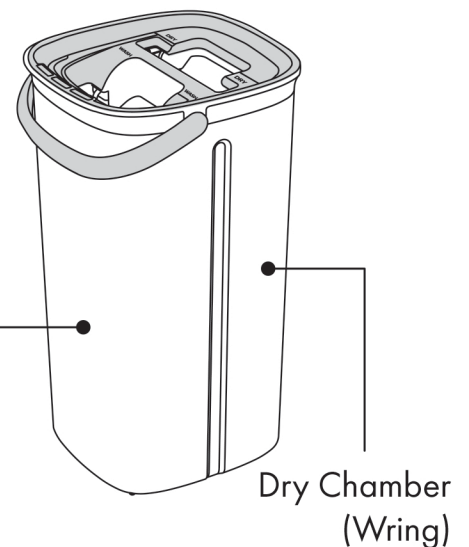

FULLY ASSEMBLED BUCKET