

# American Planking Installation Instructions

## Read Carefully Before Installation

**Step 1)** Open boxes of planking in the room it will be installed. Wood **MUST** acclimate to the conditions of the room for a minimum of **72 hours**.

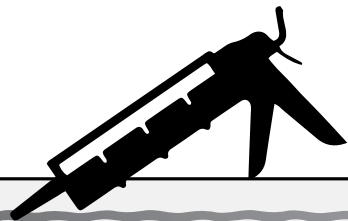
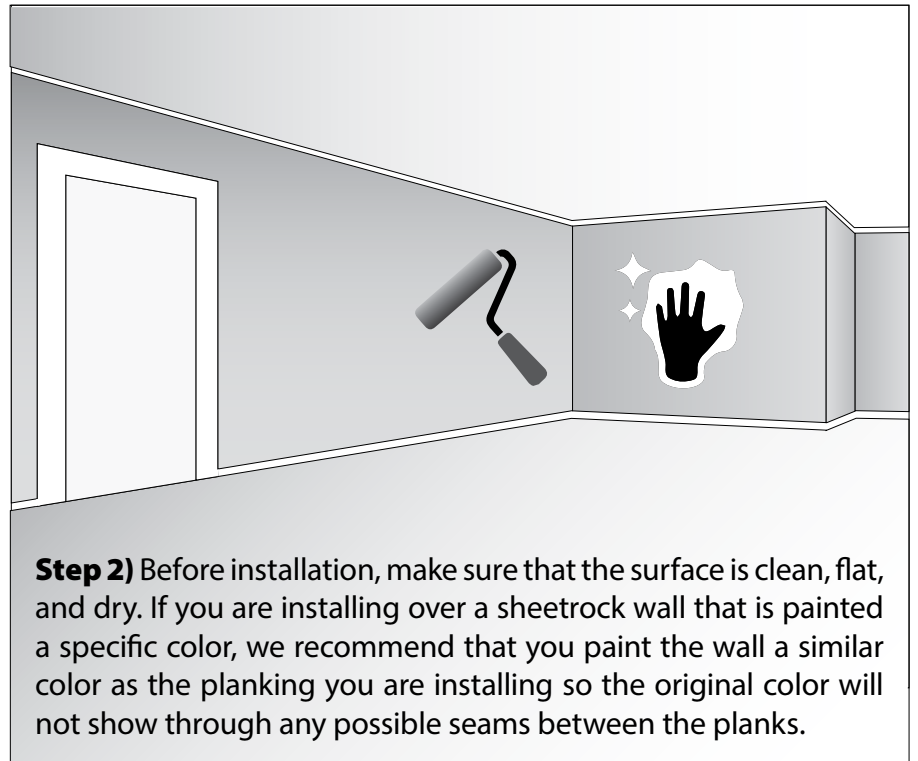
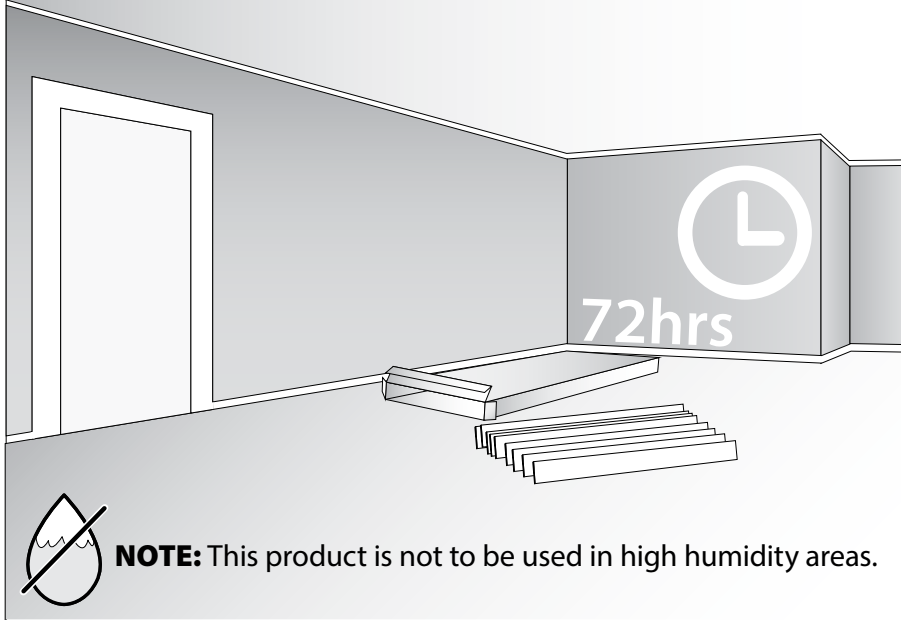

### Proper Construction Adhesive Application

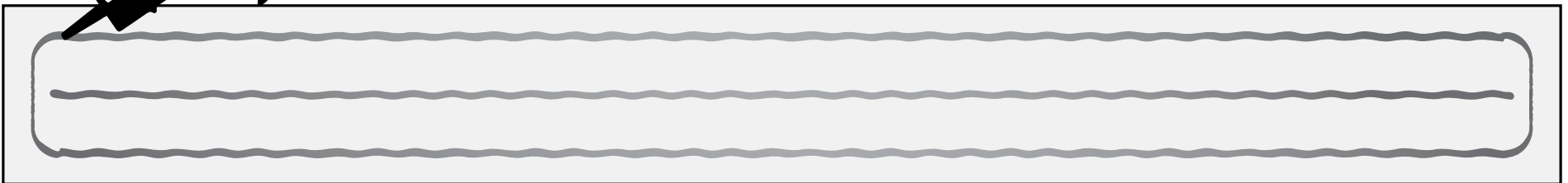

### Proper Brad / Nail Placement

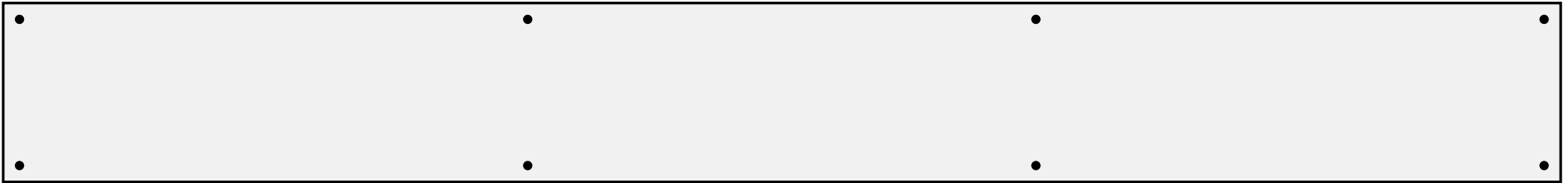

**Step 3)** Recommended installation is with Heavy Duty \*Liquid Nails® (construction adhesive) and to be nailed with a brad nail gun or a hammer and finishing nails. Each plank should have a bead of adhesive 1" from all outside edges and a single bead applied down the center of the plank (see above diagram). Recommended brad/nail lengths is 1-1/4". Apply brads/nails approximately 1/2" from outside edges of planks and into studs when possible (see above diagram). If a brad gun is not available, use 3d x 1-1/4" finish nails along with a nail set to set the nail head slightly before the surface of the plank. It is not recommended to apply wood putty to the nail holes since the putty will collect in the weathered wood grain.

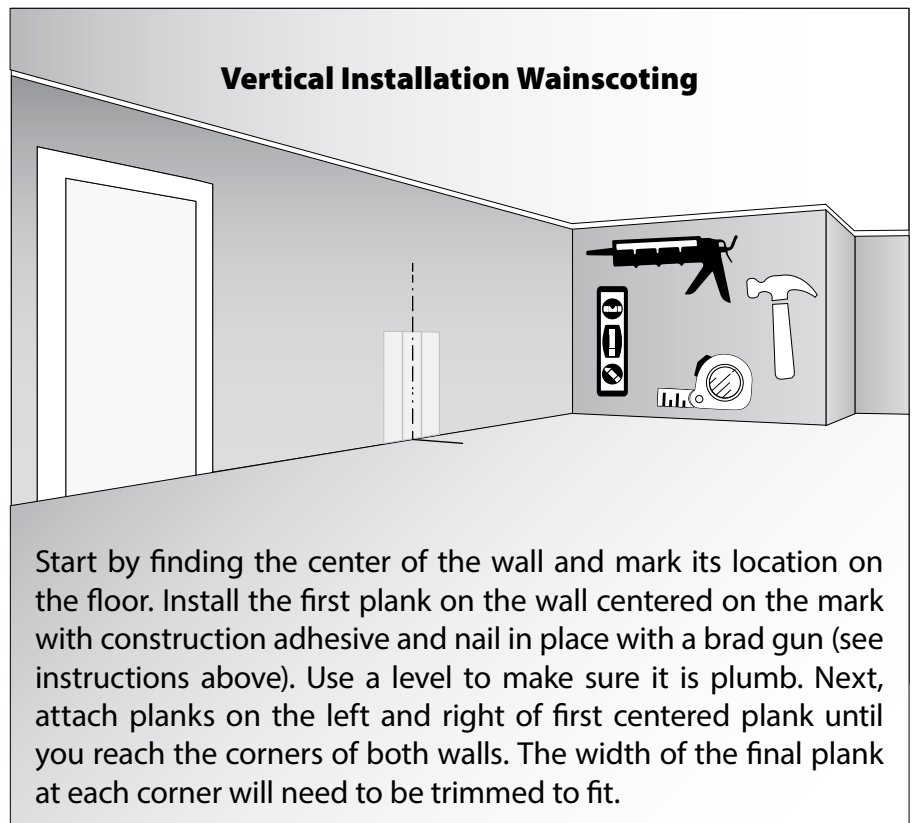
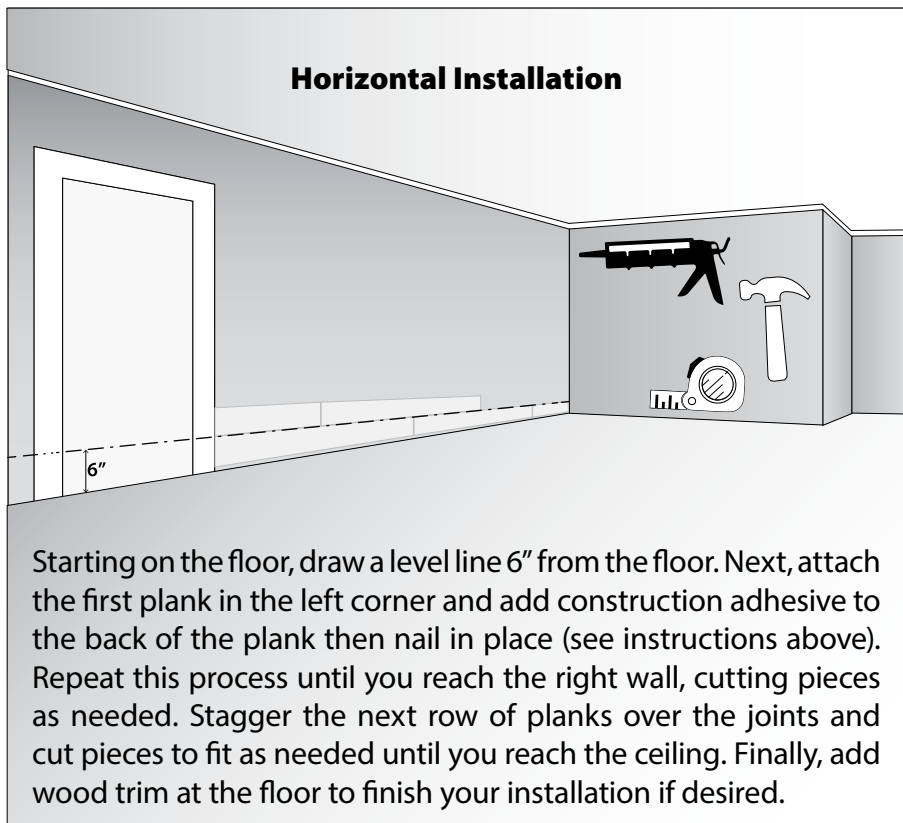

### Coastal Ivory Touch Up Instructions

**What you will need:**

- \*\*BEHR® Solid Color Waterproofing Stain & Sealer tinted to Drizzle PPU26-14
- Cotton swabs or a small art brush

**Directions:** Apply a small amount of \*\*BEHR® Solid Color Waterproofing Stain & Sealer tinted to Drizzle PPU26-14 to a cotton swab or small art brush. Lightly brush the stain over the area needing to be repaired. Repeat light coats of stain until the area blends into the original plank color.

**AmericanPac.com**



\*Liquid Nails® is a registered trademark of PPG Architectural Finishes Inc. © 2024 PPG Industries, Inc.

\*\* BEHR® is a registered trademark of Behr Process Corporation © 2024 Behr Process Corporation