

Thank You

Thank you for purchasing this product. It was carefully engineered to provide excellent performance when properly operated and maintained.

Please read this entire manual prior to operating the equipment. It instructs you how to safely and easily set up, operate and maintain your machine. Please be sure that you, and any other persons who will operate the machine, carefully follow the recommended safety practices at all times. Failure to do so could result in personal injury or property damage.

All information in this manual is relative to the most recent product information available at the time. Review this manual frequently to familiarize yourself with the machine, its features and operation. Please be aware that this Operator's Manual may cover a range of product specifications for various models. Characteristics and features discussed and/or illustrated in this manual may not be applicable to

all models. We reserve the right to change product specifications, designs and equipment without notice and without incurring obligation.

If applicable, the power testing information used to establish the power rating of the engine equipped on this machine can be found at www.opei.org or the engine manufacturer's web site.

If you have any problems or questions concerning the machine, phone your local authorized service dealer or contact us directly. We want to ensure your complete satisfaction at all times.

Throughout this manual, all references to *right* and *left* side of the machine are observed from the operating position.

Contents of Carton

- | | | |
|----------------------------------|--|-----------------------------------|
| • Lawn Tractor (1) | • Steering Wheel (1) – Cup Washer (1) & Hex Bolt (1) | • Operator's Manual (1) |
| • Ignition Key (2) | • Seat (1) | • Engine Operator's Manual (1) |
| • Plastic Oil Drain Sleeve (1) † | • Dash Shroud (1) † | • Fast Start Guide (1)† |
| • Oil Drain Hose (1) † | • Deck Wash Nozzle (1) † | • Parts/Warranty Document (1) |
| • Hood Scoop (1) † | • Hose Coupler (1) † | • Product Registration Card (1) † |
- † — If Equipped

Note: This Operator's Manual covers several models. Features may vary by model. Not all features in this manual are applicable to all models and the model depicted may differ from yours. Refer to Figure 2-1 to match your transmission style; Foot Control CVT (Continuously Variable Transmission), CVT (Continuously Variable Transmission) or Hydrostatic.

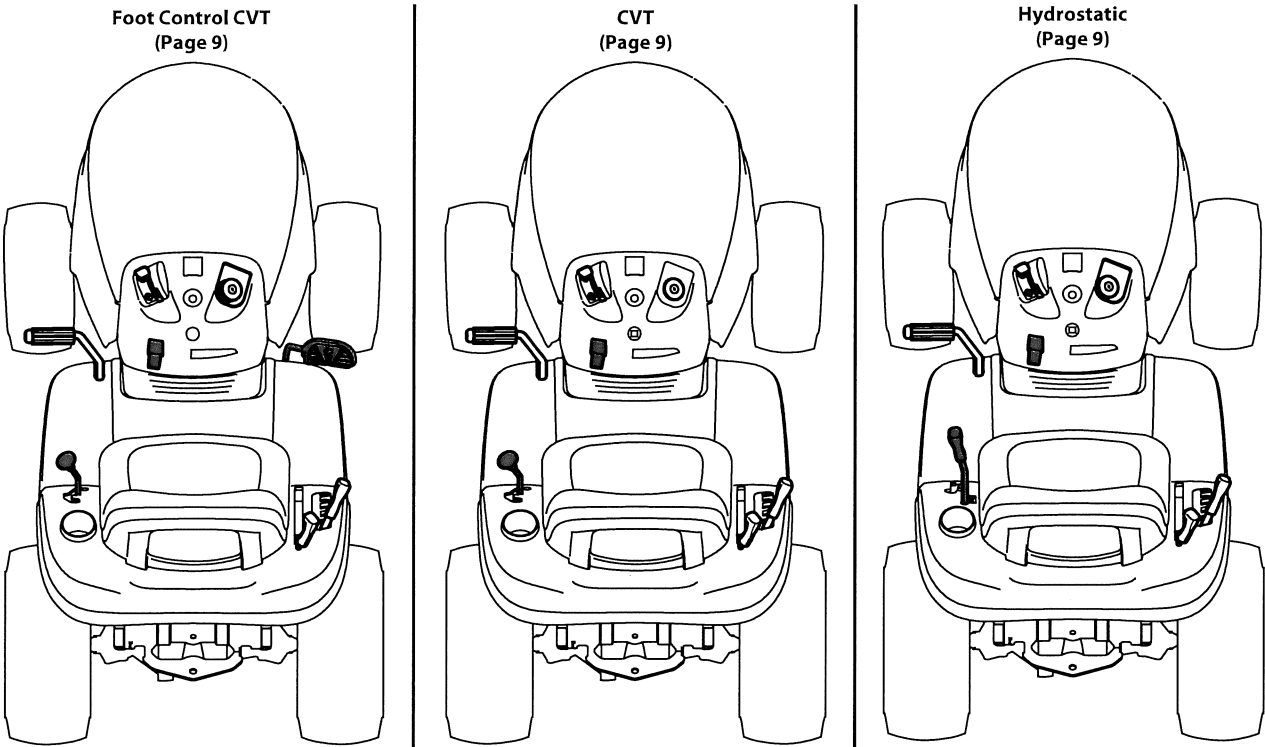

Figure 2-1

Tools Required

- Adjustable Wrench or Socket Set

Connecting the Battery Cables

⚠ WARNING

California **PROPOSITION 65** Battery posts, terminals, and related accessories contain lead and lead compounds, chemicals known to the State of California to cause cancer and reproductive harm. Wash hands after handling.

⚠ CAUTION

When attaching battery cables, always connect the **POSITIVE (Red)** wire to its terminal first, followed by the **NEGATIVE (Black)** wire.

For shipping reasons, both battery cables on your equipment may have been left disconnected from the terminals at the factory. To connect the battery cables, proceed as follows:

- Note:** The positive battery terminal is marked Pos. (+). The negative battery terminal is marked Neg. (-).
1. Remove the plastic cover, if present, from the positive battery terminal and attach the red cable to the positive battery terminal (+) with the bolt (a) and hex nut (b). See Figure 2-2.

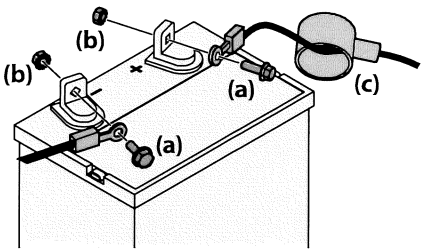

Figure 2-2

2. Remove the plastic cover, if present, from the negative battery terminal and attach the black cable to the negative battery terminal (-) with the bolt (a) and hex nut (b). See Figure 2-2.
3. Position the red rubber boot (c) over the positive battery terminal to help protect it from corrosion.

Note: If the battery is put into service after the date shown on top/side of battery, charge the battery as instructed in the Service section your Operator's Manual on page 8 prior to operating the tractor.

Shipping Brace Removal

⚠ WARNING

Make sure the tractor's engine is OFF, remove the ignition key, and set the parking brake before removing the shipping brace. Refer to the Controls & Operations section on page 8 for instructions on how to set the parking brake.

Check the cutting deck for a shipping brace (a) that may be holding the chute deflector (b) upward for shipment. If the shipping brace (a) is present, it must be removed before operating the tractor. Holding the chute deflector (b) fully upward, remove the shipping brace (a). Lower the chute deflector (b) and discard the shipping brace (a). See Figure 2-3.

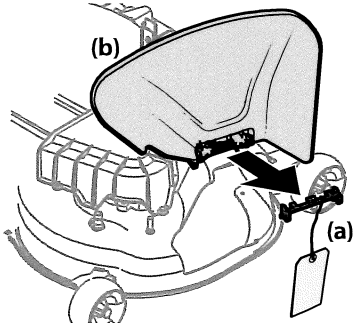

Figure 2-3

⚠ WARNING

The shipping brace (a) is used for packaging purposes only, it must be removed and discarded before operating your tractor.

⚠ WARNING

The cutting deck is capable of throwing objects. Failure to operate the tractor without the chute deflector in the proper operating position could result in serious personal injury and/or property damage.

Attaching the Steering Wheel

1. If the steering wheel (a) for your tractor did not come attached, the hardware for attaching it has been packed within the steering wheel (a), beneath the steering wheel cap (b). Carefully pry OFF the steering wheel cap (b) and remove the cupped washer (c) and hex bolt (d).

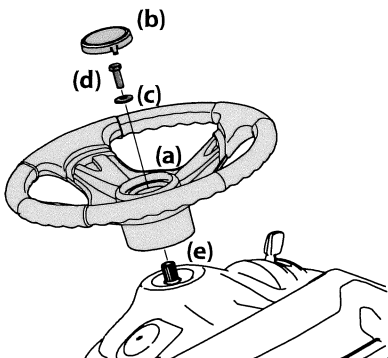

Figure 2-4

2. With the wheels of the tractor pointing straight forward, place the steering wheel (a) over the steering shaft (e).
3. Place the cupped washer (c) — cupped side down — over the steering wheel (a) and secure with the hex bolt (d). See Figure 2-4.
4. Place the steering wheel cap (b) over the center of the steering wheel (a) and push downward until it "clicks" into place.

Attaching the Seat

If the seat for your tractor was not attached at the factory, refer to the following steps.

Note: For shipping reasons, seats are either fastened to the tractor seat's pivot bracket with a cable tie, or mounted backward to the pivot bracket. In either case, remove the seat from its shipping position.

1. Remove the seat adjustment knob/bolt (a) from the bottom of the seat (b). See Figure 2-5.

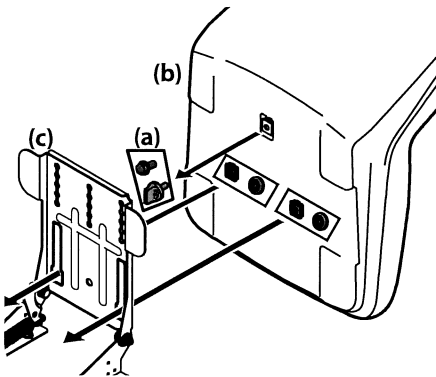

Figure 2-5

2. Align the seat (b) over the seat pivot bracket (c) as shown in Figure 2-5 and fit the seat (b) onto the seat pivot bracket (c) inserting the two tabs (square or round) on the seat (b) bottom into the slots on the seat pivot bracket (c).
3. Slide the seat (b) rearward in the seat pivot bracket (c), lining up the center rear slot in the seat pivot bracket (c) with the remaining hole in the seat (b) base. See Figure 2-6.

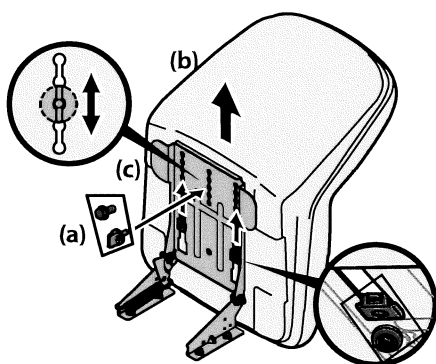

Figure 2-6

Note: Be certain the two seat tabs (square or round) engage the seat pivot bracket as shown in the bottom right inset of Figure 2-6.

4. Select the desired position for the seat (b), and secure with the adjustment knob/bolt (a) removed in Step 1. See Figure 2-6.
5. To adjust the position of the seat, remove the adjustment knob/bolt (a) on the bottom of the seat (b). Slide the seat (b) forward or backward as desired. Reinstall the adjustment knob (a). See Figure 2-6.

Dash Shroud (If Equipped)

There are two shroud types. One shroud for the 1/3/5/K/T-Style and one for the S-Style dash.

Continue below for the 1/3/5/K/T-Style, skip ahead to the S-style section for the S-Style dash.

1/3/5/K/T-Style Dash

1. If the dash shroud (a) was shipped loose, the hardware for attaching the dash shroud (a) is shipped installed in the dash (c). Remove the two bolts (b) from the dash (c). See Figure 2-7.

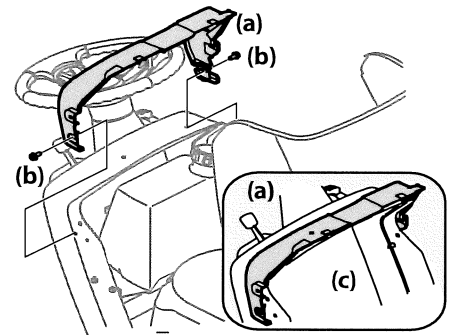

Figure 2-7

2. Mount the dash shroud (a) and align the mounting holes. See Figure 2-7.
3. Secure the dash shroud (a) to the dash (c) with the bolts (b) removed in Step 1. See Figure 2-7.

S-Style Dash

1. If the dash shroud (a) was shipped loose, the hardware for attaching the dash shroud (a) is shipped installed in the dash shroud (a) and the dash (b). Remove the two bolts (c) and washers (d) from the dash (g) and two bolts (e) and clips (f) from the dash shroud (b). See Figure 2-8.

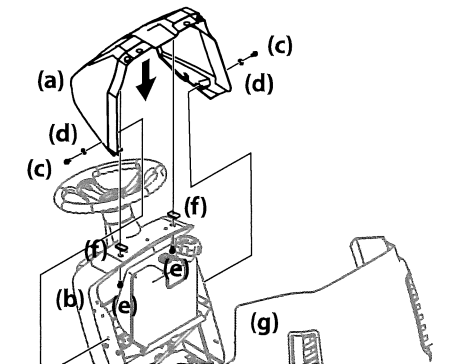

Figure 2-8

2. Mount the dash shroud (a) and align the mounting holes. Using the bolts (c/e), washers (d) and clips (f) install the dash shroud (a) and snug the bolts (c) so that the dash shroud (a) can be adjusted. Close the hood and align the dash shroud (a) to the hood (g) leaving a uniform gap between the hood (g) and the dash shroud (a).
3. Raise the hood (g) and tighten the bolts (c/e) that hold the dash shroud (a) on the dash (b).

Tire Pressure

⚠ WARNING

Equal tire pressure should be maintained at all times. Refer to the tire sidewall for proper pressure.

The recommended operating tire pressure is:

- Approximately 10 psi for the rear tires
- Approximately 14 psi for the front tires

Important: Refer to the tire sidewall for exact tire manufacturer's recommended or maximum psi. Do not overinflate. Uneven tire pressure could cause the cutting deck to mow unevenly.

Gas & Oil Fill-up

Oil

Important: Your tractor is shipped with motor oil in the engine. However, you MUST check the oil level before operating. Be careful not to overfill.

Service and check the engine oil as instructed in the Engine Operator's Manual. Read the instructions carefully.

Gasoline

The gasoline tank is located under the hood. Do not overfill.

⚠ WARNING

Use extreme care when handling gasoline. Gasoline is extremely flammable and the vapors are explosive. Never fuel machine indoors or while the engine is hot or running. Extinguish cigarettes, cigars, pipes, and other sources of ignition.

Note : Purchase gasoline in small quantities. Do not use gasoline left over from the previous season, to minimize gum deposits in the fuel system.

- This engine is certified to operate on unleaded gasoline. For best results, fill the fuel tank with only clean, fresh, unleaded gasoline with a pump sticker octane rating of 87 or higher.
- Gasohol (up to 10% ethyl alcohol, 90% unleaded gasoline by volume) is an approved fuel. Other gasoline/alcohol blends, such as E85, are not approved.
- Methyl Tertiary Butyl Ether (MTBE) and unleaded gasoline blends (up to a maximum of 15% MTBE by volume) are approved fuels. Other gasoline/ether blends are not approved.
- Fill fuel tank outdoors or in well-ventilated area.
- Never remove gas cap or add fuel while the engine is hot or running. Allow engine to cool at least two minutes before refueling.
- If gasoline is spilled, wipe it off the engine and equipment. Move machine to another area. Wait five minutes before starting the engine.

To Add Gasoline

Refer to Figure 2-1 and proceed to your applicable model for your gas tank.

Hydrostatic Models

1. Turn the engine OFF and let the engine cool at least two minutes before removing the fuel cap. The gasoline tank is located under the hood. Remove the fuel cap by turning it counter-clockwise.

2. Fill the fuel tank with gasoline. Use only clean, fresh (no more than 30 days old), unleaded gasoline. Fill tank to the base of the filler neck to allow space for fuel expansion. DO NOT TOP OFF THE TANK WITH FUEL. See Figure 2-9.

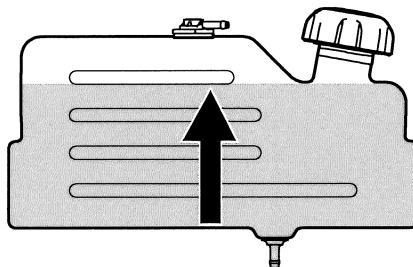

Figure 2-9

3. Reinstall the fuel cap.



STOP! Continue to Setting the Deck Gauge Wheels (If Equipped) on page 9.

Foot Control CVT Models & CVT Models

1. Turn the engine OFF and let engine cool at least two minutes before removing the fuel cap. The gasoline tank is located under the hood. Remove the fuel cap by turning it counter-clockwise.
2. Fill the fuel tank with gasoline. Use only clean, fresh (no more than 30 days old), unleaded gasoline. Fill tank to no more than 1/2" below bottom of filler neck to allow space for fuel expansion. See Figure 2-10.

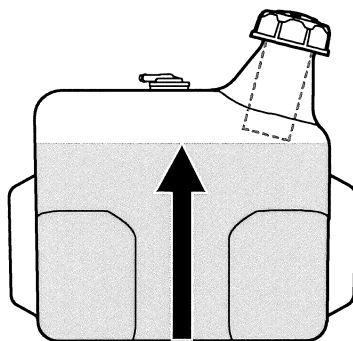

Figure 2-10

3. Reinstall the fuel cap.

Important: Do not overfill the tank. Fill tank to no more than 1/2" below bottom of filler neck to allow space for fuel expansion. See Figure 2-10.



STOP! Continue to Setting the Deck Gauge Wheels (If Equipped) on page 10.

Setting the Deck Gauge Wheels (If Equipped)

Move the tractor to a firm and level surface, preferably pavement, and proceed as follows:

1. Select the height position of the cutting deck by placing the deck lift lever in the normally desired mowing height setting (there are six different cutting height notches on the right fender).
2. Check the deck gauge wheels for contact or excessive clearance with the surface below. The deck gauge wheels should have between 1/4" and 1/2" clearance above the ground.

If the gauge wheels have excessive clearance or contact with the surface, adjust as follows:

- a. Raise the deck lift handle to its highest setting.
- b. Remove the front and rear deck gauge wheels (a) by removing the lock nuts (b) and shoulder screws (c) which secure them to the deck. See Figure 2-11.

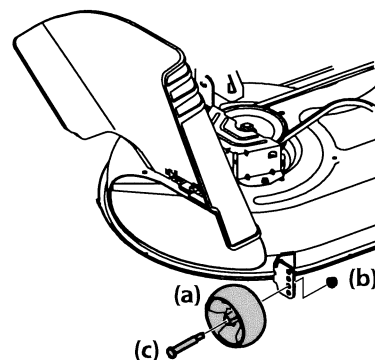

Figure 2-11

- c. Place the deck lift lever in the desired mowing height setting.
- d. Reinsert the shoulder screws (c) into the index hole that leaves approximately 1/2" between the bottom of the deck gauge wheel (a) and the pavement. Secure in place with the lock nuts (c).

Refer to Leveling the Deck in the Service section on page 10 of this manual for more detailed instructions regarding various deck adjustments.

Attaching the Hood Scoop (If Equipped)

On some tractors, a hood scoop may be included. If the hood scoop was not installed on the hood of your tractor at the factory, refer to the following steps to install the hood scoop:

1. Cut the cable ties securing the hood scoop to the tractor.
2. Remove the four screws pre-installed in the hood scoop and retain for Step 4.
3. Snap the hood scoop into place using the hood as your guide. See Figure 2-12.

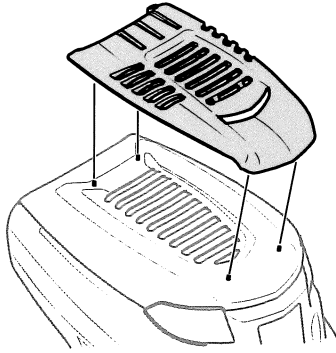

Figure 2-12

4. Install the hood scoop onto the hood of the tractor and secure from the underside using the four screws removed in Step 2.

Moving the Tractor Manually

Refer to Figure 2-1 and proceed to your applicable model.

Hydrostatic Models

Hydrostatic models are equipped with a hydrostatic relief valve when it is necessary to move the tractor manually. Activating this valve forces the fluid in the transmission to bypass its normal route, allowing the rear tires to “freewheel.” To engage the hydrostatic relief valve, proceed as follows:

1. Locate the hydrostatic bypass rod in the rear of the tractor. See Figure 2-13.

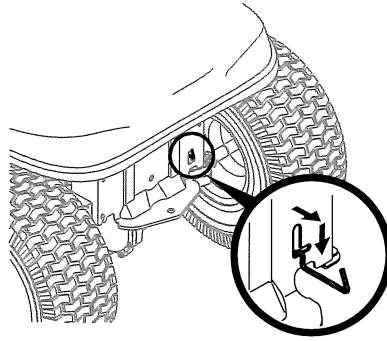

Figure 2-13

2. Pull the hydrostatic bypass rod outward, then down, to lock it in place.
Note: The transmission will NOT engage when the hydrostatic bypass rod is pulled out. Return the rod to its normal position prior to operating the tractor.

Important: Never attempt to move the tractor manually without first engaging the hydrostatic relief valve. Doing so will result in serious damage to the tractor's transmission.



STOP! Continue to Controls & Operations section page 10.

Foot Control CVT & CVT Models

CVT models can be placed in the NEUTRAL (N) position when it is necessary to move the tractor manually. To move the tractor manually, place the shift lever in the NEUTRAL (N) position.



STOP! Continue to Controls & Operations section page 10.

Notes