

OVENTE®

TEMPERATURE CONTROL

ELECTRIC KETTLE

KG661 SERIES



Before use, please read this manual thoroughly and save for future reference.

ovente.com

TEMPERATURE CONTROL ELECTRIC KETTLE

KG661 SERIES

TABLE OF CONTENTS

IMPORTANT SAFEGUARDS	3
PARTS & FEATURES	5
USING YOUR ELECTRIC KETTLE	6
DESCALING YOUR ELECTRIC KETTLE	8
CARE & MAINTENANCE	11



IMPORTANT SAFEGUARDS

When using your electric kettle, basic safety precautions should always be followed, including:

- ❗ Read these instructions carefully and thoroughly before using your kettle.
- ❗ Before connecting the kettle to a power source, check whether the voltage indicated on the bottom of the kettle and base unit corresponds with the main voltage in your home.
- ❗ Do not touch hot surfaces or hot water. Use handles. Care must be taken since burns can occur from touching hot parts or from spilled hot liquid.
- ❗ To protect against fire, electric shock, and personal injury, do not immerse cord, plug, power base, or electric kettle in water or other liquid.
- ❗ Unplug from outlet when not in use and allow the kettle to cool completely before cleaning, filling, emptying, or storing.
- ❗ Do not operate any appliance with a damaged cord or plug, or after the appliance malfunctions or is dropped or damaged in any manner. Call Customer Support on [1-855-926-2626](tel:1-855-926-2626) for immediate assistance.
- ❗ The use of accessory attachments not recommended by the manufacturer may result in fire, electric shock, or personal injury.
- ❗ Do not use outdoors or for other than intended use.
- ❗ Do not overfill the kettle. Refer to the maximum level indicator.
- ❗ To avoid against fire, do not operate near explosive and/or flammable fumes. Do not operate or place any part of this kettle on or near gas, an electric burner or in a heated oven.



IMPORTANT SAFEGUARDS

When using your electric kettle, basic safety precautions should always be followed, including:

- ❗ Close supervision is necessary when any appliance is used by or near children.
- ❗ This kettle is not intended to be used by persons (including children) with reduced physical, sensory and mental capabilities. This appliance is not for persons with lack of experience and knowledge, unless they have been given supervision or instructions concerning the use of the appliance by a person responsible for their safety.
- ❗ Do not let the cord hang over the edge of a table or counter where it can be tripped over or pulled on by children or pets.
- ❗ Never pull the cord; instead remove the plug from the outlet.
- ❗ To avoid possible steam damage, do not face the spout when operating the kettle.
- ❗ If operated on wooden furniture, use a protective pad to prevent damage to delicate finishes.
- ❗ To avoid scalding, always ensure the lid is closed before switching on the kettle.
- ❗ Do not switch your kettle on if it is empty.
- ❗ Make sure to regularly descale your kettle (see descaling instructions on Page 8), because mineral build-up can cause the kettle to stop operating correctly.



PARTS & FEATURES

SPOUT FILTER

Ensures debris-free water

1500W CONCEALED HEATING ELEMENT

Helps reduce mineral build up

BLUE LED LIGHT

Illuminates to let you know kettle is on

1.8L CAPACITY

Ideal for entertaining guests

TEA INFUSER LID

Conveniently brew tea in your kettle

NON-SLIP, 360° ROTARY BASE

With built-in cord storage

EASY PULL-OPEN LID

Opens easily for filling and cleaning

COOL-TOUCH HANDLE

For safe, effortless use

PRE-SET TEMPERATURES

160, 170, 180, 190, 200 or 212° F

SAFETY FEATURES

Boil-Dry Protection
Auto Shut-Off
BPA-Free

BOROSILICATE GLASS BODY

Heat-tempered for durability

KEEP-WARM FUNCTION

Maintains your selected temperature for up to 2 hours





USING YOUR ELECTRIC KETTLE

- 1 Refer to Figure 1 to open the kettle.
- 2 Before first use, fill the kettle with filtered water to maximum capacity and boil. Discard water and repeat the process.
- 3 Fill the kettle up to your desired level. Do not overfill to prevent the risk of spillage. Use the water-level indicator to measure the desired amount of water.
- 4 Put the base on a dry, flat, heat-resistant surface.
- 5 Place the kettle on the base.
- 6 Plug the kettle into a properly installed 110-120V 50/60Hz outlet. The display screen will say "On".
- 7 To boil water, press . The LED light will illuminate to let you know the kettle is on.
- 8 Press + or - to select your temperature (160, 170, 180, 190, 200 or 212°F). If not, the kettle will default to 212°F. After boiling, the LED light switches off and the kettle beeps twice.
- 9 If you press keep warm, the temperature on the dial flickers briefly and the LED lights inside the kettle flash. The keep-warm function works for up to 2 hours, but will automatically be cancelled if you lift the kettle off the base.
- 10 After use, disconnect the kettle from the outlet.

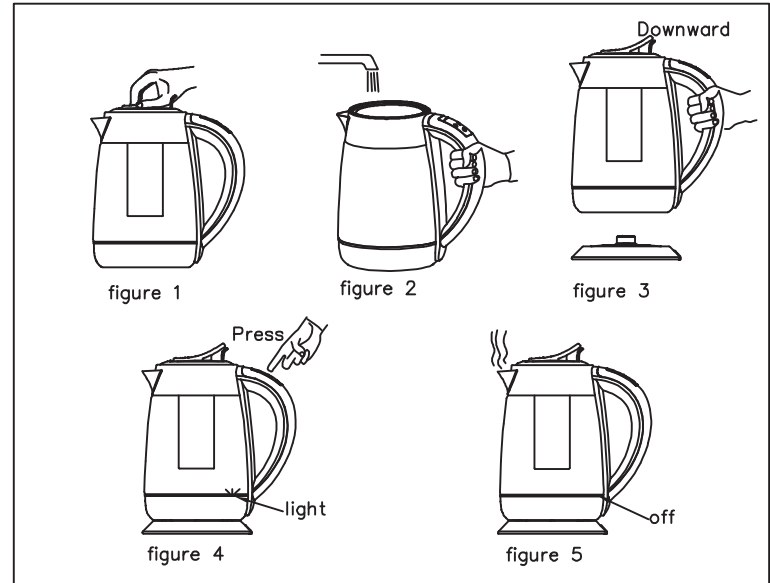





USING YOUR ELECTRIC KETTLE

AUTO SHUT-OFF

This kettle is fitted with auto shut-off, a safety feature that prevents overheating should the kettle be switched on when empty or with insufficient water. Always ensure water covers the minimum mark on the water-level gauge. If auto shut-off kicks in, switch off the kettle, disconnect it from the outlet, and allow it to cool down for 5-10 minutes. When you refill it and switch it on, the kettle will operate as normal.

TEMPERATURE CONTROL PANEL

The temperature control panel has 6 pre-set temperatures for optimal tea and coffee brewing. Press  or  to select your desired temperature.

160°F - White Tea

170°F - Green Tea

180°F - Black Tea

190°F - Oolong Tea

200°F - Coffee

212°F - Noodles



DESCALING YOUR ELECTRIC KETTLE

Residue, odor and spotting found inside your kettle are most likely caused by limescale which are natural deposits (calcium, magnesium, iron and copper) that may build up depending on the water in your area.

While you do not need to worry about hygienic or health-related issues, we do strongly recommend descaling your kettle from time to time to avoid limescale build-up and other issues.

What you need:

Water and vinegar or lemon juice

Steps:

- 1 Mix a solution that is 3/4 parts water to 1/4 part vinegar or lemon juice.
 - 2 Pour solution into kettle and close the lid.
 - 3 Bring solution to a boil and leave for 5-8 hours.
 - 4 Discard solution.
 - 5 If the problem persists, repeat from Step 1 until limescale dissipates.
- ⚠ Caution: the solution may be extremely hot during this process.



SAFETY INSTRUCTIONS FOR YOUR KETTLE

- ⚠ Since tap water can leave mineral deposits, we recommend filling your kettle with filtered water. Empty out your kettle after use; leaving water inside can contribute to mineral build up.
- ⚠ The water level must be within the MIN and MAX marks.
- ⚠ Switch off the kettle before removing it from the base.
- ⚠ Always ensure that the lid is tightly closed.
- ⚠ The base and exterior of the kettle must not become wet.
- ⚠ Always make sure that the kettle is positioned properly on the base.





TROUBLESHOOTING



Problem

Solution

Indicator light is not turning on

Ensure that the kettle is plugged in and positioned properly on the base. Press  once to boil water or   for desired temperature.

Kettle is not heating

Ensure that the kettle is plugged in and positioned properly on the base. Press  once to boil water or   for desired temperature. Check if the indicator light is powered on. If kettle is still not heating, please contact Customer Support at [1-855-926-2626](tel:1-855-926-2626).

There are brown/red/white spots at the bottom of my kettle

This is normal especially in areas with hard water. Please refer to Page 8 for descaling instructions.



CARE & MAINTENANCE

- Wipe the exterior of the kettle with a soft, damp cloth or sponge.
- Remove water spots with a clean, damp cloth.
- Do not use abrasive scouring pads.
- Never immerse the kettle in water or other liquids.
- From time to time, depending on the nature of your water supply, limescale will be naturally formed and can be found mostly on the heating element; thus, reducing the heating efficiency. (Refer to Page 8 for descaling instructions).



ELECTRICAL REQUIREMENTS

Voltage: 110-120V

Wattage: 1500W

Hertz: 50/60Hz



OVENTE WARRANTY

LIMITED TWO (2)-YEAR WARRANTY

At Ovente, we aim to make your life easier by producing top-quality housewares, designed with you in mind. We have pledged to uphold all our offerings to the highest standards, and we back all our kettles with a two (2)-year warranty from the date of purchase from an authorized retailer. This warranty covers defects in workmanship and materials. It does not include damage due to abuse, misuse, commercial use, accidents or natural wear and tear. In case of replacement, shipping and handling fees may apply.

LIMITATIONS

The warranty stated above is the only warranty applicable to this product. Other expressed or implied warranties are hereby disclaimed. No verbal or written information given by the Manufacturer, its agents or employees shall create a guarantee or in any way increase the scope and duration of this warranty. Repair or replacement as provided under this warranty is the exclusive remedy of the consumer. The manufacturer shall not be liable for incidental or consequential damages resulting from the use of this product. Any implied warranty of merchantability or fitness for a particular purpose on this product is limited to the applicable warranty period set forth above except to the extent prohibited by law. Proof of purchase may be required to validate the order. Promotional items may not be covered under any warranty. Consumer rights may vary from state to state.

For product support email support@ovente.com or call **1-855-926-2626**.

Visit us at ovente.com



[Facebook.com/ovente](https://www.facebook.com/ovente)



[@oventeTweets](https://twitter.com/oventeTweets)



[@Ovente](https://www.instagram.com/Ovente)



[youtube.com/ovente](https://www.youtube.com/ovente)

ovente.com