

HOME DECORATORS COLLECTION®

Item #1003 236 536
#1003 236 537
Model #YG682-BN
#YG682-NI

USE AND CARE GUIDE

CALTHORPE 20 IN. CEILING FAN

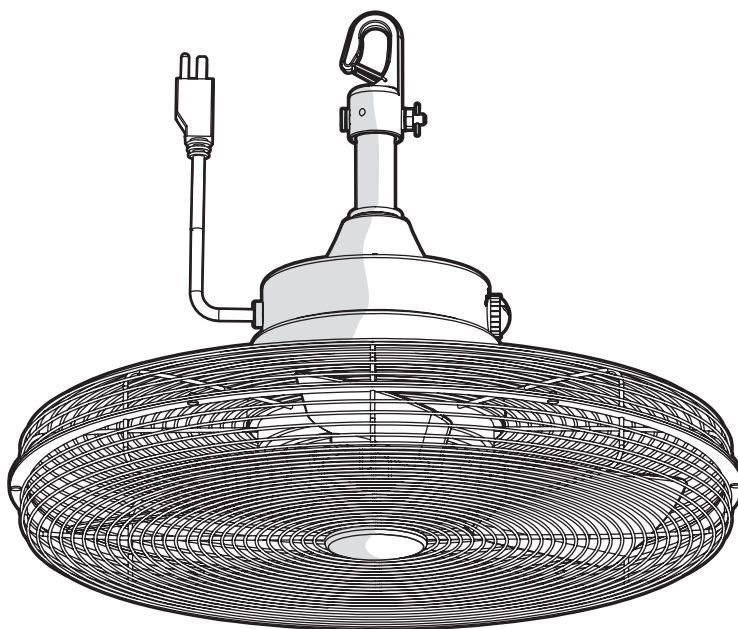

Questions, problems, missing parts? Before returning to the store,
call Home Decorators Collection Customer Service
8 a.m. - 7 p.m., EST, Monday-Friday, 9 a.m. - 6 p.m., EST Saturday

1-800-986-3460

HOMEDEPOT.COM/HOMEDECORATORS



Visual instruction of how to install this fan:

Visit www.homedepot.com and enter either the Item or Model number to find
this fan and click the link of visual instruction in the product overview section.

THANK YOU

We appreciate the trust and confidence you have placed in Home Decorators Collection through the purchase of this ceiling fan. We strive to continually create quality products designed to enhance your home. Visit us online to see our full line of products available for your home improvement needs. Thank you for choosing Home Decorators Collection!

Table of Contents

Table of Contents	2	Disassembling Your Fan	10
Safety Information	3	Operation	11
Warranty	4	Switch Operating Instructions	11
Pre-Installation	4	Care and Cleaning	12
Specifications	4	Troubleshooting	12
Tools Required	4	Service Parts	13
Hardware Included	5		
Package Contents	6		
Installation	7		
Assembly	8		
Hanging the Fan	8		

READ AND SAVE THESE INSTRUCTIONS

Safety Information

1. To reduce the risk of electric shock, ensure electricity has been turned off at the circuit breaker or fuse box before beginning.
2. Avoid placing objects in the path of the blades.
3. To avoid personal injury or damage to the fan and other items, be cautious when working around or cleaning the fan.
4. Do not use water or detergents when cleaning the fan or fan blades. A dry dust cloth or lightly dampened cloth will be suitable for most cleaning.
5. This product employs overload protection (fuse). A blown fuse indicates an overload or short-circuit situation. If the fuse blows, unplug the product from the outlet. Replace the fuse as per the user servicing instructions (follow product marking for proper fuse rating) and check the product. If the replacement fuse blows, a short-circuit may be present and the product should be discarded or returned to an authorized service facility for examination and/or repair.
6. This fan is applicable only for gazebos or pagodas where a reliable mounting bracket is provided.
7. Ensure the hanging structure can support a minimum weight of 30 lbs. If you are not sure the hanging structure can support the weight, do not attempt to install this fan as it may fall and cause damage to the fan or personal injury. Contact a qualified, licensed electrician for information regarding proper mounting methods in your area.
8. Unplug or disconnect the appliance from the power supply before servicing.
9. Use only on GFCI-protected receptacles.



WARNING: Do not insert foreign objects between rotating fan blades.



WARNING: Risk of fire. Do not replace attachment plug. Contains a safety device (fuse, AFCI, LCD) that should not be removed. Discard product if the attachment plug is damaged.



WARNING: To reduce the risk of personal injury, do not insert foreign objects inside the cage of the fan. Do not damage or deform the cage of the fan.



WARNING: Power cord will not support the weight of a fixture; pulling power cord will result of the fixture falling, with the possibility of personal injury and the danger of electrical shock or fire.



CAUTION: Do not operate any fan with a damaged cord or plug. Discard fan or return to an authorized service facility for examination and/or repair.



CAUTION: Do not run cord under carpeting. Do not cover cord with throw rugs, runners, or similar coverings. Do not route cord under furniture or appliances. Arrange cord away from traffic area and where it will not be tripped over. Do not strain the power cord.

Warranty

The manufacturer warrants the fan motor to be free from defects in workmanship and material present at time of shipment from the factory for a period of lifetime after the date of purchase by the original purchaser. The manufacturer warrants the light kit (excluding any glass), to be free from defects in workmanship and material present at time of shipment from the factory for a period of five years after the date of purchase by the original purchaser. The manufacturer also warrants that all other fan parts, excluding any glass or acrylic blades, to be free from defects in workmanship and material at the time of shipment from the factory for a period of two years after the date of purchase by the original purchaser. We agree to correct such defects without charge or at our option replace with a comparable or superior model if the product is returned. To obtain warranty service, you must present a copy of the receipt as proof of purchase. All costs of removing and reinstalling the product are your responsibility. Damage to any part such as by accident, misuse, improper installation or by affixing any accessories, is not covered by this warranty. Because of varying climatic conditions this warranty does not cover any changes in brass finish, including rusting, pitting, corroding, tarnishing or peeling. Brass finishes of this type give the longest useful life when protected from varying weather conditions. A certain amount of "wobble" is normal and should not be considered a defect. Servicing performed by unauthorized persons shall render the warranty invalid. There is no other express warranty. We hereby disclaim any and all warranties, including but not limited to those of merchantability and fitness for a particular purpose to the extent permitted by law. The duration of any implied warranty which cannot be disclaimed is limited to the time period as specified in the express warranty. Some states do not allow limitation on how long an implied warranty lasts, so the above limitation may not apply to you. The retailer shall not be liable for incidental, consequential, or special damages arising out of or in connection with product use or performance except as may otherwise be accorded by law. Some states do not allow the exclusion of incidental or consequential damages, so the above exclusion or limitation may not apply to you. This warranty gives specific legal rights, and you may also have other rights which vary from state to state. This warranty supersedes all prior warranties. Shipping costs for any return of product as part of a claim on the warranty must be paid by the customer.

Contact the Customer Service Team at 1-800-986-3460 or visit www.HOMEDEPOT.COM/HOMEDECORATORS

Pre-Installation

SPECIFICATIONS

Fan size	Speed	Volts	Amps	Watts	RPM	N.W.	G.W.	C.F.
20 in.	Low	120	0.3	19.44	325	7.8 kg (17.16 lbs.)	10.71 kg (23.56 lbs.)	3.71 cu. ft.
	Medium		0.40	35.8	496			
	High		0.51	60.1	745			



NOTE: These are approximate measures. They do not include amps and wattage used by the light kit.



TOOLS REQUIRED



Phillips
screwdriver



Flat blade
screwdriver



Adjustable
wrench



Step
ladder



Wire
stripper



Electrical
tape

Pre-Installation (continued)

HARDWARE INCLUDED



NOTE: Hardware not shown to actual size.

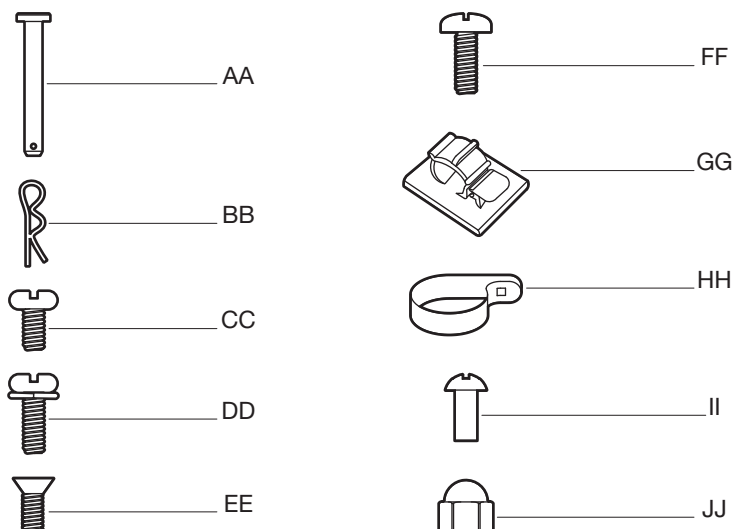

Part	Description	Quantity
AA	Cotter pin (preassembled)	1
BB	Cross pin (preassembled)	1
CC	Collar setscrew (preassembled)	2
DD	Blade arm screw with lock washer (preassembled)	6
EE	Rear guard screw (preassembled)	3
FF	Front guard screw (preassembled)	8
GG	Wire clip	6
HH	Rod clip	1
II	Set screw	1
JJ	Acorn nut	1

Pre-Installation (continued)

PACKAGE CONTENTS

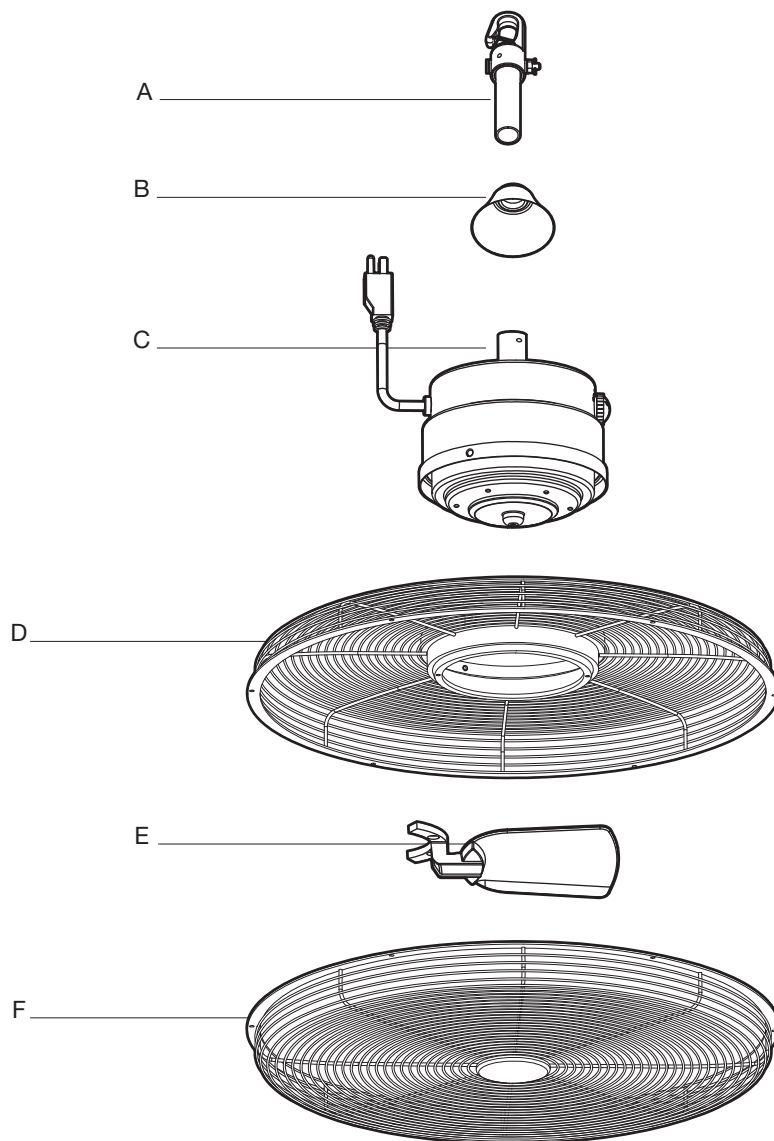

Part	Description	Quantity
A	Downrod assembly	1
B	Coupling cover	1
C	Fan motor assembly	1

Part	Description	Quantity
D	Rear guard (preassembled)	1
E	Blade assembly (preassembled)	3
F	Front guard (preassembled)	1

Installation

1 Standard mounting



WARNING: Before beginning assembly of the product, make sure all parts are present. Compare parts with package contents list and hardware contents list. If any part is missing or damaged, do not attempt to assemble the product.



WARNING: To avoid over-pull to damage the wire and plug, turn off circuit breakers and wall switch to the fan supply line leads.

- For a ceiling higher than 8 ft., you can purchase an extension downrod.

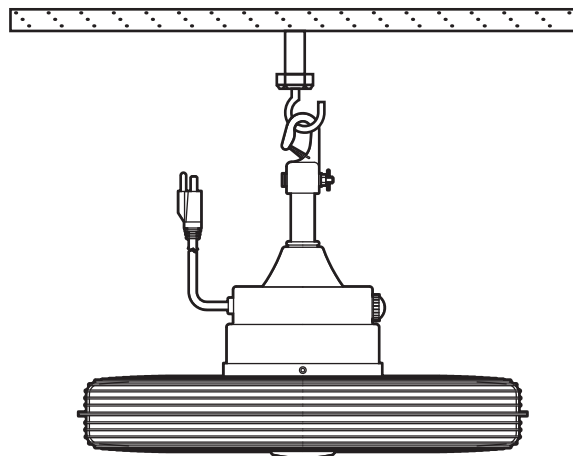

2 Angle mounting



NOTE: The preferred mounting method is to gazebos or pagodas. However, other mounting methods are also supported. For example, the fan can be mounted on a drywall, provided the surface supports a minimum weight of 30 lbs.

- Angle mounting is used for vaulted or angled ceilings. If using the angle mount, make sure the ceiling angle is not steeper than 30° and the open end of the mounting bracket (not included) is up and facing the ceiling.

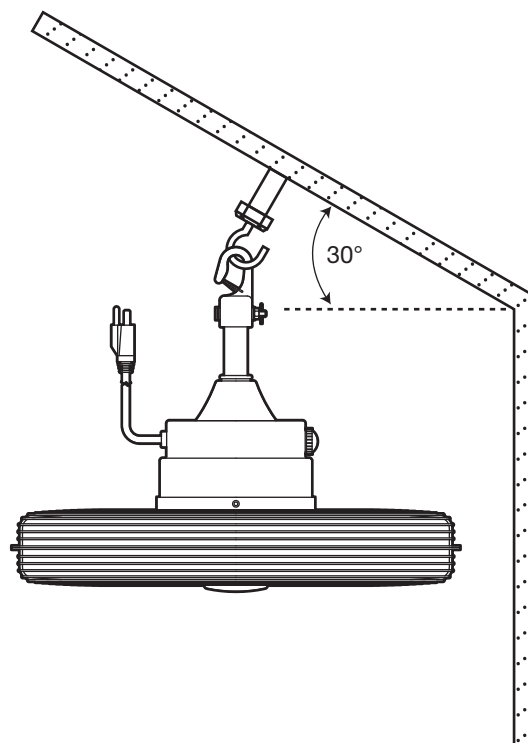

Assembly — Hanging the Fan

1 Preparing the motor

- Remove the cotter pin (BB), and clevis pin (AA), and loosen the two collar setscrews (CC) from the motor collar.

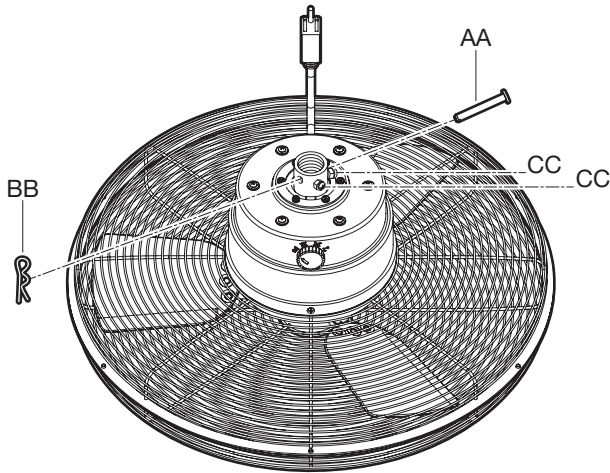

2 Assembling the fan



WARNING: Failure to properly install the cotter pin (BB) could result in the fan becoming loose and possibly falling.

- Insert downrod assembly (A) through coupling cover (B) into the holes in the collar on top of the fan motor assembly (C).
- Align the holes at the bottom of the downrod assembly (A) with the holes in the collar on top of the fan motor assembly (C).
- Carefully insert the clevis pin (AA) through the holes in the collar and the downrod assembly (A).
- Insert the cotter pin (BB) through the hole near the end of the clevis pin (AA) until it snaps into the locked position.
- Tighten the two collar setscrews (CC) on top of the fan motor assembly (C) firmly.

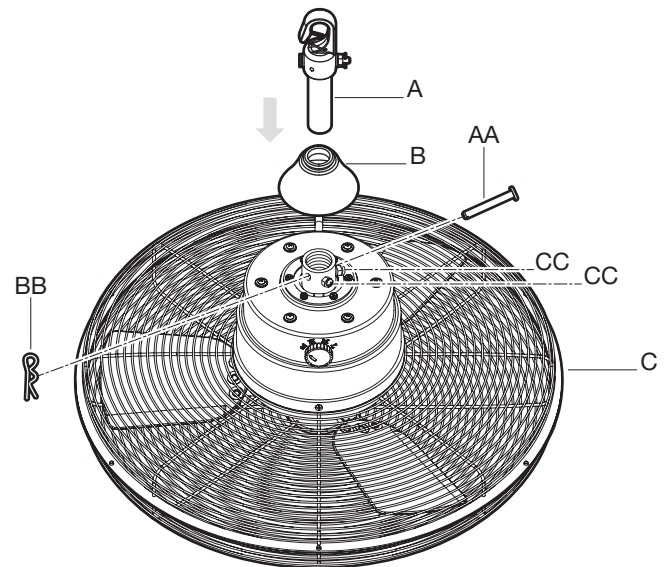

Assembly — Hanging the Fan (continued)

3 Secure the wire from motor

- Secure the wire from fan motor (C) to the downrod assembly (A) with rod clip (HH). Use set screw (II) and acorn nut (JJ) to tighten rod clip (HH).

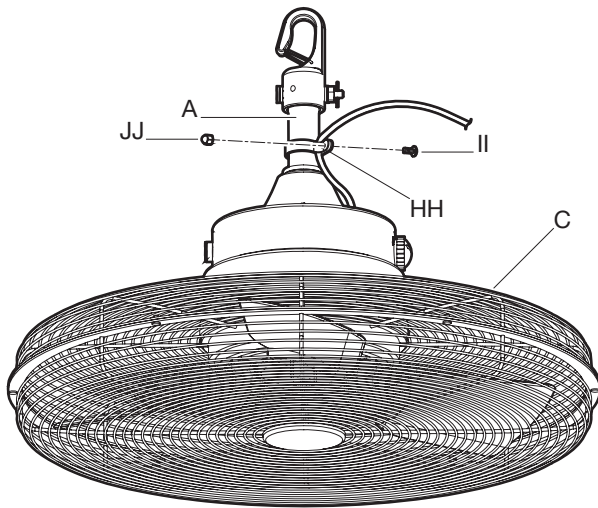

4 Attaching the fan motor assembly to the mounting bracket



WARNING: Ensure the hanging structure can support a minimum weight of 30 lbs and allow enough depth for safety mounting. If you are not sure the hanging structure can support the weight, do not attempt to install this fan as it may fall and cause damage to the fan or personal injury.

- For ceiling-mount installations, attach a standard mounting bracket (not included) (KK) to a ceiling or outdoor gazebo/pagoda per the bracket instructions. Then, attach the fan assembly (C) to the mounting bracket (not included) (KK) from the spring clip (LL) on downrod assembly (A).
- Peel the backing off the adhesive tape stripes on the bottom of the wire clips (GG). Attach the wire clips (GG) as needed to the wall or ceiling and press gently. Clip the power cord to the wire clips (GG). Plug the power cord into a ground 3-prong outlet. Once you restore power to the house, the fan is ready to use.

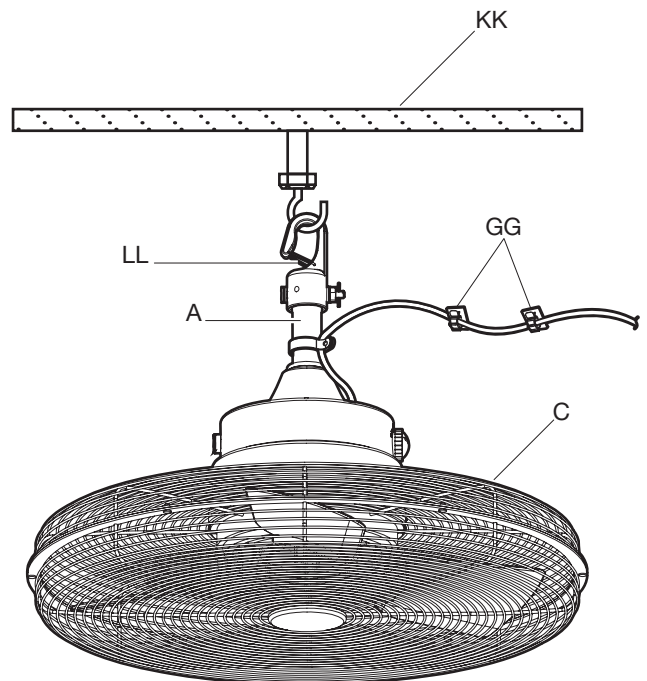

Disassembling Your Fan

This fan comes with a pre-assembled rear guard (D), blade assembly (E), and front guard (F) for your easy installation. Check that all screws are tight and securely in place.

If you need to disassemble the fan for any reason such as cleaning, follow these steps below:

- Loosen the front guard screws (FF) on the rear guard (D) to disassemble the front guard (F) from the rear guard (D).
- Detach blade assembly (E) from the fan assembly (C) by removing the blade arm screws with lock washers (DD). Disassemble blade and blade arm by removing the blade screws and rubber washers.
- Remove the rear guard (D) from the fan assembly (C) by loosening the rear guard screws (EE) from the fan assembly (C).

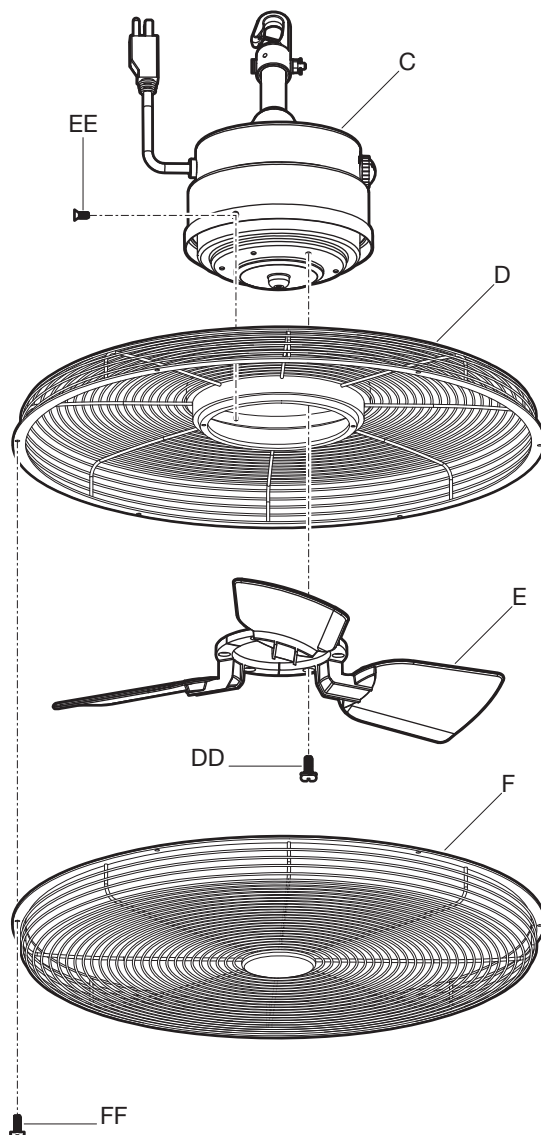

Operation

SWITCH OPERATING INSTRUCTIONS

It is recommended you test the fan before finalizing installation.
Restore power to the circuit box. Test fan speeds with the wall
control on the left side of fan assembly.

OFF = Turn the fan off

H = High speed

M = Medium speed

L = Low speed

If fan does not function properly, please refer to
“Troubleshooting” section.

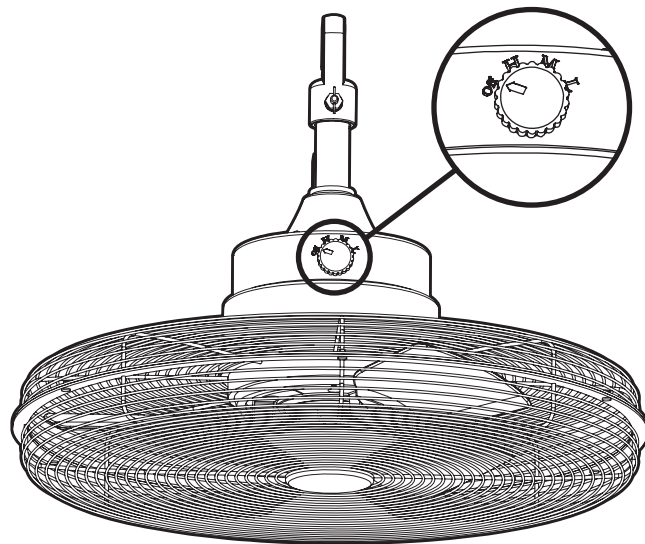

Care and Cleaning

Do

- Check the support connections, brackets, and blade attachments twice a year. Make sure they are secure. Because of the fan's natural movement, some connections may become loose over time. It is not necessary to remove the fan from the ceiling.
- Clean your fan periodically. Use only a soft brush or lint-free cloth to avoid scratching the finish. The plating is sealed with a lacquer to minimize discoloration or tarnishing.
- (Optional) Cover small scratches with a light application of shoe polish.

Do not

- Use water when cleaning. Water could damage the motor, or the wood, or possibly cause an electrical shock.
- Apply oil to your fan or motor. The motor has permanently-lubricated sealed ball bearings.

Troubleshooting

Problem	Solution
The fan will not start.	<ul style="list-style-type: none">□ Check the main and branch circuit fuses or breakers.
The fan sounds noisy.	<ul style="list-style-type: none">□ Make sure all screws on fan motor assembly and fan guards are snug.
	<ul style="list-style-type: none">□ Make sure the blade and the blade cover are securely in place.
	<ul style="list-style-type: none">□ Allow a 24-hour "breaking-in" period. Most noises associated with a new fan disappear during this time.

Service Parts

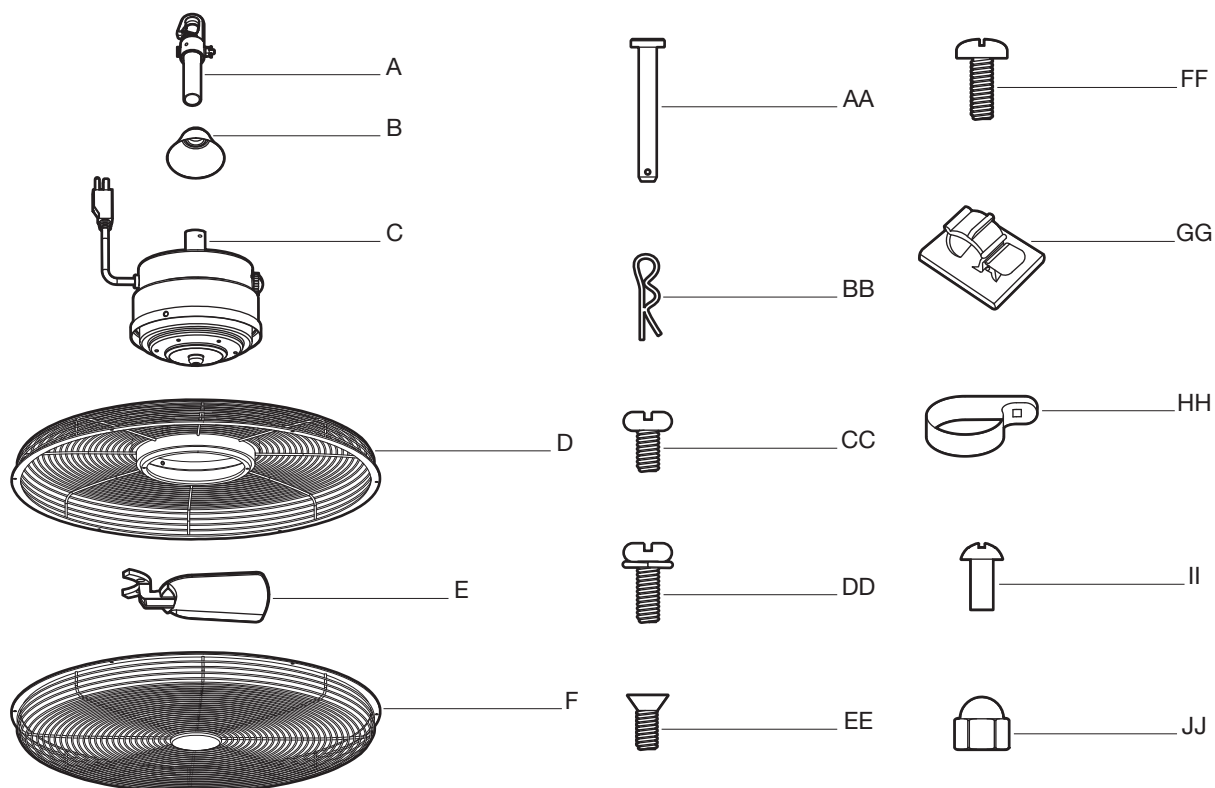

Part	Description
A	Downrod assembly
B	Coupling cover
C	Fan motor assembly
D	Rear guard (preassembled)
E	Blade assembly (preassembled)
F	Front guard (preassembled)

Part	Description
AA	Cotter pin (preassembled)
BB	Cross pin (preassembled)
CC	Collar setscrew (preassembled)
DD	Blade arm screw with lock washer (preassembled)
EE	Rear guard screw (preassembled)
FF	Front guard screw (preassembled)
GG	Wire clip
HH	Rod clip
II	Set screw
JJ	Acorn nut

HOME DECORATORS COLLECTION®

Questions, problems, missing parts? Before returning to the store,
call Home Decorators Collection Customer Service
8 a.m. - 7 p.m., EST, Monday-Friday, 9 a.m. - 6 p.m., EST Saturday

1-800-986-3460

HOMEDEPOT.COM/HOMEDECORATORS

Retain this manual for future use.