



X SERIES CHAIR

USER GUIDE

 **BREEO[®]**

HOW TO ASSEMBLE THE X SERIES CHAIR

PARTS & TOOLS INCLUDED

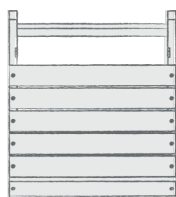

Seat x1

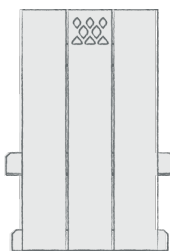

Back x1

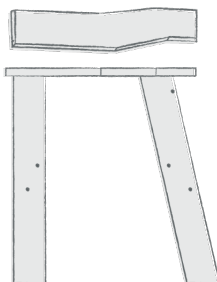

Left Arm x1

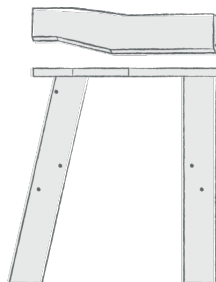

Right Arm x1

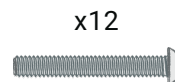

x12
Hex Bolts
(included)

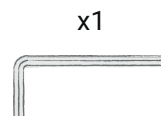

x1
Hex Key
(included)

STEP 1

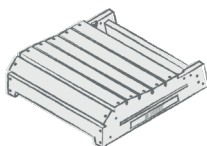

Lay the Seat on the ground with the legs down.

STEP 2

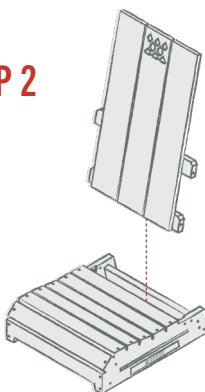

With the Breco logo facing up, slide the Back into the two diagonal slots on the Seat.

STEP 3

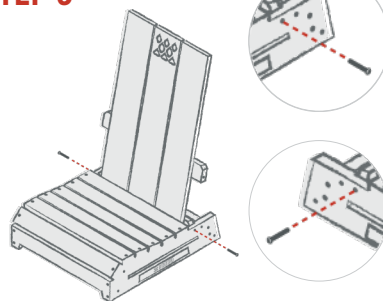

Use the hex key tool provided and 2 hex bolts provided and bolt the Back to the Seat.



Scan the QR code to watch an assembly video for the X Series Chair and to learn more.

BREEO PRO TIP

To prevent cross-threading the bolts, start every bolt by hand till it turns freely and smoothly in the thread. Then use the hex key tool to tighten down.

STEP 4

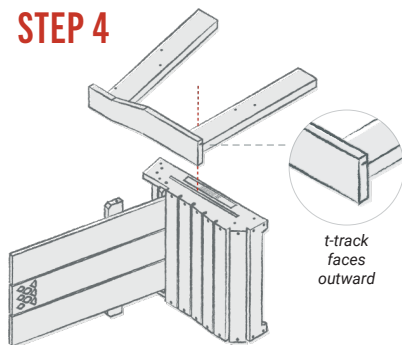

Flip assembled **Seat and Back** on its right side to attach the **Left Arm**. The t-track system should be on the outside of the arm.

STEP 5

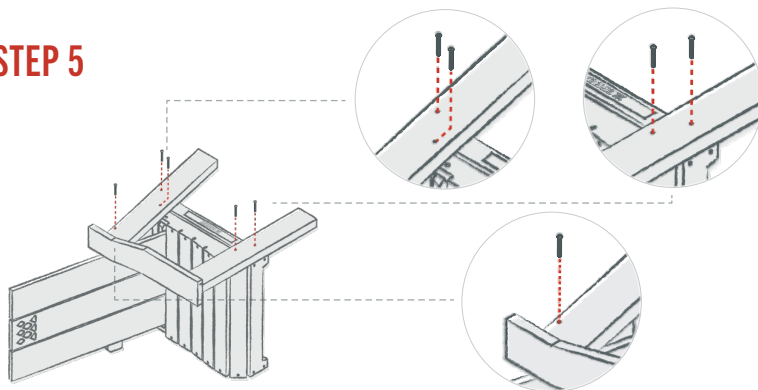

Use 4 of the hex bolts provided and bolt the **Left Arm** to the **Seat**.

Use 1 of the hex bolts provided and secure the slanted leg of the **Left Arm** to the **Back**.

STEP 6

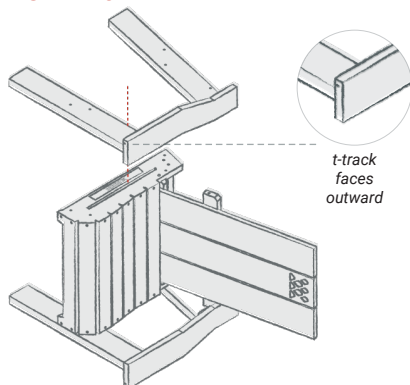

Flip the chair over to its left side and repeat the same steps as the other side.

STEP 7

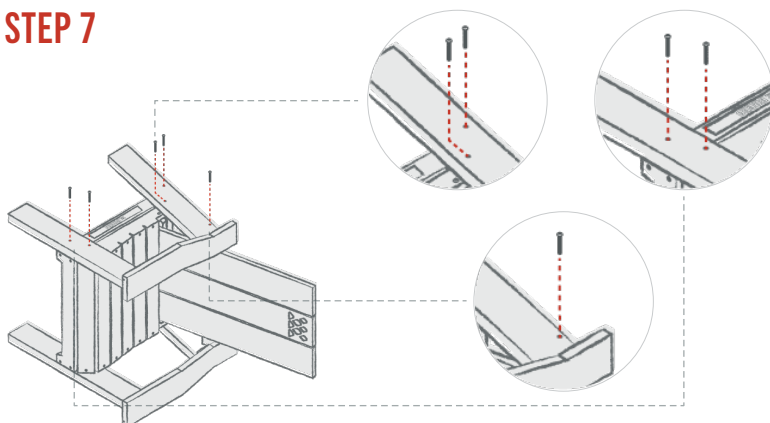

Use 4 of the hex bolts provided and bolt the **Right Arm** to the **Seat**.

Use 1 of the hex bolts provided and secure the slanted leg of the **Right Arm** to the **Back**.

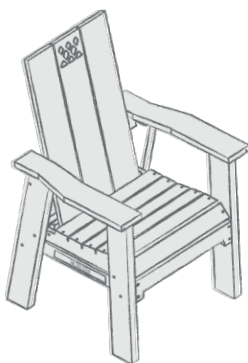

STEP 8

Finally, check all the bolts and make sure they are firmly tight. Set the chair on its legs, and your chair is ready to enjoy.



FOR YOUR SAFETY

Do not stand on the chair for risk of falling or injury.

Do not exceed any weight of 400 lbs on the X Series Chair.

CARE & CLEAN

For a quick clean, add dish soap and warm water to a bucket and wipe any dirt off the surface of the chair, rinse with clean water, and let it air dry.

HIGHLIGHTS & FEATURES

- Poly Lumber
- 20 Year Limited Warranty
- Made in the USA
- Higher Seat
- Forward Leaning Backrest
- OutRig Compatibility

Breeo X Series Limited Furniture Warranty

THIS LIMITED WARRANTY GIVES YOU SPECIFIC LEGAL RIGHTS AND YOU MAY ALSO HAVE OTHER RIGHTS, WHICH VARY FROM STATE TO STATE **What does this Limited Warranty cover?** Breeo, LLC (hereinafter "BREEO") warranties to the original purchaser ("Purchaser") that, for a period of twenty (20) years (except as specified below) of residential use from the date of purchase, under normal use and service conditions, BREEO® X Series furniture (the "product") shall be free from material defects, and shall not splinter, crack, chip, peel, or rot, or suffer structural damage from insect infestation. This warranty does not extend to any subsequent owner or other transferee of the product.

304 Stainless Steel Frames & Accessories. Welds and joints are warranted to not break or crack for five (5) years of residential use. **Hardware.** Hardware used in production or assembly of Breeo X Series furniture is warranted to not break for five (5) years of residential use.

Making a Claim. To make a claim under this limited warranty, Purchaser shall send to BREEO, within the warranty period referred to above, (1) a description of the BREEO® X Series furniture and claimed defect, (2) proof of purchase (including the serial number for the product), and (3) photographs of the defect to the following address: 5002 Lincoln Hwy E. Attn: Warranty Claims Kinzers, PA 17535 If a product is covered by this limited warranty, BREEO, at its option, will repair or replace the product with a new product free of charge, excluding any applicable shipping and handling charges. If the product being warranted has been discontinued, the replacement product will be of equal or similar value.

Exclusions from the Limited Warranty. The following items are specifically excluded from this Limited Warranty: BREEO shall not be liable for any failure, defect or damage resulting from or connected with the following: • Fading, color change or color match. To minimize possible fading: keep product covered, utilize cushions where applicable, minimize direct sunlight by storing product when not in use, or use a UV-protectant • Color or pattern variance between any new replacement section or pieces and other sections or pieces • Rust or corrosion of stainless steel or zinc coated steel hardware (please see Cleaning/ Maintenance information for details on how to maintain your hardware) • Damage caused by, among other things, use of incompatible accessories, intentional acts, unreasonable use, misuse, physical abuse, permanent deformation or destruction by human or animal, vandalism, riot, insurrection or civil disorder, accidents or corrosive atmospheres (such as those contaminated by acid rain, harmful chemicals or vapors), or any act of God (such as fire, flooding, hurricane, earthquake, tornado, lightning, We reserve the right to discontinue or modify any product line or color without notifying the Purchaser. If the original product is not available, we retain the right to choose to provide replacement material of equal value or quality. No person or entity is authorized by BREEO to make and BREEO shall not be bound by any statement or representation as to the quality or performance of BREEO products other than as contained in this warranty. This warranty may not be altered or amended except in a written instrument signed by BREEO and Purchaser. Proper maintenance of your product is required to support the benefits of this warranty. This warranty is voided in the event that there are indications of abuse or neglect to the furniture. This warranty does not apply to normal wear and tear effects on BREEO products, which are received by regular use of the products.

This warranty is effective for products purchased on or after 4/1/2022.

THIS WARRANTY IS EXPRESSLY IN LIEU OF ALL OTHER WARRANTIES, EXPRESS OR IMPLIED, INCLUDING THE WARRANTY OF MERCHANTABILITY AND FITNESS FOR A PARTICULAR PURPOSE. NO ORAL AGREEMENT, GUARANTEE, PROMISE, REPRESENTATION OR WARRANTY SHALL BE BINDING. IN NO EVENT WILL BREEO BE LIABLE FOR ANY SPECIAL, INDIRECT, INCIDENTAL OR CONSEQUENTIAL DAMAGES EVEN IF BREEO HAS BEEN ADVISED OF THE POSSIBILITY OF SUCH DAMAGES AND EVEN IF BREEO HAS KNOWLEDGE THAT FAILURE TO PERFORM COULD CAUSE CONSEQUENTIAL ECONOMIC LOSSES. IN ANY EVENT, CUMULATIVE DAMAGES FOR BREACH OF THIS WARRANTY WILL BE LIMITED TO THE AMOUNT ACTUALLY PAID TO BREEO FOR THE PRODUCT. THIS PARAGRAPH SHALL APPLY TO ALL ACTIONS RELATED TO THE PRODUCT, WHETHER BASED ON TORT, CONTRACT OR OTHER THEORIES. THE PURCHASER ACKNOWLEDGES THAT THIS PARAGRAPH ALLOCATES THE RISK OF PRODUCT FAILURE BETWEEN BREEO AND THE PURCHASER, AND THAT THIS ALLOCATION IS REFLECTED IN THE PRICE PAID. Some states do not allow the exclusions or limitations of incidental or consequential damages, so the above limitations or exclusions may not apply to you. This warranty gives you specific legal rights, and you may also have other rights that vary from state to state. This warranty shall only be applicable and enforceable in the United States of America and Canada.



WWW.BREEO.CO
(800) 413-9848
CONTACT@BREEOLLC.COM

