



Item #1003 930 514
Model #HD4795-DIP

USE AND CARE GUIDE

3.5 TON LOW PROFILE FLOOR JACK WITH SPEEDY LIFT

Questions, problems, missing parts?
Before returning to the store, call
Husky Customer Service
8 a.m. - 7 p.m., EST, Monday - Friday, 9 a.m. - 6 p.m., EST Saturday

1-888-HD-HUSKY

HUSKYTOOLS.COM

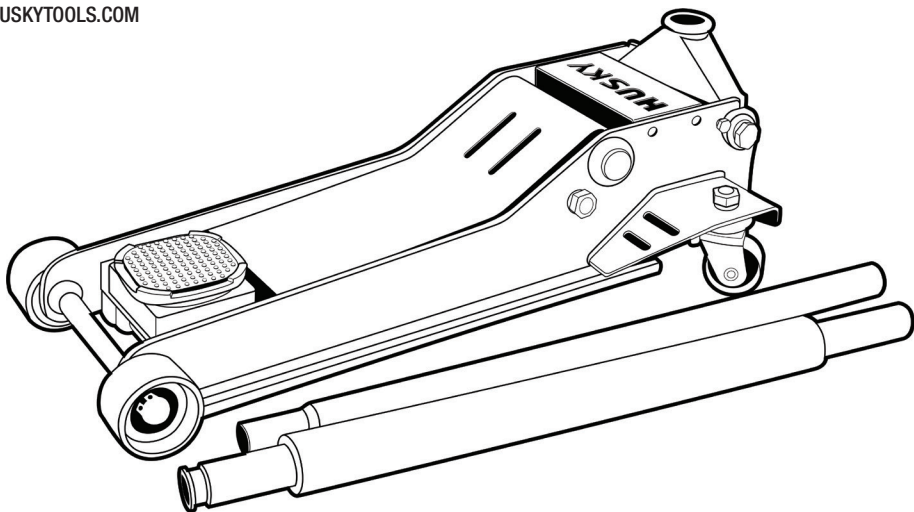

THANK YOU

We appreciate the trust and confidence you have placed in Husky through the purchase of this jack kit. We strive to continually create quality products designed to enhance your home. Visit us online to see our full line of products available for your home improvement needs. Thank you for choosing Husky!

Table of Contents

Safety Information	2
Warranty	2
Pre-Operation	3
Before Assembly and Operation	3
Specifications	3
How It Works	3
Garage Jack Package Contents	3
Jack Operation	4-5
Tool Set Up	5-6
Attaching the Handle	5
Bleeding	6
Adding Oil	6

Care and Cleaning	7
Inspection	7
Maintenance	7-9
Replacing Hydraulic Jack Oil	8
Lubricating the Jack	8
Storing the Jack	8
Cleaning the Jack	9
Troubleshooting	10
Exploded View	11

Safety Information

READ AND SAVE THESE INSTRUCTIONS

1. Read, understand, and follow all instructions before operating this device prior to use.
2. Do not overload this jack beyond the rated capacity.
3. This jack is designed for use only on hard level surfaces capable of sustaining the load. Use on other than hard level surfaces can result in jack instability and possible loss of load.
4. This is a lifting device only. Immediately after lifting, support the vehicle with jack stands.
5. Inspect the jack prior to each use. Do not attempt use if the unit is broken, bent, cracked, or has missing and/or damaged parts. Replace broken, bent, cracked, missing and/or damaged parts, and/ or missing labels, warnings and/or decals with factory authorized parts prior to use.



DANGER: Because of the potential hazards associated with the misuse of equipment of this type, no alterations shall be made to the product without written authorization of the manufacturer or supplier.



WARNING: Do not get under or allow anyone under the vehicle until it has been supported by jack stands.



WARNING: For your safety and to prevent injury, use the service jack for lifting purposes only.



WARNING: This jack is a lifting device only. It is not a support device. NEVER place yourself under or near a raised vehicle supported by a jack. Immediately after lifting, support the vehicle with jack stands or other appropriate means.



CAUTION: Do not move or dolly the vehicle while on the jack.



CAUTION: Any jack that appears to be damaged or has worn parts should be removed from service immediately.



IMPORTANT: Lift only on areas of the vehicle as specified by the vehicle manufacturer. Use the vehicle manufacturer's instructions on proper lifting.



NOTE: Center the load on the saddle prior to lifting.



NOTE: Use of garage and bottle jacks on sea vessels is prohibited.



NOTE: Some vehicles require an adapter to properly engage the frame for lifting



NOTE: Failure to heed these warnings may result in personal injury and/or property damage.

Warranty

The manufacturer warrants the products to be free from defects in materials and workmanship for a period of one (1) year from the date of purchase. This warranty applies only to the original consumer purchaser and only to products used in normal use and service. If this product is found to be defective, the manufacturer's only obligation, and your exclusive remedy, is the repair or replacement of the product at the manufacturer's discretion, provided that the product has not been damaged through misuse, abuse, accident, modifications, alteration, neglect, or mishandling. This warranty shall not apply to any product as a result of an accident, misuse, abuse, negligence, alteration, faulty installation, or any other failure not relating to faulty material or workmanship. This warranty shall not apply to the finish on any portion of the products such as surface and/or weathering, as this is considered normal wear and tear.

The manufacturer does not warrant and specially disclaims any warranty, whether express or implied, of fitness for a particular purpose, other than the warranty contained herein. The manufacturer specifically disclaims any liability and shall not be liable for any consequential or incidental loss or damage, including but not limited to any labor/expense costs involved in the replacement or repair of said product.

Contact the Customer Service at 1-888-HD-HUSKY or visit www.huskytools.com.

BEFORE ASSEMBLY AND OPERATION

Compare all parts with the Package Contents lists in this manual. If any part appears missing or damaged, do not use this product. Contact the Customer Service at 1-888-HD-HUSKY or visit www.huskytools.com.

SPECIFICATIONS

Model	Jack Dimensions	Max Load Capacity	LiftingRange	Saddle Dimensions	Jack Weight
3.5 Ton Low Profile Floor Jack	30.12in. x 14.41in. x 6.50in.	7,000 lbs	3.74 to 21 in.	4.56 in. Diameter	101.2 lbs.

HOW IT WORKS

The jack power unit consists of a plunger, plunger cavity, hydraulic oil reservoir, cylinder, and ram. An upward stroke of the jack handle draws oil from the reservoir into the plunger cavity. Hydraulic pressure closes a valve that keeps oil in the cavity. A downward stroke of the jack handle forces oil into the cylinder, pushing out the ram and raising the saddle.

 **NOTE:** As a protective feature, when the ram reaches maximum extension, sufficient oil passes back into the reservoir to prevent an overextended ram stroke and possible jack damage.

When the release valve is open, oil flows back into the reservoir, causing the ram to retract, lowering the saddle.

GARAGE JACK PACKAGE CONTENTS

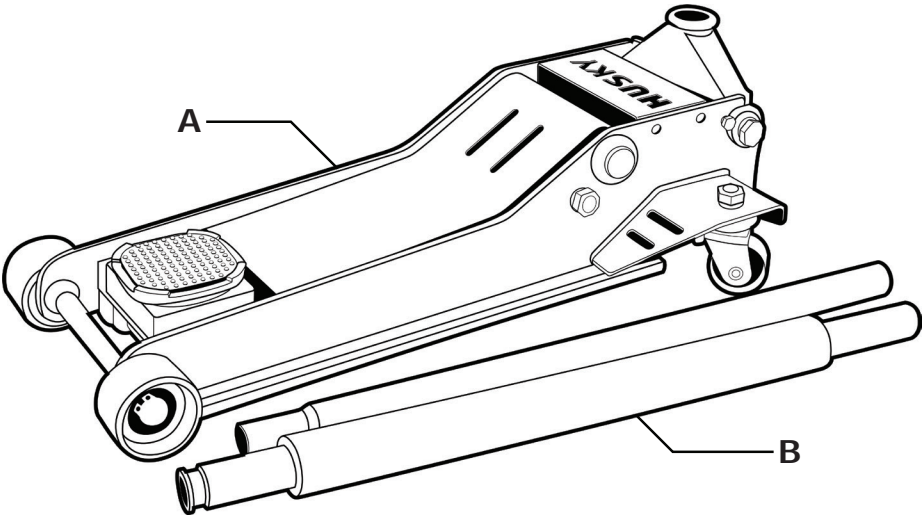

Part	Description	Quantity
A	3.5 Ton Floor Jack	1
B	Handle	1

Jack Operation

1 Inserting the handle

- Insert the handle (B) into the handle socket of the jack (A). Ensure the pin on the lower end of the handle (B) snaps into the socket slot.

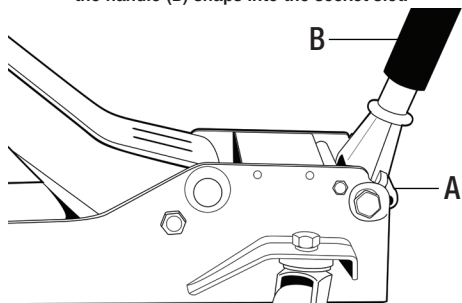

2 Placing the vehicle in park

- Place the vehicle in PARK and apply the emergency brake.

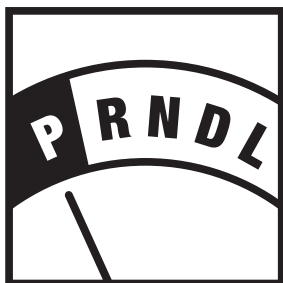

3 Closing the jack

- Close the jack release valve by turning the handle (B) clockwise.

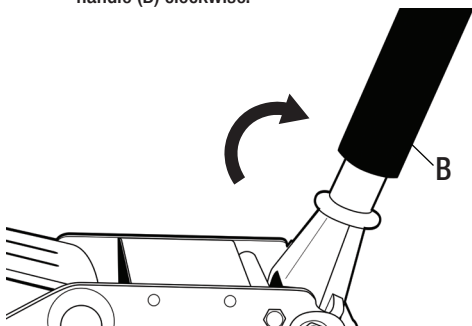

4 Blocking the wheels

- Block the vehicle wheels that are not being raised.

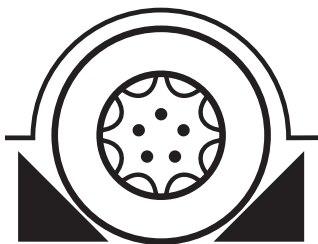

5 Centering the jack

- Center the jack under the load so that the saddle (1) contacts the load firmly and will not slip. (Refer to the vehicle manufacturer's owner's manual to locate the approved lifting points on the vehicle).

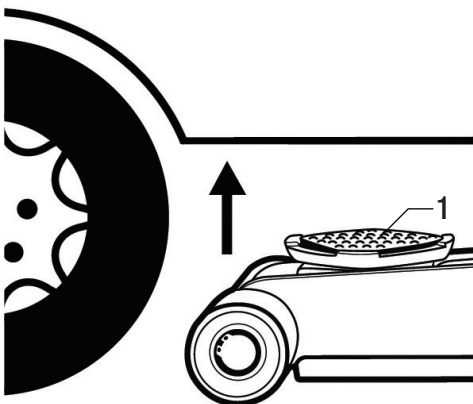

Jack Operation (continued)

6 Lifting the vehicle



WARNING: To avoid pinching or crushing hands or feet, ALWAYS keep them clear of the jack hinge and ground contact area when lowering the vehicle. The jack is a lifting device only. DO NOT move or dolly the vehicle while it is on the jack.

- Pump the jack handle (B) until the saddle (1) nears contact with the vehicle. Check to see that the saddle (1) is centered and will contact the lifting point firmly.
- Continue to pump the jack handle (B) to lift the vehicle to a height slightly above the jack stands or other supports. Then turn the handle (B) very slowly counterclockwise to open the release valve to lower the vehicle onto the supports.

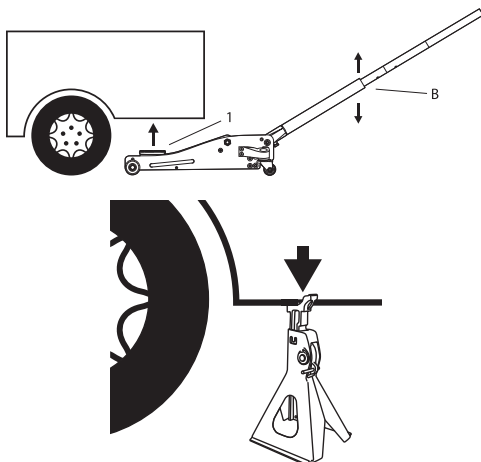

Tool Set Up

ATTACHING THE HANDLE

1. Fasten the Upper handle to the Lower Handle.
2. Loosen the Set Screw and insert the assembled Handle into the Handle Socket.
3. Tighten the Set Screw.

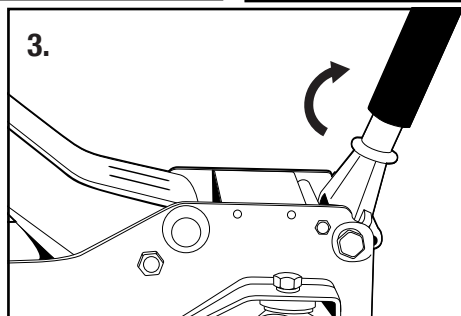
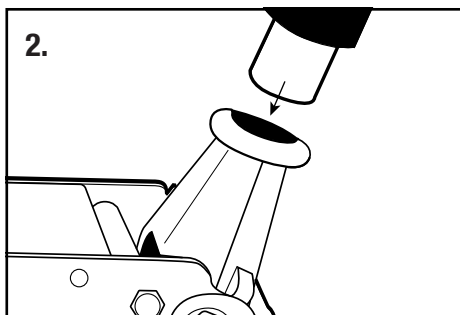
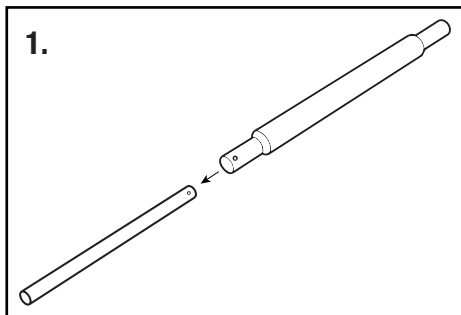

Tool Set Up (continued)

BLEEDING

1. Loosen the Fill Screw.
2. Insert the Handle into the Handle Socket to operate the Release Valve.
3. Turn the Handle counterclockwise to open the valve.
4. Pump the Handle up and down quickly several times to purge air from the system.
5. Tighten the Fill Screw.

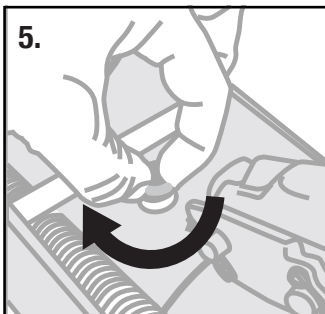
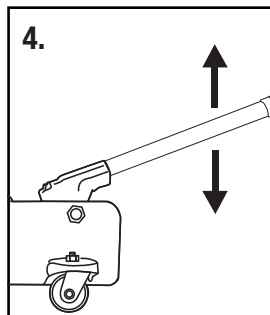
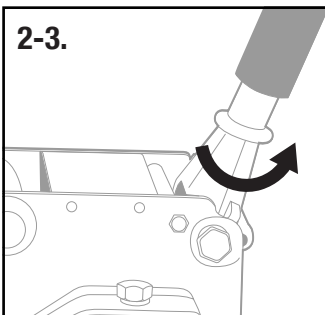
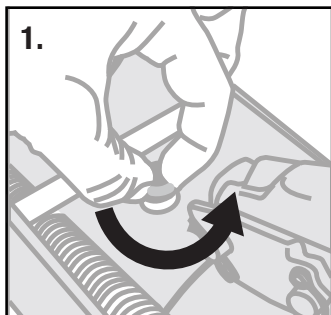

ADDING OIL

1. Remove the Fill Screw. (See above for Fill Screw Location)
2. Add high grade hydraulic fluid into the Fill Screw slowly until the oil reaches the top of the oil fill hole.
3. Replace the Fill Screw.



NOTE: Do not touch the handle when adding hydraulic oil.

Care and Cleaning

INSPECTION

Maintain the product according to these instructions. You may not alter this product in any way.

1. Before using, inspect the jack thoroughly. Look for cracks in the welds, bent, damaged, loose, worn or missing parts.
2. Inspect according to this manual **ONLY**.
3. If the jack has been subjected to abnormal load or shock (abuse), perform an immediate inspection. Take the product to a local customer service representative for an authorized inspection before use.

Maintenance

REPLACING HYDRAULIC JACK OIL TO THE JACK

1 Opening the release valve

- Open the release valve by turning the handle counterclockwise.

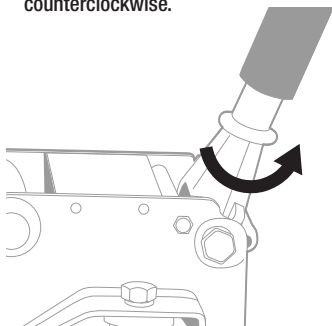

2 Removing the plug

- Remove the oil fill plug.

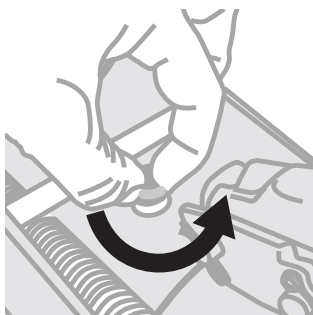

3 Draining the old oil

- Turn the entire jack over so that all of the old oil will drain out of the oil fill hole.

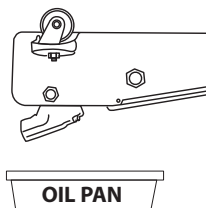

NOTE: When draining oil, use a proper container and always follow all local and state waste disposal guidelines.

4 Leveling the jack

- After all of the old oil has drained out of the jack, turn the jack back over to a level position.

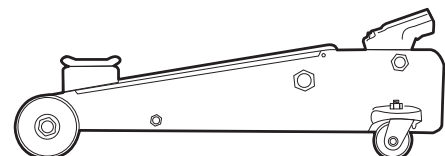

5 Releasing pressurized air

- Rapidly pump the jack handle 6 to 8 strokes to release any pressurized air.

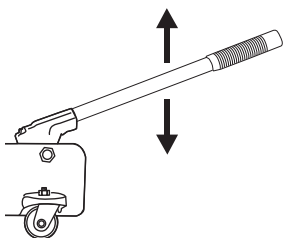

6 Filling with new oil

- Using a good grade of SAE 5W hydraulic jack oil, fill the reservoir to the bottom of the threads in the oil fill hole. Replace and tighten the oil fill plug. Do not allow dirt and debris to enter the system.



Maintenance (continued)

Lubricating the jack

- Use a good grade of lubricating oil on all moving parts when needed (arm linkages, front wheels and rear casters).



Storing the jack

- When the jack is not in use, or when storing the jack, ALWAYS have the saddle in its lowest (down) position.
- Store the jack in a dry location with all wheels touching the ground on a relatively level position.

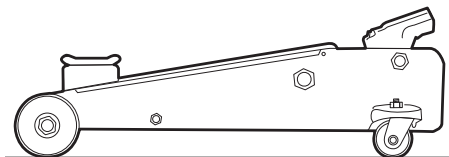

RUST PREVENTION

Check the ram and pump piston every two months (or sooner, based on usage) for any signs of rust or corrosion. Clean as needed and wipe down with an oil cloth.

CLEANING, MAINTENANCE AND LUBRICATION



CAUTION: To prevent serious injury from tool failure: Do not use damaged equipment. If abnormal noise or vibration occurs, have the problem corrected before further use.



IMPORTANT: Procedures not specifically explained in this manual must be performed by a qualified technician.

1. Before each use, inspect the general condition of the jack. Check for broken, cracked or bent parts, loose or missing parts, and any condition that may affect the proper operation of the product. If a problem occurs, have the problem corrected before further use.

DO NOT USE DAMAGED EQUIPMENT

2. Before each use, thoroughly test the jack for proper operation prior to its actual use. If the jack appears not to be working properly, follow bleeding instructions on page 5.

3. Change the hydraulic oil at least once every three years.

A. With the jack fully lowered, remove the Oil Filler Plug on the side of the housing.

B. Tip the jack to allow the old hydraulic oil to drain out of the housing completely, and dispose of the old hydraulic fluid in accordance with local regulations.

C. With the jack upright, completely fill the housing with a high quality hydraulic oil (not included) until the oil is 1/4" below the fill hole.

D. Open the valve by turning the handle counterclockwise and pump the handle to bleed air from the system.

E. Recheck oil level and re-fill as needed.

F. Reinstall the Oil Filler Plug.

4. Wipe dry with a clean cloth. Then, store the jack in a safe, dry location out of reach of children and other non-authorized people.

Troubleshooting

Problem	Probable Cause	Solution
The jack will not lower completely.	<ul style="list-style-type: none"> <input type="checkbox"/> There is air in the hydraulic system. <input type="checkbox"/> The release valve is stuck. 	<ul style="list-style-type: none"> <input type="checkbox"/> Purge air from the hydraulic system. <input type="checkbox"/> Transfer the weight load and clean the valve.
The jack will not hold weight.	Release the valve in open position. Check the locking pin and release handle to make sure they are functioning properly.	Close the release valve tightly.
The jack will not raise.	<ul style="list-style-type: none"> <input type="checkbox"/> The oil level is low. <input type="checkbox"/> There is air in the hydraulic system. 	<ul style="list-style-type: none"> <input type="checkbox"/> Fill to recommended level. <input type="checkbox"/> Purge air from the hydraulic system.
The jack lifting is weak.	<ul style="list-style-type: none"> <input type="checkbox"/> There is air in the hydraulic system. <input type="checkbox"/> The oil is dirty. <input type="checkbox"/> The release valve is not completely closed. 	<ul style="list-style-type: none"> <input type="checkbox"/> Purge air from the hydraulic system. <input type="checkbox"/> Change the oil. <input type="checkbox"/> Close the release valve tightly.
The jack will not lift the load.	<ul style="list-style-type: none"> <input type="checkbox"/> The weight is excessive. <input type="checkbox"/> The release valve is in the open position. <input type="checkbox"/> The oil level is low. 	<ul style="list-style-type: none"> <input type="checkbox"/> Decrease the weight or change to a higher capacity jack. <input type="checkbox"/> Turn the valve clockwise and tighten. <input type="checkbox"/> Fill to a recommended level.
The lift arm will not lower.	Check the locking pin and release handle to make sure they are functioning properly.	Call customer service.

WARNING: TO PREVENT SERIOUS INJURY: Use caution when troubleshooting a malfunctioning jack. Stay clear of the supported load. Completely resolve all problems before use. If the solutions presented in the Troubleshooting guide do not solve the problem, have a qualified technician inspect the and repair the jack before use.



After the jack is repaired: Test it carefully without a load by raising and lowering it fully, checking for proper operation, BEFORE RETURNING THE JACK TO OPERATION

WARNING: Park vehicle on a flat, level, solid surface safely away from oncoming traffic. Turn off the vehicle's engine. Place the vehicle's transmission in "PARK" (if automatic) or in its lowest gear (if manual). Set the vehicle's emergency brake. Then, chock the wheels that are not being lifted.



WARNING: The rated capacity of jack stands is per pair, not the individual capacities combined unless specifically noted on the product by the jack stand manufacturer. Do not exceed rated jack stand capacity. Ensure that the vehicle support points are fully seated in the saddle of both jack stands. Use a matched pair of jack stands per vehicle to support one end only. Failure to do so may result in the load suddenly falling, which may cause personal injury and/or property damage.



Exploded View

3.5 TON LOW PROFILE FLOOR JACK

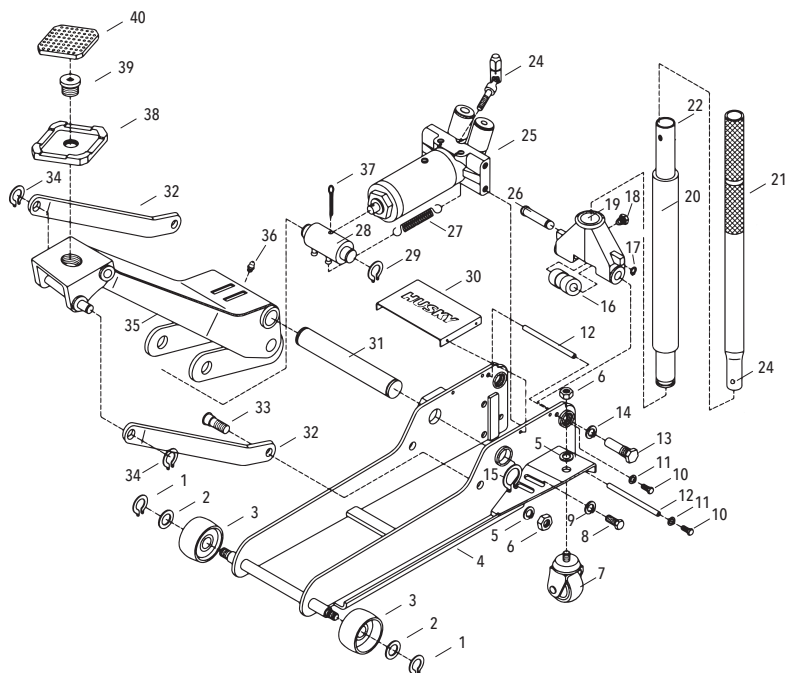

Part	Description	Quantity	Part	Description	Quantity
1	Retaining Ring M20	2	21	Upper Handle	1
2	Washer	2	22	Lower Handle	1
3	Front Wheel	2	23	Upper Handle Detent	1
4	Frame	1	24	Universal Joint	1
5	Spring Washer M16	4	25	Power Unit Assembly	1
6	Nut M16	4	26	Connect Rod	1
7	Rear Caster Assembly	2	27	Return Spring	2
8	Bolt M12x22	4	28	Connecting Rod	1
9	Spring Washer M12	4	29	Retaining Ring M25	2
10	Bolt M8x22	4	30	Cover Plate	1
11	Spring Washer M8	4	31	Spindle-Lift Arm	1
12	Tie Rod	2	32	Side Link	2
13	Bolt-Handle Yoke	2	33	Screw-Side Link	2
14	Spring Washer M18	2	34	Retaining Ring M16	2
15	Retaining Ring M30	2	35	Lifting Arm Assembly	1
16	Handle Yoke Roller	1	36	Grease Fitting	1
17	Retaining Ring M12	1	37	Split Pin 4x55	1
18	Set Screw-Handle	1	38	Saddle	1
19	Handle Yoke	1	39	Saddle Screw	1
20	Handle Bumper	1	40	Rubber Pad	1



Questions, problems, missing parts?
Before returning to the store,
call Husky Customer Service
8 a.m. - 7 p.m., EST, Monday - Friday, 9 a.m. - 6 p.m., EST Saturday

1-888-HD-HUSKY

WWW.HUSKYTOOLS.COM

Retain this manual for future use.