

# HIWMA1BLE40AWH



Standard  
Light Fixtures



HALO Home™  
In-Wall Smart  
Dimmer



HALO Home™  
App

- Controls standard lighting lamps and fixtures.
- Max 600W incandescent / 30W LED or CFL.
- Must have switch installed and wired to a standard light to use switch.
- Indoor use only.

Only  
use with  
non-smart  
lights



Press to turn on

Up/down for dimming

Press to turn off

LED indicator

## 1 Install in-wall smart dimmer

- Follow installation instructions provided with switch.
- Make sure the LED indicator on your dimmer is illuminated.

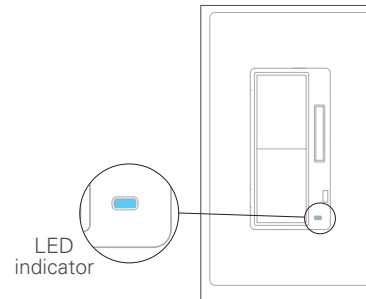

LED  
indicator

## 2 Adding the smart dimmer switch to the APP

- Open to the HALO Home app.
- Press the "☰" menu button in the upper left and navigate to "Devices"; then press the "+" button on the screen.
- The switch will appear on the screen.
- Select the switch and press "Done." It may take up to 30 seconds for this process to complete.
- You can now associate it to a device.



Powering Business Worldwide