

ProVantage 4-in Series Glass Block Installation System

- Mortar Free Method, Install With Glass Block Silicone
- Finish Joints Using Silicone or Grout
- Components Include: Horizontal Spacer, Vertical Spacer, Silicone, Vertical Half Spacer, Perimeter Channel or Framing Anchor

A 4-in Thick
Horizontal Spacer
Model #: PVHORSP
*Stock Model #: PVHORSP4



B 4-in Thick
Vertical Spacer
Model #: PVVERSP
*Stock Model #: PVVERSPB



C 4-in Thick
Redi2Bond Silicone
Model #: R2BSIL
*Stock Model #: R2BSILT

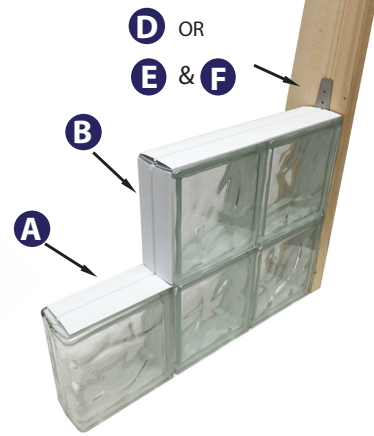

D 4-in Thick
Perimeter Channel
Model #: VPC4
*Stock Model #: 4VPC3



E 4-in Thick
Vertical Half Spacer
Model #: PVHALF4



F 4-in Thick
Framing Anchor
Model #: PVANCP
*Stock Model #: PVANCP1

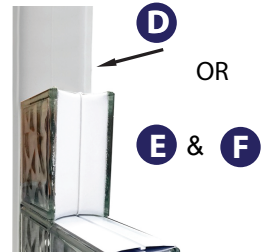

Traditional Mortar Glass Block Installation System

- Install With Mortar For a Classic "Grid Look"
- Components Include: Mortar Spacers, Panel Reinforcing, Expansion Strips, Panel Anchors or Perimeter Channel

A Mortar Spacers
Model #: SPACERGBU
*Stock Model #: SPACERGB1

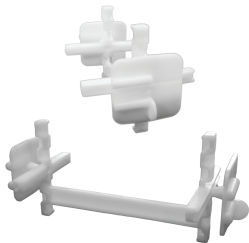

B Panel Reinforcing
Model #: SSREINFORCE
*Stock Model #: SSREIN6



C Expansion Foam
Model #: FOAMEXP3
*Stock Model #: FOAMEXP12



D 4-in Thick
Perimeter Channel
Model #: VPC4
*Stock Model #: 4VPC3



E Panel Anchors
Model #: SSANCHOR
*Stock Model #: SSANCHOR6

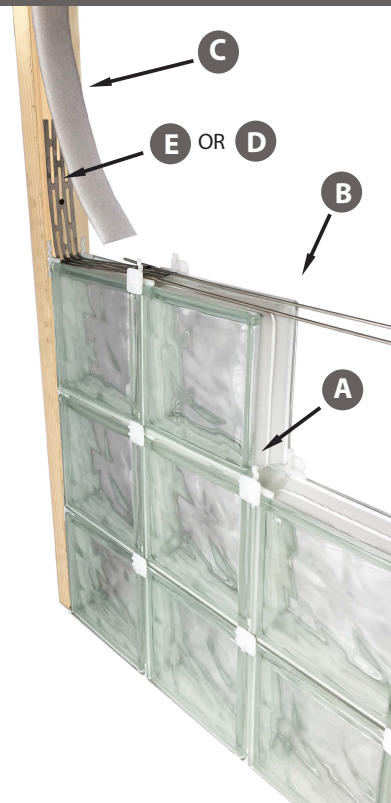
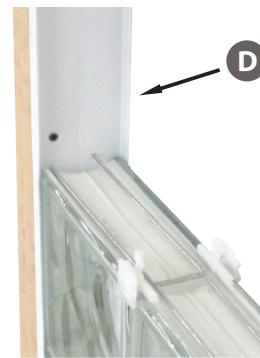
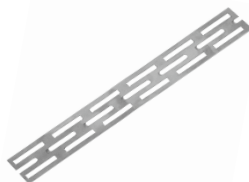

*Stock products available in select stores only.
Please refer to your local Home Depot for stock availability.