

## USING THE HOMEBARISTA® REUSABLE FILTER CUP

The Single-Serve Coffeemaker can be used with a reusable coffee capsule (not included), which allows you to use your own ground coffee.

Try the Cuisinart HomeBarista® Reusable Filter Cup for your favorite coffee or tea. Available in stores.

1. Fill the filter basket inside the reusable capsule with your ground coffee.

**Max fill is 15 grams  
(2½ scoops)**



2. Remove the capsule chamber from the brew head and insert reusable filter cup.



3. Follow steps 3 and 4 of the "SINGLE SERVE: BREWING" directions on the previous page.



4. After brewing, replace the capsule holder, ensuring arrow on capsule rim aligns with arrow on brewing chamber. Gently push down to snap into place.



For more helpful hints, see Instruction Booklet.

## QUICK REFERENCE GUIDE

# Cuisinart®

Coffee Center® GRIND & BREW PLUS



## INITIAL SETUP

1. Fully immerse and soak the 2 charcoal water filters in cold tap water for 15 minutes (see instruction booklet, page 8). Remove water filter holders from both 12-Cup Coffeemaker and Single-Serve reservoirs.



2. Press down and pull forward on filter compartments to open, and place filters in holders. Snap to close, run under water for 10 seconds and drain completely.

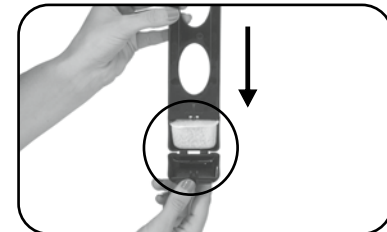

3. Slide filter holders back into channels in reservoirs.



## BEFORE FIRST USE

Before using your Coffee Center® Grind & Brew Plus for the first time:

**12-Cup Coffeemaker:** Follow steps 1, 3, 4 and 5 on the following page, using only water to thoroughly rinse the coffeemaker.

**Single-Serve Coffeemaker:** Follow steps 1–4 on the following page, without a capsule to thoroughly rinse the coffeemaker.

Your unit is now ready to use.

## 12-CUP CARAFE: BREWING

- 1.** Pour your desired amount of water into the water reservoir. A water level indicator is located on the side of the unit.



- 2.** Lift the grinder basket lid, using the recess on either side. Fill the basket with the desired quantity of beans and replace lid. *Skip this step when brewing pre-ground coffee.*



- 3.** Press the door release button, and insert a paper filter or permanent filter into the filter basket. *When brewing with pre-ground coffee, add 1 level scoop of ground coffee per cup. Do not exceed 16 tablespoons.* Replace the cover, and close door.



- 4.** Press the CARAFE button to activate carafe brew mode. Press BOLD if you prefer a stronger taste.

*When brewing pre-ground coffee, be sure to press the GRIND OFF button to turn off the grinder.*



- 5.** Press the BREW/OFF/AUTO OFF button to begin brewing. Once the coffee has finished, the unit will enter Keep Warm mode and alert you with a beep.



## SINGLE SERVE: BREWING

- 1.** Add water into the 40-ounce water reservoir. Plug the power cord into an independent outlet.



- 2.** Place mug on tray, open the brew head and insert capsule. **NOTE:** Shelf flips down to accommodate shorter mugs and the drip tray can be removed to accommodate travel mugs.



- 3.** Press the POD button once to enter single-serve mode. Use the POD button to continuously scroll through size options until the desired cup size setting is displayed on the LCD display (8, 10, or 12 oz).



- 4.** Press the BREW/OFF/AUTO OFF button once. When beverage has finished dispensing, all lights will illuminate. Lift brew head to dispose of the capsule.

