

Let's build the

Aaron Desk

SKU 56001

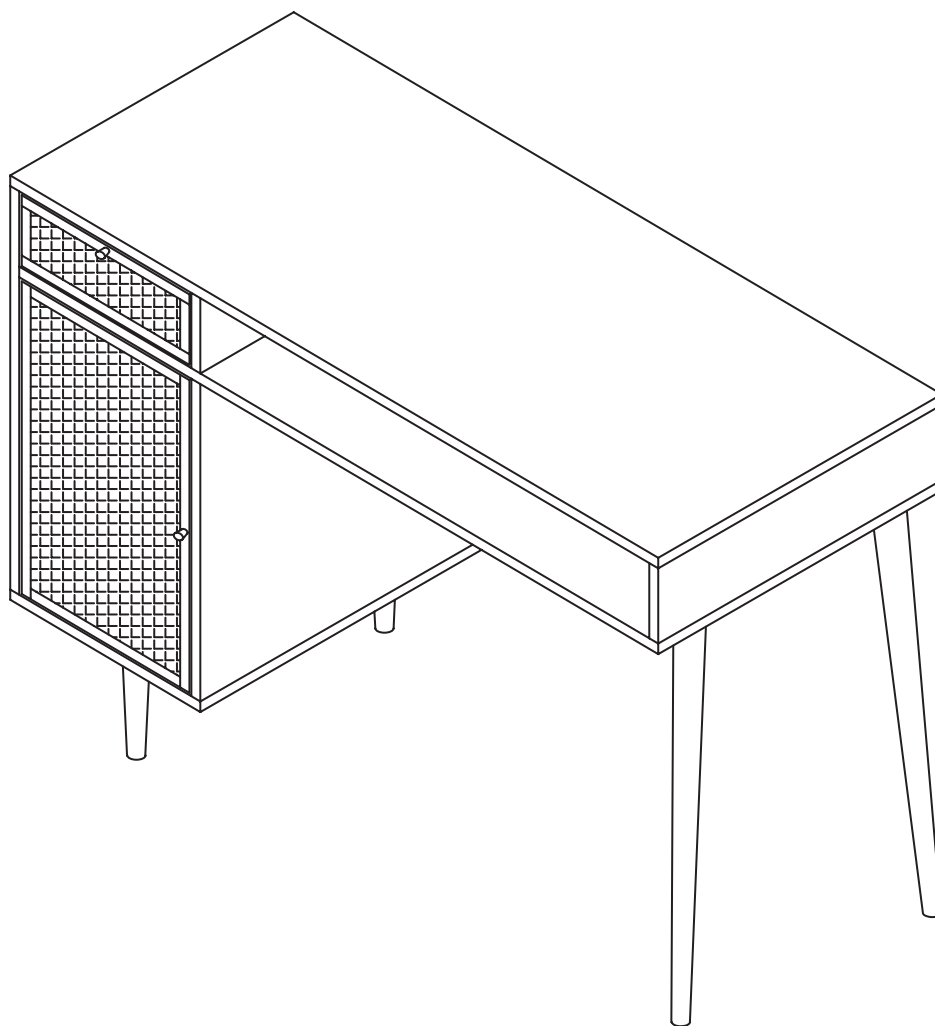

Scan me!

Free Lifetime
Warranty

nathan james

23-0414

Ok, let's get rolling

This should be easy, just follow our instructions and you will be back to Netflix in no time.

Estimated time for assembly



60:00

What you need

- Some of your favourite bubbly or your preferred relaxant
- Use the packaging carton as a working surface to prevent product damage during assembly
- Phillips head screwdriver
- Drill
- 1/4" Drill bit (for non-drywall)
- 5/16" Drill bit (for drywall)

Weight Limitation



Max. Weight: 100 lbs.
Tabletop: 40 lbs.
Drawers: 10 lbs.
Open Cubby: 20 lbs.
Adjustable Shelf: 10 lbs.
Bottom Shelf: 20 lbs.

What's included

Description	Qty
A Desktop Subassembly	1
B Large Side Panel (Left)	1
C Small Side Panel (Right)	1
D Cabinet Back Panel	1
E Cabinet Bottom Panel	1
F Adjustable Shelf	1
G Short Legs (Left)	2
H Long Legs (Right)	2
I Door	1

Scan me!

Free Lifetime
Warranty



Toll-free at 1-866-619-1004
Help@nathanjames.com
Nathanjames.com/help

The goods

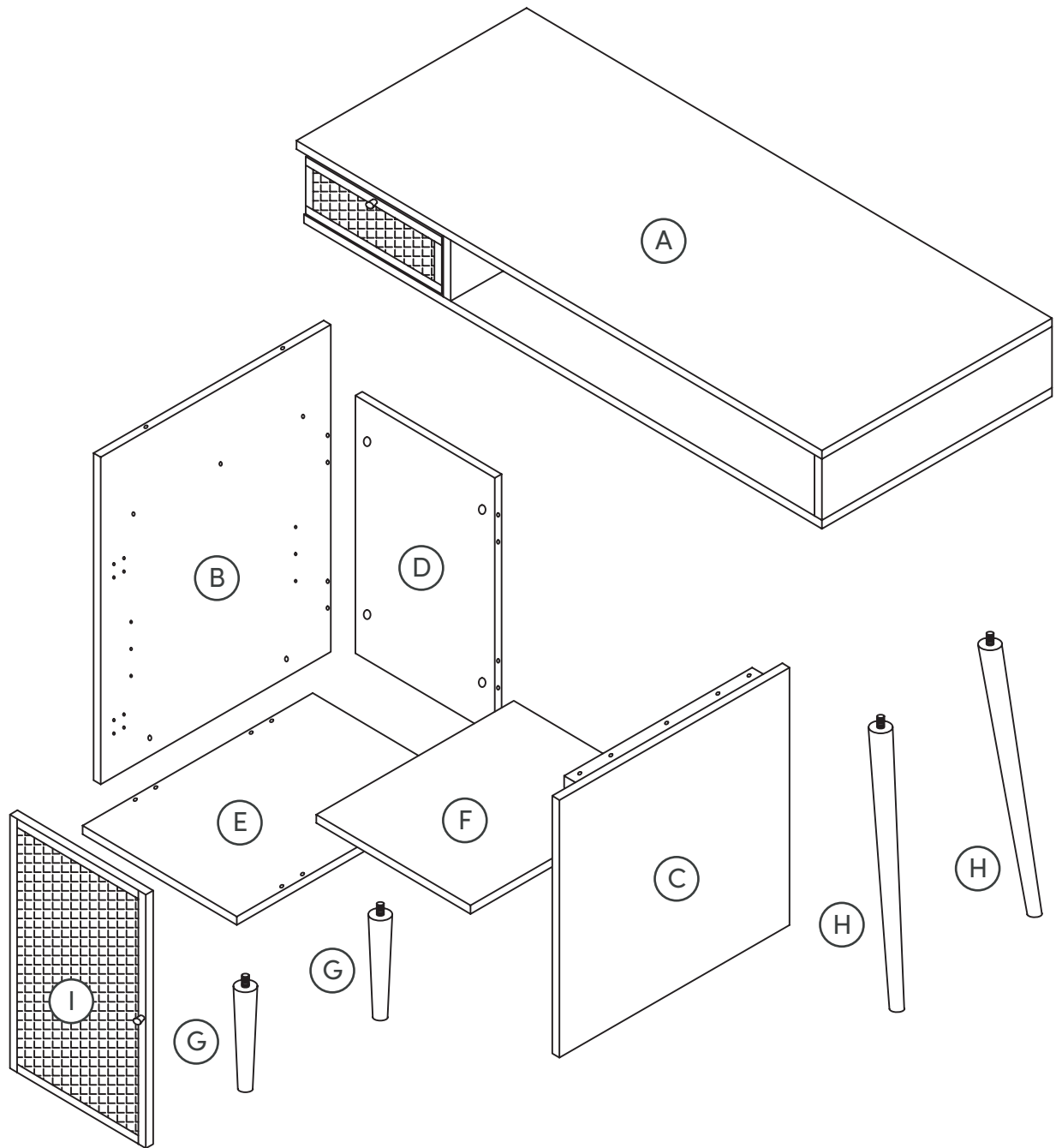

IMPORTANT

1. Do not tighten bolts / screws completely until all bolts / screws are lined up and inserted into holes.
2. Do not over tighten screws and bolts to avoid stripping.

What's included

Description		Qty
1	1/4" x 1 1/8" Hex Button Head Bolt	6
2	1/4" x 2" Hex Button Head Bolt	4
3	1/4" x 3/8" Spring Washer	10
4	1/4" x 1/2" Flat Washer	10
5	1/4" x 12mm Barrel Nut	4
6	Allen Key	1
7	8*20mm Wooden Dowel	12
8	Knob	2
9	5/32" x 3/4" Knob Bolt	2
10	Cam Bolt	4
11	Cam Lock	4
12	Hinge	2
13	M3 x 15mm Screw	12
14	Shelf Pin	4
15	Plastic Nail-in Foot (extra)	4
16	Plastic Bracket (for anti-tip)	2
17	Non-Drywall Wall Anchor (for anti-tip)	2
18	M3.5 x 15mm Screw (for anti-tip)	2
19	Plastic Tether (for anti-tip)	1
20	M4 x 50mm Screw (for anti-tip)	2
21	Drywall Wall Anchor (for anti-tip)	2

1

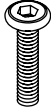

2

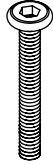

3



4



5



6

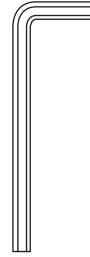

7



8



9

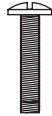

10



11



12

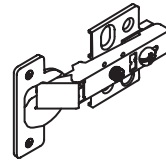

13



14



15



16

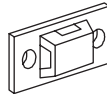

17



18



19

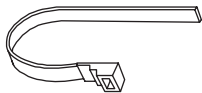

20



21

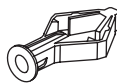

Step 1

Alright, let's get started! Start off by inserting the Cam Bolts (10) into the holes indicated below in the Large Side Panel (B), Small Side Panel (C) and Cabinet Bottom Panel (E). Tighten using a Phillips head screwdriver (not included).

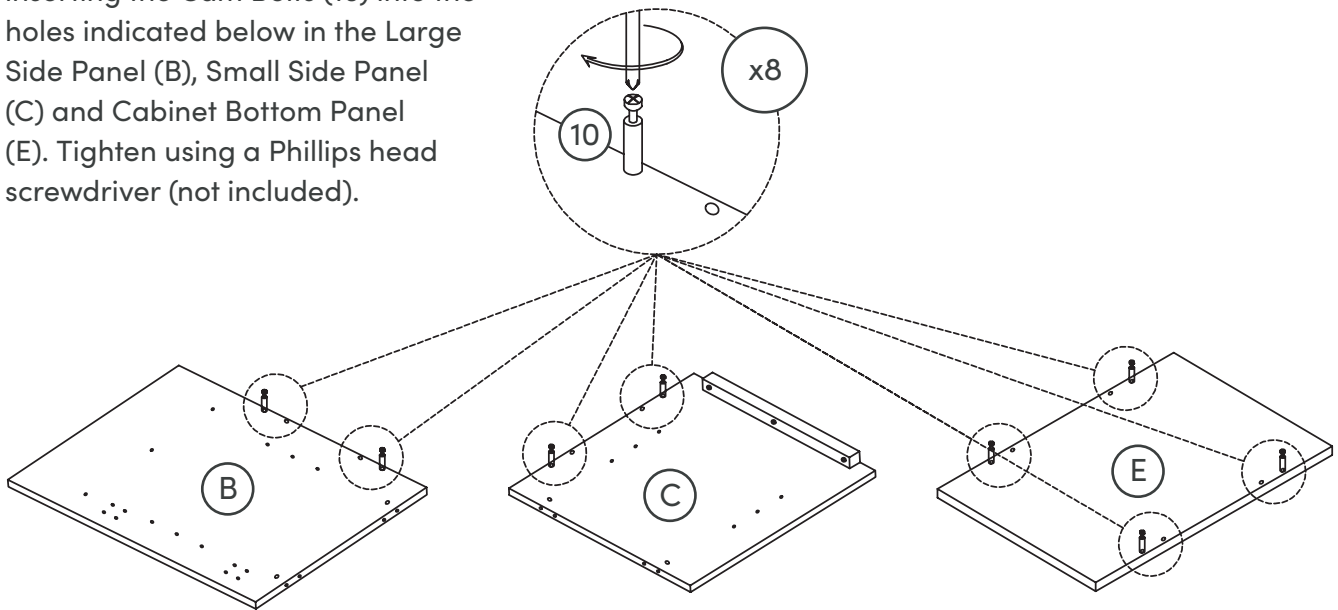

Step 2

Next, insert the Wooden Dowels (7) into the holes indicated below in the Large Side Panel (B). Align the holes in the side of the Cabinet Back Panel (D) with the Cam Bolts and Dowels you inserted in the Large Side Panel (B). Secure using the Cam Locks (11).

Flip to the next page for more in-depth instructions on using cam locks.

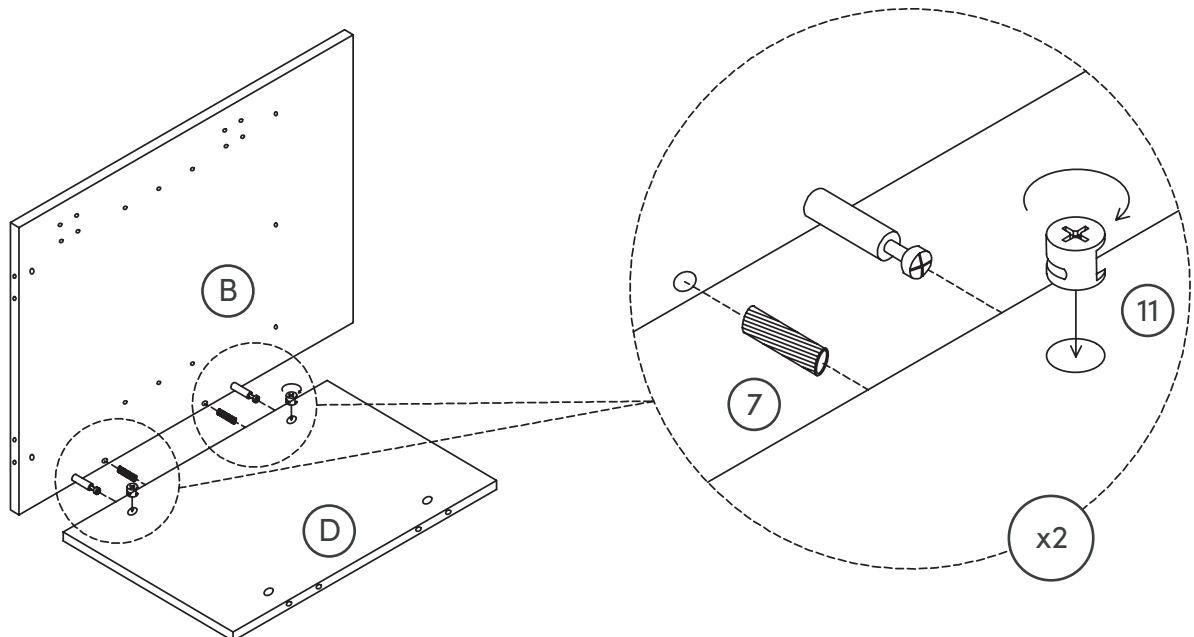

How to use cam locks

Did you know?

Cam locks are used to join two panels together, usually the edge of one to the flat side of another.

First, your cam bolt (or cam pin) will need to be properly inserted into the flat side of the board.

Important Note: Only tighten the cam bolt until it is secure. Do not over-tighten.

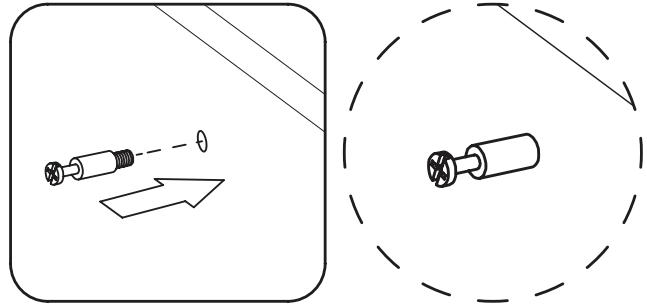

Next, you will fit the proper hole on the edge of the associated joining panel over the cam bolt.

Important Note: When installed properly, the head of the cam bolt will be visible through the larger hole on the side of the joining panel.

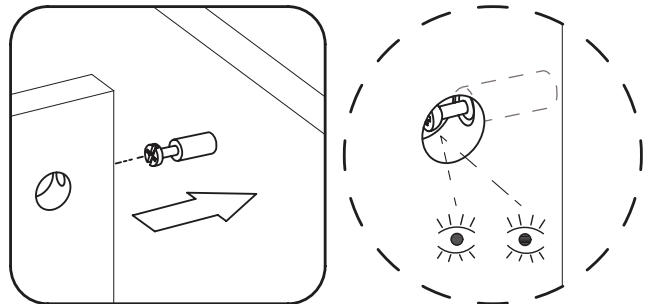

Next, you will notice the cam lock has a “C” shaped back. Commonly, an arrow on the front of the cam lock points in the same direction as the open section on back.

Using these as your cue, insert the cam lock into the large hole so the opening of the “C” fits over the head of the cam bolt.

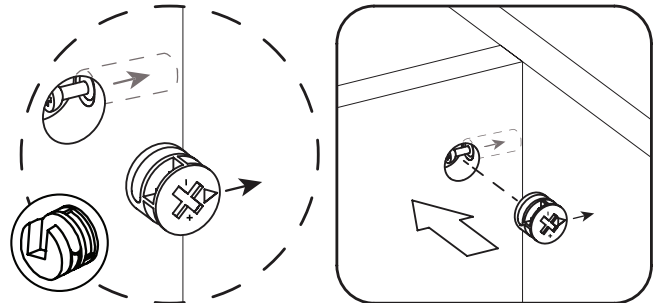

Using a screwdriver, you will turn the cam lock until it stops, usually at 90° or 180°. You will feel the panels pulling closer until they are secured.

Important Note: Only turn the cam lock until the panels are fully engaged & feel secure. Turning too far may lead to hardware failure.

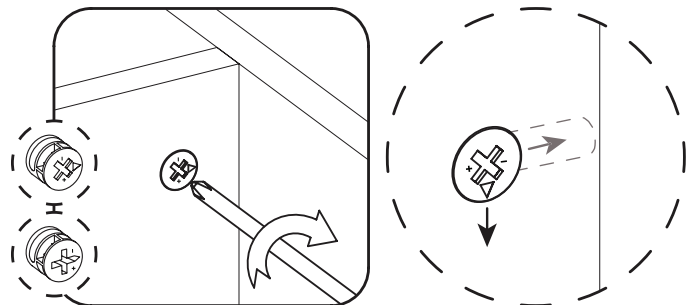

Still having issues?

If a cam lock seems to be spinning in place or is not “catching” or pulling the panels together as expected, first remove the cam lock & try again while making sure that everything is properly positioned & oriented.

If you are still having issues getting things working as expected, first remove the cam lock then unscrew the cam bolt slightly (less than 1 complete turn) to see if that helps with the alignment of the cam lock & bolt.

Step 3

Now insert the Wooden Dowels (7) into the side of the Cabinet Back Panel (D). Slide the Small Side Panel (C) into place by lining up the holes with the Wooden Dowels and Cam Bolts you already inserted into the Cabinet Back Panel (D). Secure in place using the Cam Locks (11).

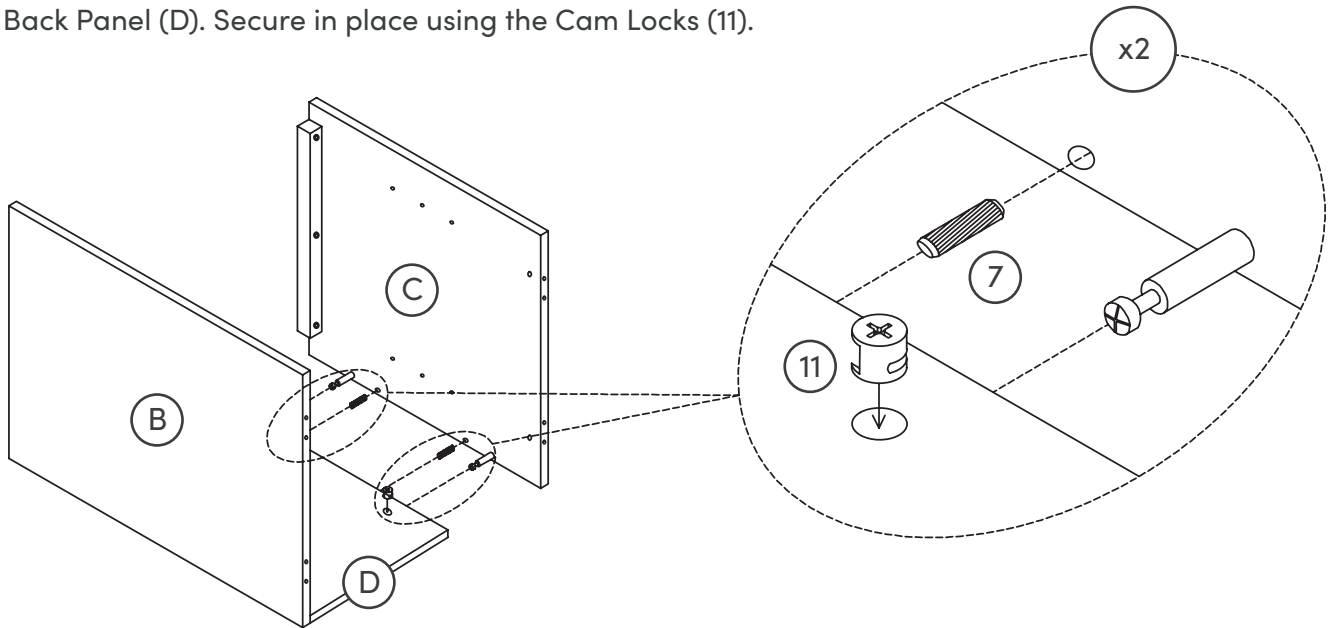

Step 4

Next, insert the 1/4" x 12mm Barrel Nuts (5) into the Large Side Panel (B) and Small Side Panel (C). Then insert the Wooden Dowels (7) into the Cabinet Bottom Panel (E) and attach to the rest of the cabinet you've built by aligning the Wooden Dowels with the holes in the side of the cabinet. Secure in place using the 1/4" x 2" Hex Button Head Bolts (2). Don't forget to use the 1/4" x 1/2" Flat Washers (4) and 1/4" x 3/8" Spring Washers (3).

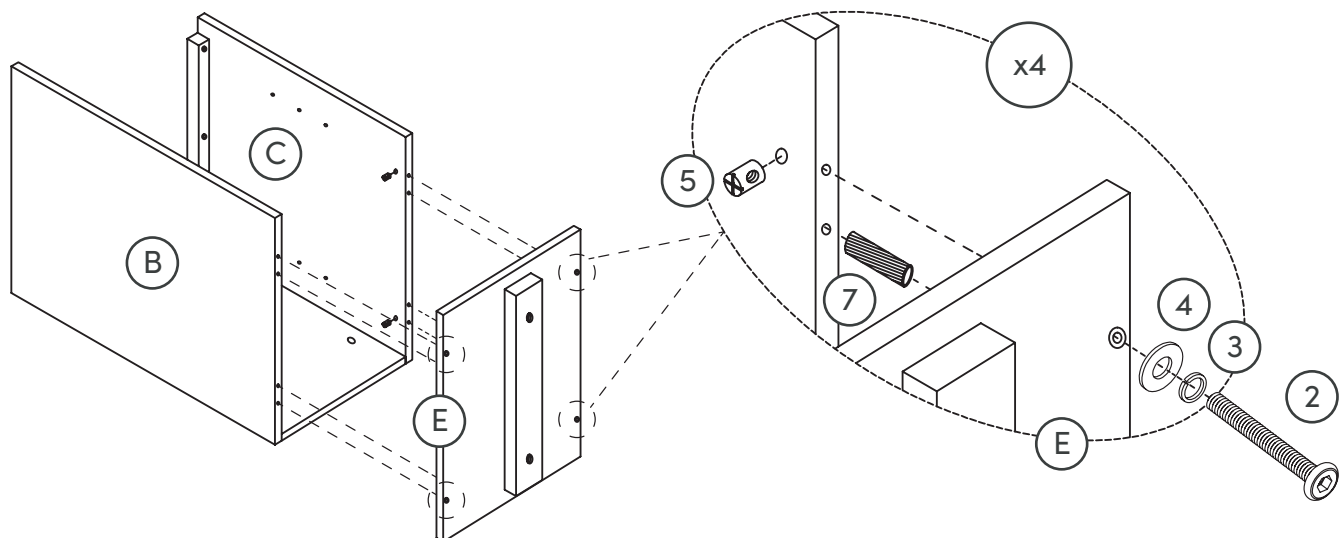

Step 5

Now it's time to attach the cabinet you've been building to the Desktop Subassembly (A) using the Wooden Dowels (7). Secure in place using the $\frac{1}{4}$ " x $1\frac{1}{8}$ " Hex Button Head Bolts (1). Don't forget to use the $\frac{1}{4}$ " x $\frac{1}{2}$ " Flat Washers (4) and $\frac{1}{4}$ " x $\frac{3}{8}$ " Spring Washers (3).

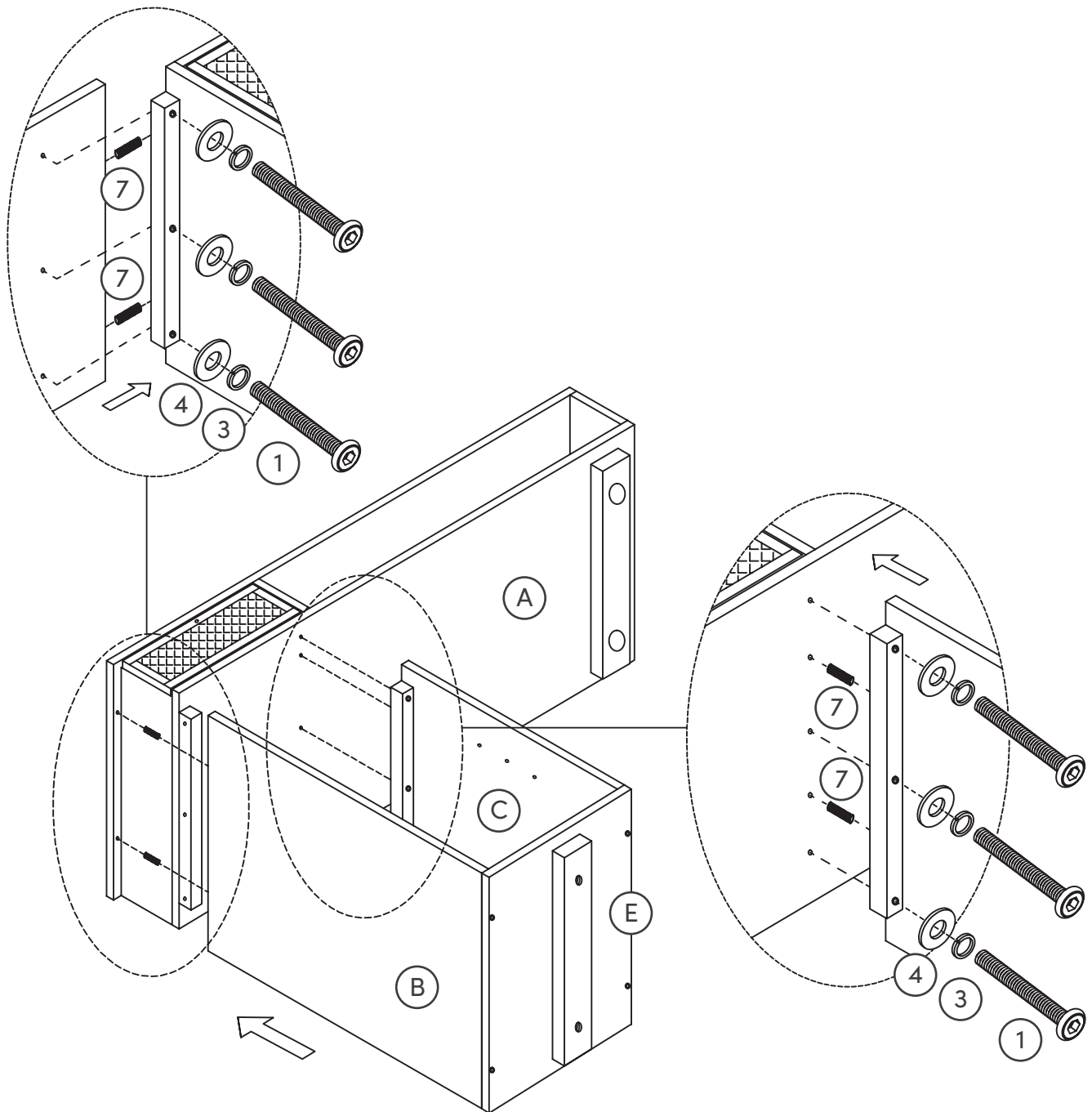

Step 6

You're halfway there and doing great! Now it's time to attach the legs. Attach the Short Legs (G) and Long Legs (H) by twisting into place.

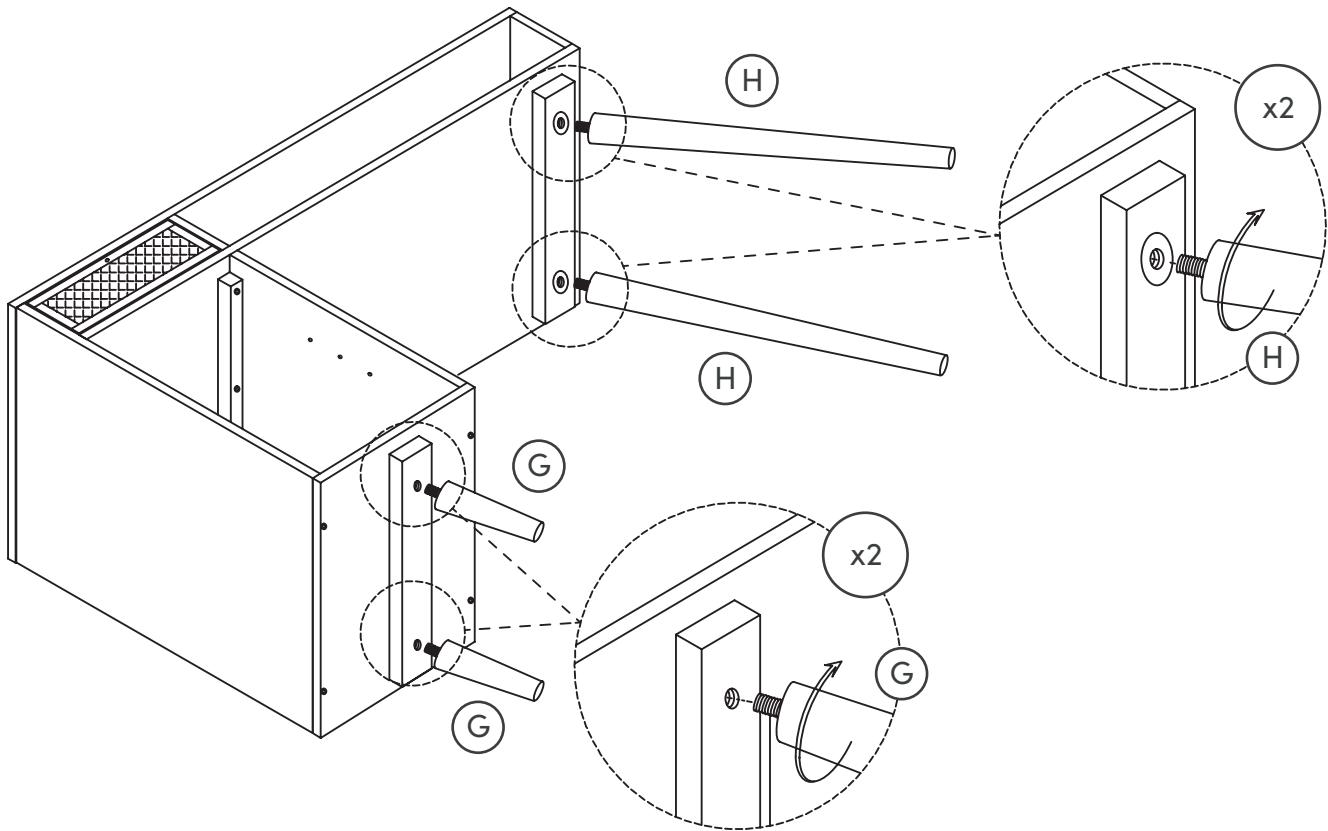

Step 7

Now insert the Shelf Pins (14) into the cabinet at your desired height.

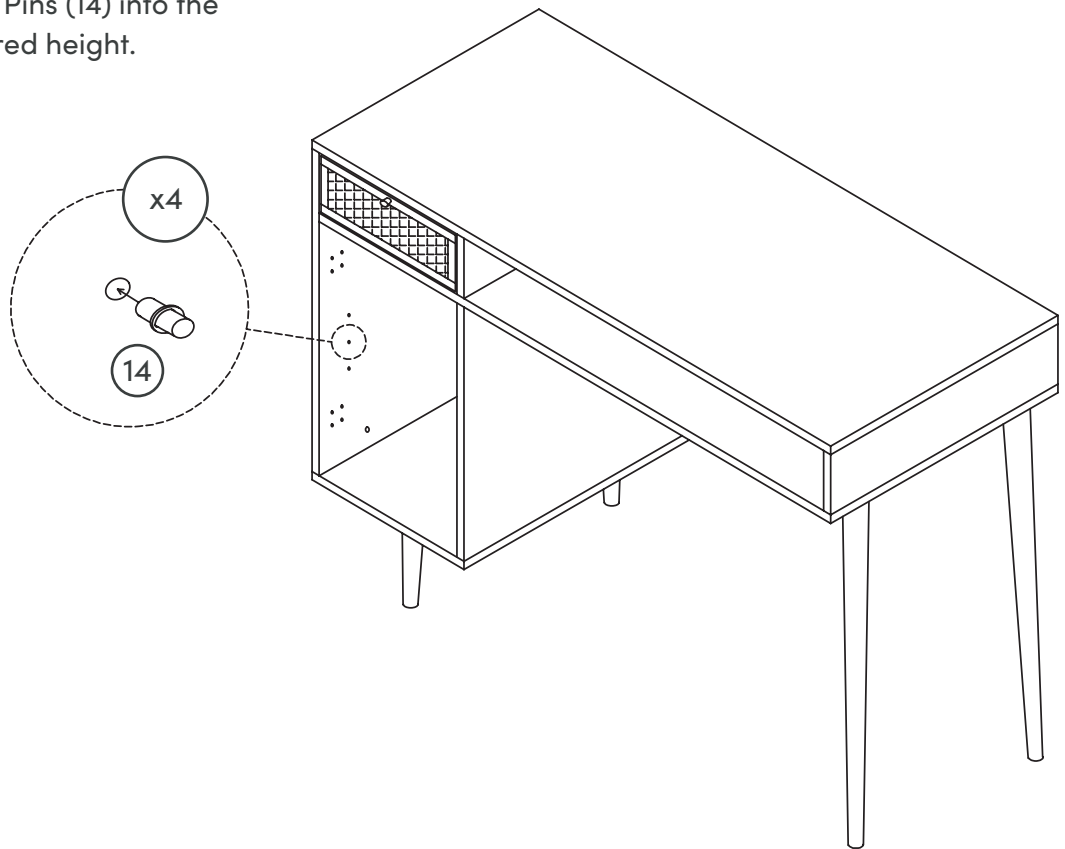

Step 8

Next, slide the Adjustable Shelf (F) into the cabinet on top of the Shelf Pins you inserted in Step 7.

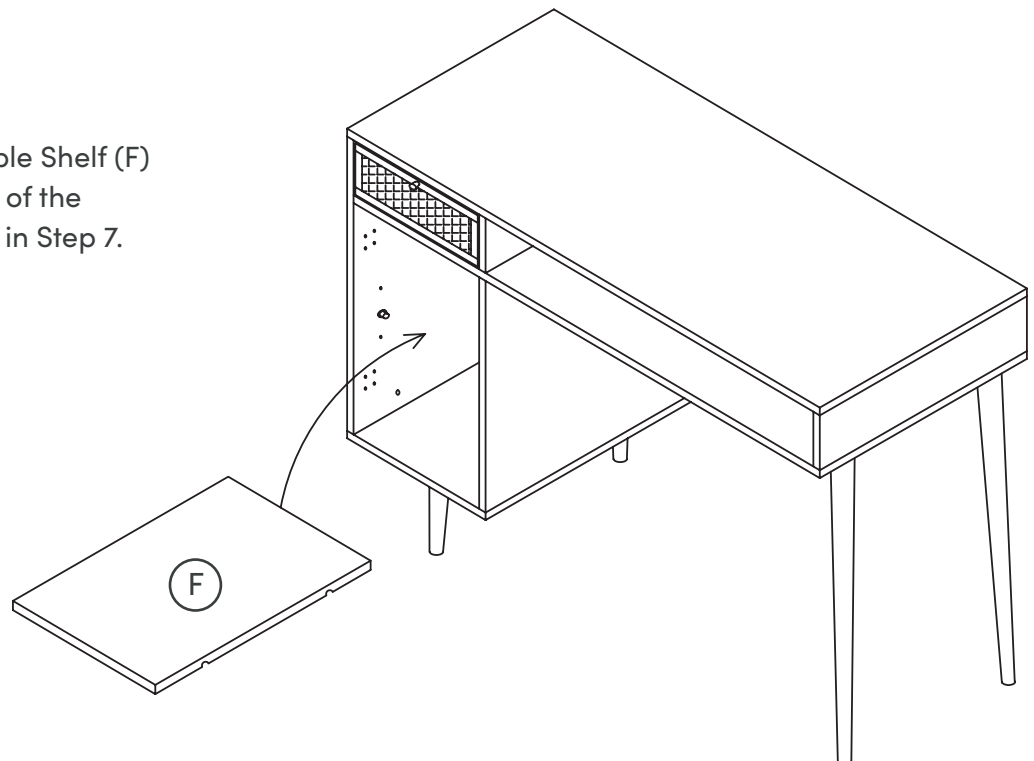

Step 9

Almost done! Let's get the hinges installed now. To do this, place the Hinges (12) in the Door (I) and secure in place using the M3 x 15mm Screws (13).

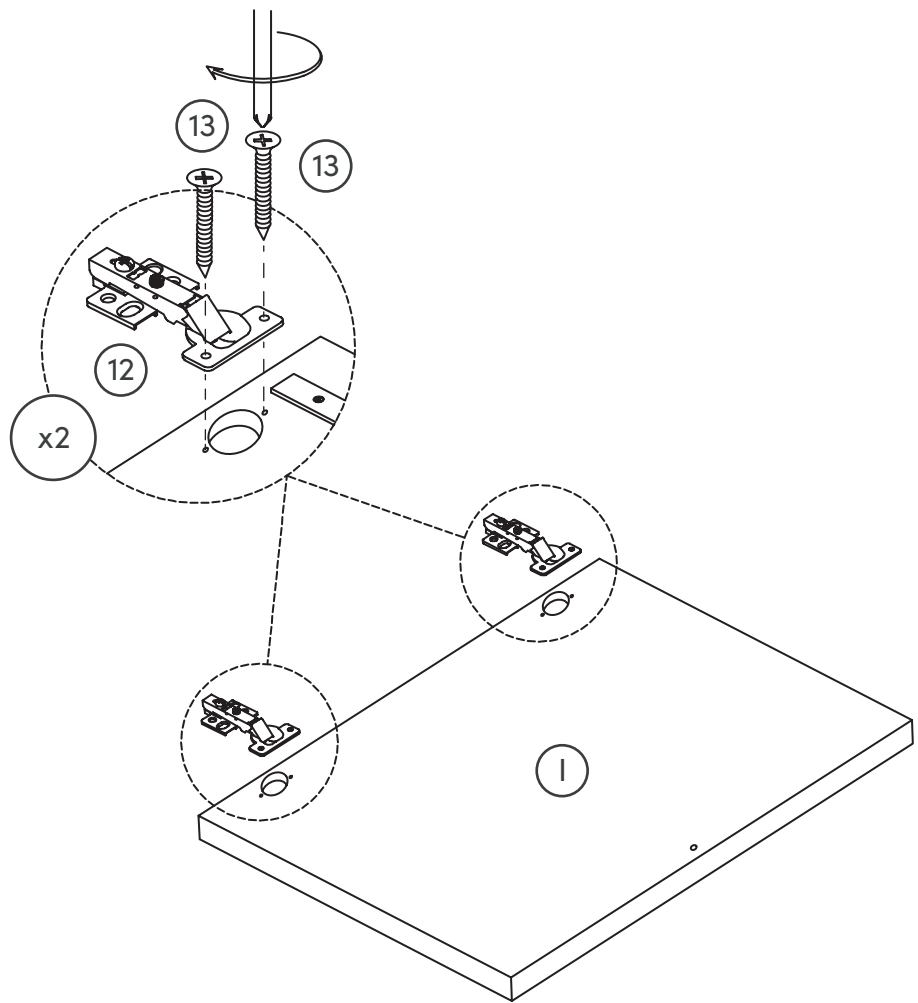

Step 10

Next, attach the Door (I) to the desk by securing the Hinges in place using the M3 x 15mm Screw (13).

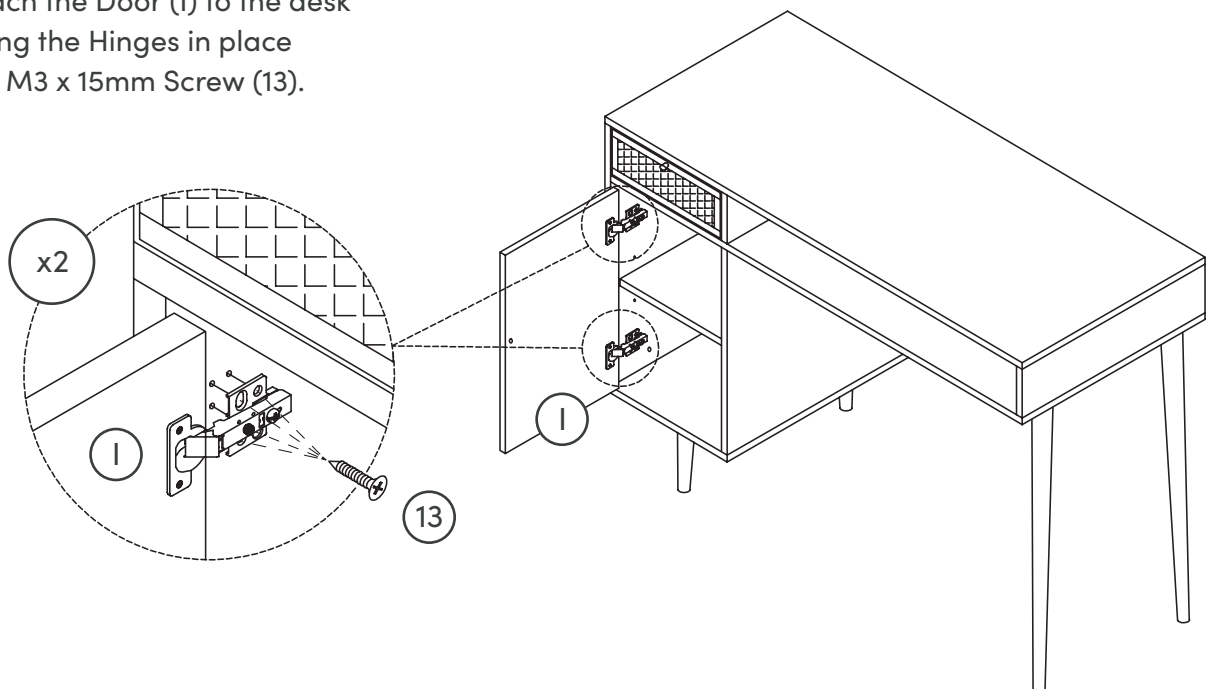

Step 11

Attach the Knobs (8) to the desk using the 5/32" x 3/4" Knob Bolts (9).

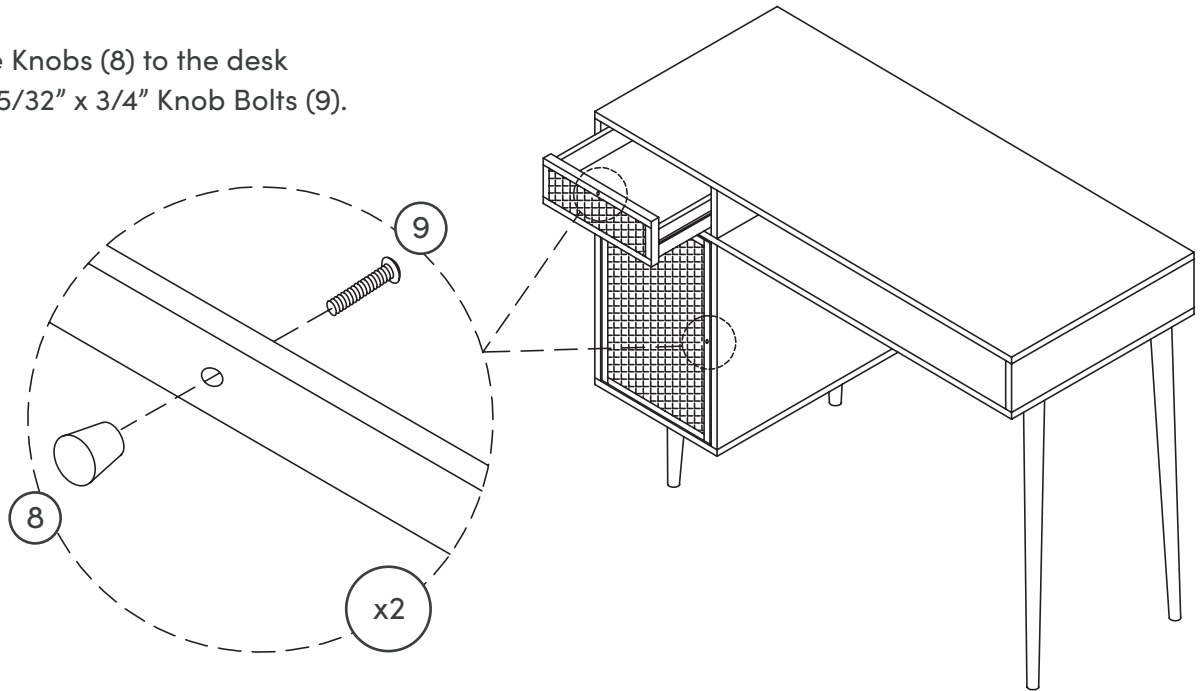

Step 12

Finally, secure your new desk to the wall to prevent tipping. Secure the Plastic Brackets (16) to your wall and the desk using the appropriate screws listed below. For drywall, use the Drywall Wall Anchors (21). For non-drywall, use the Non-Drywall Wall Anchors (17).

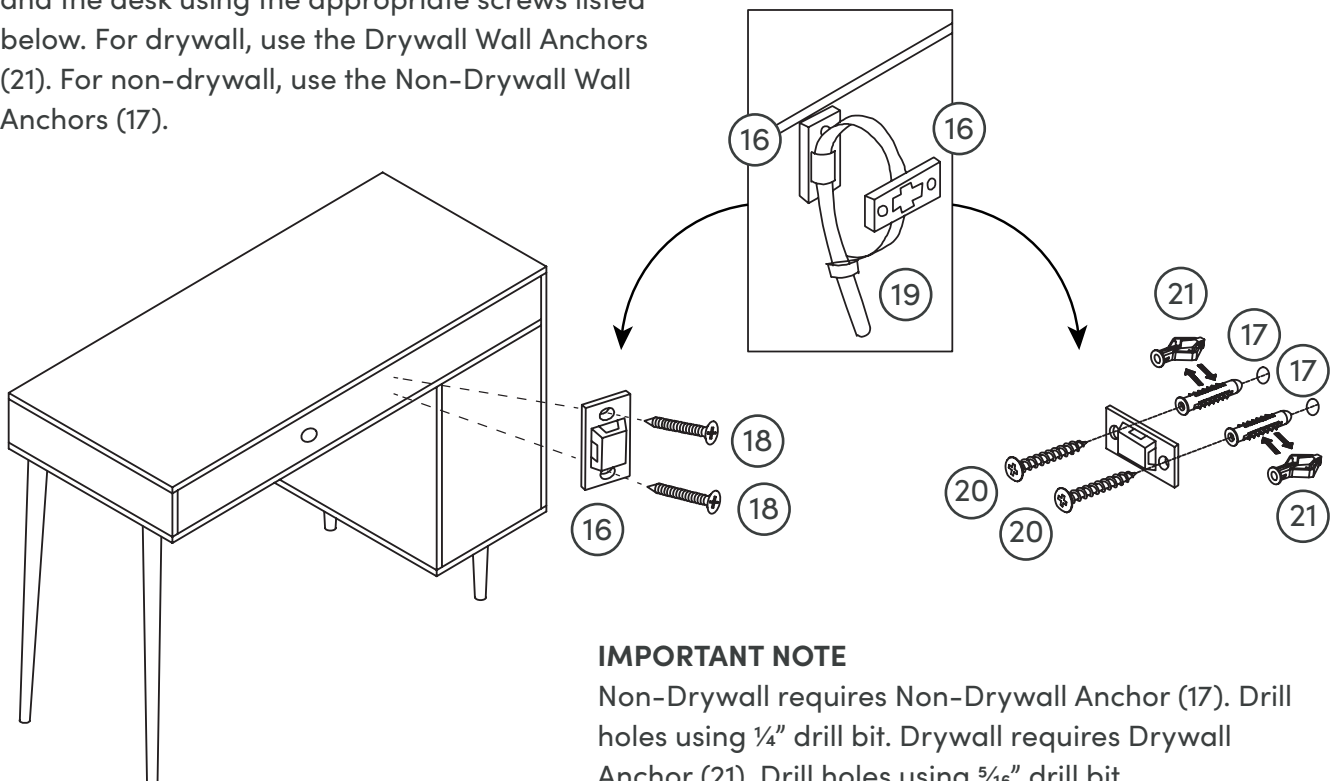

How to use drywall anchors

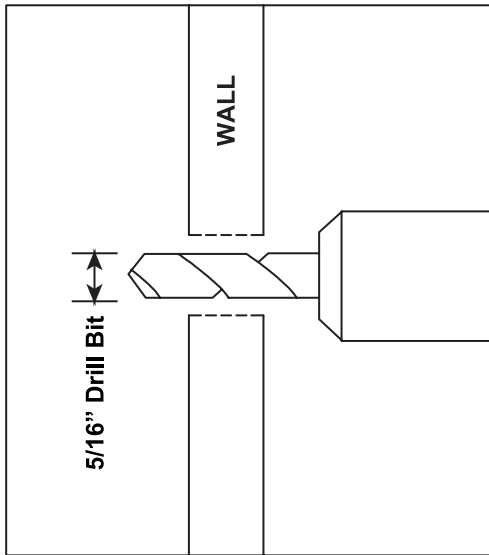

1. Drill hole with 5/16" bit

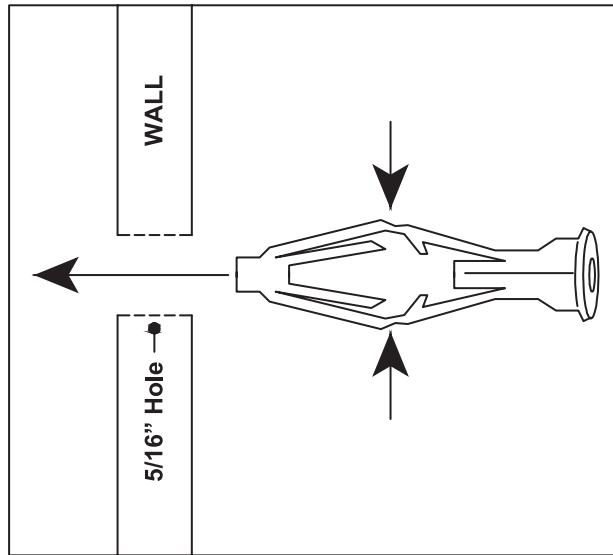

2. Pinch and insert

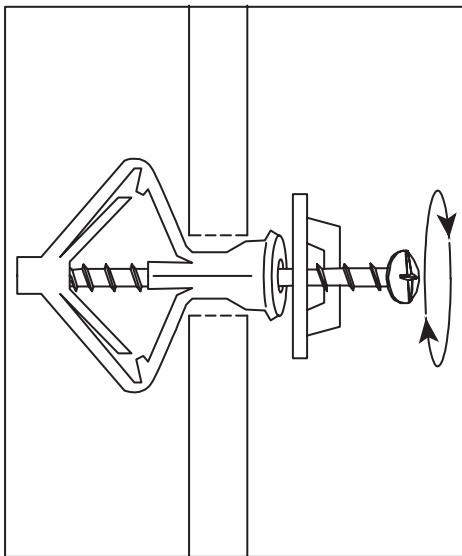

3. Begin tightening

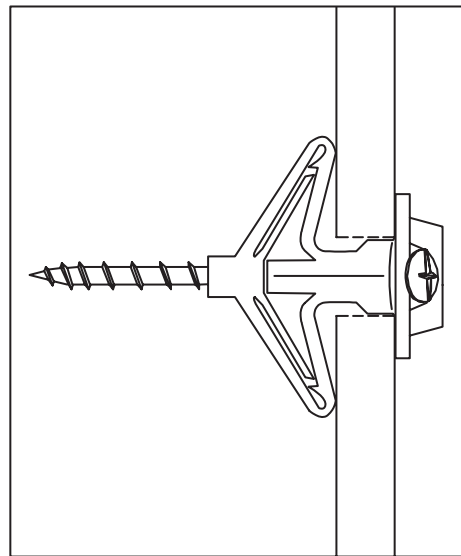

4. Anchor is secure when screw is tightened to 100%.

No heartburn, when we handle the return

Give us a call **1-866-619-1004** or shoot us a message
at **help@nathanjames.com** we will issue you a free
replacement with **zero hassle**.

Our way



Give us a call



Replacement



You

Their way



Re-package item



Schedule pick up



Track package



Replacement



You

We really don't want you to go through the hassle of re-packaging your item
and sending it back, because let's be honest...nobody has time for that.

Safety first, fun later

We want your product to last as long as possible, so we recommend that you tighten the screws 2 weeks after assembly and for added safety check the tightness of all screws every 2 months.

For proper care and treatment, please check our website at NathanJames.com/products

Safe use of this product starts with you.

Use this product responsibly with the primary concern for your safety. Follow assembly instructions carefully and inspect product upon receipt and each use.

Nathan James and its parent companies cannot be held legally responsible for any injuries or death resulted from failure to follow instructions or improper use of this product.

Do not modify the structure of this product in any way.

Our products have been tested to meet specific safety measures as they were originally intended to be sold. Any modifications will present the risk of creating significant safety issues which NJ will not be responsible for.

Proper use

DO NOT	use for commercial purposes
DO NOT	frolic on desk
DO NOT	use desk as foot stool
DO NOT	leave spilled liquid on desk
DO NOT	use desk if damaged
DO NOT	make temporary repairs
DO NOT	use outdoors

We are only in business if you're happy

For starters, thanks for being you.

☎ Toll-free at 1-866-619-1004

✉ Help@nathanjames.com

🌐 NathanJames.com/help

We do our best to ensure your furniture arrives without any problems, but occasionally mistakes happen—as humans we are imperfect beings. In the event that a part is damaged or missing, we will be more than happy to provide you with replacement part(s) for free.

Warranty

This product comes with a lifetime warranty from the date of purchase. Please use your phone to scan the QR code to register your product or visit <https://goo.gl/i9dk3q>

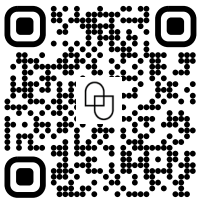

Did we do alright? Please spread the love!

If you are happy with your product, tell your friends and family about us or even better leave us a review online. Spreading the word gives us the opportunity to make more people happy and keep our prices low for your next purchase.

Brooklyn Burdon

Founder, Nathan James