

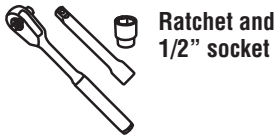

**6 cu ft.
(0.169 m³)**

You will need:



Ratchet and
1/2" socket



1/2" Combination
wrench

PARTS LIST	QUANTITY
Tray	1
Handles	2
Wheel Guard	1
Axle Brackets	2
Legs	2
Leg Brace	1
Wheels	2
Axle	1
Wedges	2
Hooks	2
Tray Brace	2
5 3/4 inch Bolts	2
3 1/2 inch Bolts	2
2 1/2 inch Bolts	4
2 1/4 inch Bolts	2
3/4 inch Bolts	6
Flange Nuts	16
Bolt Holders	4



A. Important: Do not wrench-tighten nuts until after step 4

Step 1

Assembly the legs with the leg brace
Important: Do not wrench-tighten nuts until assembly is complete

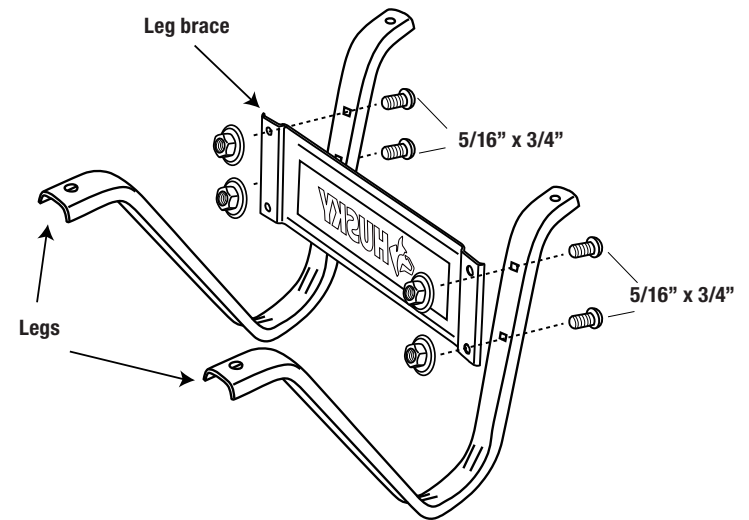

Bolt size guide

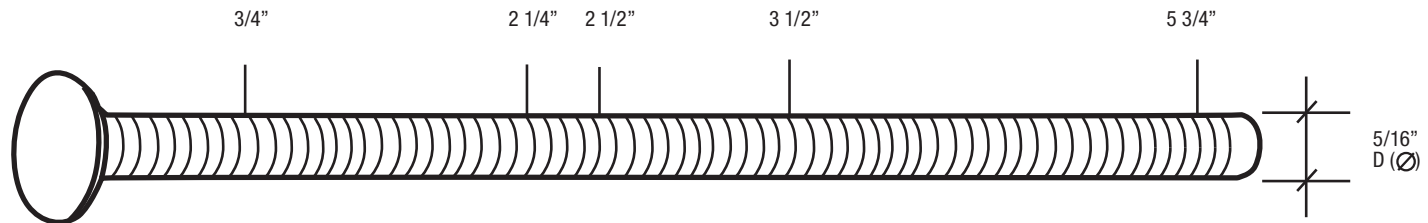

Step 2

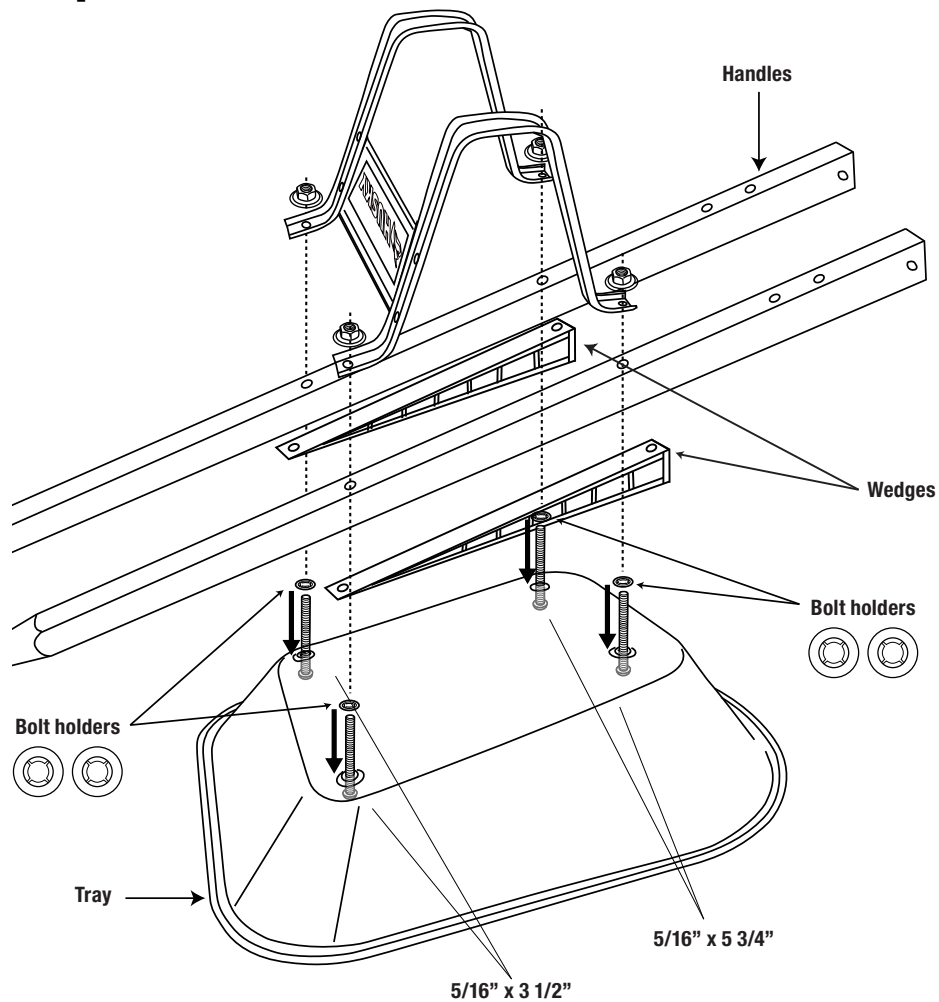

Insert the screws, fix them with a bolt holder to keep them in place up to the top. Once the screws are fixed, turn the tray upside down and set the steel handles and then the legs assembly.

Step 3

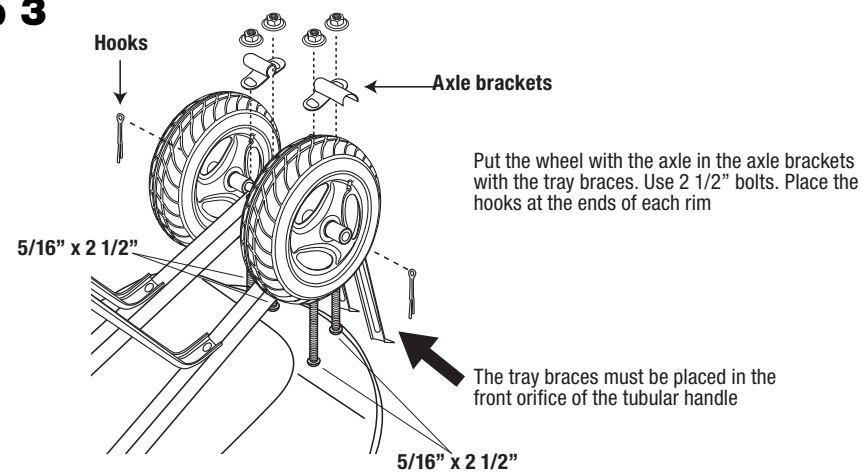

Put the wheel with the axle in the axle brackets with the tray braces. Use 2 1/2'' bolts. Place the hooks at the ends of each rim

The tray braces must be placed in the front orifice of the tubular handle

Step 4

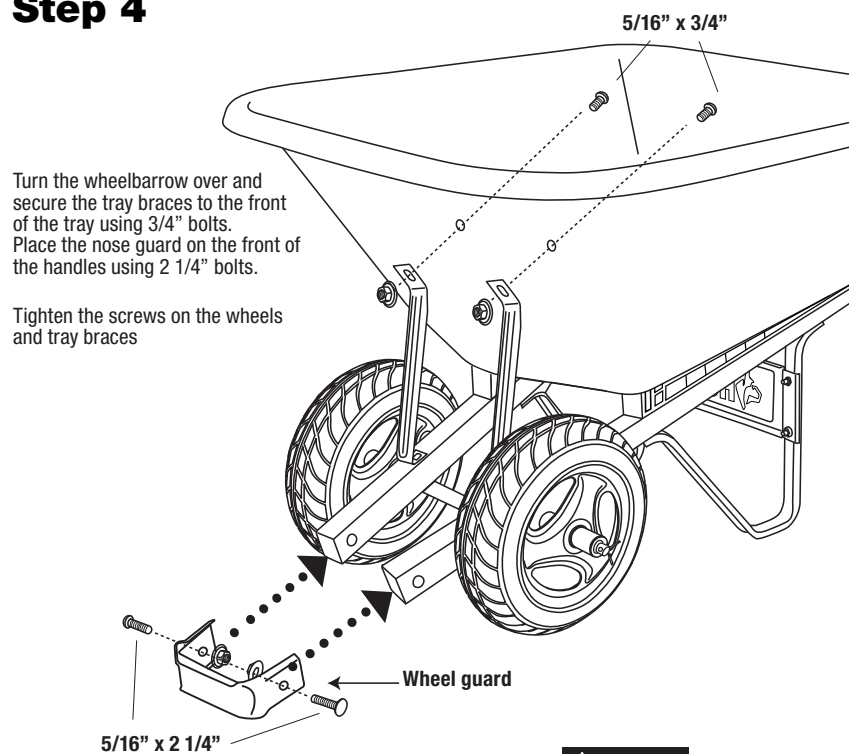

Turn the wheelbarrow over and secure the tray braces to the front of the tray using $3/4''$ bolts. Place the nose guard on the front of the handles using $2 \frac{1}{4}''$ bolts.

Tighten the screws on the wheels and tray braces

CAUTION

Cutting edges are very sharp use caution when handling. Wear safety gloves. Keep out of reach of children.