

USE AND CARE GUIDE

ASHDALE DRAWER DRESSER PATINA
ASHDALE DRAWER DRESSER ANTIQUE IVORY

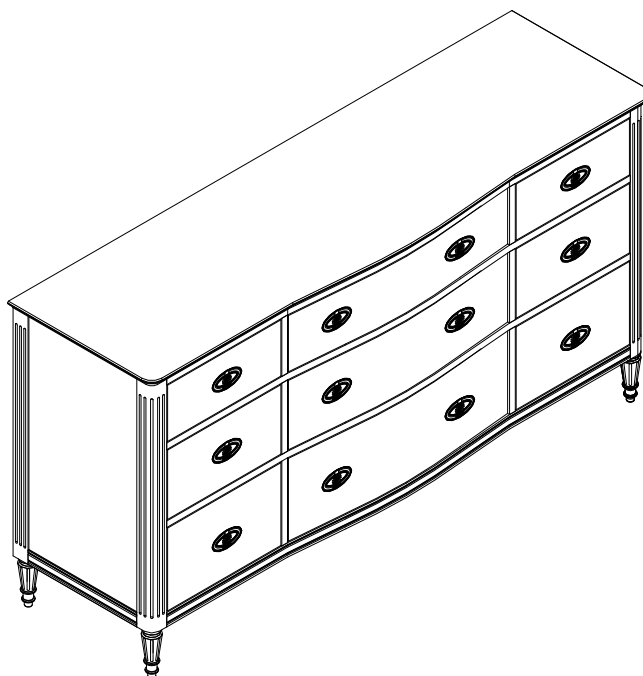

Questions, problems, missing parts? Before returning to the store,
call Home Decorators Collection Customer Service.
8 a.m. – 7 p.m., EST, Monday – Friday, 9 a.m. – 6 p.m., EST, Saturday

1-800-986-3460

HOMEDEPOT.COM/HOMEDECORATORS

THANK YOU

We appreciate the trust and confidence you have placed in Home Decorators Collection through the purchase of this Dresser. We strive to continually create quality products designed to enhance your home. Visit us online to see our full line of products available for your home improvement needs. Thank you for choosing Home Decorators Collection!

Table of Contents

Table of Contents.....	2	Assembly.....	6
Safety Information.....	2	Assembly (Continued).....	7
Warranty.....	3	Assembly (If Necessary).....	8
3 Years Warranty.....	3	Maintenance.....	9
What is Covered.....	3	Care and cleaning.....	9
What is Not Covered.....	3		
Pre-assembly.....	4		
Planning Assembly.....	4		
Tools Required.....	4		
Hardware Included.....	4		
Pre-assembly (Continued).....	5		
Package Contents.....	5		

Safety Information



DANGER

- Keep children and animals away from the work area. Small parts can choke them if they are swallowed.
- Read and follow instructions carefully.



WARNING

- Read these instructions carefully and keep in a safe place.
- TO GUARANTEE THE SAFE USE OF THIS PRODUCT, FOLLOW THE WARNINGS, GUIDELINES AND RECOMMENDATIONS IN THIS MANUAL.
- Adult assembly required.
- Small parts may present choking hazard prior to assembly.
- To further reduce the risk of serious injury and death from Tip overs:
 - Place heaviest items in the lowest compartments or drawers.
 - Never allow children to climb or hang on drawers, doors or shelves.
 - Never open more than one drawer at a time.
 - Use of tip-over restraints may only reduce, but not eliminate, the risk of tip-over.
 - For safe mounting, it is essential to use wall anchors appropriate to your wall type (i.e plaster, drywall, concrete, etc). Mount to wood studs whenever possible.*



NOTE: If you are unsure about your wall type of what mounting method you should use, consult a qualified professional.



CAUTION

- Do not use power tools to assemble your item. Power tools may strip or damage parts/product.
- Do not over tighten connectors (screws, bolts, etc.) Overtightening can lead to product damage.
- Be sure to check all packing materials carefully for small parts that may have come loose inside the carton during shipment. If parts are missing, contact THE HOME DEPOT to obtain any missing parts.
- DO NOT USE SUBSTITUTE PARTS.
- This product should only be used on a flat, level surface.
- Product is designed to hold [200lbs]. Exceeding this limit may damage the product or cause injury to the user.
- Assemble the item as close to its final position (in the same room) as possible.
- Assemble on a soft level surface to avoid damaging the Unit or your floor.

Warranty

3 YEAR WARRANTY

WHAT IS COVERED

We guarantee this product to be free of manufacturing defects to the original purchaser for three years.

WHAT IS NOT COVERED

This warranty does not cover commercial use, acts of nature, and abusive use.

Pre-assembly

PLANNING ASSEMBLY

Compare all parts to the Hardware Included and Package Contents lists. If any part appears missing or damaged, do not assemble or use the product. Contact Customer Service at 1-800-986-3460.

TOOLS REQUIRED

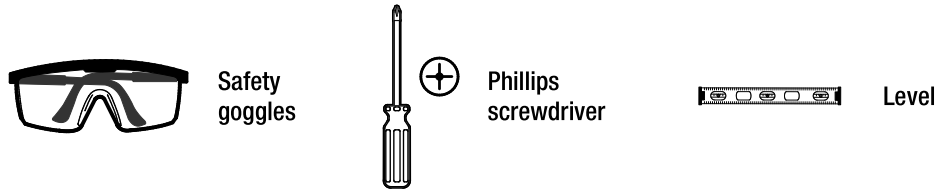

HARDWARE INCLUDED

 **NOTE:** Hardware not shown to actual size.

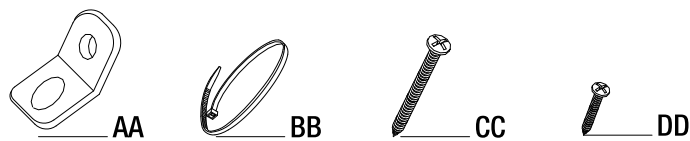

Part	DESCRIPTION	Quantity
AA	BRACKET	2
BB	TIPPING RESTRAINT	1
CC	LONGER SCREW	1
DD	SHORTER SCREW	1

Pre-assembly (continued)

PACKAGE CONTENTS

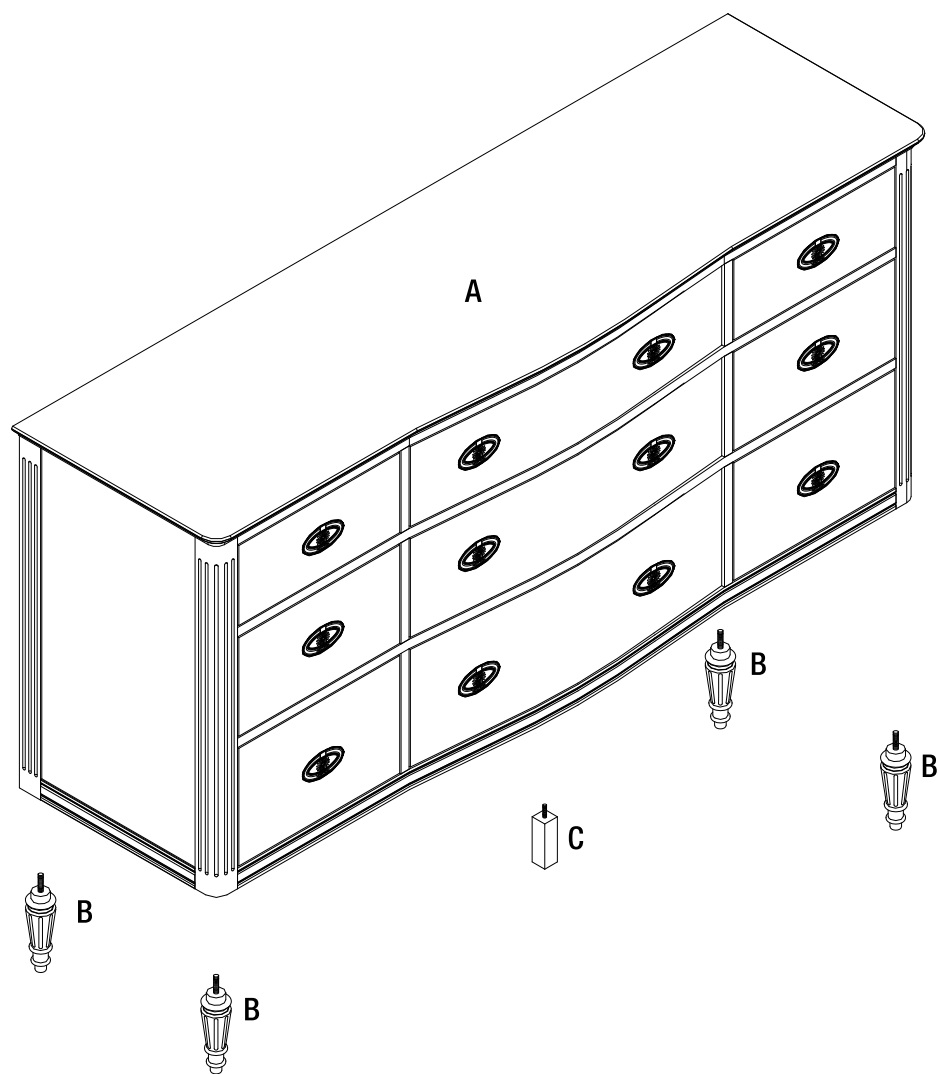

Part	DESCRIPTION	Quantity
A	DRESSER	1
B	LEG	4
C	CENTER LEG	1

Assembly

- 1 Take the foot box out of the pull box.

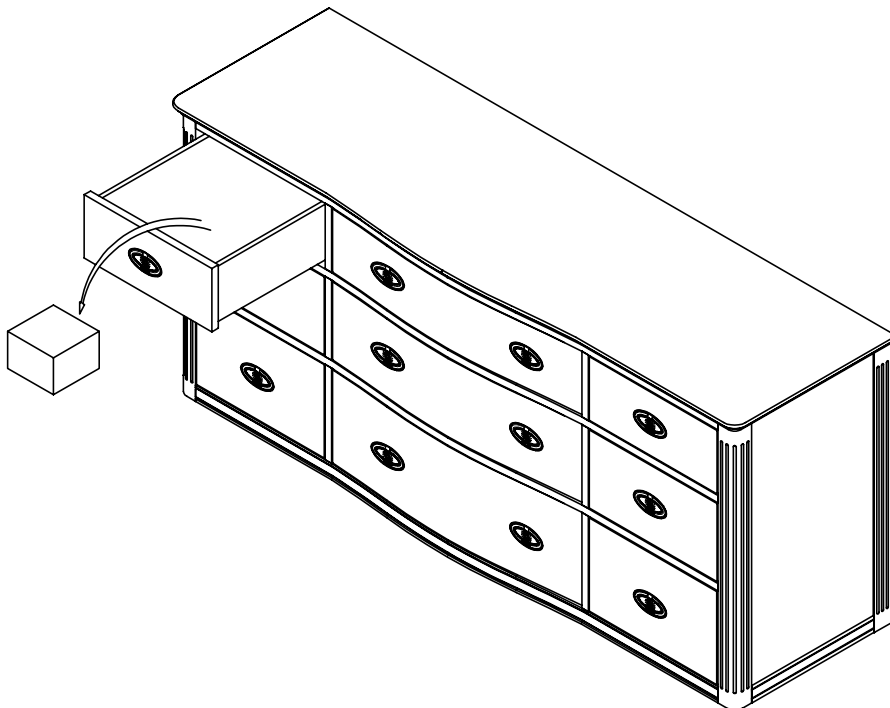

- 2 Assemble the dresser to the leg .

□ Attaching the dresser (A) to the leg (B) and to the center leg (C).

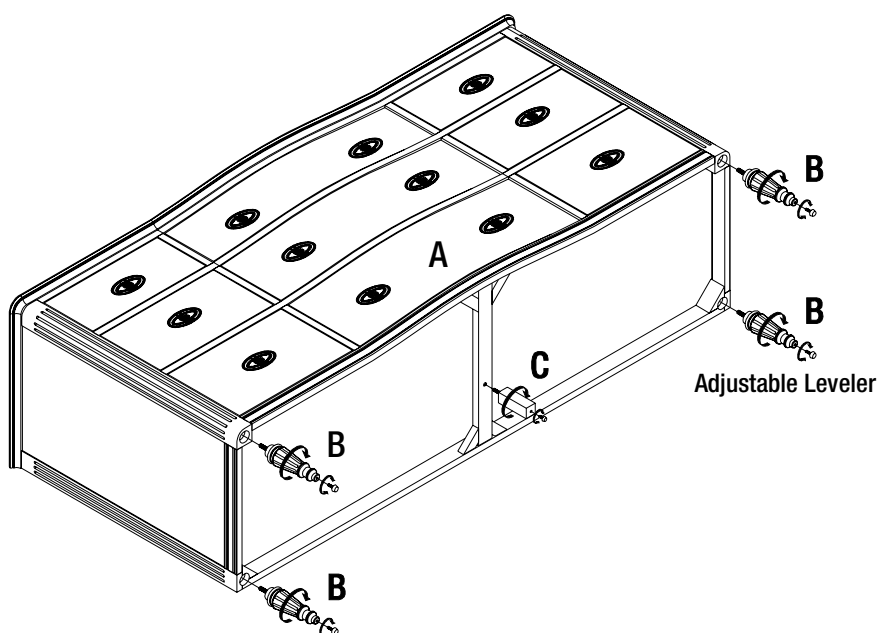

Assembly (continued)

3 Assembling Tipping Restraint Kit

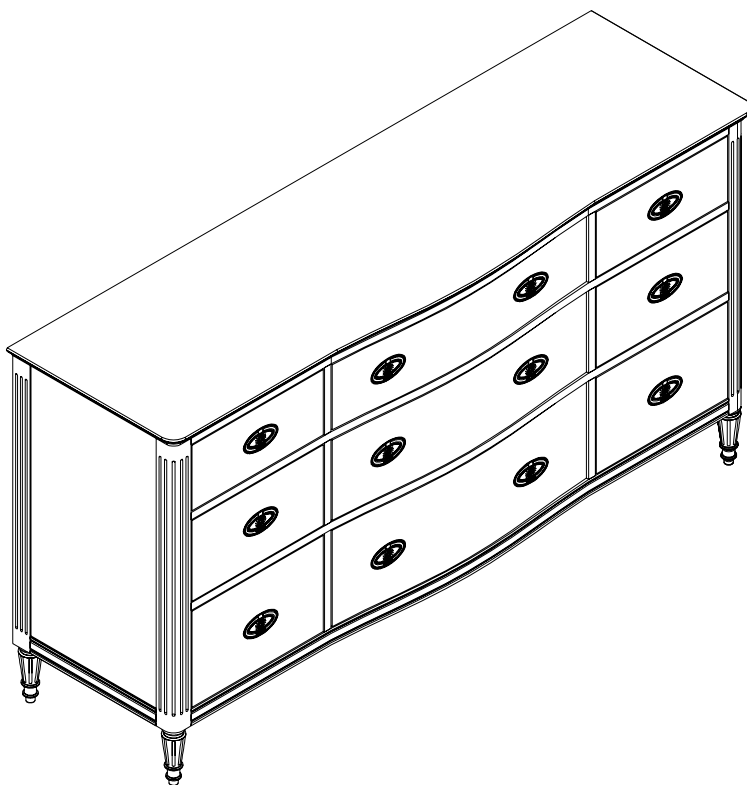
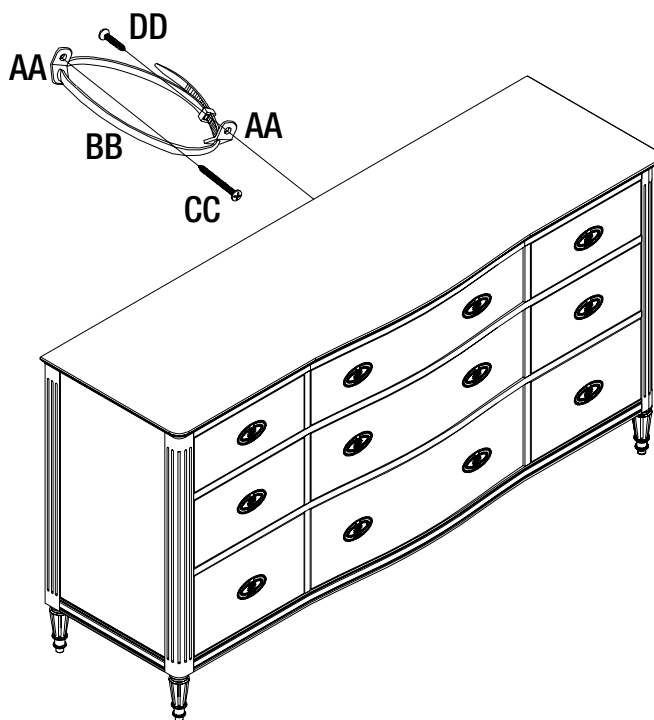

Assembly (if necessary)

4 A. Removing the drawers

- Open the drawer as far as possible.
- Simultaneously, press the right side spring clip downward and the left side spring clip upward.
- Once both spring clips are held in the indicated position, pull the drawer straight out.

Left side view

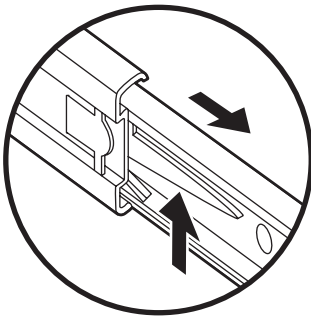

Right side view

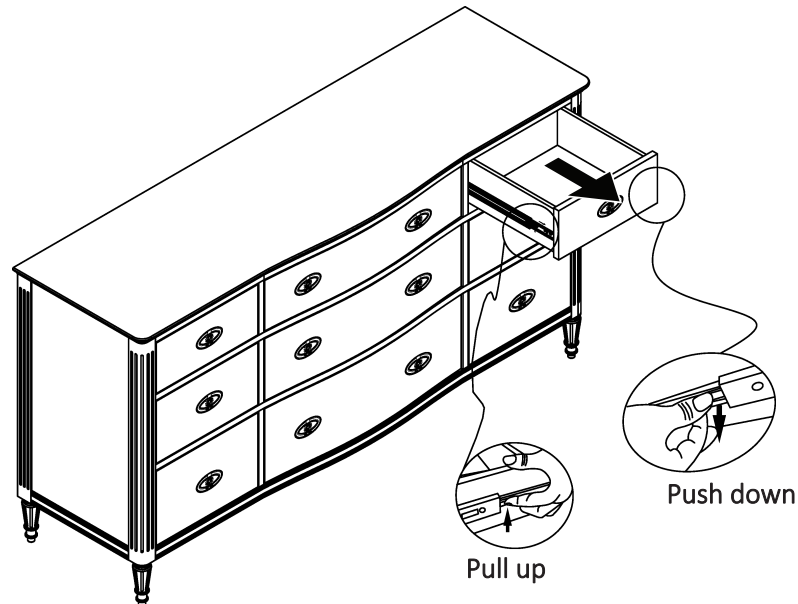
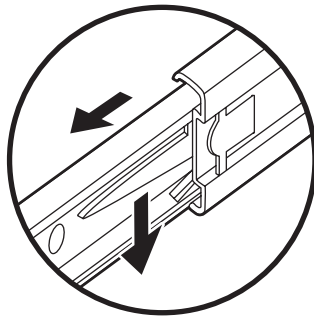

B. To Reinstall Drawers

- Insert the drawers by pulling cabinet tracks on both sides. All the way out (including ball bearing rack).
- Align tracks on drawer with sliders and push in the drawer until there is audible "click" sound.

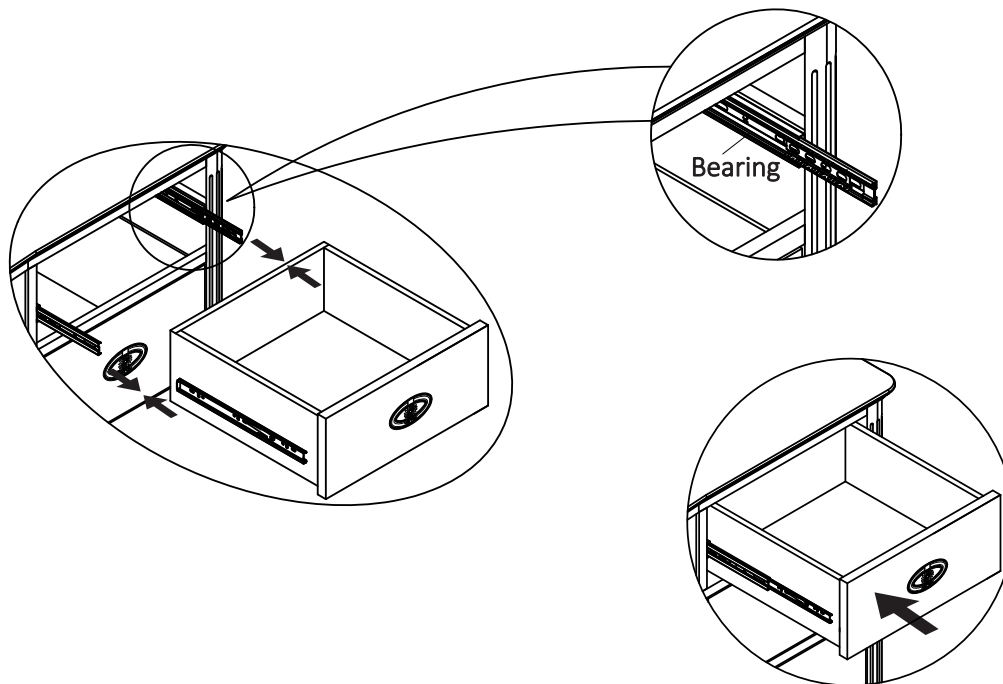

Maintenance

- ☐ Please periodically check all fittings and re-tighten as necessary.
- ☐ Do not use this product if parts are missing, damaged or worn.

Care and Cleaning

- ☐ Never allow any kind of liquid to remain on your furniture. Absorption can cause wood to warp or finishes to de-laminate.
- ☐ Please do not drag and pull your furniture.
- ☐ Please do not place hot items (e.g. hot drinks) directly on the surfaces. Please make sure you use a placement or coaster.
- ☐ Remove the drawers then lift them if need moving. We recommend to make a marking before remove it then insert back in original position.



Questions, problems, missing parts?

Before returning to the store, call Home Decorators Collection Customer Service.

8 a.m. – 7 p.m., EST, Monday – Friday, 9 a.m. – 6 p.m., EST, Saturday

1-800-986-3460

[HOMEDEPOT.COM/HOMEDECORATORS](https://www.homedepot.com/homedecorators)

Retain this manual for future use.