

HAMPTON BAY®

INSTALLATION GUIDE

UNFINISHED CABINET DOORS AND DRAWER FRONTS

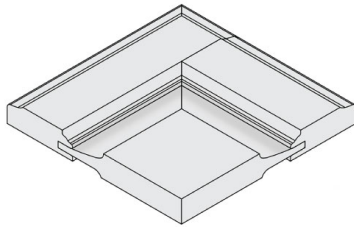

Raised Panel

- Square
- Arch
- Cathedral

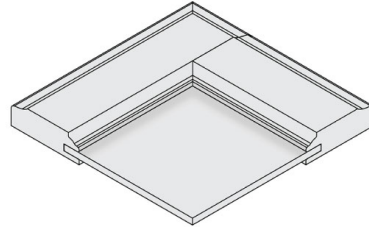

Profiled Recessed Panel

- Square
- Arch
- Cathedral

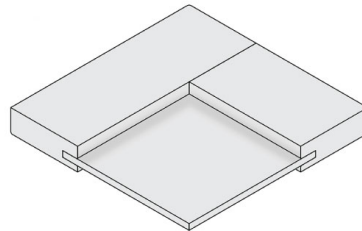

Shaker Recessed Panel

Questions, problems, missing parts? Before returning to the store,
call Hampton Bay Customer Service
8 a.m. – 7 p.m., EST, Monday – Friday, 9 a.m. – 6 p.m., EST, Saturday

1-855-HD-HAMPTON

HAMPTONBAY.COM

THANK YOU

We appreciate the trust and confidence you have placed in Hampton Bay through the purchase of Unfinished Cabinet Doors and Drawer Fronts. We strive to continually create quality products designed to enhance your home. Visit us online to see our full line of products available for your home improvement needs. Thank you for choosing Hampton Bay!

Table of Contents

Table of Contents.....	2	Pre-installation	3
Safety Information	2	Tools required	3
Warranty.....	2	Installation.....	4
What is Covered	2	Maintenance.....	5
What is Not Covered	2	Care and Cleaning.....	5

Safety Information

GUIDELINES

1. Read all measure and installation instructions before starting your project.
2. Review the list of tools and understand how to properly operate all tools before use.
3. Always wear protective eyewear.

 **WARNING: WOOD DUST WARNING**
This product can expose you to chemicals including wood dust, which are known to the State of California to cause cancer. For more information go to www.P65Warning.ca.gov.

NOTICE: EPA TSCA TITLE VI
Products are compliant with EPA TSCA Title VI regulations for formaldehyde emissions.

Warranty

UNFINISHED DOOR AND DRAWER FRONT WARRANTY

WHAT IS COVERED

Product is warrantied against warpage, swelling, twisting, or cracking for one year, when given reasonable treatment. Reasonable treatment requires that doors and drawer fronts:

- Be stored in areas not subject to abnormal heat, cold, dryness, humidity, or direct sunlight.
- Not be subject to extreme moisture (bleaching finishing technique, etc.)
- Not be subject to impairment of structural strength when fitting or applying hardware.
- Unfinished product should be finished on front, back, top, bottom, and sides with an equal amount of finish, as soon as possible, to aid in the prevention of unequal absorption or release of moisture. This is particularly important with Maple product as it is prone to moisture absorption, especially in areas with humid conditions and in the winter.

WHAT IS NOT COVERED

- A warp or twist of 3/16 of an inch or less is not considered a defect. Twists are measured by placing the face of the door against a true plane surface.
- The use of finishes that are old or that have not been mixed correctly (too much water content in both water or lacquer-based finishes) may cause uneven finish when applied to areas with putty and cannot be warrantied.
- Individual wood staves in raised wood panels naturally expand and contract, potentially causing hairline cracks where the wood panel meets the wood frame. Development of offsets from one wood stave to another can also appear. These natural movement in wood panels are not considered defects, thus are not warrantied when painted. Medium Density Fiberboard (MDF) panels are recommended for all paintable products.
- Effort is taken to minimize natural characteristics (pitch pockets, pin knots, sugar and mineral streaks). Since they are a natural occurrence in wood products, they are not considered a manufacturing defect.
- Do not apply additional weight to the cabinet doors as it could exceed the weight limits of the cabinet hinges and cause damage.

Contact the Customer Service Team at 1-855-HD-HAMPTON or visit www.Hamptonbay.com.

Pre-installation

TOOLS REQUIRED



Tape Measure



Safety goggles



Phillips and Flat Head screwdrivers

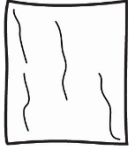

Cloth



Drill



Double Stick Tape

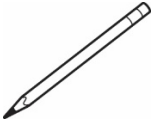

Pencil



Level

Installation

1 Prepare Surfaces

- Remove old doors by removing the screws from the hinges.
- Clean all surfaces with a clean cloth

2 Doors

- Install hinges into bored recesses in the back of the door with the appropriate screws
- Lightly mark with a pencil on the face frame the amount of your overlay. When using the 1/2" hinges in the program, a 1/2" overlay should be used.
- Use a helper, if possible, to hold the door in place while you install screws through hinge plate into edge of frame. A small pilot hole, 1/16" bit may be needed for hardwood frames. Hold the door so the edge is even with the pencil mark.

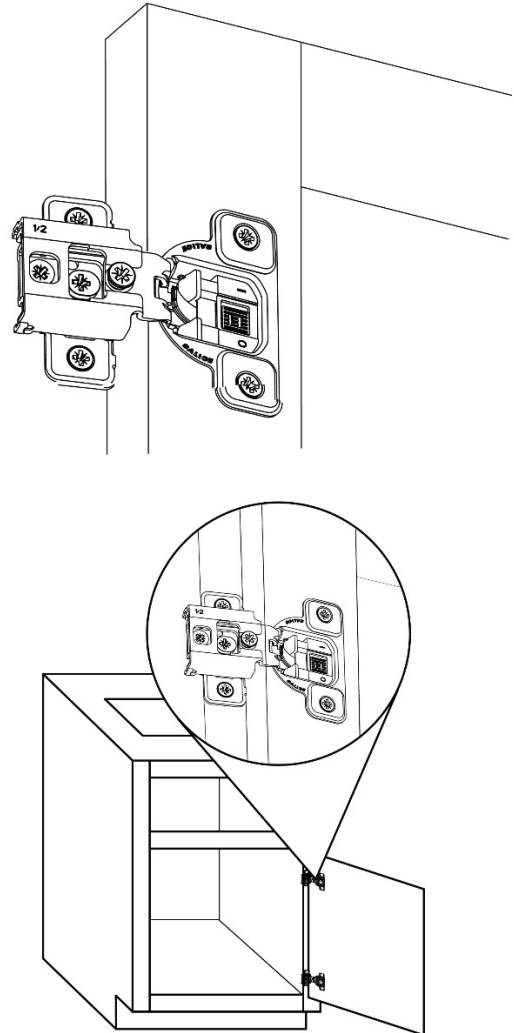

Installation

3 Drawer Fronts

- Determine the space between the door and drawer front, then cut a piece of scrap cardboard to this size to use as a spacer.
- Apply double stick tape to the back of the drawer front. Stick the drawer front onto the drawer.
- Open the door below, then pull out the drawer from underneath. Carefully remove drawer.
- Use pan head screws through the inside of the drawer into the back of the drawer front.
- For recessed panel 5-piece drawer fronts, align the screw holes to screw into the solid frame of the drawer front to avoid screwing through the face of the recessed panel.

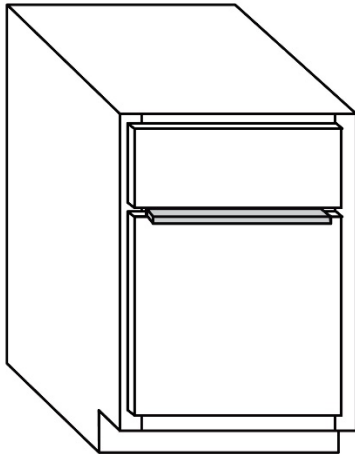

4 Hinge Adjustments

- Use 3-way adjustment options on hinges to move doors to align properly.
- Check door and drawer fronts with a level and adjust as needed.
- Adjust soft-close mechanism to start soft close at either 10-degree setting (0) or 30-degree setting (1).

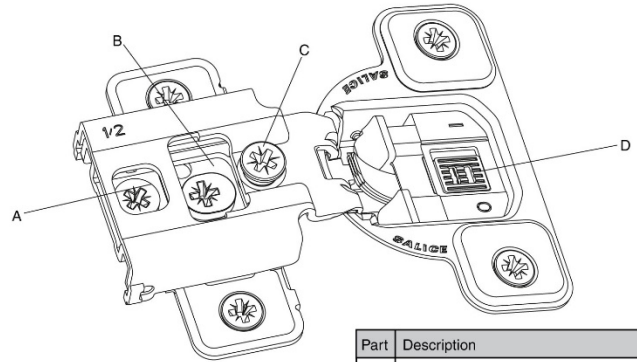

Part	Description
A.	Depth Adjustment (In - Out)
B.	Height Adjustment (Up - Down)
C.	Side Adjustment (Left - Right)
D.	Soft Close Switch: 1 = Soft Close starts at 30 degrees 0 = Soft Close starts at 10 degrees

Maintenance

Do not apply additional weight to the cabinet doors as it could exceed the weight limits of the cabinet hinges and cause damage.

Care and Cleaning

Follow all care and cleaning instructions for the finish you choose to apply.

HAMPTON BAY®

Questions, problems, missing parts? Before returning to the store,
call Hampton Bay Customer Service
8 a.m. – 7 p.m., EST, Monday – Friday, 9 a.m. – 6 p.m., EST, Saturday

1-855-HD-HAMPTON

WWW.HOMEDEPOT.COM/CUSTOMCABINETDOORS

Retain this manual for future use.