

Base Cabinet Assembly:

General notes:

- Assemble cabinet on a nonmarring surface – this can be the box that the cabinet came in.
 - Tools needed: philips head screw driver*, rubber mallet
 - a. * customer can also use a drill at the lowest torque setting being careful not to overdrive and strip the screws.
1. Align posts with pre-drilled holes and secure with screws. Repeat 4x on the back panel, side panels, and face frame for 16 posts total.

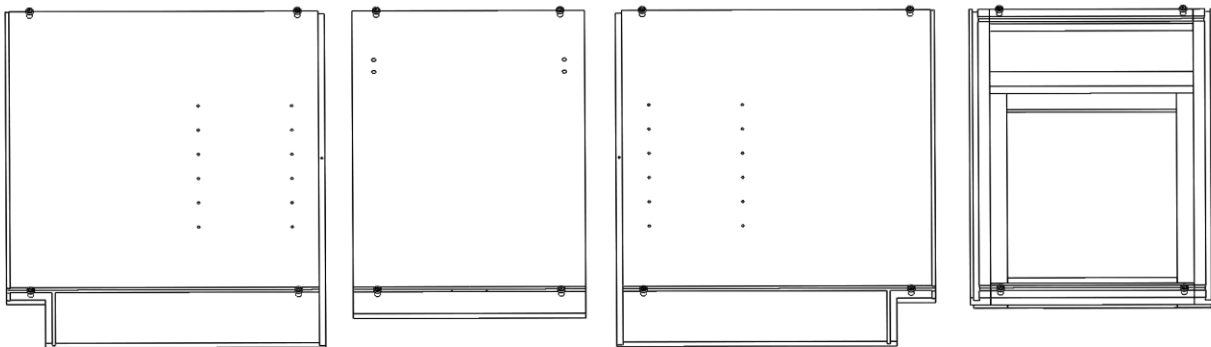
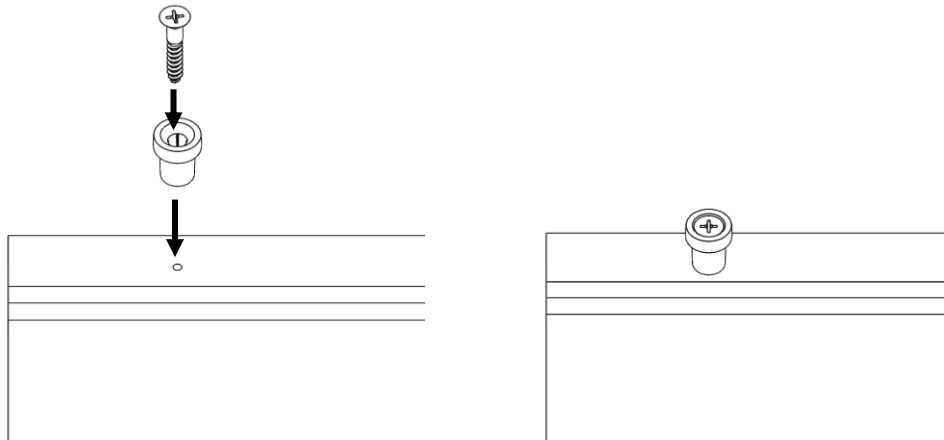

2. Slide side panels into mating grooves on the face frame. Start by placing the face frame flat on the ground with the door facing down. Repeat on both sides.

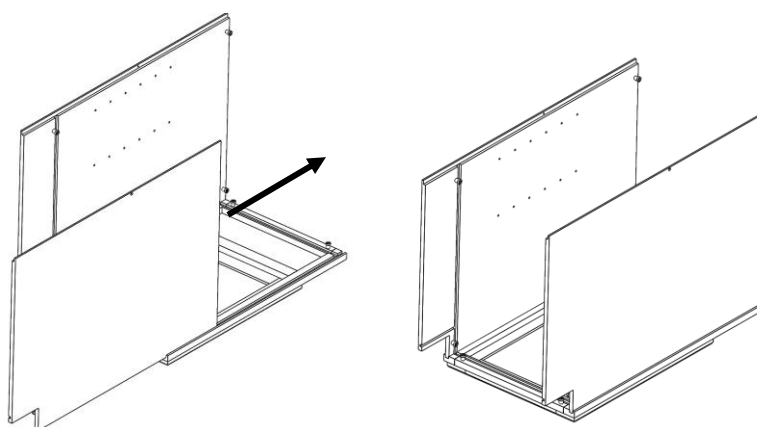
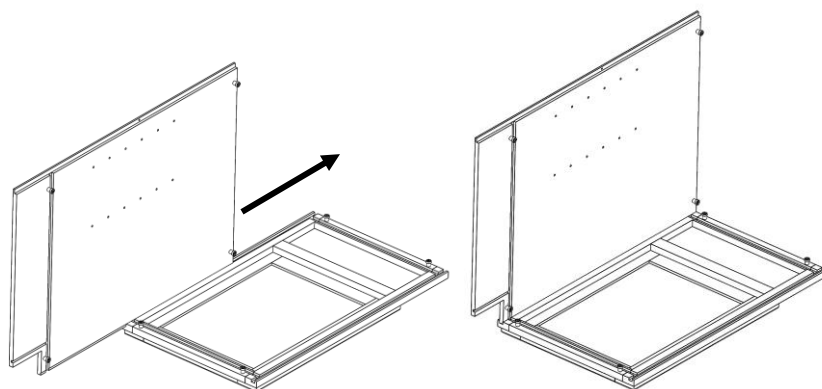

3. Slide the bottom panel into grooves in the sides. Snap corner locks over the knobs to secure the face frame and side panels, 4 locks total. At the top of the cabinet, the smooth face of each corner lock should be facing out. **If installing a laminate countertop, the smooth face should be facing the inside of the cabinet.

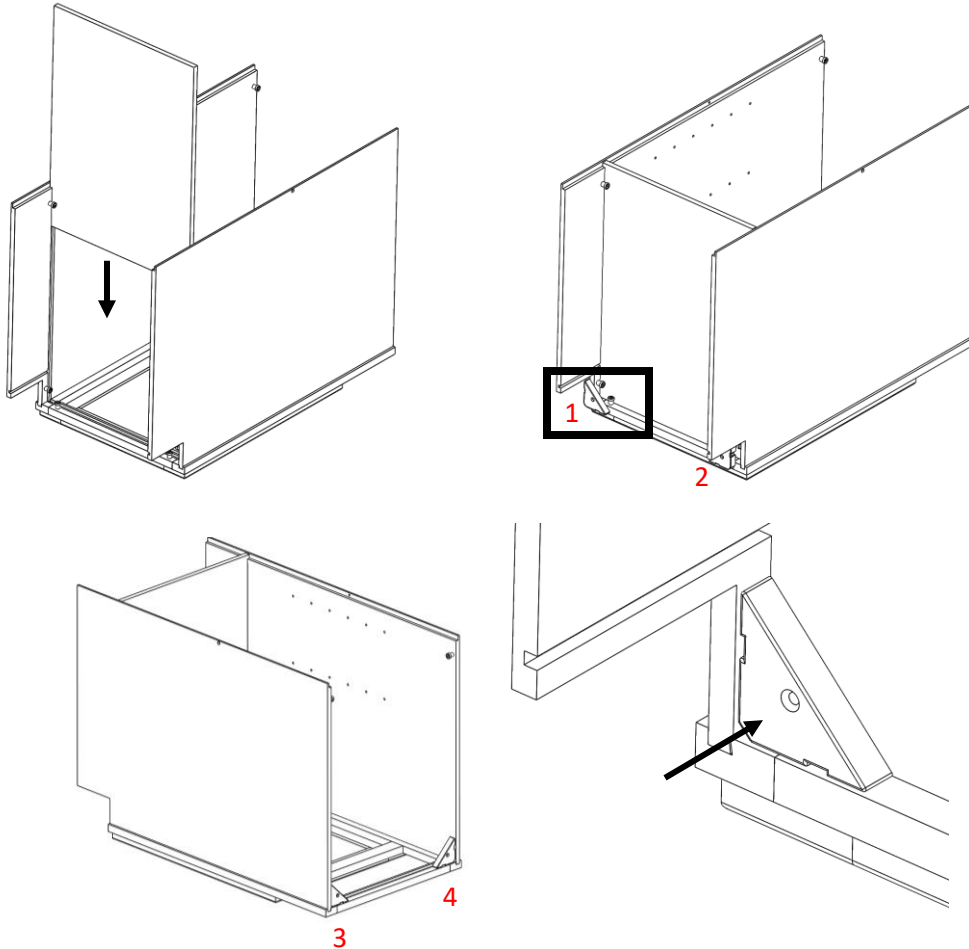

** If installing a laminate countertop, top corner locks should be oriented in the opposite direction. Bottom corner lock assembly will be the same for all countertop types.

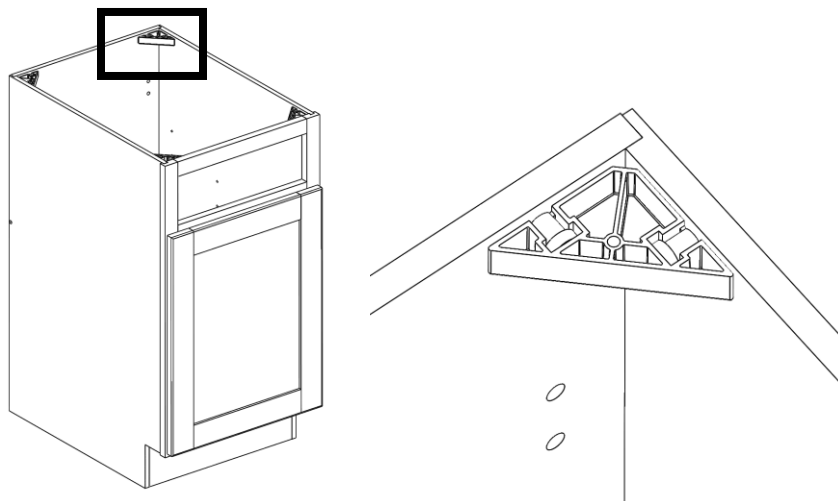

4. Assemble the back panel and attach the 4 remaining corner locks.

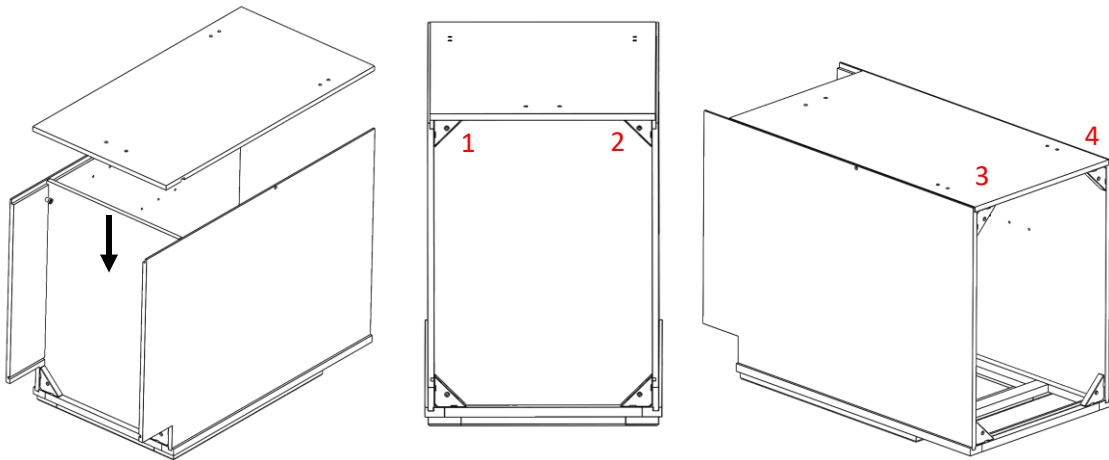

5. Insert screws through holes in the bottom 4 corner locks, and screw into the bottom panels (4 screws total).

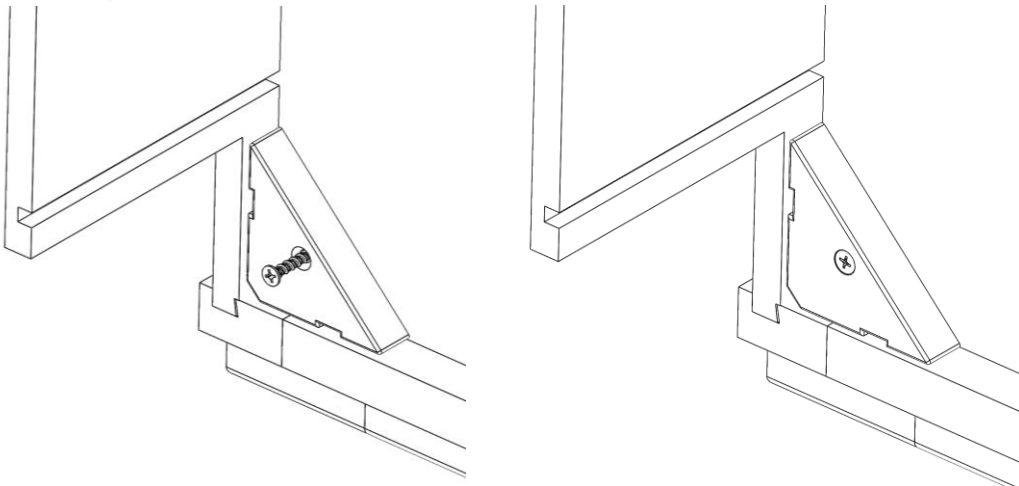

6. Slide toe kick into grooves in the side panel so that it sits flush with the bottom of the cabinet. Insert 2 screws into the pocket holes to secure the toe kick to the sides.

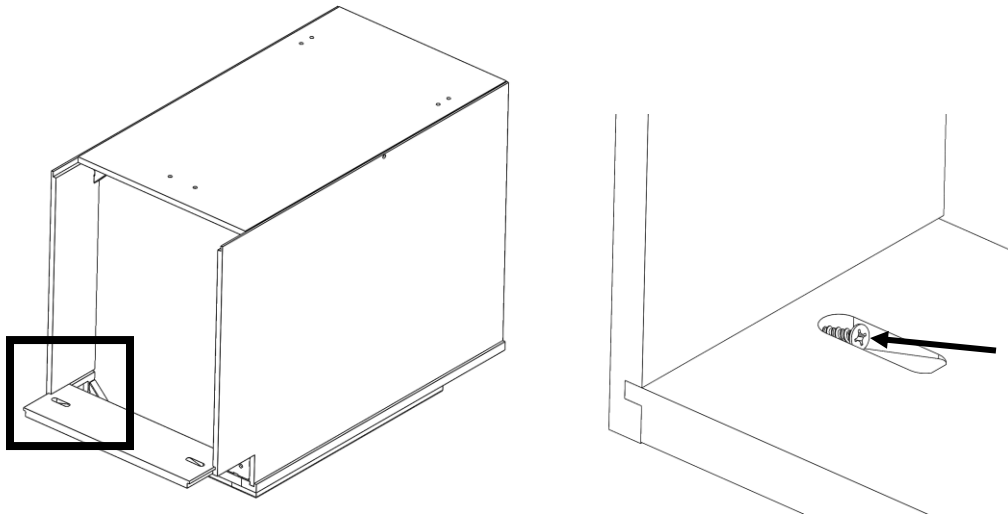

7. Insert screws into countersunk holes in the back and side panels. Wall cabinets 24" and wider will have two holes through the back, all other sizes will have one.

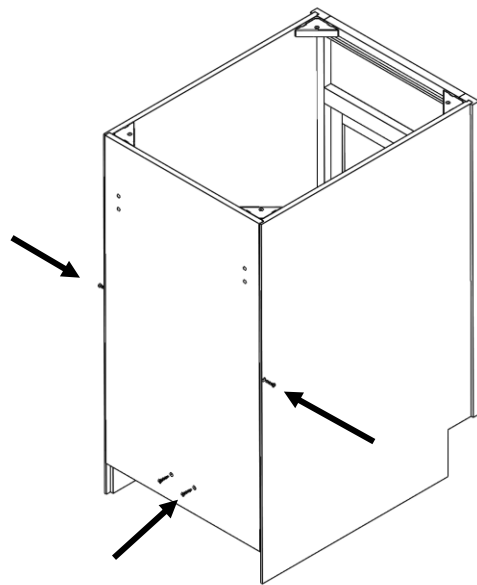

Drawer box assembly:

1. Place drawer face down on a flat surface. Use a rubber mallet to tap the side of the drawer box into place. Repeat on the opposite side. Insert screws into the countersink holes on each side, 2 screws total.

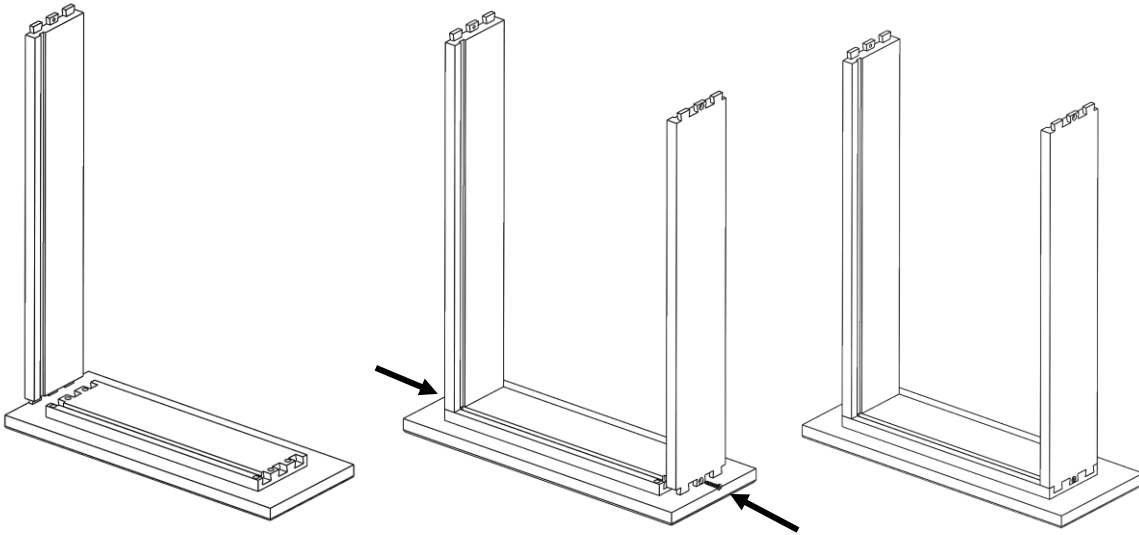

2. Slide bottom panel into grooves on the sides.

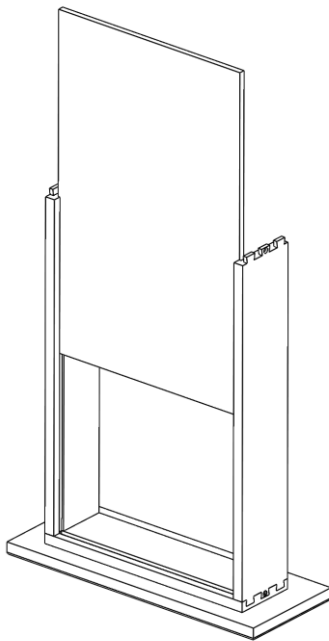

3. Use rubber mallet to tap back panel into place. Insert two more screws into the countersink holes on each side.

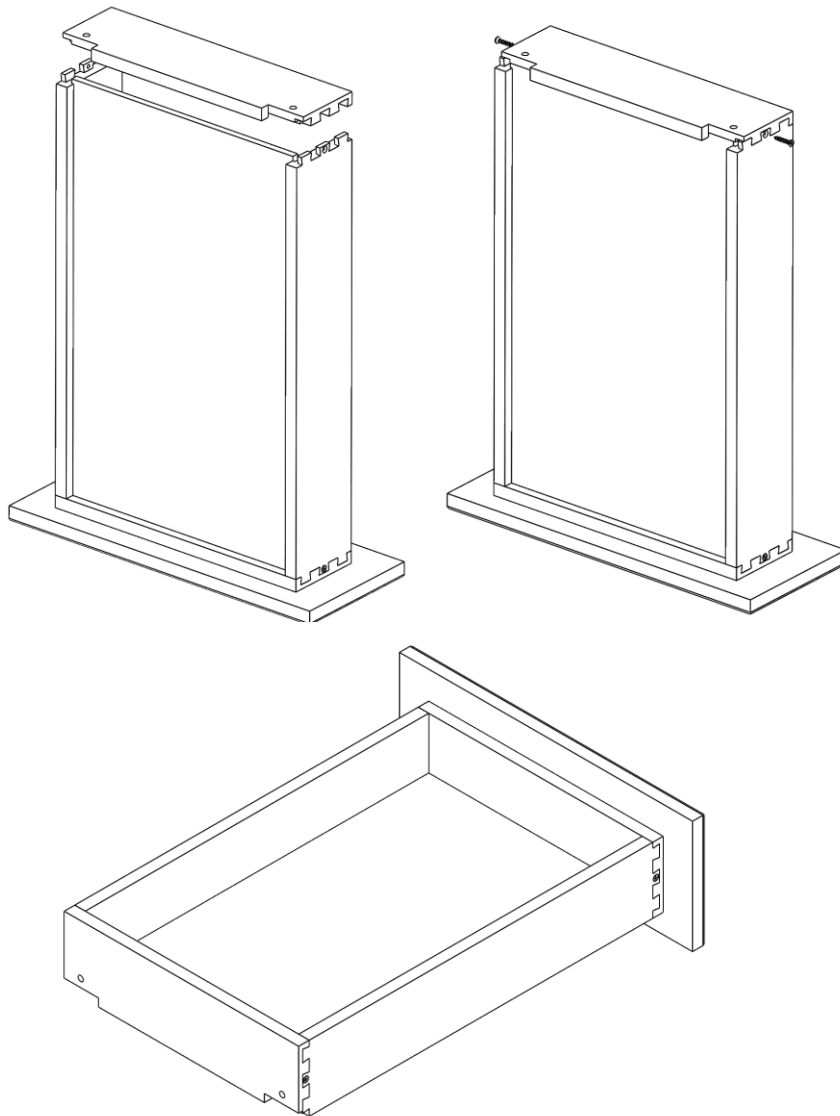

4. Install 2 drawer glide attachments to each drawer. Each glide attachment is secured with 2 screws. Screws are separately packaged with the drawer glides and drawer attachments.

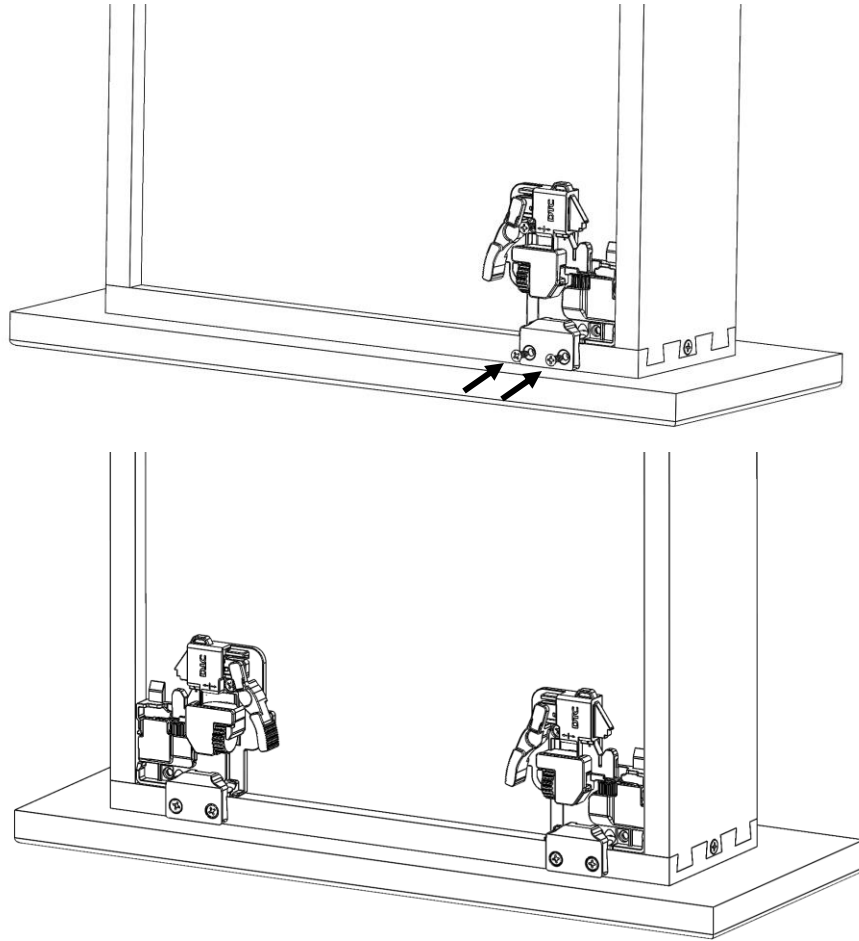

5. Install drawer glides by aligning pins with holes in the back panel. Press into place and use 2 screws to secure into the back panel. Use 1 screw to secure to face frame.

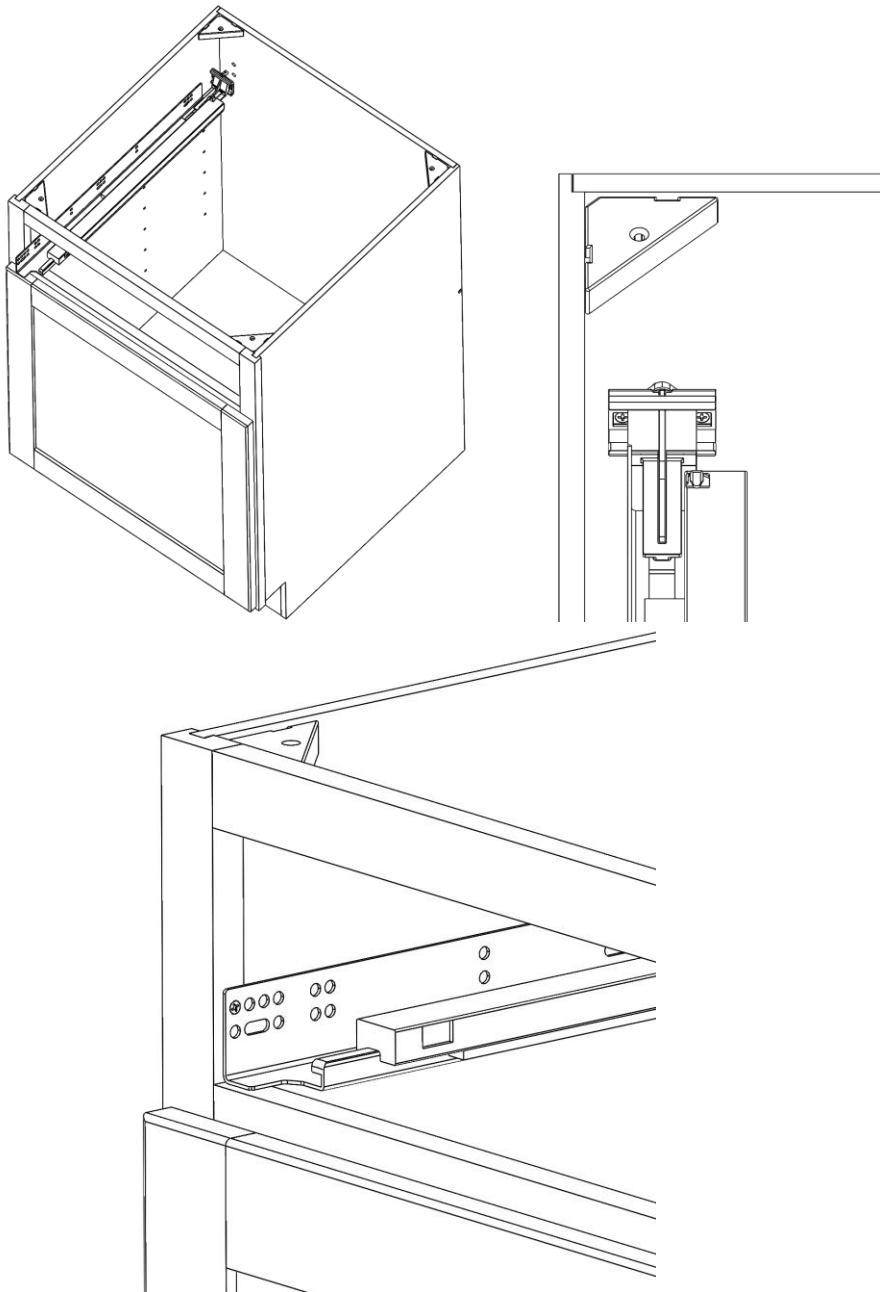

6. Pull glides out fully and install drawer. Drawer will click into place when aligned correctly with glides.

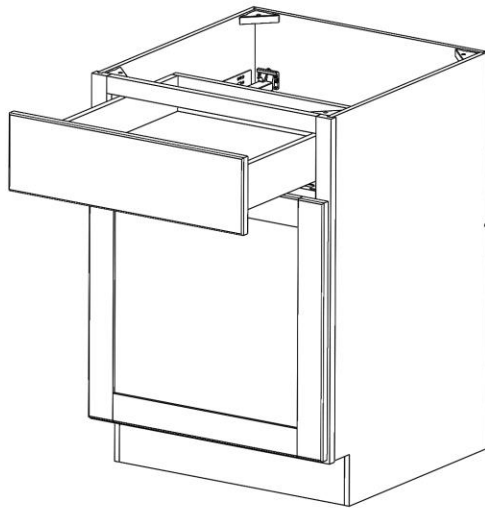

Holes in the back of the drawer will line up with metal prong:

