



BB-70 User Manual

TABLE OF CONTENTS

PRODUCT INFORMATION

Features.....	5
Parts.....	6
Dimensions.....	7

PRODUCT INSTALLATION

Pre-Installation.....	8
Installation.....	9

PRODUCT OPERATION

How To Use.....	13
-----------------	----

MAINTENANCE

Cleaning.....	14
Short Term Non-Use.....	14
Warranty.....	15

FEATURES

- High-quality ABS material with full body panel
- Premium quality metal inlet and installation parts
- Single nozzle
- Ambient temperature bidet wash
- Adjustable water pressure
- Unified internal brass valve
- Durable braided metal cold water hose
- No electricity or batteries required
- Adjustable toilet fit
- One-year warranty

PARTS

Bidet attachment with control knob

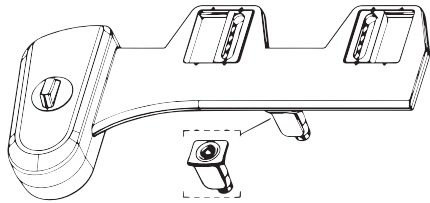

*T-Valve connector with rubber cone washer (7/8" x 7/8" x 3/8")

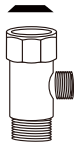

25.6" Braided metal hose



2 Protective O-rings

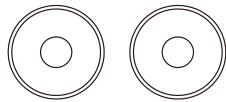

2 White washers

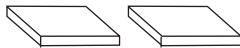

3 Toilet bumpers



DIMENSIONS

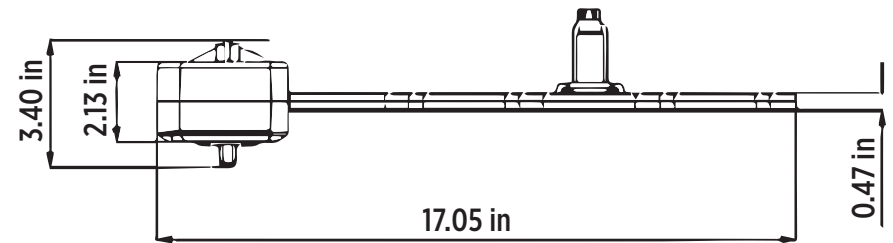
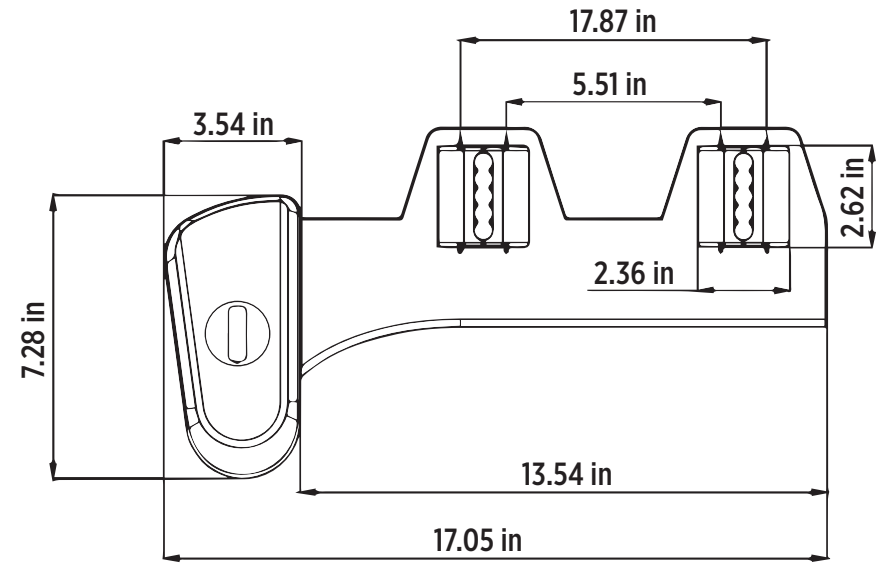

*Alternate fittings available, contact support@biobidet.com

PRE-INSTALLATION

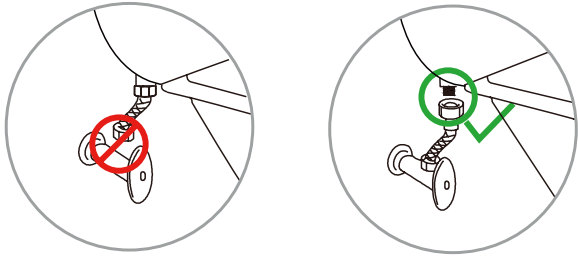

Please be advised that the provided T-Valve should be installed at the fill valve under the toilet tank, NOT down at the water supply coming from the wall.

Inspect your current water supply line that connects to the toilet tank fill valve to ensure it is a flexible water supply hose before installing the BB-70. The hose needs to be 7/8" (to connect to the T-Valve we provided) on one end and either 3/8" or 1/2", depending on your wall valve, on the other end.

If you do not have access to the fill valve under the toilet tank, contact Bio Bidet Customer Service at 847.458.2334 and we may be able to provide alternative fittings.

WARNING: Use care to avoid cross threading or over tightening the connection. Over tightening can cause leaking.

NOTICE: Observe all local plumbing, electrical and building codes. This device is designed for connection to a cold water source with a pressure of 20-80 psi.

INSTALLATION

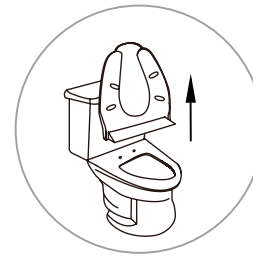

1. Remove the existing toilet seat by locating the bolts and nuts, typically under a plastic cover, and removing them first.

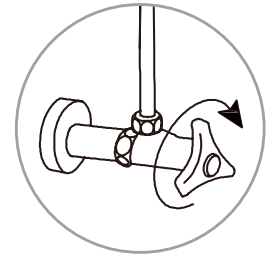

2. Close the water supply valve and flush the toilet completely so that there is little to no water left in the toilet tank.

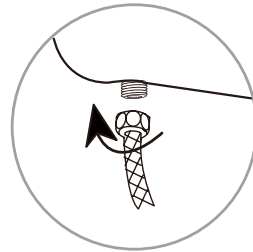

3. Disconnect the water hose from underneath the toilet tank.

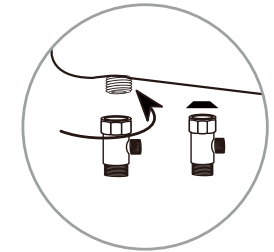

4. Connect the 7/8" T-Valve to the toilet fill valve where you just removed the water hose from.

Make sure the rubber washer is properly seated with the narrow side up.

INSTALLATION (CONT.)

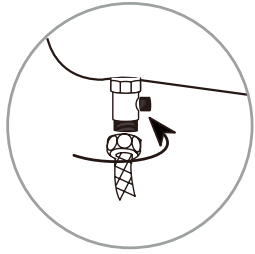

5. Attach the water supply hose that comes from the water shut off to the bottom of the T-Valve.

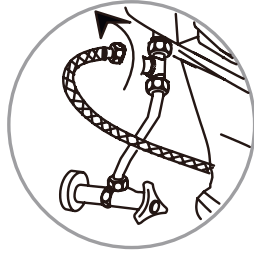

6. Connect the metal hose we supplied to the open side of the T-Valve.

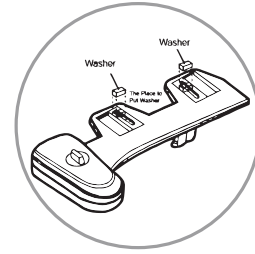

9. Use the white washers if the bidet leaves a gap between the toilet seat and bowl. Place the two washers above the sliding hooks to minimize the gap.

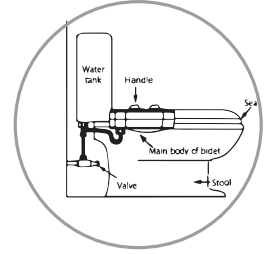

10. Connect the hose from step 6 to the bidet water connection underneath the handle of the BB-70.

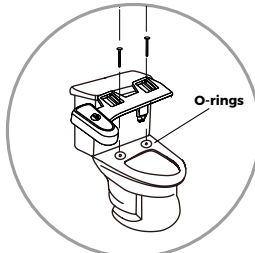

7. Place the bidet on the toilet with the mounting brackets over the bolt holes. Center the bidet on the toilet so that you can see the bolt holes through the mounting brackets of the bidet. Place the Protective O-rings under the mounting bracket.

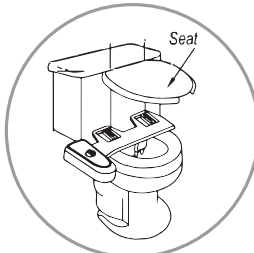

8. Place the toilet seat back on the toilet over the bidet and secure the bolts down so that the seat and bidet attachment are stable.

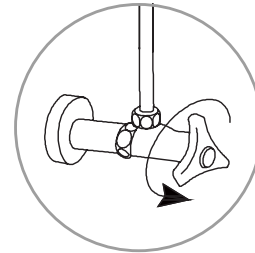

11. Slowly turn the water supply valve back on, check for leaks, and test the unit for functionality.



12. After installing your bidet attachment, check to see if there is a gap between the toilet base and toilet seat.

INSTALLATION (CONT.)

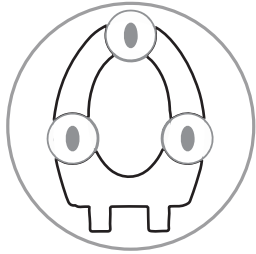

13. If necessary, place the bumpers on the underside of your toilet seat as indicated above.

HOW TO USE

Water can spray when no one is sitting on the seat. Do not activate the water until seated.

Adjust the water pressure control knob, choose the comfortable pressure you want. The water pressure control knob doesn't reset automatically, please turn it off manually.

When you want to clean the nozzle, pull it out and clean with a soft brush or cloth. Place the nozzle into the main body after cleaning and be careful not to lose the O-ring.

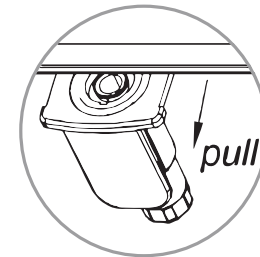

Detachable nozzle

If there are no immediate leaks, check again in about 5-10 minutes and your BB-70 is ready for use!

NOTE: If any leaks occur, check all rubber washers and make sure all connections are tight and secure. If leaking persists, discontinue the use of the unit, turn off the water source and contact support@biobidet.com.

CLEANING

Your BB-70 is made with a high grade fire-retardant ABS resin. Using hard cleaning chemicals can weaken the material, causing it to damage and develop cracks.

1. Clean the BB-70 by wiping the surface area with a damp cloth regularly.
2. Do not use harsh detergents or any cleaning tools with bristles on your bidet.

Steam cleaning is the preferred cleaning method for your bidet. For a deep, chemical free clean, consider the BioMist Bidet Cleaner.

SHORT TERM NON-USE

If the product will not be used for more than a few days, it is highly recommended that the water supply valve is turned off.

WARRANTY

Your Bio Bidet is warranted against defects in materials or workmanship for (1) year from the date of original purchase. Defective parts or a defective products returned to Bio Bidet will be repaired with new or comparable rebuilt parts or exchanged for a refurbished Bio Bidet as determined by Bio Bidet in their sole discretion.

This limited warranty given by Bio Bidet covers all defects encountered in normal use of Bio Bidet, and do not apply in the following cases:

1. Loss of or damage to Bio Bidet due to abuse, misuse, tampering, Mishandling, improper packaging by you, alteration or fail to follow operating instructions.
2. Use of parts or supplies (other than those by Bio Bidet's dealers) that cause damage to Bio Bidet.
3. Replacement of discolored or stained parts caused by chlorine, bleach, ammonia and other chemicals, cleaning supplies, oxidation, normal wear and tear.
4. Damage to or malfunction of the unit as a result of improper and negligent installation.
5. Any and all damages to plumbing, walls, floors, ceiling and personal properties resulting from water leaks or breakage. The product must be used at the user's own risk. Therefore, the owner hereby releases the manufacturer and distributor from any and all claims for damages where the above condition exists.

No implied warranty, including any implied warranty of merchantability or fitness or a particular purpose, applies to BBC Innovation LLC bidet after the applicable period of the express limited warranty stated above, and no other express warranty or guarantee, except as mentioned above, given by any person or entity with respect to Bio Bidet shall bind Bio Bidet. (Some States and provinces do not allow limitations on how long an implied warranty, so the above limitation may not apply to you) BBC Innovation LLC shall not be liable for revenues or profits, inconvenience, expense for substitute equipment or service, or any other special, incidental or consequential damages caused by the use or misuse of, or inability to use, Bio Bidet, regardless of the possibility and foresee-ability of such damages. In no event shall recovery of any kind against BBC Innovation LLC be greater in amount than the purchase price of the product and causing the alleged damage. Without limiting the foregoing, you assume all risk and liability for loss, damage or injury to you and your property and to others and their property arising out of use or misuse of, or inability to use, the Bio Bidet not caused directly by the negligence or BBC Innovation LLC. This limited warranty shall not extend to anyone other than the original purchaser of the Bio Bidet.

Thank You



Technical Support/Customer Service
7900 S Route 31 Crystal Lake, IL 60014
T: 847.458.2334
U.S TOLL FREE: 877.339.5214

support@biobidet.com
www.biobidet.com