

COUNTER ASSEMBLY GUIDE

Package includes:

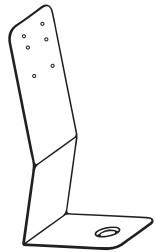

#A Counter Base (1)



#B Dispenser (1)

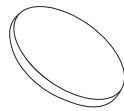

#C Rubber Feet (4)



#D Screw (4)



#E Locking Washer (4)



#F Butterfly Nut (4)

Step 1

Apply double-sided tape to each of the four #C rubber feet

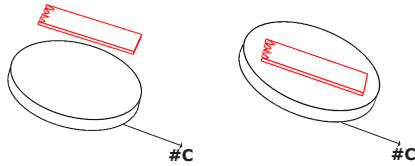

Step 2

Adhere the four #C rubber feet to the underside of the #A counter base as shown

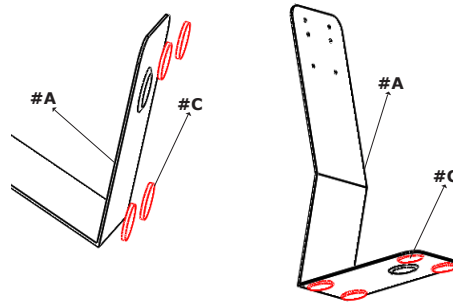

Step 3

Open the #B dispenser with the key provided or any flat object if necessary

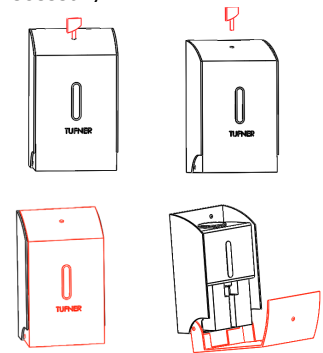

Step 4

Remove the reservoir from the #B dispenser

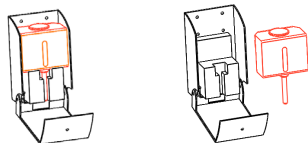

To install batteries (not included): push up on battery cover to open. Requires 4 C batteries

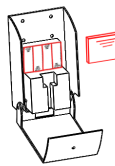
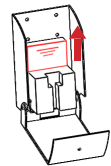

For detailed initial setup of the dispenser, please refer to the manual inside the dispenser package

Step 5

Align the holes on the #B dispenser with the holes on the back plate of the #A counter base

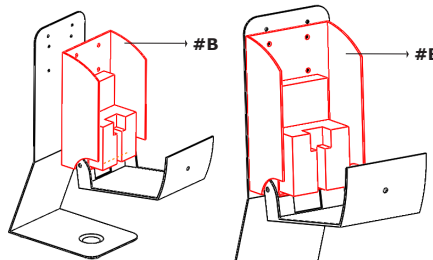

Step 6

Secure the #B dispenser onto the back plate of the #A counter base via #D screws, #E locking nuts, and #F butterfly nuts

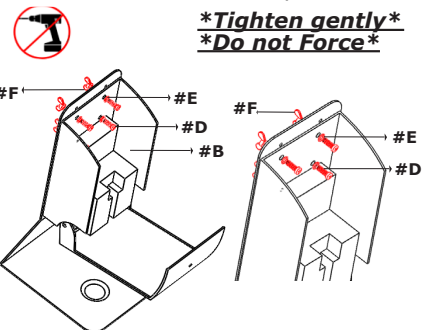

Step 7

Replace the reservoir into the #B dispenser

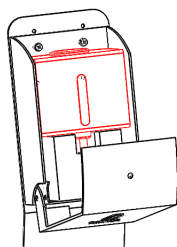
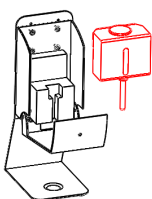

Step 8

Close the #B dispenser until it locks

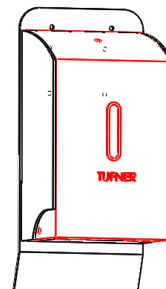
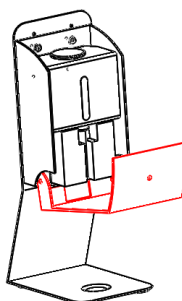

Step 9

Countertop dispenser completed!

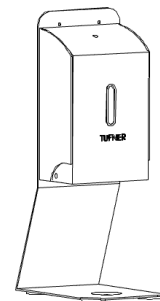

TUFNER INC.

HEADQUARTERS
9030 BRIDGEPORT PLACE RANCHO CUCAMONGA, CA 91730

MANUFACTURING FACILITY
1800-1900 NORTH COLLINS FWY. HOWE, TX 75459

888.688.4833
SALES@TUFNER.COM
WWW.TUFNER.COM