

How to Install:

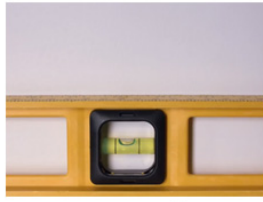

1. Clean the Wall

Lightly sand and clean the surface with a degreaser such as TSP, then dry properly.



2. Trace your guidelines

Using a level or chalk line to trace a guideline on wall.

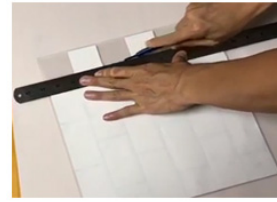

3. Measure & Cut

Measure with a ruler and report it on the tile. Cut along straight line from the first tile.



4. Peel and Stick

Simply fold back half of the protective paper in the back without touching the adhesive.

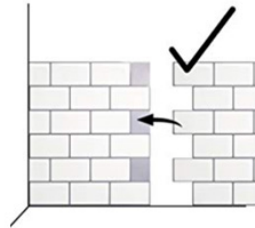

5. Align the Tiles

Align the tiles carefully and apply a light pressure, overlapping only on grout tiles.



6. Finished the project

Got your new wall decor style. EASY, QUICK, DIY.

Recommended Surface

smooth ceramic tiles backsplash, smooth glass tiles backsplash, acrylic wall panel, painted gypsum, wall linoleum, stainless metal, mirror, laminate, wallpaper (if some corners are peeling, just peel them off and install tiles over them).

Non-Recommended Surface

Orange peel texture wall, oily wall, brick wall, stucco wall, stone wall, unfinished wall (gypsum or plaster), unpainted plywood.

Wall & Tile Temperature

The temperature of the wall and tiles should be at least about 70°F for 12 hours before installation and 24 hours after installation. This is very important because if wall and tiles are cold, the tiles will not stick well. During the winter, the wall temperature is usually lower than room temperature so make sure that your walls are warm.

Press All Grout Lines Firmly

Make sure you press ALL grout lines firmly, and try NOT to touch the adhesive side as much as you can.