

7ft Closet System

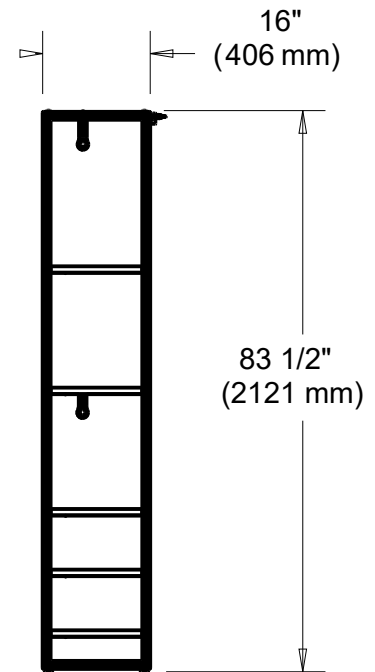
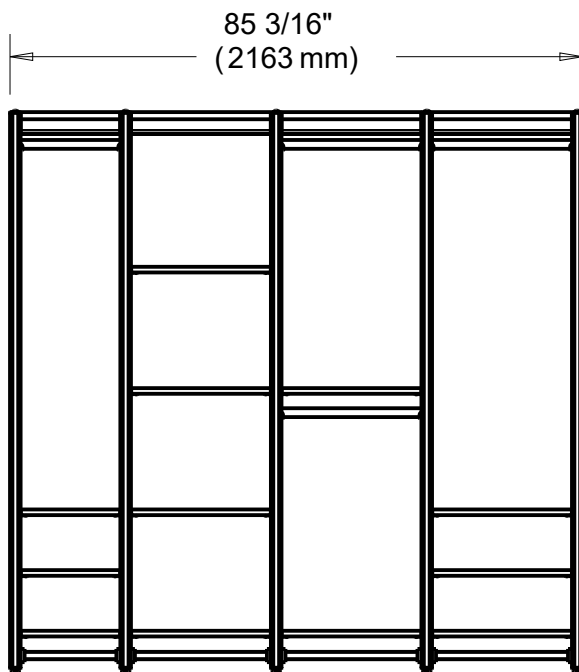
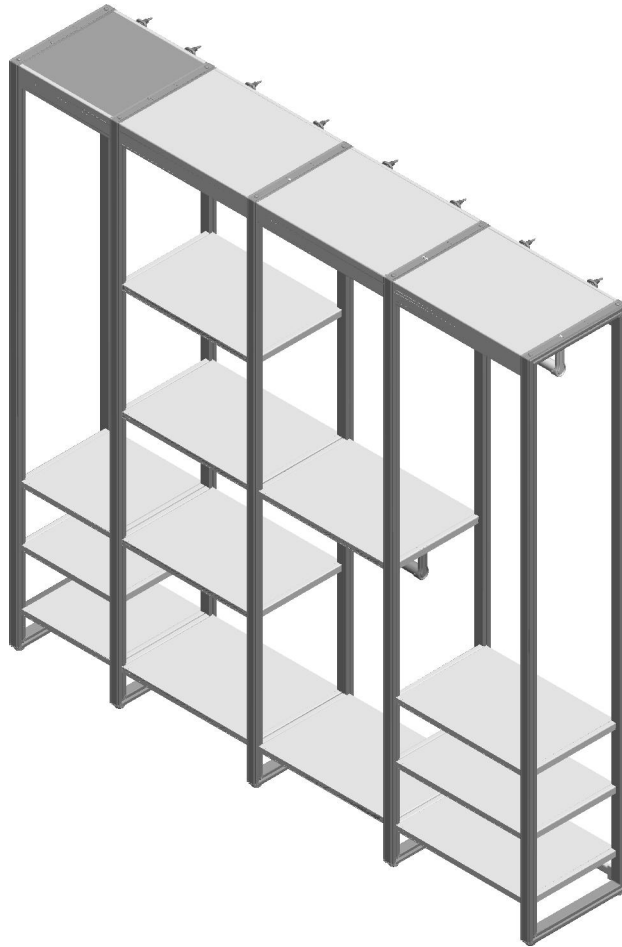

CLOSETS
By LIBERTY

7ft Closet System

ALUMINUM VERTICAL KITS

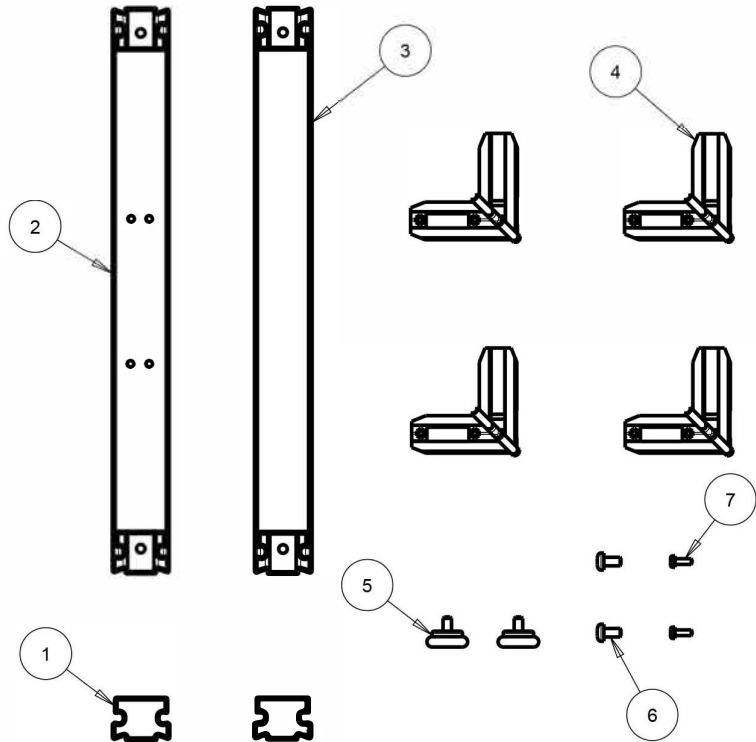
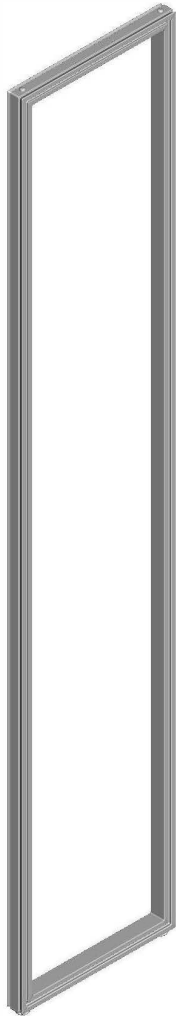

ID	DESCRIPTION	QTY
1	FULL HEIGHT VERTICAL EXTRUSION	2
2	HEADER MEMBER	1
3	HORIZONTAL MEMBER	1
4	COUPLER ASSEMBLY	4
5	LEVELING FEET	2
6	M6 X 12.0 PHILLIPS PAN HEAD MACHINE SCREW	2
7	M4 X 12.0 PHILLIPS PAN HEAD MACHINE SCREW	2

QTY: 5

MATERIALS: Powder Coated Aluminum Frame and Glass Filled Nylon Corners.

DIMENSIONS: Assembled closet organization system is 85-3/16 in. wide x 16-3/4 in. deep x 83.5 in. tall.

INSTALLATION: Detailed Instructions and Hardware Included for Easy Installation.

UNIQUE FEATURE: Smart customization with bracket locations every 4.5 in. to offer the maximum customizability and optimize space in the closet

WARRANTY: 1 Year Limited Warranty.

CLOSETS
By LIBERTY

7ft Closet System

FOUR SHELF AND HANGING BAR KIT

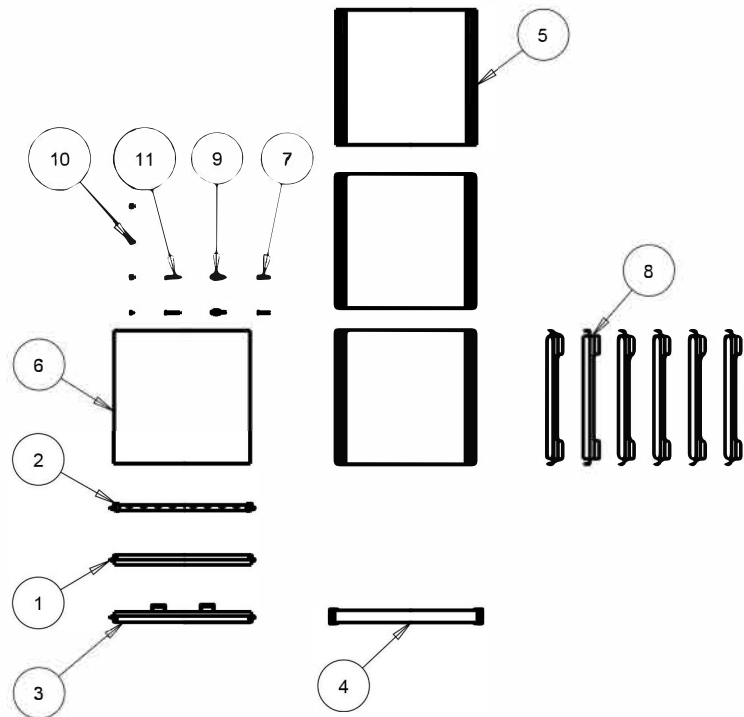
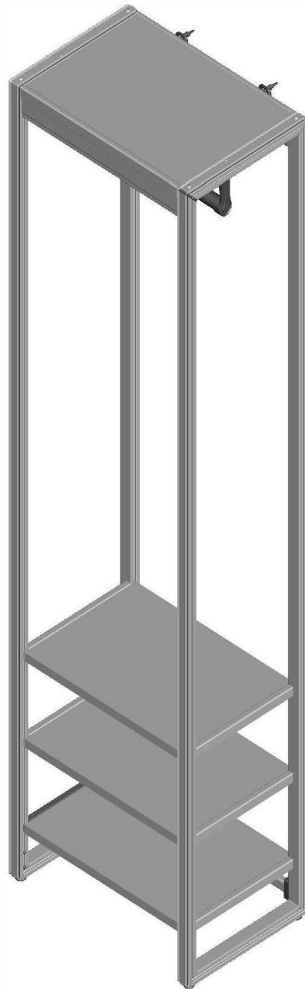

ID	DESCRIPTION	QTY
1	18IN FRONT STABILIZER ASSEMBLY	1
2	18IN REAR BOTTOM STABILIZER ASSEMBLY	1
3	18IN REAR TOP STABILIZER ASSEMBLY	1
4	18IN ROD ASSEMBLY	1
5	18IN SHELF ASSEMBLY	3
6	18IN TOP SHELF ASSEMBLY	1
7	#8 X 1-1/4" PHILLIPS PAN HEAD TAPPING SCREW	2
8	ACCESSORY BRACKET	6
9	AUGER ANCHORS	2
10	M4 X 10.0 FLAT HEAD TAPPING SCREW	4
11	M4 X 40.0 FLAT HEAD TAPPING SCREW	2

QTY: 1

MATERIALS: Aluminum hanging bars with Nylon brackets. Powder Coated Steel shelf supports. Engineered Wood shelves with Paper Coated Surface.

DIMENSIONS: Assembled closet organization system is 85-3/16 in. wide x 16-3/4 in. deep x 83.5 in. tall.

INSTALLATION: Detailed Instructions and Hardware Included for Easy Installation.

UNIQUE FEATURE: Allows for long hanging space and small item storage.

WARRANTY: 1 Year Limited Warranty.

CLOSETS
By LIBERTY

7ft Closet System

FIVE SHELF KIT

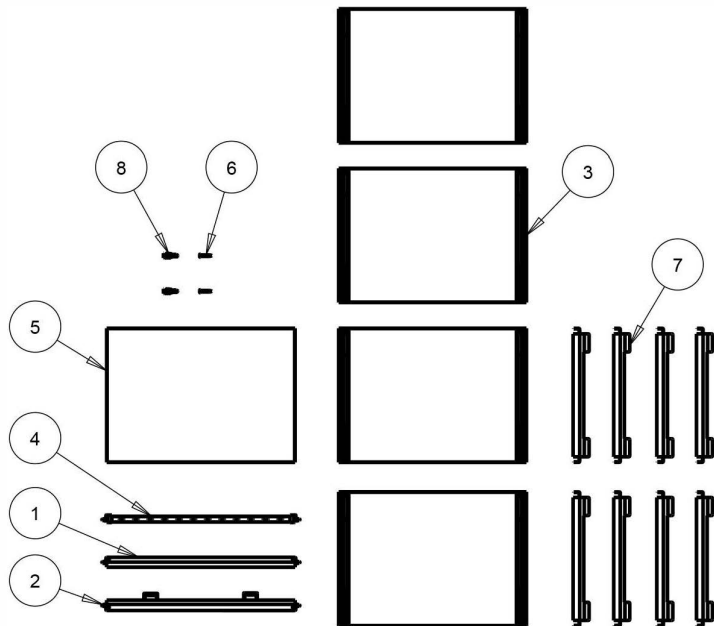
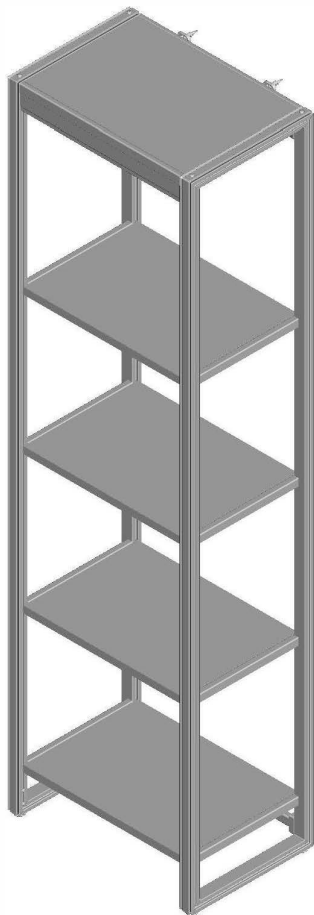

ID	DESCRIPTION	QTY
1	24IN FRONT STABILIZER ASSEMBLY	1
2	24IN REAR TOP STABILIZER ASSEMBLY	1
3	24IN SHELF ASSEMBLY	4
4	24IN REAR BOTTOM STABILIZER ASSEMBLY	1
5	24IN TOP SHELF ASSEMBLY	1
6	#8 X 1-1/4" PHILLIPS PAN HEAD TAPPING SCREW	2
7	ACCESSORY BRACKET	8
8	AUGER ANCHORS	2

QTY: 1

MATERIALS: Powder Coated Steel shelf supports. Engineered Wood shelves with Paper Coated Surface.

DIMENSIONS: Assembled closet organization system is 85-3/16 in. wide x 16-3/4 in. deep x 83.5 in. tall.

INSTALLATION: Detailed Instructions and Hardware Included for Easy Installation.

UNIQUE FEATURE: Dynamic customization allows you to move anything, anywhere at any time for the ultimate in customization in your closet.

WARRANTY: 1 Year Limited Warranty.

CLOSETS
By LIBERTY

7ft Closet System

TWO HANGING BAR KIT

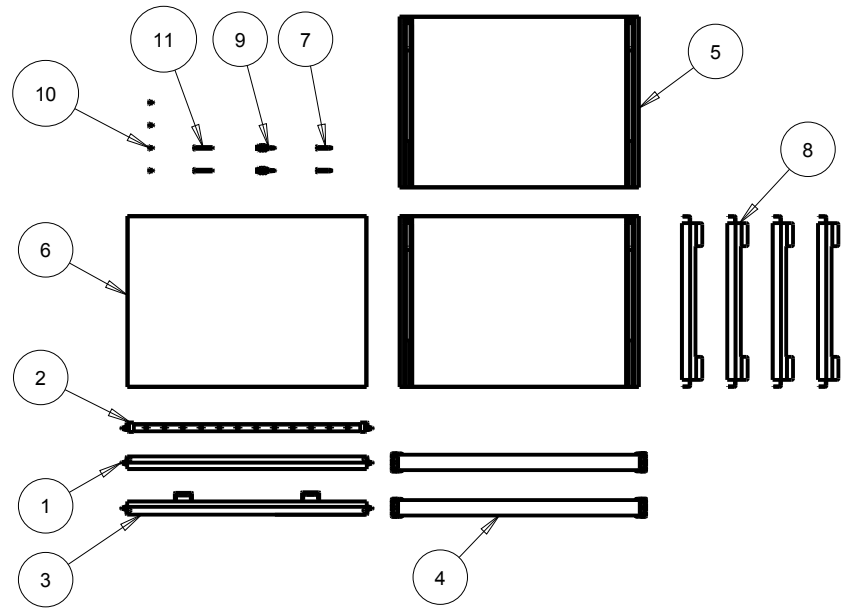
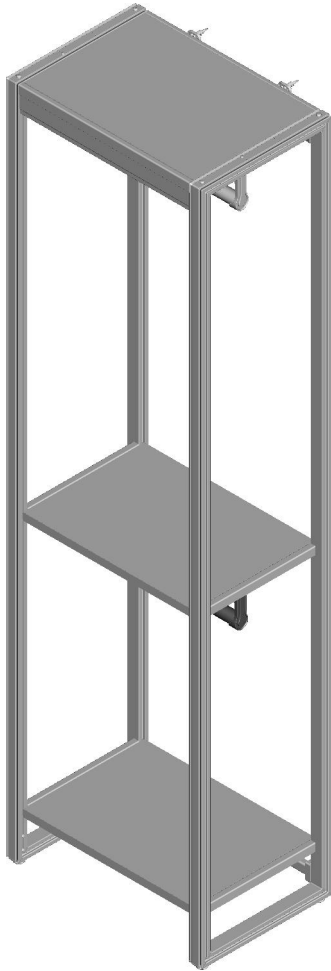

ID	DESCRIPTION	QTY
1	24IN FRONT STABILIZER ASSEMBLY	1
2	24IN REAR BOTTOM STABILIZER ASSEMBLY	1
3	24IN REAR TOP STABILIZER ASSEMBLY	1
4	24IN ROD ASSEMBLY	2
5	24IN SHELF ASSEMBLY	2
6	24IN TOP SHELF ASSEMBLY	1
7	#8 X 1-1/4" PHILLIPS PAN HEAD TAPPING SCREW	2
8	ACCESSORY BRACKET	4
9	AUGER ANCHORS	2
10	M4 X 10.0 FLAT HEAD TAPPING SCREW	4
11	M4 X 40.0 FLAT HEAD TAPPING SCREW	2

QTY: 1

MATERIALS: Aluminum hanging bars with Nylon brackets. Powder Coated Steel shelf supports. Engineered Wood shelves with Paper Coated Surface.

DIMENSIONS: Assembled closet organization system is 85-3/16 in. wide x 16-3/4 in. deep x 83.5 in. tall.

INSTALLATION: Detailed Instructions and Hardware Included for Easy Installation.

UNIQUE FEATURE: Need more storage? Our complementing accessories work within the closet system for an easy addition to help optimize your storage space.

WARRANTY: 1 Year Limited Warranty.



7ft Closet System

FOUR SHELF AND HANGING BAR KIT

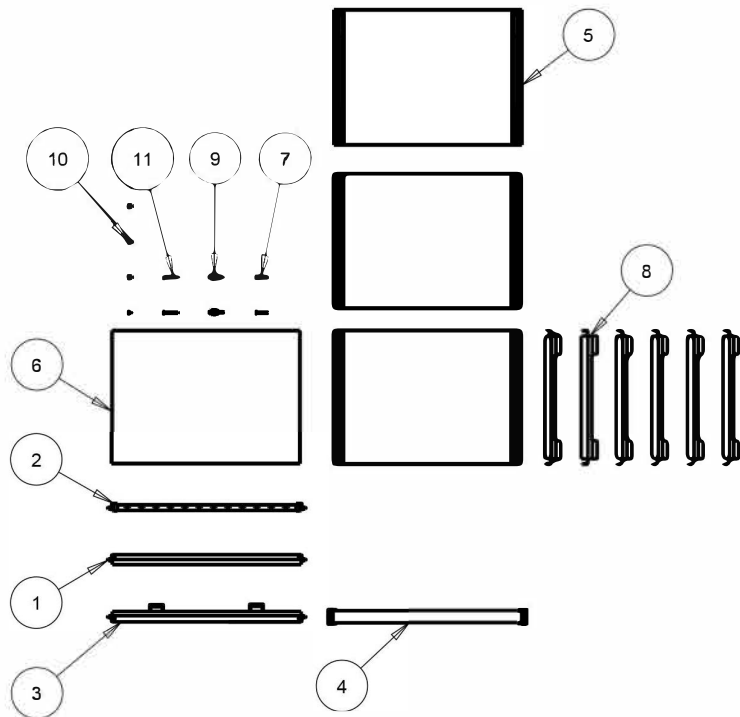
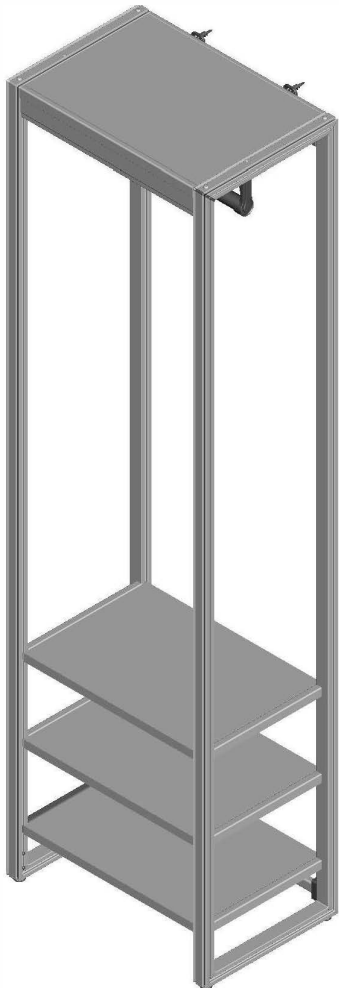

ID	DESCRIPTION	QTY
1	24IN FRONT STABILIZER ASSEMBLY	1
2	24IN REAR BOTTOM STABILIZER ASSEMBLY	1
3	24IN REAR TOP STABILIZER ASSEMBLY	1
4	24IN ROD ASSEMBLY	1
5	24IN SHELF ASSEMBLY	3
6	24IN TOP SHELF ASSEMBLY	1
7	#8 X 1-1/4" PHILLIPS PAN HEAD TAPPING SCREW	2
8	ACCESSORY BRACKET	6
9	AUGER ANCHORS	2
10	M4 X 10.0 FLAT HEAD TAPPING SCREW	4
11	M4 X 40.0 FLAT HEAD TAPPING SCREW	2

QTY: 1

MATERIALS: Aluminum hanging bars with Nylon brackets. Powder Coated Steel shelf supports. Engineered Wood shelves with Paper Coated Surface.

DIMENSIONS: Assembled closet organization system is 85-3/16 in. wide x 16-3/4 in. deep x 83.5 in. tall.

INSTALLATION: Detailed Instructions and Hardware Included for Easy Installation.

UNIQUE FEATURE: Allows for long hanging space and small item storage.

WARRANTY: 1 Year Limited Warranty.

CLOSETS
By LIBERTY