

## outdoor basic

## Main Components

Canopy Tent (SKU # ODF006)

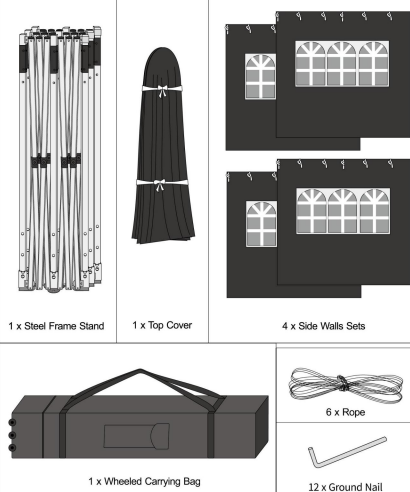

Page 1

## outdoor basic

④

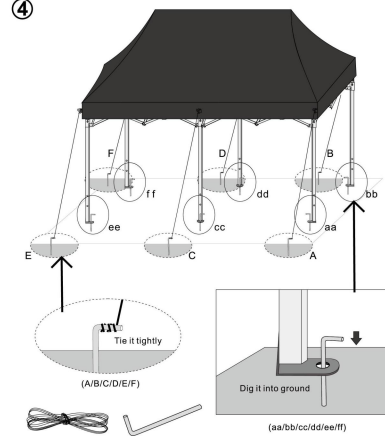

4. Install the following parts - aa, bb, cc, dd, ee, ff as showed in pictures: make the ground-nail through the hole of bottom of each steel main stand then push it into the ground.  
For the following part - A, B, C, D, E, F:  
Twine the same rope on the top steel frame and ground-nail, at the same time, please tie them tightly, and dig all ground-nails into the ground.  
Please follow above instructions to make your tent stable enough to use.

Page 6

## outdoor basic

② -1

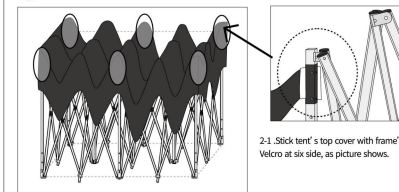

② -2

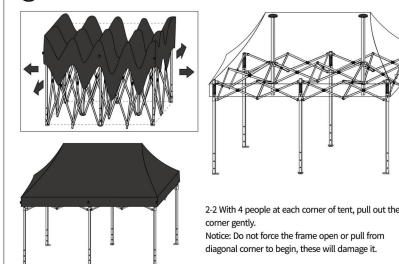

Page 3

## outdoor basic

①

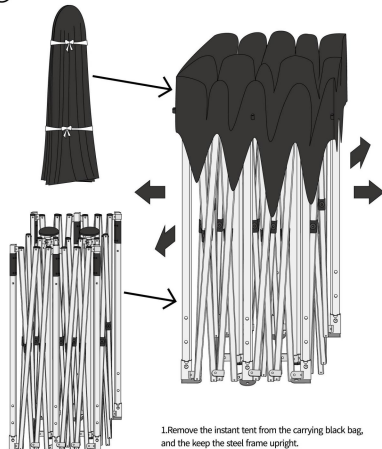

Page 2

## outdoor basic

⑤

5. HOW TO FOLD BACK:  
Each main stand has two clip, one is at top and the other is at the middle, push in them and the tent will be folded back as regularly.

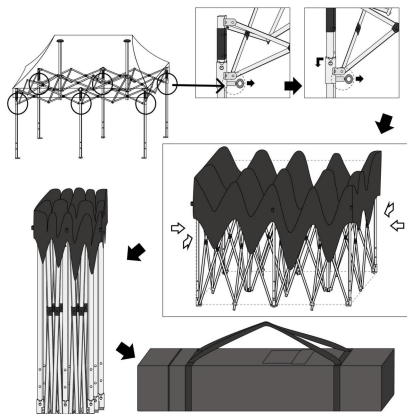

Page 7

## outdoor basic

② -3

2-3. Secure the sides of the tent to the frame with Velcro, as pictures show.

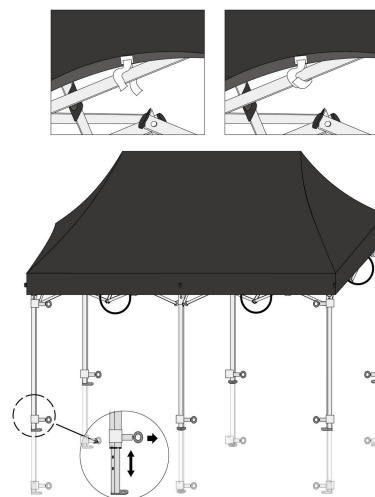

Page 4

## outdoor basic

③

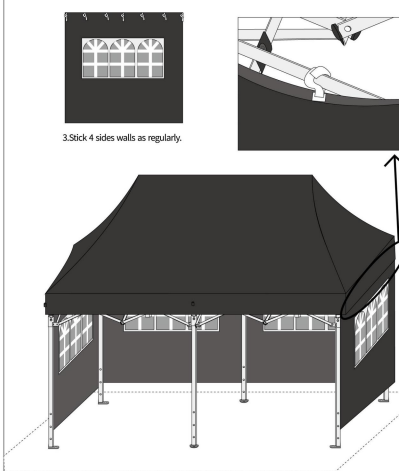

Page 5