

Owner's Manual

POWERTEC[®]

1" X 30" BELT SANDER

? QUESTION...
1-847-780-6120

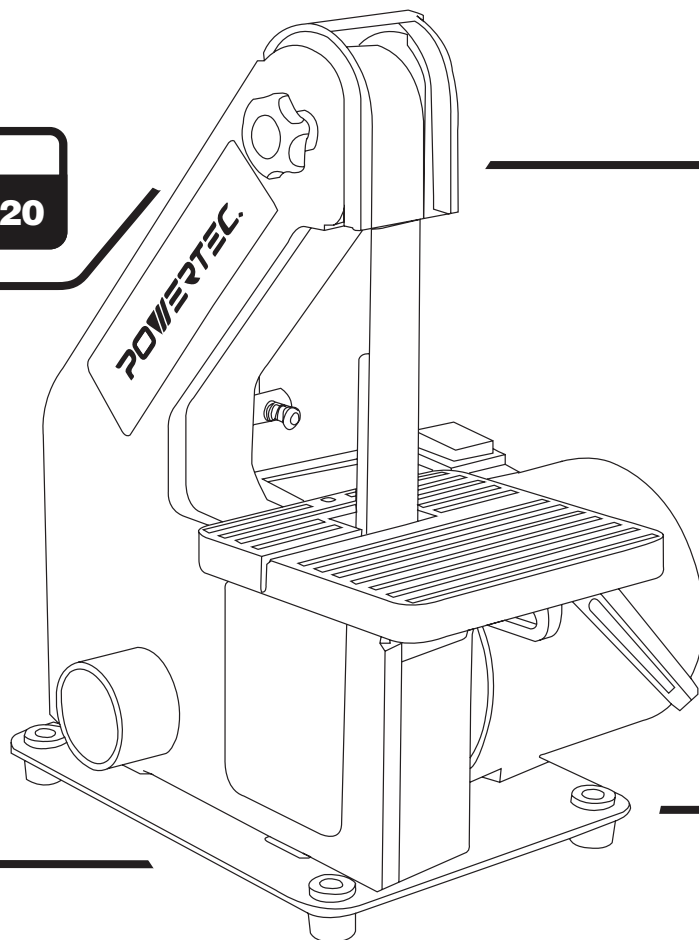







Visit us on the web at www.southerntechllc.com



You will need this manual for safety instructions, operating procedures, and warranty. Put it and the original sales invoice in a safe, dry place for future reference.

TABLE OF CONTENTS

SECTION	PAGE
 SAFETY RULES	1
Work Preparation Work Area Preparation Tool Maintenance Tool Preparation	
 ASSEMBLY	2
Unpackaging Tool Needed Mounting the Sanding Belt Table Replacing the Sanding Belt Sanding Belt Tracking Adjustment Backstop Dust Port Options Mounting the Sander to Work Surface Power Source Grounding Instructions Extension Cords Motor Electrical Connections	
 OPERATION	6
ON/OFF Switch Surface Sanding On Sanding Belt End Sanding - Belt Contour Sanding With The Belt	
 MAINTENANCE	6
General Maintenance Lubrication	
 TROUBLESHOOTING	7
 PARTS ILLUSTRATION & LIST	8
 WARRANTY	10

PRODUCT SPECIFICATIONS

Horsepower	1/3
Voltage	120
Amp	3
Hertz	60
Phase	Single
RPM	3260
Belt Size	1" x 30"
Belt Table Dimensions	5" x 5"
Dust Ports Diameter	1-3/4" OD
Base Dimensions	6-1/2"x 8-5/8"
Net Weight	11.6 lb

GENERAL SAFETY RULES



1

WARNING

For your own safety, read and understand all warnings and operating instructions before using any tool or equipment.

WARNING

The 1" belt sander can be used for processing wood and metal products. However, combining both wood dust and metal filings can create a FIRE HAZARD. Make certain dust collector is free of wood dust deposits before processing metal products.

WARNING

Some dust created by operation of power tool contains chemicals known to the State of California to cause cancer, birth defects or other reproductive harm. To reduce your exposure to these chemicals, work in a well ventilated area and work with approved safety equipment. Always wear OSHA/NIOSH approved, properly fitting face mask or respirator when using such tools.

WARNING

Failure to follow these rules may result in serious personal injury. Remember that being careless for even a fraction of a second can result in severe personal injury.

WORK PREPARATION

- Wear proper apparel. Do not wear loose clothing, gloves, neckties, rings, bracelets or other jewelry which may get caught in moving parts of the tool.
- Non-slip protective footwear is recommended. Wear protective hair covering to contain long hair.
- Wear eye and hearing protection. Always use safety glasses. Eye protection equipment should comply with ANSI Z87.1 standards. Hearing equipment should comply with ANSI S3.19 standards.
- Wear face mask or dust mask if operation is dusty.
- Be alert and think clearly. Never operate power tools when tired, intoxicated or when taking medications that cause drowsiness.

WORK AREA PREPARATION

- Keep work area clean. Cluttered work areas and benches invite accidents.
- Work area should be properly lighted.
- Do not use the machine in a dangerous environment. The use of power tools in damp or wet locations or in rain can cause shock or electrocution.
- Three-prong plug should be plugged directly into properly grounded, three-prong receptacle.
- Use the proper extension cord. Make sure your extension cord is in good condition. It should have grounding prong and should be of the correct gauge.
- It should have a grounding prong and should be of the correct gauge.

- Keep children and visitors away. Your shop is a potentially dangerous environment. Children and visitors can be injured.
- Make your workshop childproof with padlocks, master switches or remove switch keys to prevent any unintentional use of power tools.

TOOL MAINTENANCE

- Turn the machine "OFF", and disconnect the machine from the power source prior to inspection.
- Maintain all tools and machines in peak condition. Keep tools clean for best and safest performance.
- Follow instructions for lubricating and changing accessories.
- Check for damaged parts. Check for alignment of moving parts, binding, breakage, mounting and any other condition that may affect tool's operation.
- Poorly maintained tools and machines can further damage the tool or machine and/or cause injury.
- Keep guards in place. A guard or any other part that is damaged should be repaired or replaced. Do not perform makeshift repairs.

TOOL OPERATION

- Avoid accidental start-up. Make sure that the tool is in the "OFF" position before plugging in.
- Use the right tool for your job. Do not force your tool or attachment to do a job for which it was not designed.
- Use recommended accessories. Use of improper accessories may cause risk of injury to persons.
- Disconnect tool when changing parts.
- Don't force the workpiece on the machine. Damage to the machine and/or injury may result.
- Never leave tool running unattended. Turn the power off and do not leave tool until it comes to a complete stop.
- Do not overreach. Loss of balance can make you fall into a working machine, causing injury.
- Never stand on tool. Injury could occur if the tool tips, or if you accidentally contact the cutting tool.
- Know your tool. Learn the tool's operation, application and specific limitations before using it.
- Handle workpiece correctly. Keep hands away from moving parts.
- Turn tool off if it jams.
- Always feed workpiece against the direction of the sanding rotation. To maintain control, properly support long or wide work-pieces.

CAUTION

Think safety! Safety is a combination of operator common sense and alertness at all times when tool is being used.

WARNING

Do not attempt to operate tool until it is completely assembled according to the instructions.

**SAVE ALL WARNINGS AND INSTRUCTIONS
FOR FUTURE REFERENCE**



1

2

ASSEMBLY

UNPACKING

Refer to Figure 1.
Check for shipping damage. Check immediately whether all parts and accessories are included.

The sander comes assembled as one unit. Additional parts which need to be fastened to sander, should be located and accounted for before assembling.

ITEM	DESCRIPTION	QUANTITY
A	Sanding Belt Table	1
B	Locking Lever (Sanding Belt Table)	1

Figure 1

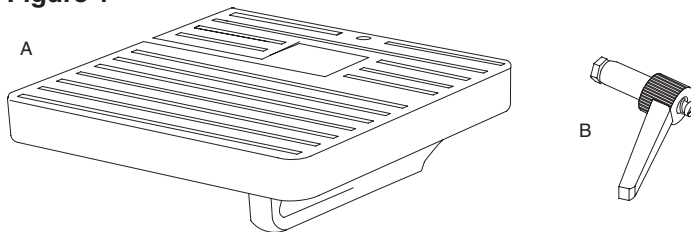
**WARNING**

Do not use the machine until it is completely assembled and you have read and understood the entire operating manual.

TOOLS NEEDED

The following tools (not included) are needed to assemble and adjust the belt sander:

- Combination square
- Phillips screwdriver
- 3 mm Hex Wrench

MOUNTING THE SANDING BELT TABLE

Refer to Figure 2–5

- Remove the belt guard locking knob and then the side belt guard.

Figure 2

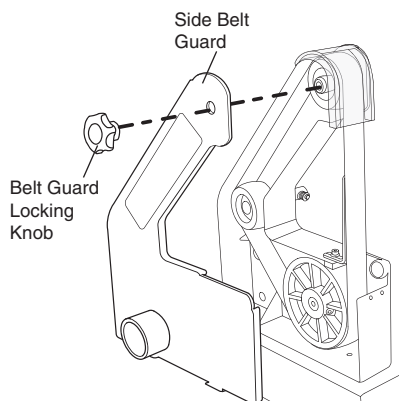

- Take apart the locking lever assembly (hex headed bolt, washer, splined shaft, lever and screw with spring).

Figure 3

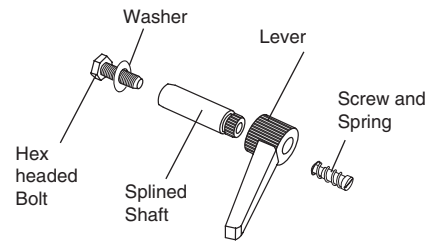

- Slide the sanding belt table into place with the adjusting slot over the hex head bolt.
- Slide the washer onto hex head bolt.
- Thread the splined shaft onto the hex head bolt.
- Slide the lever onto the splined shaft until it stops.
- Insert spring with screw into lever and tighten until screw head extends above the lever.

Figure 4

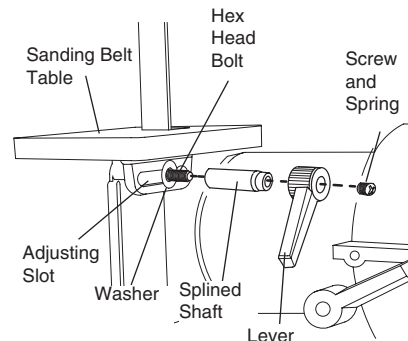

- Tighten set screw. Adjust table before tightening the set screw. See **Adjust Sanding Belt Table**.

Figure 5

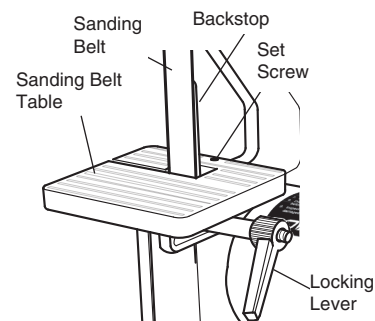

- Assemble the side belt guard and secure in place with the belt guard locking knob. (Figure 2)

To adjust sanding belt table:

WARNING

To prevent trapping the workpiece or fingers between the table and the sanding belt adjust the sanding belt table to a maximum of 1/16" from the backstop.

- Loosen the locking lever and set screw. Slide the sanding belt table in or out until it is 1/16" from the front of the sanding belt. See Figure 5.
- Place a combination square on the table with the ruler side against the back stop. Set the table 90° to the backstop.
- Tighten the locking lever.
- Tighten the set screw.
- For Bevel Sanding, loosen the locking lever and tilt the sanding belt table forward to desired position and tighten locking lever.

REPLACING THE SANDING BELT

Refer to Figure 6, 7

NOTE: This sander uses 1" x 30" sanding belts.

- Turn the machine "OFF", and disconnect the machine from the power source before assembling the sanding belt.
- Remove the belt guard locking knob and then remove the side belt guard. See Figure 6.
- Remove the spark guard. See figure 6

Figure 6

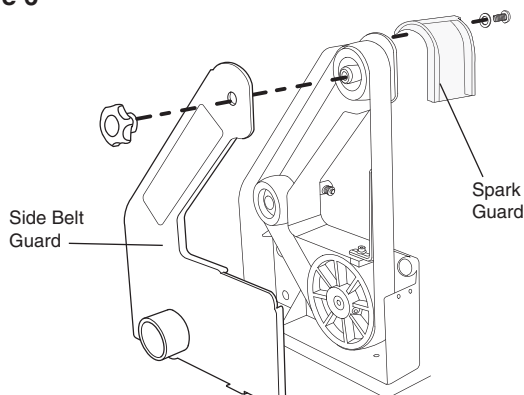

- Turn the belt tracking knob counter clockwise to loosen the belt tension and remove the old belt.
- Position the new belt on the wheels. Make sure the directional arrows on the belt point in the same direction as the arrows on the sander.

Figure 7

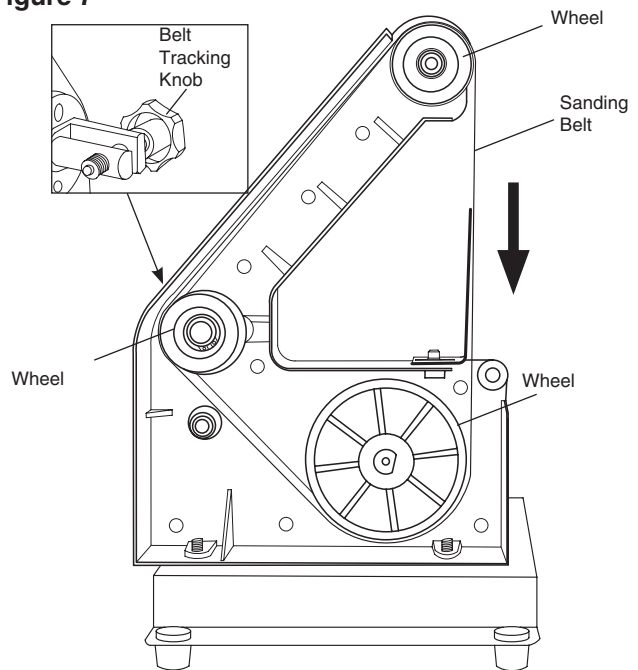

- Turn the belt tracking knob clockwise until the belt tracks to the center of the wheels.
- Replace the side guard and then spark guard.
- Ensure the sanding belt table measures a maximum of 1/16" from the backstop. To adjust see the **To Adjust Sanding Belt Table** paragraph in this section.

SANDING BELT TRACKING ADJUSTMENT

Refer to Figure 2, 7

- Turn the machine "OFF", and disconnect the machine from the power source.
- Remove the belt guard locking knob and then remove the sander's side belt guard. See Figure 2.
- Rotate the sanding belt by hand to check the belt tracking. The belt should track to the center of the wheels.
 - When looking at the front of the sander if the belt tracks to the left, turn the tracking knob counterclockwise until the belt tracks to the center of the wheels.
 - When looking at the front of the sander if the belt tracks to the right, turn the tracking knob clockwise until the belt tracks to the center of the wheels.
- Replace the side belt guards and secure in place with the belt guard locking knob.
- Plug the power cord into the correct receptacle. (Refer to **Power Source** paragraph in this section of the manual.)
- Turn the switch ON and OFF to make sure the belt is tracking at high speed; readjust with tracking knob if needed.

BACKSTOP

Refer to Figure 8

The backstop is a surface to sand against.

The backstop can be removed for polishing and contour sanding.

- Remove screws and washers securing backstop. Place screws, washers and backstop in a safe place for future use.

Figure 8

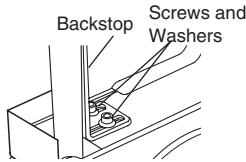

DUST PORT OPTIONS

The dust ports can be easily connected to a dust collection system with a large diameter shop vacuum hose.

Sanding operations are inherently dusty. This sander is equipped with a 1-3/4" OD belt dust port to help minimize the amount of dust escaping into the surrounding air. Attach the dust collection system vacuum hose to the dust chute. **NOTE:** The use of a dust collection system is strongly recommended when using the belt sander. Use of a mask or respirator is still recommended even when using a dust collection system.

MOUNTING THE SANDER TO WORK SURFACE

Refer to Figure 9



Properly mount the sander to a workbench or stand if during operation the sander has the tendency to tip over, slide or walk on the work surface.

- Remove the four rubber feet from the sander.
- Position the sander in place on the work surface. Mark the work surface using the holes in the sander base as a template. Remove the sander from the work surface.
- Drill holes in the work surface at the marks.
- Secure the sander to the work surface using long bolts, flat washers and hex nuts (not supplied) as shown.

NOTE: Bolts should be inserted from the top of the sander and secured underneath the work surface with flat washers, lock washers and hex nuts. A rubber washer should be placed between the sander and the workbench.

Figure 9

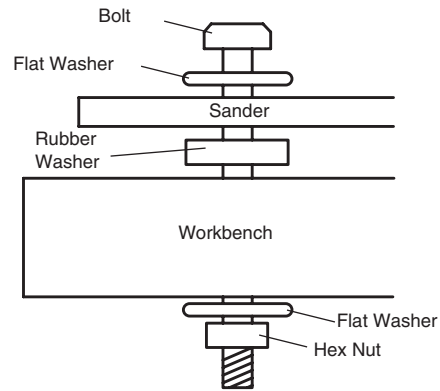

POWER SOURCE



Do not connect to the power source until the machine is completely assembled.

The machine is wired for 120 volts, 60 HZ alternating current. Before connecting the machine to the power source, make sure the switch is in the "OFF" position. Running the unit on voltages which are not within range may cause overheating and motor burn-out. Heavy loads require that voltage at motor terminals be no less than the voltage specified on nameplate.

GROUNDING INSTRUCTIONS



Improper connection of equipment grounding conductor can result in the risk of electrical shock.

- The machine should be grounded while in use to protect operator from electrical shock.
- In the event of an electrical short circuit, grounding reduces the risk of electrical shock by providing an escape wire for the electric current.
- This machine is equipped with an approved 3-conductor cord rated at 125V and a 3-prong grounding type plug for your protection against shock hazards.
- Grounding plug should be plugged directly into a properly installed and grounded 3-prong grounding-type receptacle, as shown (Figure 10).
- The plug must be plugged into an outlet that is properly installed and grounded in accordance with all local codes and ordinances.
- Check with a qualified electrician or service personnel if these instructions are not completely understood or if in doubt as to whether the tool is properly grounded.
- Do not modify plug provided. If it will not fit in outlet, have proper outlet installed by a qualified electrician. Use only 3-wire extension cords, that have 3-prong grounding type plugs and matching 3-conductor receptacles that accept the machine's plug, as shown in Figure 10.

Figure 10

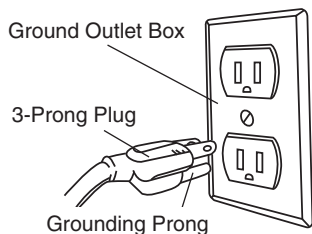

WARNING

Do not permit fingers to touch the terminals of plug when installing or removing from outlet.

- Inspect tool cords periodically, and if damaged, have repaired by an authorized service facility.
- The conductor with insulation having an outer surface that is green with or without yellow stripes is the equipment-grounding conductor. If repair or replacement of the electric cord or plug is necessary, do not connect the green (or green and yellow) wire to a live terminal.

A temporary 3-prong to 2-prong grounding adapter (see Figure 13) may be used to connect this plug to a matching 2-conductor receptacle as shown in Figure 11. The temporary adapter should be used only until a properly grounded outlet can be installed by a qualified electrician.

Figure 11

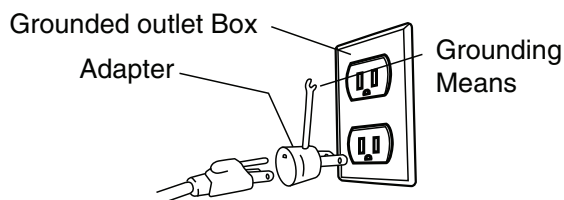

In Canada, the use of temporary adapter is not permitted by the Canadian Electric Code. Where permitted, the rigid green tab or terminal on the side of the adapter must be securely connected to a permanent electrical ground such as a properly grounded water pipe, a properly grounded outlet box or a properly grounded wire system.

- Many cover plate screws, water pipes and outlet boxes are not properly grounded. To ensure proper ground, grounding means must be tested by a qualified electrician.

EXTENSION CORDS

Use proper extension cords. Make sure the extension cord is in good condition. Use only 3-wire extension cords have 3-prong grounding type plugs and 3-pole receptacles which accept the tool plug. When using an extension cord, make sure to use one heavy enough to carry the current of the machine. An undersized cord will cause a drop in the voltage, resulting in loss of power and overheating. Use the table to determine the minimum wire size (A.W.G.) extension cord.

Extension Cord Length

Wire Size.....	A.W.G.
Up to 25 ft.....	16 gauge

NOTE: Using extension cords over 25 ft. long is not recommended.

MOTOR

The sander is equipped with a 3 Amps motor. The 120 Volt motor has the following specifications::

Horsepower	1/3
Voltage	120
Amp	3
Hertz	60
Phase	Single
RPM.....	3260

ELECTRICAL CONNECTIONS

- Turn the switch off and disconnect the machine from power source before performing any repair or maintenance work.
- Some electrical wiring and connection work must be performed by a qualified electrician in accordance with local regulations.
- Scheme of the motor and electric wiring inside this machine is shown in Figure 12.
- There is a green grounding wire fastened to the frame of the machine to provide Shock Protection. Do not disconnect the Grounding Wire from the frame.
- The Motor is rated for use at 120 Volts.
- Connect this machine to 3-Conductor Power outlet with appropriate rating only.
- Use only 3-pronged Extension Power Cord with appropriate rating with this machine.
- When changing the power cord, use only 3-pronged Power Cord with appropriate rating.

Figure 12

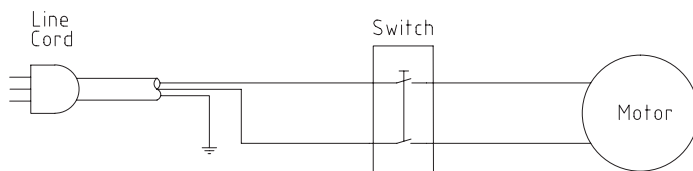



OPERATION

ON/OFF SWITCH

Refer to Figure 13

- To turn the sander ON, place the ON/OFF switch in the ON position.
- To turn the sander OFF, place the ON/OFF switch in the OFF position.

Figure 13

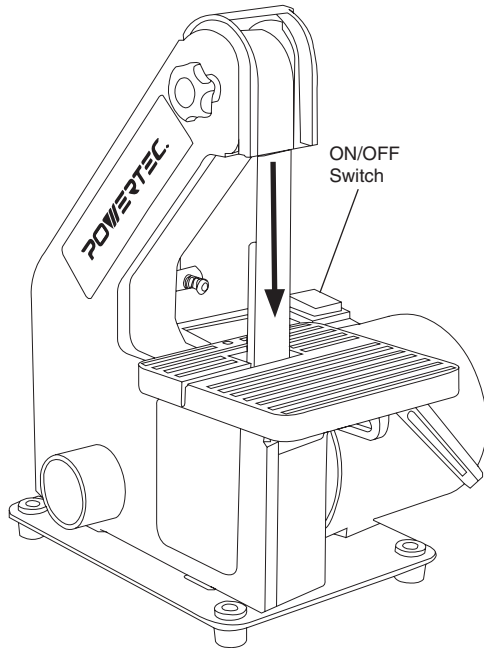

SURFACE SANDING ON SANDING BELT

Hold the workpiece firmly with both hands. Keep fingers away from sanding belt. Keep the workpiece end against the backstop and move it slowly across the sanding belt. Apply enough pressure to remove material; excessive pressure will reduce sanding efficiency.

END SANDING - BELT

Refer to Figure 13

Use end sanding when sanding the ends of small, narrow workpieces and outside curved edges.

CAUTION

To avoid personal injury and/or damage to the workpiece, become familiar with the rotation of the sanding belt.

The sanding belt rotates counterclockwise or downward toward the table or backstop.

CONTOUR SANDING WITH THE BELT

With the backstop removed the sanding belt conforms to a curved edge for sanding and polishing.

- Remove the backstop. See **Backstop** under **Assembly**.
- Turn the sander ON and slowly feed it into the sanding belt.



MAINTENANCE

WARNING

For your own safety, turn the switch OFF and remove the plug from the electrical outlet before adjusting or performing maintenance or lubrication work on the belt sander.

GENERAL MAINTENANCE

Before using, check to make sure parts are not damaged, missing, or worn; check for alignment of moving parts, binding of moving parts, improper mounting, or any other conditions that may affect the sander operation. Should any of these conditions exist, do not use the belt sander until properly repaired or parts are replaced. Frequently blow or vacuum dust from all sanding parts and motor housing.

WARNING

Any attempt to repair or replace electrical parts on this tool may be hazardous. Repairs should be done by a qualified service technician.

LUBRICATION

Ball bearings are grease packed at the factory and require no further lubrication. Use a spray lubricant on all moving table parts to ensure smooth operation.



TROUBLESHOOTING

SYMPTOM	POSSIBLE CAUSE(S)	CORRECTIVE ACTION
Sanding Grains easily rub off belt.	<ol style="list-style-type: none"> 1. Sanding belt has been stored in an incorrect environment. 2. Sanding belt has been damaged or folded. 	<ol style="list-style-type: none"> 1. Ensure sanding accessories are stored away from extremely hot or dry temperatures. 2. Store sanding accessories flat – not bent or folded.
Deep sanding grooves or scars in workpiece.	<ol style="list-style-type: none"> 1. Sanding belt grit is too coarse for the desired finish. 2. Workpiece sanded across the grain. 3. Too much sanding force on the workpiece. 4. Workpiece held still against the belt for too long. 	<ol style="list-style-type: none"> 1. Use a finer-grit sanding accessory. 2. Sand with the grain of the wood. 3. Reduce pressure on workpiece while sanding. 4. Keep workpiece moving while sanding on the sanding accessory.
Sanding surface clogs quickly.	<ol style="list-style-type: none"> 1. Too much pressure against belt/disc. 2. Sanding softwood. 	<ol style="list-style-type: none"> 1. Reduce pressure on workpiece while sanding. 2. Use different stock, different sanding accessories, or accept that this will happen and plan on cleaning or replacing discs/belts frequently.
Burns on workpiece.	<ol style="list-style-type: none"> 1. Using a sanding grit that is too fine. 2. Using too much pressure. 3. Work held still for too long. 	<ol style="list-style-type: none"> 1. Use a coarser-grit sanding accessory. 2. Reduce pressure on workpiece while sanding. 3. Do not keep workpiece in one place for too long.
Motor will not start – fuses or circuit breakers tripping or blowing.	<ol style="list-style-type: none"> 1. Short circuit in line, cord or plug. 2. Short circuit in motor or loose connections. 3. Incorrect fuses or circuit breakers in power line. 	<ol style="list-style-type: none"> 1. Inspect cord or plug for damaged insulation and shorted wires. 2. Inspect all connections on motor for loose or shorted terminals and/or worn insulation. 3. Install correct fuses or circuit breakers or switch tool to an appropriately size circuit.
Motor overheats.	<ol style="list-style-type: none"> 1. Motor overloaded. 2. Extension cord too long and of insufficient gauge (weight). 	<ol style="list-style-type: none"> 1. Reduce load on motor (pressure on object being sanded). 2. Utilize an extension cord of appropriate gauge and length or plug tool directly into outlet.
Motor stalls (resulting in blown fuses or tripped circuit).	<ol style="list-style-type: none"> 1. Short circuit in motor or loose connections. 2. Low voltage. 3. Incorrect fuses or circuit breakers in power line. 4. Motor overload. 	<ol style="list-style-type: none"> 1. Inspect connections on motor for loose or shorted terminals or worn insulations. 2. Correct low voltage conditions (for example: improper extension cord length and/or gauge). 3. Install CORRECT fuses or circuit breakers or plug tool into an appropriate circuit, matched to an appropriate fuse or breaker. 4. Reduce the load on the motor.
Machine slows when operating.	<ol style="list-style-type: none"> 1. Feed rate too great. 2. Undersized circuit or use of undersized extension cord. 	<ol style="list-style-type: none"> 1. Reduce the rate at which the workpiece is fed into the working area of the tool. 2. Ensure circuit wires or extension cords are proper gauge, or eliminate use of extension cords.
Machine vibrates excessively.	<ol style="list-style-type: none"> 1. Rubber feet worn, mounting hardware loose 2. Workbench or table is not level 3. Worn bearings 	<ol style="list-style-type: none"> 1. Replace the rubber feet, tighten mounting hardware 2. Shim or adjust as need 3. Have bearings replaced by service technician.
Workpiece frequently gets pulled out of operator's hands.	<ol style="list-style-type: none"> 1. Not supporting the workpiece against the stop. 2. Attempting to sand (unaided) a workpiece that is too small. 	<ol style="list-style-type: none"> 1. Use the platen (backstop) to support the workpiece. 2. Use another hand tool or jig to grasp or hold the workpiece.



1 x 30" BELT SANDER PARTS ILLUSTRATION

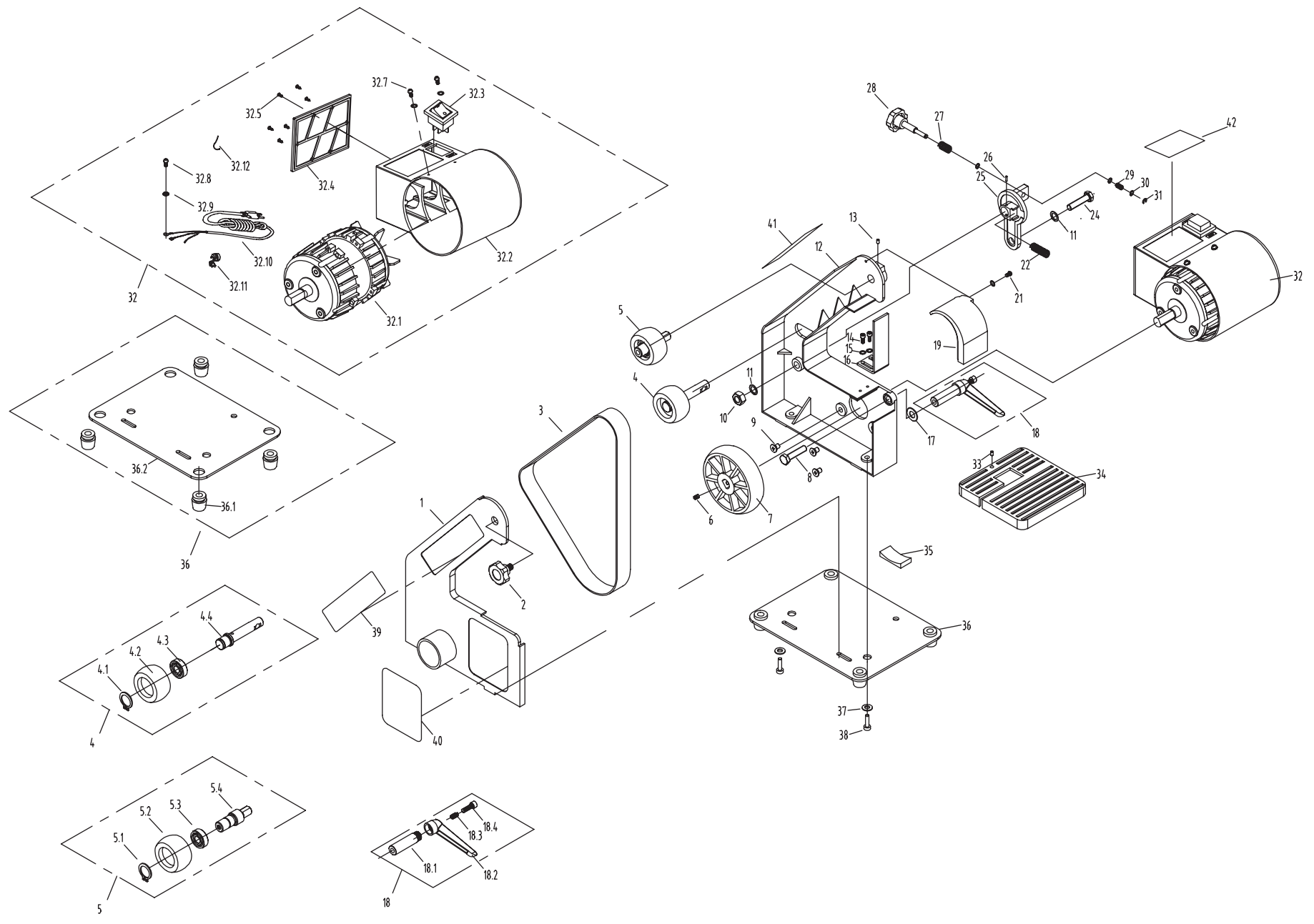

1" x 30" BELT SANDER PARTS LIST



Key#	Part#	Description	Specification	Key#	Part#	Description	Specification
1	BD1030001	Side Cover		25	BD1030025	Axle Seat	
2	BD1030002	Cover Knob		26	BD1030026	Spring Pin	φ3X18
3	BD1030003	Sanding Belt	25.4*762mm/80#	27	BD1030027	Spring	
4	BD1030004	Rear Driven Wheel		28	BD1030028	Tension Handle	
4.1	BD1030004.1	C-Ring	φ15	29	BD1030029	Spring	
4.2	BD1030004.2	Pulley		30	BD1030030	Washer	φ5
4.3	BD1030004.3	Bearing	6202-2Z	31	BD1030031	Lock E-Ring	φ4
4.4	BD1030004.4	Tension Axle		32	BD1030032	Motor Assembly	
5	BD1030005	Rear Driven Wheel		32.1	BD1030032.1	Motor	1/3HP-3450RPM
5.1	BD1030005.1	C-Ring	φ15	32.2	BD1030032.2	Motor Cover	
5.2	BD1030005.2	Pulley		32.3	BD1030032.3	Switch	K2-2-2112A (12A,125V)
5.3	BD1030005.3	Bearing	6202-2Z	32.4	BD1030032.4	Cover	
5.4	BD1030005.4	Pulley Axle		32.5	BD1030032.5	Screw	ST2.9x9.5
6	BD1030006	Set Screw	M6X10	32.6	BD1030032.6	Washer	φ4
7	BD1030007	Motor Pulley		32.7	BD1030032.7	Screw	M4X10
8	BD1030008	Bolt	M8X25	32.8	BD1030032.8	Screw	M5X8
9	BD1030009	Screw	M6X12	32.9	BD1030032.9	Washer	φ5
10	BD1030010	Nut	M10	32.10	BD1030032.10	Power Cord	18AWG/3CX2m
11	BD1030011	Washer	φ10	32.11	BD1030032.11	Bushing	6P-4
12	BD1030012	Frame		32.12	BD1030032.12		2.5X100(ROHS)
13	BD1030013	Set Screw	M6X8	33	BD1030033	Set Screw	M6X16
14	BD1030014	Bolt	M4X10	34	BD1030034	Table	
15	BD1030015	Washer	φ4	35	BD1030035	Cushion	
16	BD1030016	Belt Support		36	BD1030036	Base Assembly	
17	BD1030017	Washer	φ8×φ18×2t	36.1	BD1030036.1	Rubber Feet	
18	BD1030018	Locking Handle Assembly		36.2	BD1030036.2	Base	
18.1	BD1030018.1	Locking Stud		37	BD1030037	Washer	φ8×φ14×1.5t
18.2	BD1030018.2	Locking Handle		38	BD1030038	Bolt	M8X12
18.3	BD1030018.3	Spring		39	BD1030039	Brand Label	146X32
18.4	BD1030018.4	Screw		40	BD1030040	Warning Label	92X45
19	BD1030019	Spark Shield		41	BD1030041	Directional Arrow Label	40X10
20	BD1030020	Washer	φ4	42	BD1030042	Motor Label	69X45
21	BD1030021	Screw	M4X10				
22	BD1030022	Spring					
23	BD1030023	Washer	φ10				
24	BD1030024	Bolt	M10X30				





Thank you for investing in a **POWERTEC** power tool. This product has been designed and manufactured to meet high quality standards and is guaranteed for domestic use against defects in workmanship or material for a period of 12 months from the date of purchase. This guarantee does not affect your statutory rights.

SOUTHERN TECHNOLOGIES LLC. BENCH TOP AND STATIONARY POWER TOOL LIMITED 1 YEAR WARRANTY AND 30-DAY SATISFACTION GUARANTEE POLICY

POWERTEC products are designed and manufactured by **Southern Technologies LLC**. All warranty communications should be directed to **Southern Technologies LLC** by calling 847-780-6120, 9 AM to 5 PM, Monday through Friday, US Central Time.

30- DAY SATISFACTION GUARANTEE POLICY

During the first 30 days after the date of purchase, if you are dissatisfied with the performance of this **POWERTEC** tool for any reason, you may return the tool to the retailer from which it was purchased for a full refund or exchange. You must present proof of purchase and return all original equipment packaged with the original product. The replacement tool will be covered by the limited warranty for the balance of the one year warranty period.

LIMITED ONE YEAR WARRANTY

This warranty covers all defects in workmanship or materials in this **POWERTEC** tool for a one year period from the date of purchase. This warranty is specific to this tool. **Southern Technologies, LLC** reserves the right to repair or replace the defective tool, at its discretion.

HOW TO OBTAIN SERVICE

To obtain service for this **POWERTEC** tool you must return it, freight prepaid, to **POWERTEC**. You may call 847-780-6120 for more information. When requesting warranty service, you must present the proof of purchase documentation, which includes a date of purchase. **POWERTEC** will either repair or replace any defective part, at our option at no charge to you. The repaired or replacement unit will be covered by the same limited warranty for the balance of one year warranty period.

WHAT IS NOT COVERED

This warranty applies to the original purchaser at retailer and may not be transferred.

This warranty does not cover consumable items such as saw blades, knives, belts, discs, cooling blocks and sleeves. This warranty does not cover required service and part replacement resulting from normal wear and tear, including accessory wear.

This warranty does not cover any malfunction, failure or defect resulting from:

- 1) misuse, abuse, neglect and mishandling not in accordance with the owner's manual.
- 2) damage due to accidents, natural disasters, power outage, or power overload.
- 3) commercial or rental use.
- 4) alteration, modification or repair performed by persons not recommended by **POWERTEC**.

DISCLAIMER

To the extent permitted by applicable law, all implied warranties, including warranties of MERCHANTABILITY or FITNESS FOR A PARTICULAR PURPOSE, are disclaimed. Any implied warranties, that cannot be disclaimed under state law are limited to one year from the date of purchase. **Southern Technologies LLC**. is not responsible for direct, indirect, incidental or consequential damages. Some states do not allow limitations on how long an implied warranty lasts and/or do not allow the exclusion or limitation of incidental or consequential damages, so the above limitations may not apply to you. This warranty gives you specific legal rights, and you may also have other rights which vary from state to state. **Southern Technologies LLC.**, makes no warranties, representations, or promises as to the quality or performance of its power tools other than those specifically stated in this warranty.

NOTE

NOTE

NOTE

POWERTEC[®]

Southern Technologies, LLC
3816 Hawthron CT,
Waukegan, IL 60087