



Wood Components (Not to Scale)



E1 | FORT UPRIGHT - W4L13102
(1) 1 3/8"x3 3/8"x89 1/2" (36x86x2273)



E2 | FORT UPRIGHT - W4L13103
(1) 1 3/8"x3 3/8"x89 1/2" (36x86x2273)



E3 | FORT UPRIGHT - W2A03016
(1) 1 7/16"x3 3/8"x89 1/2" (36x86x2273)



E4 | FORT UPRIGHT - W4L13526
(1) 1 3/8"x3 3/8"x89 1/2" (36x86x2273)



E77 | ANGLE BRACE - W4L13104
(2) 1 3/8"x3 3/8"x73 1/4" (36x86x1862)



F1 | ANGLE BRACE - W4L13105
(2) 1 3/8"x2 3/8"x18 1/8" (36x60x460)



F2 | ANGLE BRACE - W4L13106
(2) 1 3/8"x2 3/8"x12 1/4" (36x60x310)

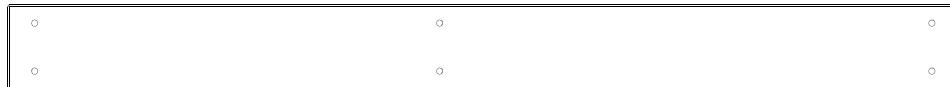

G1 | GROUND BOARD - W4L13107
(2) 1"x5 1/4"x59 1/2" (24x134x1511)



G2 | SWING BEAM SUPPORT - W4L13108
(1) 1"x5 1/4"x34 1/8" (24x134x868)

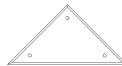

G3 | PICNIC SUPPORT - W4L13109
(2) 1"x5 1/4"x5 1/4" (24x134x134)



H1 | ROOF CROSS BRACE - W4L13110
(2) 1"x3 3/8"x53 7/8" (24x86x1368)



H2 | FLOOR JOIST - W4L13111
(3) 1"x3 3/8"x34 1/8" (24x86x868)



Wood Components (Not to Scale)



H4 | FLOOR BRACE - W4L13112
(1) 1"x3 3/8"x34 1/8" (24x86x868)



H5 | PICNIC TARP SUPPORT - W4L13113
(2) 1"x3 3/8"x24 1/2" (24x86x622)



H6 | WALL SLAT - W4L13114
(2) 1"x3 3/8"x25 1/2" (24x86x648)

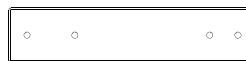

H7 | PICNIC SUPPORT - W4L13115
(2) 1"x3 3/8"x15 1/4" (24x86x387)



H8 | PICNIC SUPPORT - W4L13116
(2) 1"x3 3/8"x13 1/2" (24x86x344)



H9 | PICNIC SUPPORT - W4L13117
(2) 1"x3 3/8"x6 3/4" (24x86x172)



H10 | FLOOR BRACE - W4L13118
(4) 1"x3 3/8"x3 3/8" (24x86x86)



H11 | FLOOR JOIST - W4L13527
(1) 1"x3 3/8"x34 1/8" (24x86x868)



H73 | ROCK WALL RAIL - W4L13119
(2) 1"x3 3/8"x48 3/4" (24x86x1238)



H79 | END SUPPORT - W4L13120
(1) 1"x3 1/2"x42" (24x86x1072)



H80 | GROUND BOARD - W4L13121
(1) 1"x3 3/8"x87 3/8" (24x86x2218)



J1 | WALL SLAT - W4L13122
(2) 1"x2 3/8"x25 1/2" (24x60x648)



Wood Components (Not to Scale)



K1 | WALL RAIL - W4L13123
(3) 5/8"x5 1/4"x34 7/8" (16x134x887)

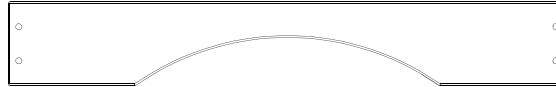

K2 | ARCHED WALL RAIL - W4L13124
(1) 5/8"x5 1/4"x34 7/8" (16x134x887)

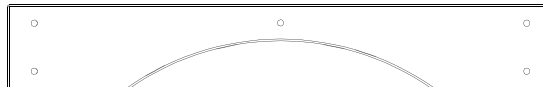

K3 | ARCHED WALL RAIL - W4L13125
(1) 5/8"x5 1/4"x34 1/8" (16x134x868)



K4 | WALL RAIL - W4L13126
(1) 5/8"x5 1/4"x34 1/8" (16x134x868)

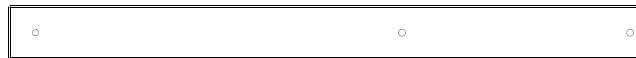

M1 | TARP SUPPORT - W4L13127
(2) 5/8"x3 3/8"x40" (16x86x1016)



M2 | FLOOR BOARD - W4L13128
(13) 5/8"x3 3/8"x36 3/4" (16x86x935)

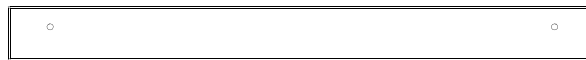

M3 | TARP SUPPORT - W4L13129
(3) 5/8"x3 3/8"x36 3/4" (16x86x935)



M4 | FLOOR/TARP SUPPORT - W4L13130
(1) 5/8"x3 3/8"x34 7/8" (16x86x887)



M5 | WALL RAIL - W4L13131
(1) 5/8"x3 3/8"x34 7/8" (16x86x887)



M6 | WALL RAIL - W4L13132
(1) 5/8"x3 3/8"x34 7/8" (16x86x887)



M7 | FLOOR BOARD - W4L13133
(2) 5/8"x3 3/8"x32 1/8" (16x86x815)



Wood Components (Not to Scale)



M8 | PICNIC CLEAT - W4L13134
(1) | 5/8"x3 3/8"x10 1/8" (16x86x258)



M9 | PICNIC CLEAT - W4L13135
(1) | 5/8"x3 3/8"x6 3/4" (16x86x172)



M10 | WALL RAIL - W4L13136
(2) | 5/8"x3 3/8"x6 1/4" (16x86x160)



M11 | WALL RAIL - W4L13137
(2) | 5/8"x3 3/8"x4 3/4" (16x86x122)



M12 | WALL SLAT - W4L13138
(9) | 5/8"x3 3/8"x25 1/4" (16x86x640)



M13 | WALL RAIL - W4L13139
(1) | 5/8"x3 3/8"x34 7/8" (16x86x887)



M14 | FLOOR/TARP SUPPORT - W4L13528
(1) | 5/8"x3 3/8"x34 7/8" (16x86x887)



M71 | ROCK BOARD - W4L13140
(6) | 5/8"x3 3/8"x20 1/4" (16x86x514)



M72 | ROCK WALL SLAT - W4L13421
(2) | 5/8"x3 3/8"x20 1/4" (16x86x514)

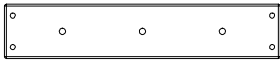

M77 | SLIDE BRACE - W4L08748
(1) | 5/8"x3 3/8"x17 1/4" (16x86x438)



M78 | CENTER SLIDE BRACE - W4L08749
(2) | 5/8"x3 3/8"x17 1/4" (16x86x438)



N1 | WALL RAIL - W4L13422
(1) | 5/8"x1 1/8"x34 1/8" (16x30x868)



SB74 | SWING BEAM - W4L13423
(1) | 2"x5 1/4"x89 1/2" (50x134x2274)



W71 | SWING BEAM SUPPORT - W4L13424
(1) | 2"x3 3/8"x46 1/8" (50x86x1170)



Hardware Components

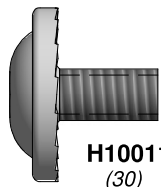

H100115 | BOLT WH
(30) | 5/16x1/2

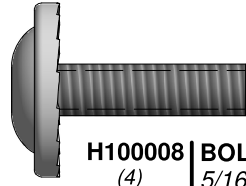

H100008 | BOLT WH
(4) | 5/16x1

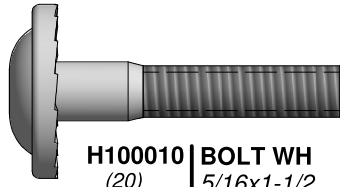

H100010 | BOLT WH
(20) | 5/16x1-1/2

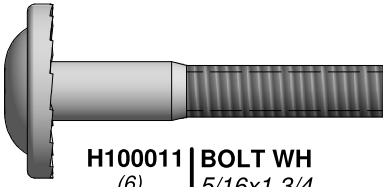

H100011 | BOLT WH
(6) | 5/16x1 3/4

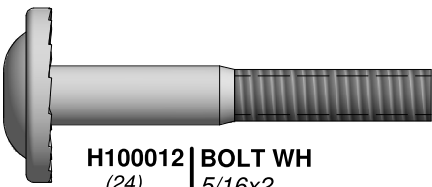

H100012 | BOLT WH
(24) | 5/16x2

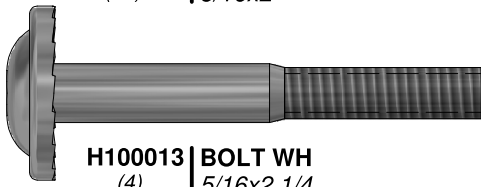

H100013 | BOLT WH
(4) | 5/16x2 1/4

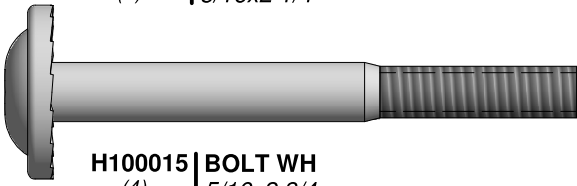

H100015 | BOLT WH
(4) | 5/16x2 3/4

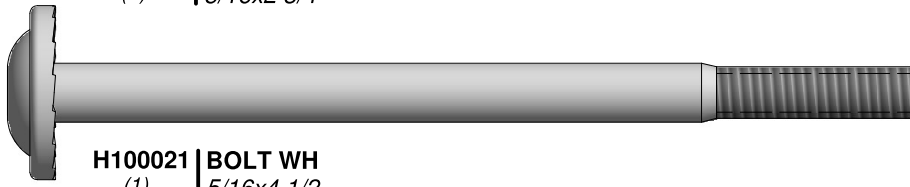

H100021 | BOLT WH
(1) | 5/16x4 1/2



H100047 | BOLT HEX
(2) | 5/16x2 3/4



H100027 | LAG SCREW WH
(40) | 5/16x2

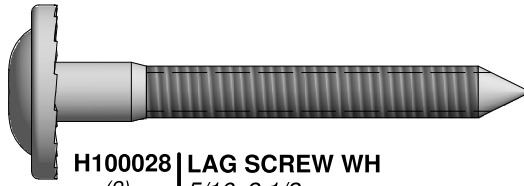

H100028 | LAG SCREW WH
(2) | 5/16x2 1/2

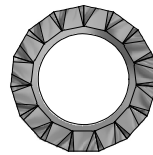

H100031 | WASHER LOCK EXT
(74) | 12x19

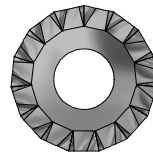

H100030 | WASHER LOCK EXT
(99) | 8x19



H100001 | BOLT FA
(7) | 3/8x1 1/2

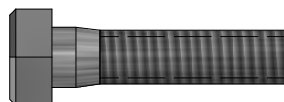

H100042 | BOLT HEX
(4) | 5/16x1 1/4

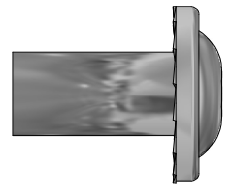

H100005 | NUT BARREL WH
(64) | 5/16x7/8

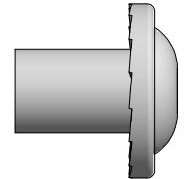

H100004 | NUT BARREL WH
(4) | 5/16 x 5/8

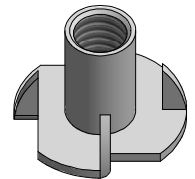

H100074 | T-NUT
(24) | 5/16

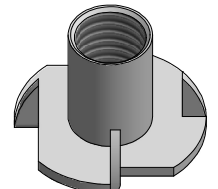

H100073 | T-NUT
(7) | 3/8



H100128 | SCREW PWH
(19) | 8x5/8



Hardware Components



H100088 | SCREW PFH
(48) | 8x1 1/8



H100087 | SCREW PFH
(30) | 8x1 1/4



H100086 | SCREW PFH
(56) | 8x1 1/2



H100089 | SCREW PFH
(9) | 8x1 3/4



H100111 | SCREW PFH
(64) | 8x2



H100090 | SCREW PFH
(30) | 8x2 1/2"

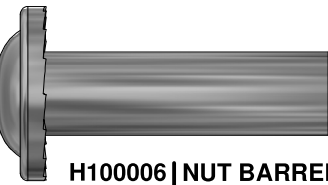

H100006 | NUT BARREL WH
(4) | 5/16x1 1/2

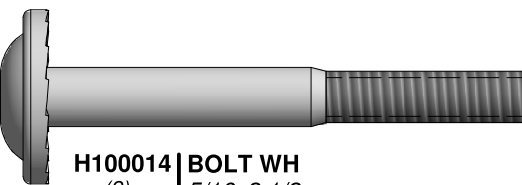

H100014 | BOLT WH
(2) | 5/16x2 1/2



H100062 | BOLT PTH
(4) | 1/4x1 1/4

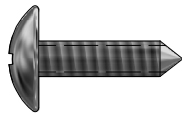

H100083 | SCREW TAPPING
(9) | 14x3/4



H100072 | T-NUT
(4) | 1/4

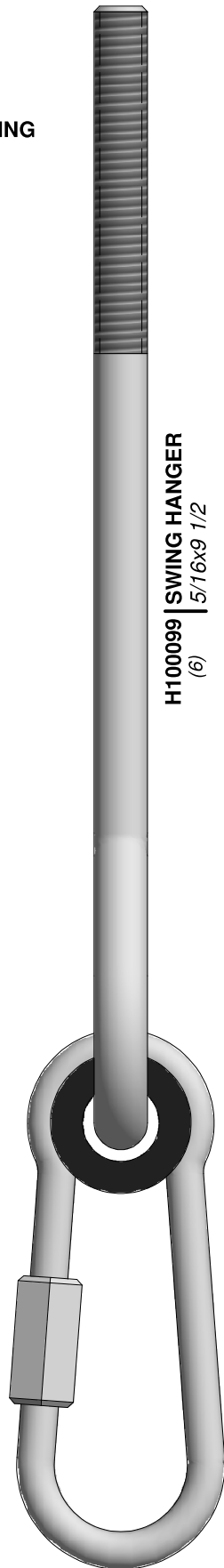

H100099 | SWING HANGER
(6) | 5/16x9 1/2

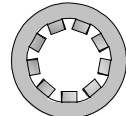

H100108 | WASHER LOCK INT
(4) | 8x15

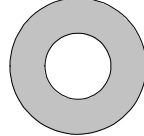

H100106 | WASHER FLAT
(4) | 9x18

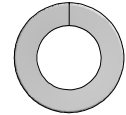

H100095 | WASHER SPLIT
(4) | 5/16

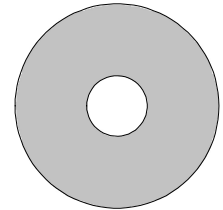

H100105 | WASHER FLAT
(15) | 8x27

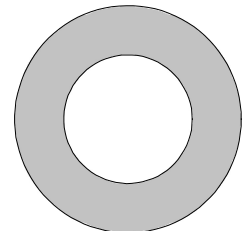

H100103 | WASHER SAFETY
(7) | 17x30

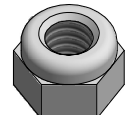

H100110 | NUT LOCK
(9) | 5/16



Accessory Components (Not to Scale)



A100054 | SLIDE RAIL 8' GREEN RIGHT
(1)



A100055 | SLIDE RAIL 8' GREEN LEFT
(1)



A6P00386 | SLIDE BED 8' DARK GREEN
(1)

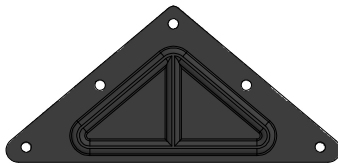

A100294 | TRIANGLE PLATE 100° 5 HOLE
(2)

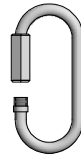

A100069 | QUICK LINK
(6)



A100028 | HAND GRIP GREEN PLASTIC
(2)



A100164 | BYD ID TAG (LARGE) AGES 3-10
(1)

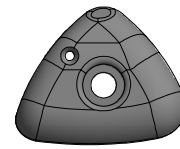

A100060 | CLIMBING ROCK GREEN SMALL
(6)



A100314 | "A" REVISION TAG
(1)

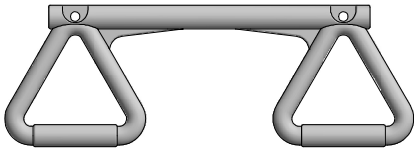

A6P00034 | TRAPEZE YELLOW
(1)

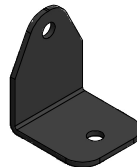

A100053 | L BRACKET 54x67 - GRN
(4)



A4M01046 | L BRACKET 2.5x38x55x55
(8)



A6P00054 | SWING SEAT GREEN 22IN
(2)

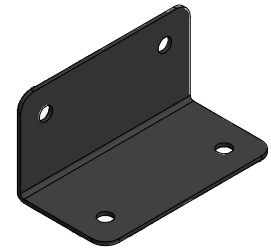

A100140 | L BRACKET 66x66x127
(2)



A100083 | ROPE-CHAIN GREEN 33"
(2)



A100087 | ROPE-CHAIN GREEN 51.25"
(4)



Accessory Components (Not to Scale)

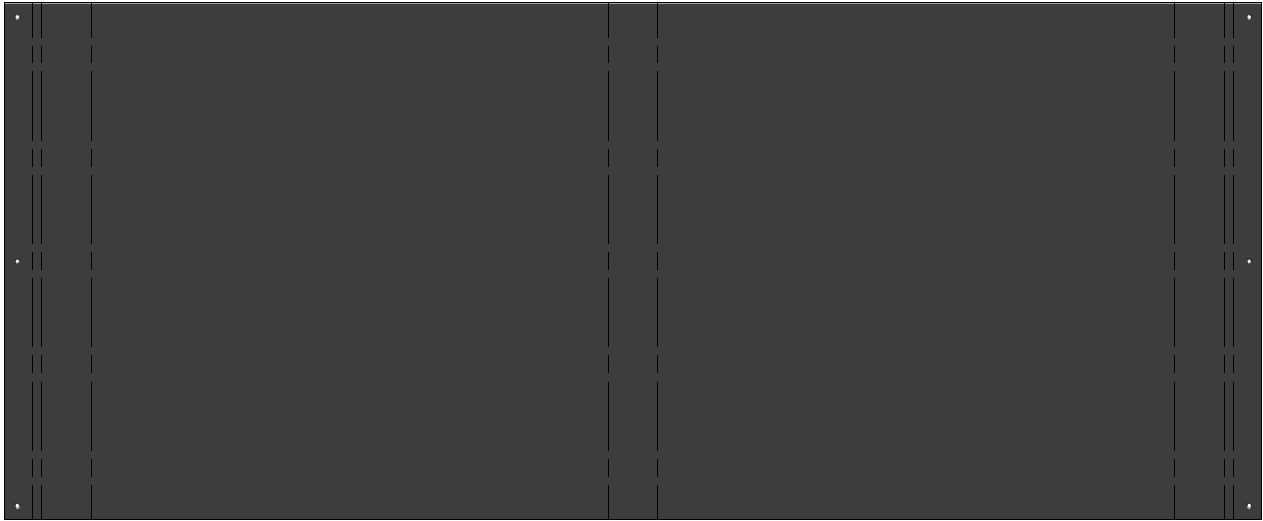

A6P00382 | ROOF TARP
(1)

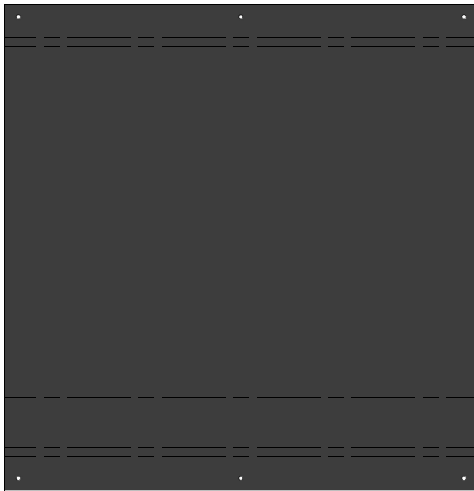

A6P00383 | PICNIC TABLE TARP
(1)



A100042 | T-40 TORX BIT
(2)

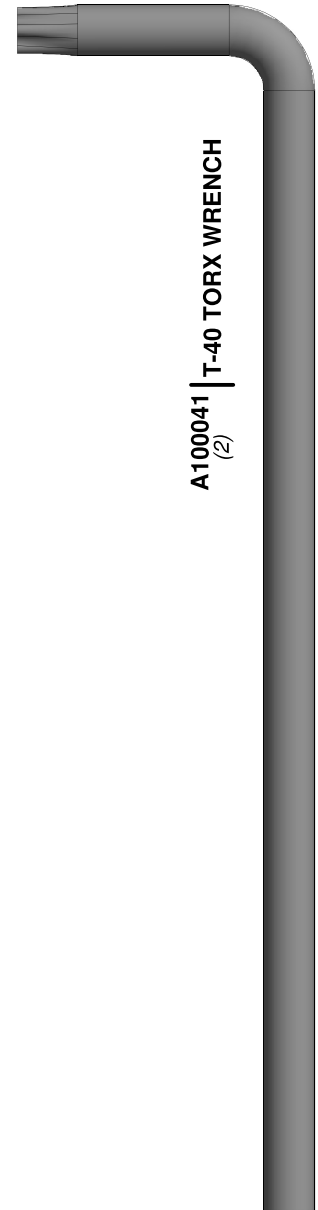

A100041 | T-40 TORX WRENCH
(2)



A4M00527 | GROUND STAKE REBAR
(6)