

21SV23107 BUBBLE FOGGER MACHINE

USER MANUAL

1005390722



FOR INDOOR USE ONLY

DON'T USE IT AS A TOY

READ AND SAVE THESE INSTRUCTIONS FOR FUTURE REFERENCE

IMPORTANT TIPS:

- * Ensure that the bubble liquid and fog liquid are poured into the correct corresponding container according to Step 2 below. Always make sure there is enough bubble liquid and fog liquid in the tank before using the Bubble Fogger.
- * Do not remove the drainage caps (J) & (R) when there is liquid in the container unless you intend to drain the item of its contents. Drain over a trash bin or empty container.
- * Make sure that the end of the (H) Tube touches the bottom of the bubble liquid container and that there is no blockage.
- * The Bubble Fogger needs time to warm up before it can produce fog. This may take 2-4 minutes. The Bubble Fogger will be ready to produce fog when the (D) Status Indicator light turns red. When filled to the max fill line, the Bubble Fogger will run for approximately 70 minutes before running out of fog liquid. Refill when fog liquid has been depleted.
- * When the Bubble Machine has preheated (Status Indicator light turns red), turn on the (L) Function Switch to produce fog bubble
- * When the Bubble Machine Status Indicator light turns blue, the Bubble Machine needs more fog liquid.
- * The machine will keep blowing fog bubbles for about 40 seconds and then stop for about 20 seconds before resuming.
- * If you have any broken or missing parts, please contact SVI customer service from 8:30am to 5:30pm PST at 1-855-428-3921, email customerservice@svious.com, or call The Home Depot customer service at 1-877-527-0313 before returning to the store.

DESCRIPTION OF THE APPLIANCE

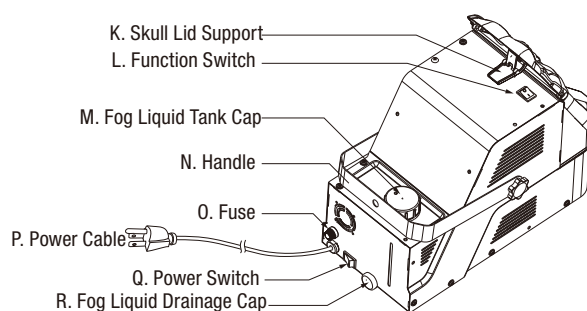
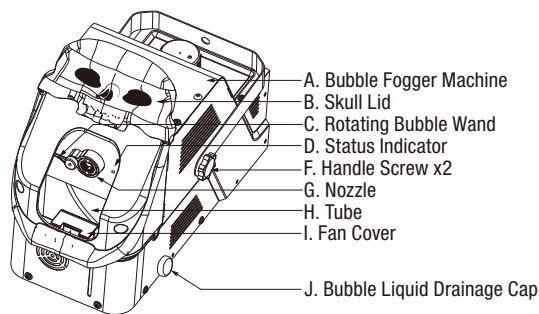

INSTRUCTION

1. Pull the (B) Skull Lid up and Support as shown. Secure the (N) Handle to the (A) Bubble Fogger Machine using the (F) Handle Screws.

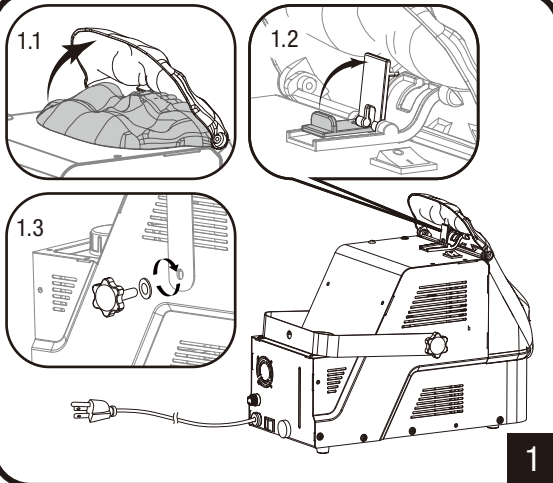

2. Fill the bubble tank and fog liquid tank up to their max fill lines. The fan cover will open automatically when the bubble fogger machine is running normally. Do not pour liquid into the air outlet.

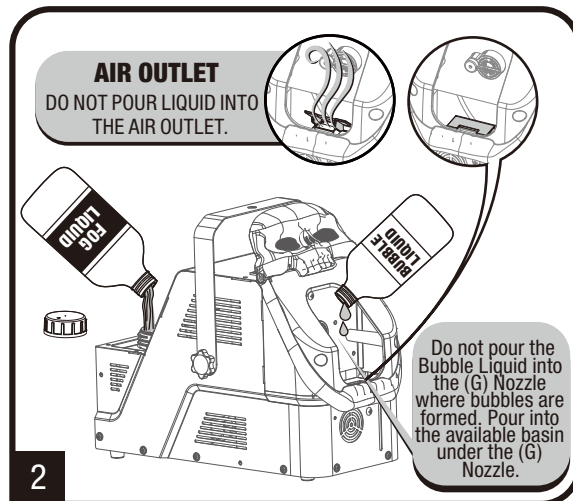

3. Plug the (A) Bubble Fogger Machine into an outlet, toggle the (Q) Power Switch behind the machine to the "I" position. The (D) Status Indicator will turn red after the machine heats up for 2-4 minutes. Then toggle the (L) Function Switch under the (B) Skull Lid to "I" to activate the fog bubbles.

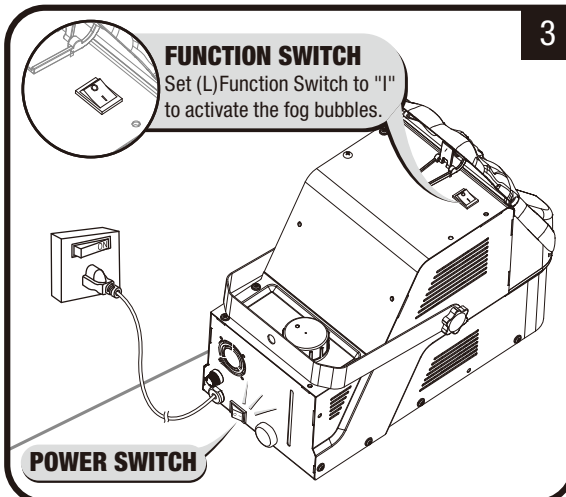

4. There will not be any fog bubbles within the first 20 seconds as the machine needs time to pump the bubble liquid from the tank to the nozzle. After the first 20 seconds, the machine will start blowing fog bubbles for about 40 seconds and then stop for about 20 seconds before resuming.

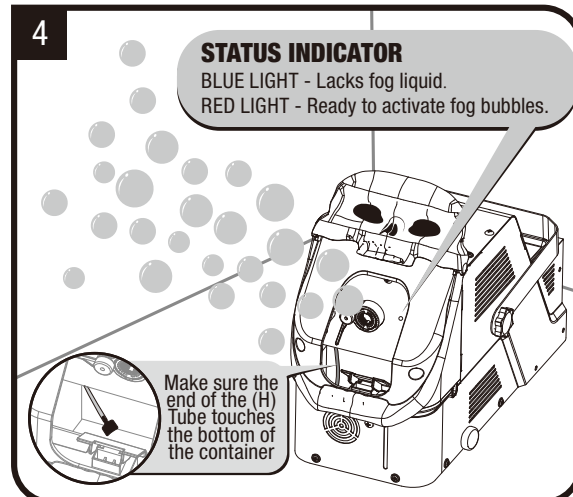

NOTE

This device complies with Part 15 of the FCC Rules. Operation is subject to the following two conditions: (1) this device may not cause harmful interference, and (2) this device must accept any interference received, including interference that may cause undesired operation.

Warning: Changes or modifications to this unit not expressly approved by the party responsible for compliance could void the user's authority to operate the equipment. This equipment has been tested and found to comply with the limits for a Class B digital device, pursuant to Part 15 of the FCC Rules. These limits are designed to provide reasonable protection against harmful interference in a residential installation. This equipment generates, uses and can radiate radio frequency energy and, if not installed and used in accordance with the instructions, may cause harmful interference to radio communications. However, there is no guarantee that interference will not occur in a particular installation. If this equipment does cause harmful interference to radio or television reception, which can be determined by turning the equipment off and on, the user is encouraged to try to correct the interference by one or more of the following measures:

- Reorient or relocate the receiving antenna.
- Increase the separation between the equipment and receiver.
- Connect the equipment into an outlet on a circuit different from that to which the receiver is connected.
- Consult the dealer or an experienced radio/TV technician for help.

WARNING

To prevent risk of personal injury, fire, and electric shock:

- Never leave unit unattended while plugged in. Unplug when not in use or refilling.
- Connect only to a properly grounded outlet.
- Place product on a flat, level HARD surface and connect the cord to prevent the product from overturning.
- For use only in covered areas. Keep unit dry, do not expose to rain or moisture.
- Leave enough space for good ventilation. Keep unit cool and away from other objects.
- Use only with Home Accents Holiday Fog Liquid / Bubble Liquid (sold separately).
- Do not operate unit without Home Accents Holiday Fog Liquid / Bubble Liquid.
- Pour Home Accents Holiday Fog Liquid / Bubble Liquid carefully to avoid spills which could result in electric shock. Do not use if liquid spills onto unit. Let unit dry completely before plugging in.
- Do not overfill the liquid.
- Keep away from flames and flammable/explosive substances to avoid fire or explosions. Never pour flammable liquids such as gas, perfume etc. into the fog machine.
- Keep product and Home Accents Holiday Fog Liquid / Bubble Liquid out of reach of children. Use only under adult supervision.
- Do not spray in the direction of flames or people. Stay at least 20 inches (50cm) from the nozzle at the front of the unit.
- Do not obstruct the nozzle.
- Do not open unit. No user serviceable parts inside, please refer to your vendor. Only an electrician can change the power cord.
- Clean unit before storage to avoid damages.

CAUTION

- Risk of burn, fire or electric shock.
- Please read instruction manual before using.
- Don't immerse in liquid.
- Not for space heating purposes.
- Changes or modifications not expressly approved by the party responsible for compliance could void user's authority to operate the equipment.

FUSE REPLACEMENT

If the Bubble Fogger does not work at all when it is connected to the power socket, then it is probably that the fuse has been broken.

- Risk of electric shock and fire. Disconnect from power socket before replacing the fuse.
- Turn the fuse knob counterclockwise to reveal the fuse.
- Replace the fuse with the same size and type fuse: 5A, 125V
- Place fuse in cover and reinstall by turning clockwise. Be sure not to over tighten.

ADDITIONAL INFORMATION

- (a) It is normal for condensation to appear on the nozzle of the Bubble Fogger.
(b) A small amount of fog may spray during or after operation.

MAINTENANCE & SERVICING

Use of fog liquids other than Home Accents Holiday Fog Liquid are not recommended and may result in blockage, leakage, or other damage to the unit.

INSPECTION

Before each use, check unit for any cracks in the enclosure, cords, and plugs. Make sure there are no exposed wires. Do not use if any of the above conditions are found.

CLEANING

Please pay attention to cleaning after you use it. Follow the cleaning procedure as below.

1. Discharge all the bubble and fog liquid through the two different drainage outlets.
2. Close the outlets and pour 300ml distilled water into each liquid tank.
3. Turn on the power to heat the machine with function switch on and let it work for 5 to 10 minutes.
4. Turn off the machine and discharge the distilled water.

STORAGE

It is important to remove all fluid from the unit when storing for an extended period of time.

1. When the unit is unplugged and cool, empty all Home Accents Holiday Liquid from the machine. Plug in unit and allow to warm as usual.
2. Before storage, it is recommended to follow the CLEANING procedure available in this instruction sheet.
3. Run unit in a well-ventilated area for 10-seconds to confirm tank is empty and dry.
4. Store on a flat, level surface. Keep in a well-ventilated, cool and dry location.

For best performance, operate unit for 10-minutes every 3 months. Follow the Operation Instructions and Storage instructions accordingly.

TROUBLESHOOTING

Issue	Correction
Bubble Fogger Machine will not produce Bubble / fog	<ul style="list-style-type: none">· Ensure there is sufficient fog liquid and bubble liquid in the tank.· Ensure the machine is plugged into a working outlet.· Ensure the machine has been given 2-4 minutes to heat up.· Ensure the fuse is not blown. First disconnect the fog machine from the power source, then unscrew the fuse knob to reveal the fuse. If the fuse looks damaged or burnt, replace the fuse with the same size and type (5A, 125V). Place fuse in cover and reinstall by turning clockwise. Be sure not to overtighten.· Make sure the (L) Function Switch and (Q) Power Switch buttons are on the "I" position.· If only smoke, no bubbles:<ol style="list-style-type: none">1. Please check whether or not there's enough bubble liquid in the container2. Check whether the (H) Tube is touching the bottom of the container3. Check if there is anything blocking the (H) Tube
Fog bubbles stop and start.	The unit will need 20 seconds to pump the bubble liquid from the tank to the nozzle. After the first 20 seconds, the machine will start blowing fog bubbles for about 40 seconds and then stop for about 20 seconds before resuming.
Fog output is low	<ul style="list-style-type: none">· Try cleaning the machine (details in "Cleaning" section).· Ensure there is sufficient Fog Liquid / Bubble Liquid in the tank.
Bubbles that are ejected immediately fall to the ground	Make sure that the air outlet cover opens to send the bubbles flying into the air.
Missing parts	Please call customer service at 1-877-527-0313 so a replacement can be sent to you.
Still experiencing an issue	Please call customer service at 1-877-527-0313 for further assistance.

TECHNICAL SPECIFICATIONS

BUBBLE FOGGER MACHINE

Item Code: 21SV23107

Model #: QB-807S

Rating Voltage: 120V, 60Hz

Power: 450W

Ambient Temperature: 5 ~ 45°C

Fuse: 5A, 125V

Preheat Time: 2 ~ 4 Minutes

Fog Liquid Tank Capacity: 350ml

Bubble liquid Tank Capacity: 500ml

Dimensions: L348 x W161 x H254 mm

© Seasonal Visions International
Emeryville, CA 94608
Tel: 855-428-3921
All Rights Reserved
MADE IN CHINA