



heated lunchbox
food warmer - 1.5L capacity



Instruction Booklet

Model: SP2111

IMPORTANT SAFEGUARDS

When using electrical appliances, basic safety precautions should always be followed, including the following:

1. Read all instructions.
2. **DO NOT** touch hot surfaces. Use handles or knobs.
3. To protect against electrical hazards, **DO NOT** immerse cord, plugs, or the appliance in water or other liquid.
4. Close supervision is necessary when any appliance is used by or near children. Children should be supervised to ensure that they do not play with the appliance.
5. This appliance is not intended for use by persons (including children) with reduced physical, sensory or mental capabilities or lack of experience and knowledge, unless they have been given supervision or instruction concerning the use of the appliance by a person responsible for their safety.
6. Unplug from outlet when not in use and before cleaning. Allow to cool before putting on or taking off parts, and before cleaning the appliance.
7. **DO NOT** operate any appliance with a damaged cord or plug or after the appliance malfunctions or has been damaged in any manner. Return appliance to manufacturer for examination, repair or adjustment. See Warranty.
8. The use of accessories or attachments not recommended by Salton may cause hazards.
9. **DO NOT** use outdoors.
10. **DO NOT** let cord hang over edge of table or counter or touch hot surfaces.
11. **DO NOT** place on or near a hot gas or electric burner, or in a heated oven.
12. Extreme caution must be used when moving an appliance containing hot oil or other hot liquids.
13. **DO NOT** move the unit when it is still hot.
14. The heating base is subject to residual heat from warming cycle. Do not touch heating base immediately after removing the inner vessel.
15. Avoid sudden temperature changes, such as adding refrigerated goods or cold liquids into a heated pot.
16. To protect against electrical shock and product damage, do not heat foods directly in the heating base. Heat only in the removable inner vessel provided.

17. Wear oven mitts when handling hot components or touching hot surfaces.
18. Prior to connecting or disconnecting plug from wall outlet, turn any control to “Off”.
19. Always plug power cord fully into electric lunch box first, then plug cord into the wall outlet.
20. Always unplug the unit after use. The appliance will remain on unless it is unplugged.
21. Always place appliance on a heat resistant surface.
22. **CAUTION:** This appliance generates heat during use. Proper precautions must be taken to prevent the risk of burns, fire or other damage to persons or property.
23. **DO NOT** open the steam release during use. Steam can result in burns.
24. **DO NOT** use appliance for other than intended use.
25. **DO NOT** leave appliance unattended while in use.

SAVE THESE INSTRUCTIONS

HOUSEHOLD USE ONLY

POLARIZED PLUG

This appliance has a polarized plug (one blade is wider than the other). To reduce the risk of electric shock, as a safety feature, this plug will fit in a polarized outlet only one way. If the plug does not insert fully in the outlet, reverse the plug. If it still fails to fit, contact a qualified electrician. **DO NOT** attempt to defeat this safety feature.

DESCRIPTION OF PARTS

1. Lid
2. Handle
3. Locking Clasps
4. Steam Vent
5. Cutlery Compartment
6. Removable Stainless Steel Inner Bowl
7. Heating Base
8. Indicator Light
9. Plastic Container with Lid
10. Stainless Steel Spoon
11. Stainless Steel Fork
12. Power Cord for Home Use
13. Power Cord for Car Use

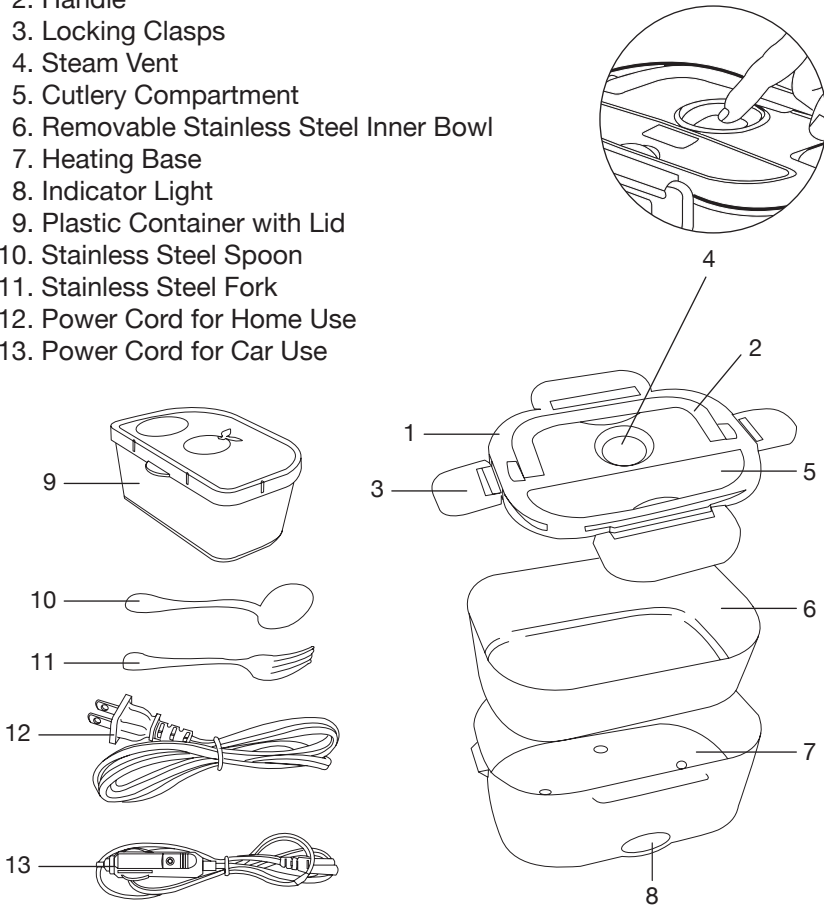

BEFORE FIRST USE

1. Read all instructions carefully and keep them for future reference.
2. Remove all packaging.
3. Wash the Lid, Stainless Steel Inner Bowl, Plastic Container with Lid and Utensils in warm soapy water with a non-abrasive sponge. Rinse and dry. The Lid, Stainless Steel Inner Bowl and Plastic Container with Lid can also be washed in the dishwasher. **TOP RACK ONLY.**
4. Wipe the Heating Base with a non-abrasive sponge or cloth dampened in warm water.

- **NEVER IMMERSER THE HEATING BASE IN WATER OR ANY OTHER LIQUID.**

- **DO NOT** use steel wool pads or other abrasive cleansers on any part of the appliance.

5. Your unit is now ready for use.

NOTE: During initial use, the unit may emit some smoke or odor as it burns off any manufacturing oils. This is normal and does not affect the safety of the appliance.

HOW TO USE

Warm homemade food. Anytime. Anywhere. Simply plug the unit in a wall outlet or in the car and your food is ready when you are. This lunchbox is designed to warm up food. This unit will not cook uncooked food. If a recipe calls for uncooked foods or meats, they should be fully cooked before combining with other ingredients and heating it in this unit.

NEVER put the Heating Base in the fridge, freezer, oven, stovetop, or microwave.

1. Fill the Removable Stainless Steel Inner Bowl with your desired food, then place the Inner Bowl inside the Heating Base. Do not overfill. The Stainless Inner Bowl should not be filled more than 3/4 full.
2. If desired, fill the Plastic Container with Lid with a side dish such as soup, gravy, a side salad, snack, dessert, fruits, etc. Add the Plastic Container with Lid inside the Removable Stainless Steel Inner Bowl.
3. Place the Lid on top of the Removable Bowl/Heating Base and Lock Clasps.
4. Plug the unit at least 30 minutes prior to desired meal time so that you food is ready when you are. The Indicator Light will turn on and the unit will begin to heat up.

NOTE: The Plastic Container can be left in the heating base to warm up your side dish (with or without the Container Lid on) or remove prior to plugging in if your side dish does not require warming.

IMPORTANT: The unit will not automatically shut off and will continue to warm until it is unplugged.

5. As soon as the Lunch Box is plugged in, push down on the center of the Steam Vent on the Lid. This will allow steam to escape during heating.

NOTE: It is important to make sure the steam vent is open during heating to avoid steam build up inside the unit and possible damage to your Lunch Box.

6. Once your food has reached the desired temperature, unplug the unit and enjoy your food right out of your Lunch Box. **CAUTION:** do not attempt to remove the Removable Stainless Steel Inner Bowl from Heating Base as it will be hot.

HELPFUL HINTS

1. Save time in the morning and fill the Removable Stainless Steel Inner Bowl the night before. Cover with plastic wrap and store in the fridge. Remove the plastic wrap prior to adding to the Lunch Box.
2. When warming pasta dishes, add a couple of teaspoons of water to your dish prior to heating. This will help create some steam and avoid drying out your pasta.
3. **DO NOT** expect your lunch box to heat up your food quickly. Heat times will vary depending on the amount and type of food being warmed and the starting temperature of the food.
4. Stirring your food from time to time will not only help speed up the time it takes to heat the food but also help prevent foods from sticking to the bottom of the Removable Stainless Steel Inner Bowl.
5. Food will remain warm for approximately 1-2 hours after unplugging. Warming time will depend on environment (hot or cold temperatures) and whether the lid is locked in position and steam vent is closed.

CARE AND CLEANING

1. Unplug the Lunch Box and allow it to cool.
2. Wash the Lid, Stainless Steel Inner Bowl, Plastic Container with Lid and Utensils in warm soapy water with a non-abrasive sponge. Rinse and dry. The Lid, Stainless Steel Inner Bowl and Plastic Container with Lid can also be washed in the dishwasher. **TOP RACK ONLY.**
3. Wipe the Heating Base with a non-abrasive sponge or cloth dampened in warm water. .
 - **NEVER IMMERSE THE HEATING BASE IN WATER OR ANY OTHER LIQUID.**
 - **DO NOT** use steel wool pads or other abrasive cleansers on any part of the appliance.
4. All other servicing other than cleaning should be performed by an authorized service representative. See Warranty section.

A short supply cord is provided to reduce the hazards of becoming entangled in or tripping over a long cord. Extension cords may be used if care is exercised in their use. If an extension cord is used, the marked electrical rating of the detachable power-supply cord or extension cord should be at least as great as the electrical rating of the appliance. If the appliance is of the grounded type, the extension cord should be a grounded 3-wire cord. The extension cord should be arranged so that it will not drape over the counter top or table top, where it can be pulled on by children or tripped over.

LIMITED WARRANTY

The original sales receipt is the only acceptable proof of purchase

Salton Appliances (1985) Corp. warrants that this appliance shall be free from defects in material and workmanship for a period of one (1) year from the date of original purchase. Salton Appliances (1985) Corp., at its sole discretion during this warranty period, will repair or replace a defective product or issue a refund. Any refund to the purchaser will be at a pro-rated value based on the remaining period of the warranty. All liability is limited to the amount of the purchase price. This warranty covers normal domestic usage and does not cover damage which occurs in shipment or failure which results from alteration, accident, misuse, abuse, glass breakage, neglect, improper maintenance, use contrary to the operating instructions or commercial use. This warranty is not available to retailers or other commercial purchasers or owners.

This warranty does not include the cost of shipping, which is to be borne by the customer.

TO OBTAIN PROMPT WARRANTY SERVICE:

Contact one of our many Service Centers found on our website www.salton.com/customer-care

or

Securely package and return the appliance to us. Please enclose:

- Original proof of purchase
- The completed form below with a \$12.50 Return Shipping & Handling fee – either a cheque, money order or credit card (A personal cheque will delay return shipping by 2-3 weeks)

For added protection, we suggest that you use an insured delivery service with tracking information when returning your product. Salton Canada will not be held responsible for in-transit damage or for packages that are not received.

.....
Name _____

Address _____

City _____ Prov/State _____ Postal/Zip Code _____

Daytime Phone No. _____ Email _____

Product defect: _____

Type of payment Cheque/Money Order Visa MasterCard

Name on card _____ Expiry Date _____ CSV No _____

Card No. _____

To contact our Customer Service Department:

SALTON CANADA
81A Brunswick,
Dollard-des-Ormeaux, Quebec H9B 2J5
Canada

Telephone: 514-685-3660
E-mail: service@salton.com
Fax: 514-685-8300
www.salton.com