

VEVOR®

TOUGH TOOLS, HALF PRICE

Technical Support and E-Warranty Certificate www.vevor.com/support

WATER IONIZER MACHINE

OPERATION INSTRUCTION

MODEL:EHM-729

We continue to be committed to provide you tools with competitive price.

"Save Half", "Half Price" or any other similar expressions used by us only represents an estimate of savings you might benefit from buying certain tools with us compared to the major top brands and does not necessarily mean to cover all categories of tools offered by us. You are kindly reminded to verify carefully when you are placing an order with us if you are actually saving half in comparison with the top major brands.

MODEL: EHM-729





NEED HELP? CONTACT US!

Have product questions? Need technical support? Please feel free to contact us:

Technical Support and E-Warranty Certificate
www.vevor.com/support

This is the original instruction, please read all manual instructions carefully before operating. VEVOR reserves a clear interpretation of our user manual. The appearance of the product shall be subject to the product you received. Please forgive us that we won't inform you again if there are any technology or software updates on our product.

	<p>Warning-To reduce the risk of injury, user must read instructions manual carefully.</p>
	<p>Indoor Use only</p>
	<p>CORRECT DISPOSAL</p> <p>This product is subject to the provision of European Directive 2012/19/EC. The symbol showing a wheeled bin crossed through indicates that the product requires separate refuse collection in the European Union. This applies to the product and all accessories marked with this symbol. Products marked as such may not be discarded with normal domestic waste, but must be taken to a collection point for recycling electrical and electronic devices</p>

IMPORTANT SAFEGUARDS

When using your Buffet Warmer, basic safety precautions should always be followed:

1. Read all instructions.
2. Check that the voltage indicated on the data plate corresponds with that of the local network before connecting the appliance to the mains power supply.
3. Do not leave the appliance unattended whilst connected to the mains power supply.
4. Do not immerse the appliance in water or any other liquids.
5. It is imperative to unplug the power cord after the appliance has been used, before it is cleaned and whilst being repaired.
6. Close supervision is required when using this appliance near children. Never leave the appliance within reach of children.
7. Repairs to electrical appliances should only be performed by a qualified electrician. Improper repairs may place the user at serious risk.
8. This appliance is intended for household use only and should not be

used for commercial purposes.

9.Do not operate the appliance with a damaged plug or cord, after a malfunction, or after being dropped or damaged in any way.

10.Do not use the appliance for anything other than its intended use.

11.Do not touch hot surfaces, use handle or knobs when working with the unit.

12.This appliance can be used by children aged from 8 years and above and persons with reduced physical, sensory or mental capabilities or lack of experience and knowledge if they have been given supervision or instruction concerning use of the appliance in a safe way and understand the hazards involved. Children shall not play with the appliance. Cleaning and user maintenance shall not be made by children without supervision. Keep the appliance and its cord out of reach of children less than 8 years.

13.Type Y attachment: If the supply cord is damaged, it must be replaced by the manufacturer, its service agent or similarly qualified persons in order to avoid a hazard.

SAVE THESE INSTRUCTIONS

FCC INFORMATION

CAUTION:

Changes or modifications not expressly approved by the party responsible for compliance could void the user's authority to operate the equipment!

This device complies with Part 15 of the FCC Rules. Operation is subject to the following two conditions:

1) This product may cause harmful interference.

2) This product must accept any interference received, including interference that may cause undesired operation.

WARNING:

Changes or modifications to this product not expressly approved by the party responsible for compliance could void the user's authority to operate the product.

Note:

This product has been tested and found to comply with the limits for a Class B digital device pursuant to Part 15 of the FCC Rules, These limits are designed to provide reasonable protection against harmful interference in a residential installation.

This product generates, uses and can radiate radio frequency energy, and if not installed and used in accordance with the instructions, may cause harmful interference to radio communications. However, there is no guarantee that interference will not occur in a particular installation. If this product does cause harmful interference to radio or television reception, which can be determined by turning the product off and on, the user is encouraged to try to correct the interference by one or more of the following measures.

- Reorient or relocate the receiving antenna.
- Increase the distance between the product and receiver.
- Connect the product to an outlet on a circuit different from that to which the receiver is connected.
- Consult the dealer or an experienced radio/TV technician for assistance.

PRODUCT MAIN FEATURES

This Multifunctional Water Ionizer can be used freely in different water quality and different standards of the power supplies.

1. A large 3.8-inch colorful LCD screen display, displaying more information.
2. The LCD displays pH and ORP, flow rate, temperature, filter usage life, helping user to select suitable water.
3. Elegant and solid CDC Touch control panel, easy to be used by children & elderly people.
4. Using high-power SMPS power supply, it is suitable for many different power supplies in the world, safe and reliable.
5. The electrolysis with the Microcomputer automatic control system can work perfectly in the water TDS from 50 to 1000PPM.
6. It has a built-in water filtering system, showing the filter life span in time, to

make sure the water quality is safe to use.

7.It has the self-cleaning function,to prevent scaling.

8.Japan imported stainless steel spouts,never rust,free to be bent to any direction.

9.large size Titanium with Platinum coating plates,applied with Japan imported ionic membrane,providing higher efficiency electrolysis and longer working life.

10.Built-in overheat protection system,prevents high temperature water from entering the machine,assure the machine.



TECHNICAL PARAMETERS AND SPECIFICATIONS

1	Power supply	AC220-240V 50/60Hz or AC115V 60Hz
2	Work power	100W
3	Bide power	1.5W
4	Water pressure	0.1~0.3MPa
5	Inlet water TDS	50~1000mg/L
6	Flow rate	1.0~3.5L/Min
7	Best flow rate	2~3 L/Min
8	Continuously working time	≤30minutes
9	Filter usage life	8000L(Depend on the water quality)
10	Plates material	Titanium with platinum coating
11	Number of plates	5PCS(Default)/7PCS
12	Electrolytic plate area	5PCS:320cm ² / 7PCS:480cm ²

13	pH range	3.5-10.5
14	ORP range	5PCS:+500~-550mv / 7PCS:+500~-650mv
15	Inlet water temperature	5-40℃ (41-104°F)

Note:

1.The pH&ORP range,Filter usage life and Flow rate etc is depending on your local water supply condition.

2.The PH data is laboratory data, different regions are affected by TDS value, the data may be different, which is a normal phenomenon.

METHOD OF ERECTION

Installation tools:

- | | |
|----------------------------|------------------------------------|
| 1.One Phillips screwdriver | 2. A paper knife or scissors |
| 3. A hammer drill | 4. A table opener 5. A wrench |



statement

If there are technical improvements to the product, they will be included in the new manual without prior notice. If the appearance and color of the product are changed, the actual product shall prevail.

Parts and Accessories:



Tap adapter A



Tap adapter B



Coiler



Tee assembly



1/4" PE pipe



3/8" soft pipe



Accessory bag



Power cord



Filter wrench



pH test reagent

Installing the hoses for the water:

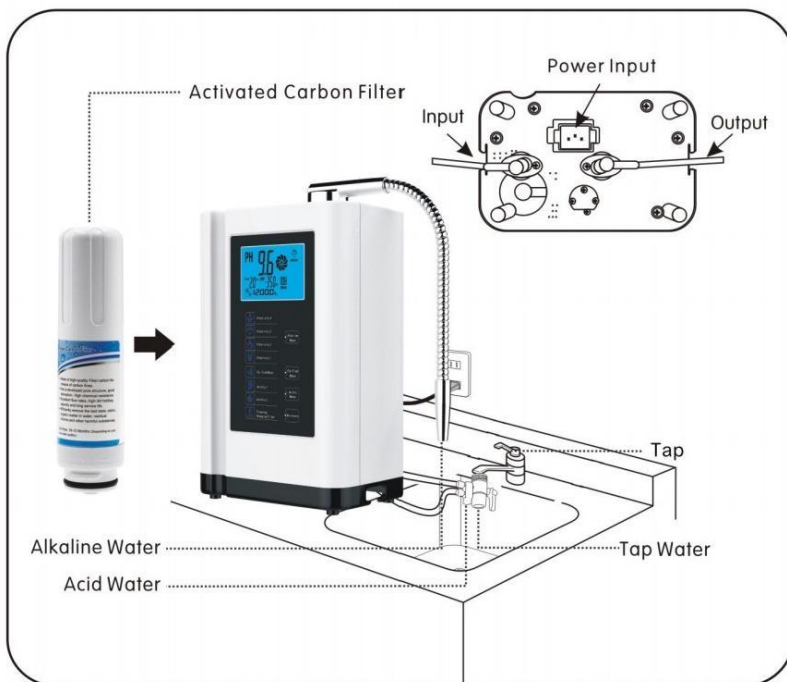



Cut the water hose into 2 pieces. Insert one hose into the IN outlet on the back of the unit and the other end should be inserted into the top insert on the adaptor. Repeat the process for the OUT outlet to the bottom insert. When getting ready to insert other end of hose into the adaptor, first insert the hollow bolt through the hose and bolt screw the bolt into the adaptor as seen in the picture below.

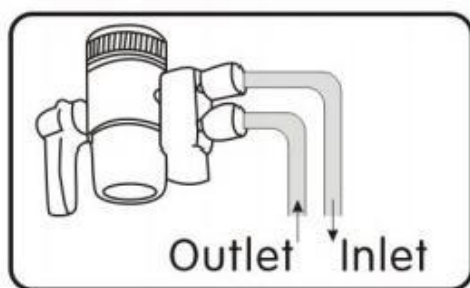

Insert the top hose to the out nozzle behind the unit and insert the bottom hose to the in nozzle. The hoses are identical, so either hose is affixed to which part of the adaptor will not matter.

How to connect the adaptor to 2 common types of faucets:

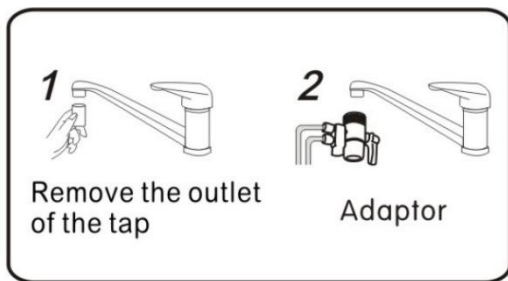

Type A:

Remove the outlet of the tap and fasten the adaptor. If there are leaks, turn it slightly as shown in the diagram until the leak stops, ensure that the washer has been inserted before tightening.

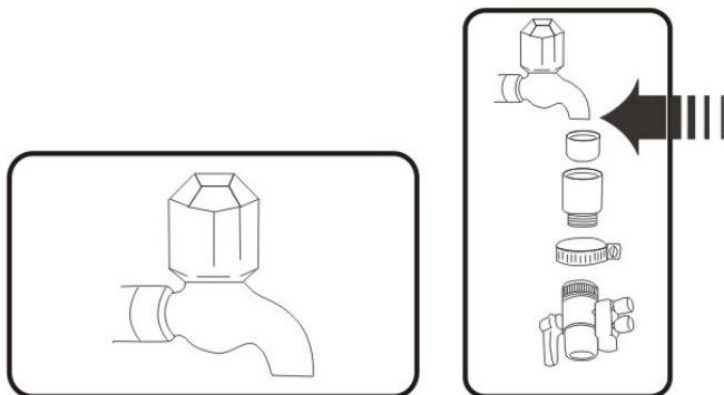

Type B:

Installation procedure (As shown in the figure) · Fix the installation ring first.
· Use the internal ring set and affix to the tap · Tighten with a wrench
· Finally, affix the valve.

Installation environment

A. Fix the water machine in a place without direct sunlight, and away from the fire source 1 meter away, to avoid the machine caused by heat shell deformation.

B. The power supply of the machine is AC120V or AC220-240V, in order to ensure safety, there must be a good grounding wire, please keep the machine away from the microwave oven, rice cooker and other high-power household appliances, use a separate power socket.

The water pressure of this machine is 0.1-0.3mpa, if the water pressure is lower than 0.1MPa, please install the booster pump.

Installation mode B:

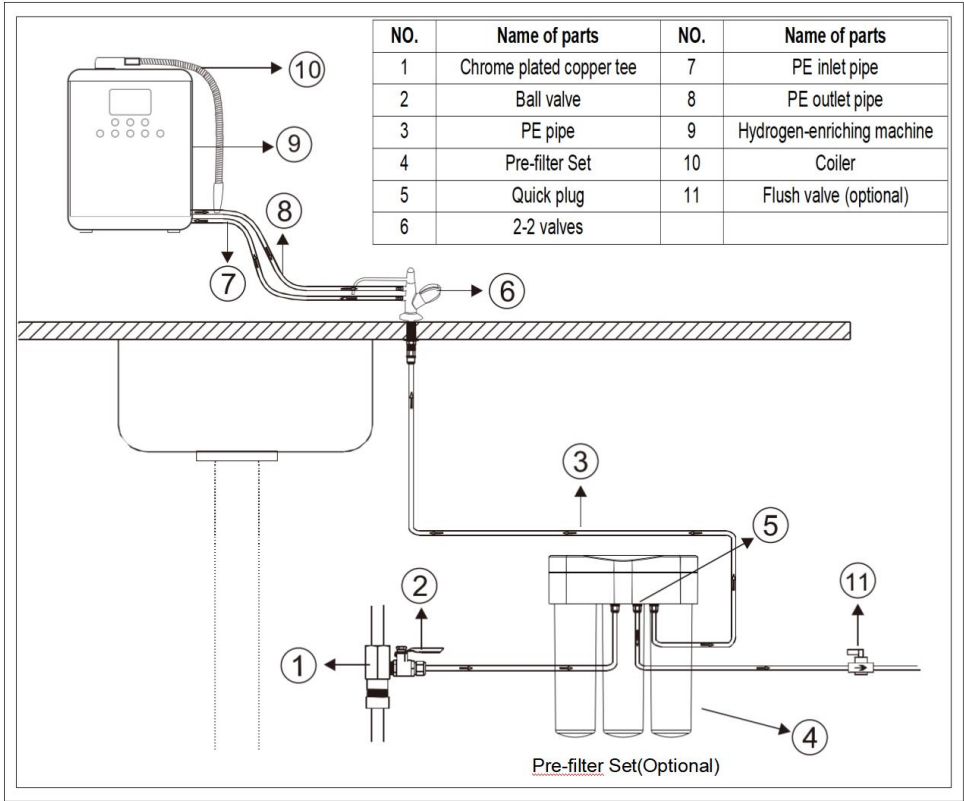

NOTE:Existing products do not have a pre-filter component, if you need to assemble, you need to purchase separately.

Installation steps:

Install three-way ball valve > PE pipe > 1/4" quick connector> tap adapter
B

Detailed installation
instructions are as follows:

2.4.2 Install 2-2 valves

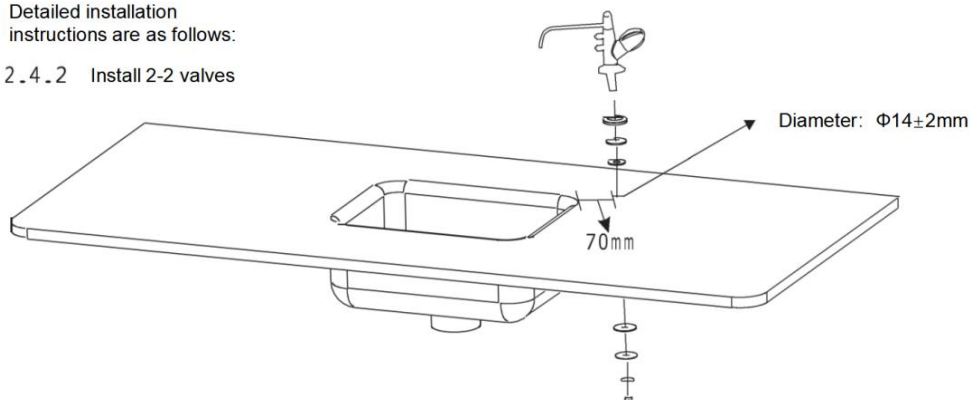

Step 1: Drilling: Within 70mm of the edge of the sink, drill a through hole (diameter 142mm) on the counter surface with an electric drill. Note: Marble counter tops need to use an $\Phi 14\text{mm}$ glass hole opener.

Step 2: Fix the 2-2 valve: Insert the 2-2 valve into the hole and fix it on the counter with a hex nut.

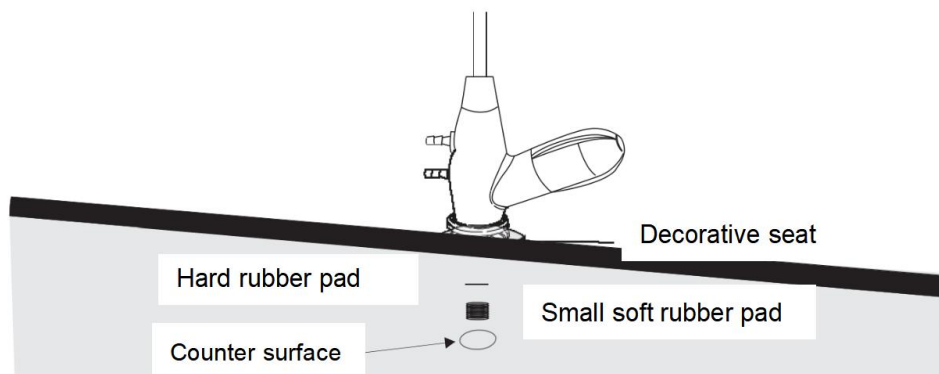

When fixing the 2-2 valve on the countertop, first put a decorative seat, and then put a hard rubber pad on the top of the screw, and then stick a small soft rubber pad.

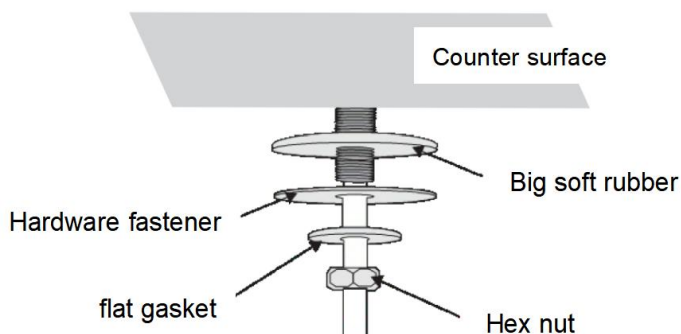

After the screw is inserted into the Counter surface, first put a big soft rubber pad, then put a hardware fixing piece, a flat gasket, and finally fixed with a hex nut.

Three-way ball valve installation

Should close the household main water valve switch, connect the three-way ball valve from the user's home water pipe, so that one end of the three-way ball valve is connected to the water inlet pipe, the other end is connected to the external water equipment pipe, and then connect the PE water pipe (1/4" water pipe) from the three-way ball valve outlet.

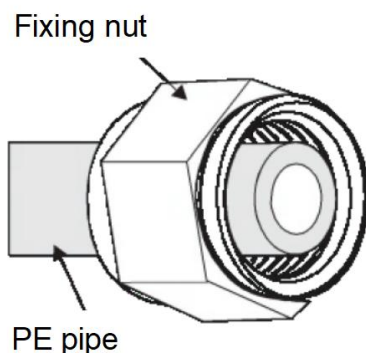

When connecting the PE pipe to the ball valve, insert the PE pipe into the fixing nut of the ball valve.

Before connecting PE

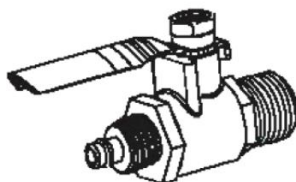

Connecting PE tube

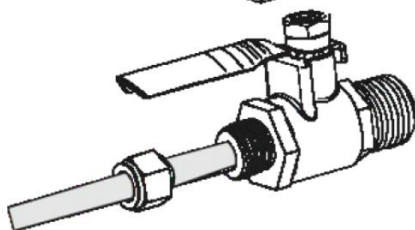

Complete connection

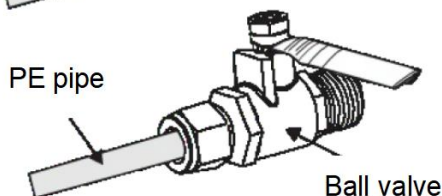

After the PE tube is inserted into the ball valve fixing nut, pull out the PE tube with sufficient operating length, insert the PE tube into the fixing screw of the ball valve base, and then screw the fixing nut into the fixing screw and tighten it with a wrench to set the ball valve in the closed position. At this time, the three-way ball valve and PE pipe are installed and connected.

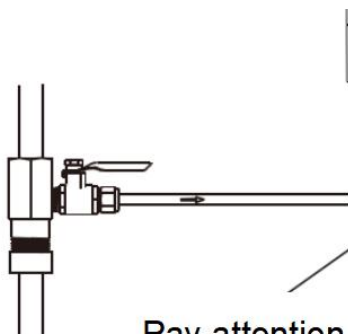

Pay attention to the

Then insert the other end of the PE pipe into the 1/4" quick connector, and the other end of the quick connector is connected to the bottom interface of the faucet adapter B, and the under-counter part is installed.



NOTE

If you want to take out the PE tube in the quick connector, just press down the inner ring of the quick connector with one hand, and pull the PE tube outward with the other hand.

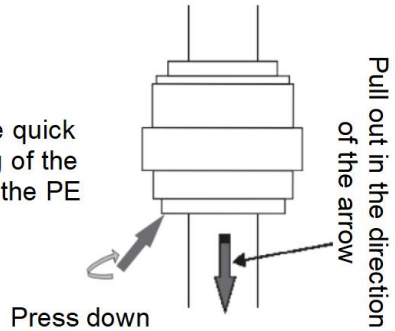

Installation of the water ionizer machine

Fix the water ionizer machine on the wall with hanging kit.

The first step is to directly place the machine in a convenient and suitable position on the counter.

The second step is to measure the appropriate height above the sink (30-50cm above the sink is appropriate), take out the accessories in the accessory bag, take out the hanging plate to determine the machine hanging holes position.

If the installation environment is not convenient to drill holes, please use nail-free glue to fix the wall hanging plate. After determining the position of the wall hanging plate, evenly apply the nail-free glue to the fixing surface of the wall hanging plate, and then stick to the fixed position of the wall surface (complete the operation within 5 minutes to prevent glue solidification). After fixing with nail-free glue, it is necessary to wait 24 hours after the glue is completely solidified before hanging the machine on the wall.

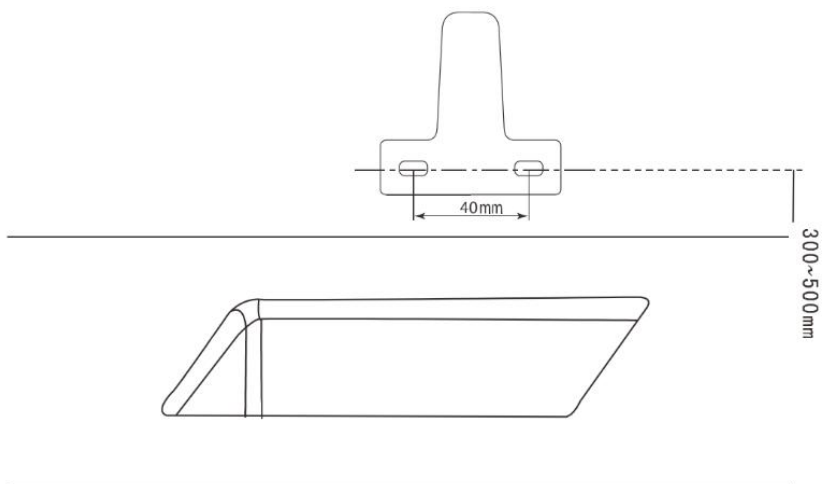

The third step is to use an electric drill to drill two holes with a vertical depth of about 50mm and a diameter of 6mm according to the drilling position, and the center distance of the two holes is 40mm.

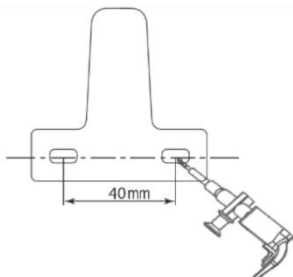

Step 4: Insert the plastic expansion tube into the hole.

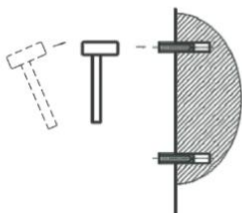

Step 5: Fix the metal hanging plate to the wall with stainless steel screws.



Step 6: Install the square metal hanging plate behind the water ionizer machine, and then hang it on the previously fixed hanging plate on the wall.

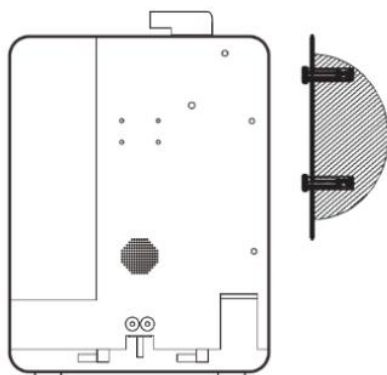

Step 7: Measure the distance from the adapter to the bottom of the machine, and cut off the appropriate length of the water inlet PE pipe and the drainage PE pipe.

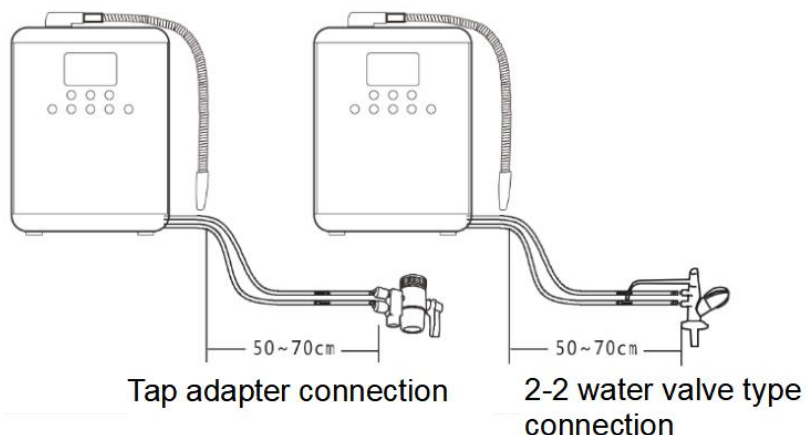

Step 8: Take down the machine from wall. Cut the 3/8" hose into 2 pieces with appropriate length. Connect the hoses to the IN and OUT nozzles at the bottom of machine base.

Tap adapter A:

Insert one end of the first 3/8" hose into the top water outlet of the tap adapter A and fix it tightly with a pipe clamp. Connect the other end to the water inlet at the IN nozzle of the machine base and fix it tightly with a pipe clamp.

Insert one end of the second 3/8" hose into the bottom outlet of the tap adapter A and fix it tightly with a pipe clamp. Connect the other end to the OUT nozzle of the machine base and fix it tightly with a pipe clamp.

Tap adapter B:

Insert one end of the first 3/8" hose into the bottom outlet of the tap adapter B and secure it tightly with a pipe clamp, and connect the other end to the water intake at the IN nozzle of the machine base and fix it tightly with a pipe clamp.

Insert one end of the second 3/8" hose into the top outlet of the tap adapter B and fix it tightly with a pipe clamp. Connect the other end to the outlet of the machine base and fix it tightly with a pipe clamp.

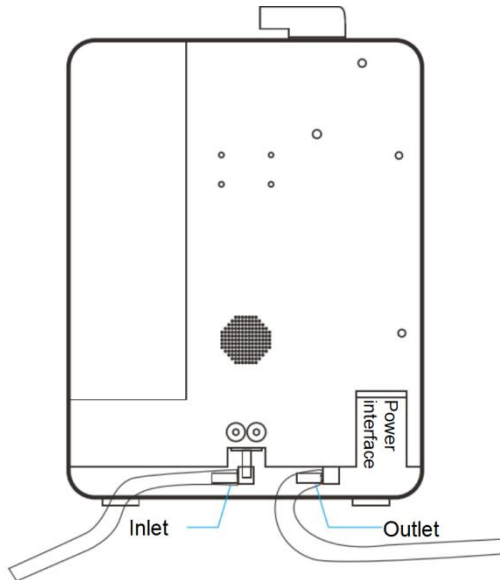

Step 9: Install metal coiler

Screw the metal coiler clockwise into the outlet connector of the machine as showing in the picture below.

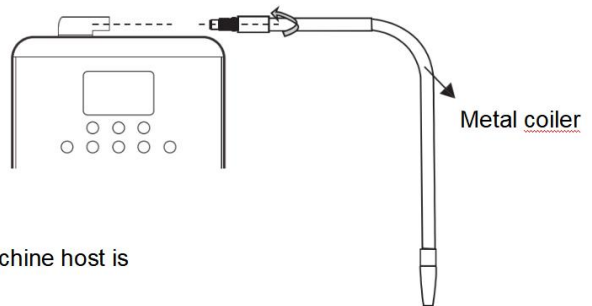

At this point, the water ionizer machine host is installed.

Plug in the power cord

First make sure that the specifications of the power supply to be connected are consistent with the requirements of the nameplate, and then insert the power cord plug (one end is connected to the lower end of the machine, the other end is connected to the power supply).

After the power cable is plugged in, the LCD and indicator light up. In daily use, the power cable plug can not be disconnected.

CONTROLLING PANEL OVERVIEW

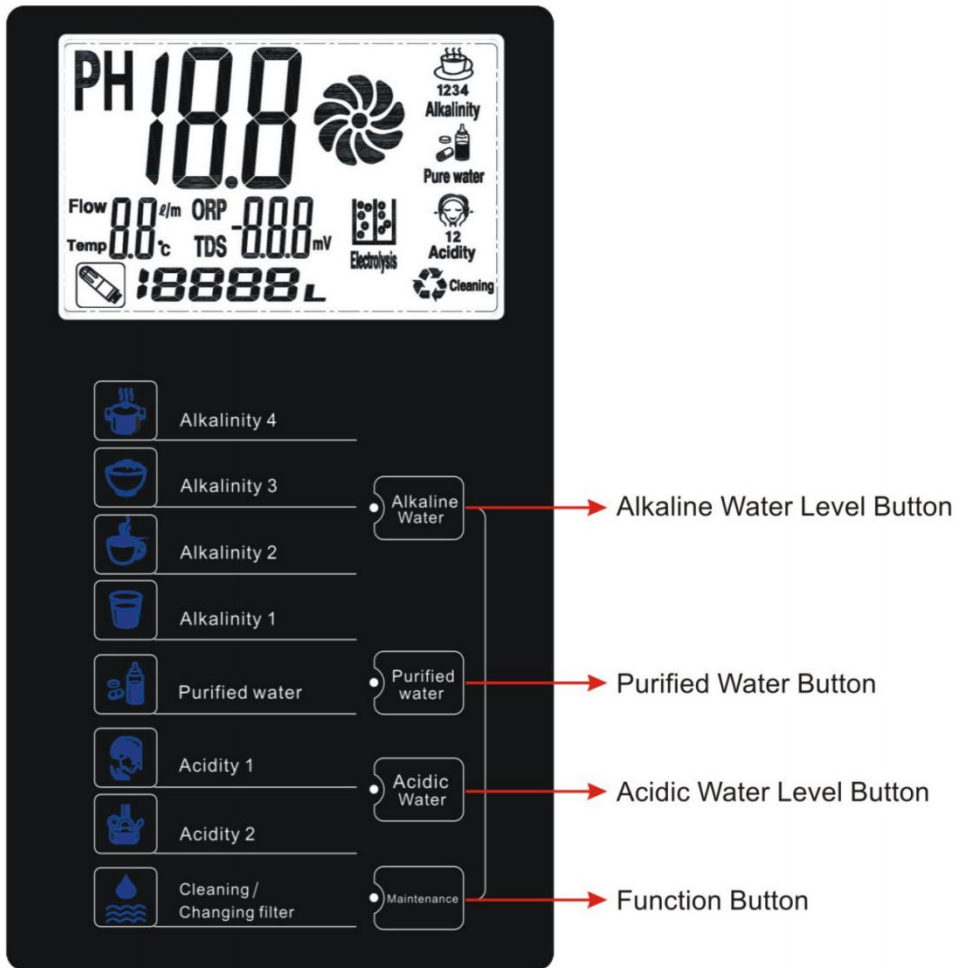

How to operate

When the tap is turned on, water enters the ionizer. As soon as the water flow rate is over 0.8L/minute, the screen will be lit up, and the default pH level is on Alkaline Water Level 2, and at the same time, the music and a voice of "Alkaline Water Level 2" will be heard. You may press the Alkaline Water Button to select different levels

Of 1,2,3,and 4 for different pH values.You will hear "Alkaline Water Level 1", "Alkaline Water Level 3"and "Super Alkaline Water"for the different Alkaline Water Levels.When the screen light turns violet,it indicates strong alkaline condition while blue indicates normal alkaline.

When the Purified Water Button is pressed,a voice of "Filtered water "will be heard. There will be no ionizing of the water (screen light turns green).The light turns off 1 minute after water supply is turned off.The ionizer automatically switches to Alkaline Water Level 2.

When the Acidic Water Button is pressed,a different music and a voice of "Mild Acidic Water "will be heard(screen light turns yellow).Press the Acidic Water Button again,a voice of "Super Acidic Water "will be heard (screen light turns red). Light turns off 1 minute after water supply is turned off.The ionizer automatically switches to Alkaline Water Level 2.

When the Maintenance Button is pressed,the voice of "Unit Is Now Cleaning "will be heard.The screen light is red.After the cleaning,the ionizer will automatically switches to Alkaline Water Level 2.

Note: The machine will be auto-clean when the flow rate is lower than 0.8L/M (LCD is red).After 5 seconds the machine are on standby(LCD is blue).No-operation for 15 seconds,the machine will be power-down mode(LCD is out).

PANEL OPERATION AND FEATURES

Alkaline water button

There are four sections of the alkaline water.You may choose the most suitable alkaline water,according to your needs,like cooking food,making tea,or daily drinking

Purified Water Button

The machine will out put the neutral pH purified water for taking medicine,brewing milk etc.

Acidic water button

There are two sections of the acidic water.You may choose the acidic water

for washing,cleansing or sterilizing.

Function button

When the water capacity reaches the set value,the cleaning light will be on.Press the cleaning button to start the internal cleansing during the machine is working.

When the filter life is exhausted,after replacement the filter,long press the function button,the filter life will be restored to the set value.

GENERAL USE PH INSTRUCTION TABLES FOR WATER LONIZER

	Function	Uses Of Different pH Water	Same pH Foods Reference
	Cooking & Food Disinfection &Dishes Cleaning	<p>pH 9.0~10.5 Alkaline Water Level 4(strong alkaline)</p> <ul style="list-style-type: none">·Good for making soups and stews.It is helpful for maintaining their nutrients and colors.·Soaking vegetables,beef,pork and fresh fish to remove fishy taste and keep the food's natural flavors.·Effectively reduces pesticides on fruits and vegetables.·Good for cleaning tough stain on dishes.·Strong antioxidant for removing the free radicals from body.	Ginger Grapes Kelps Seaweeds

Alkaline Water	Cooking & preparing bakeries	<p>PH 8.5~10 Alkaline Water Level 3</p> <p>Good for cooking rice,preparing noodles bread and cake,and preserve its nature flavor longer</p>	<p>Mushrooms Soy beans Spinach</p>
	Prepare coffee and tea	<p>pH 8.0~9.0 Alkaline Water Level 2</p> <p>·Good for making tea or coffee,reduce bitterness and give better taste.</p> <p>·After initial period use,this level is also suitable for daily drinking and improving your overall health</p> <p>·Improve conditions for upset stomach, constipation,diarrhea and gout.</p>	<p>Banana Carrot Chestnut Lettuce Red beans</p>
	Initial and daily drinking	<p>PH7.5~8.5 Alkaline Water Level 1</p> <p>·For people just beginning to drink alkaline water.</p> <p>Balancing internal pH,improving the assimilation of Calcium and other minerals.</p>	<p>Apple Cabbage Eggplant Onion Tea</p>

Purified Water	Purified water	<p>pH 7.0 Purified Water</p> <ul style="list-style-type: none"> ·No color,no taste,no impurity ·Suitable for taking medicine,preparing formula and for baby's diet. 	<p>Asparagus Bread Milk Miso Tofu</p>
Acidic Water	Facial & skin cleaning	<p>PH 5.0~6.5 Acidic Water Level 1</p> <ul style="list-style-type: none"> · Not suitable for drinking. ·Close to the skin pH value,it has an astringent effect when face cleaning. ·Ideal for bathing sensitive skin and infants,sunburn relief. ·Minimize the appearance of pores,and good for brushing teeth. ·Restores shine to hair and as a nature after shave. 	<p>Beef Beer Clam Rice Octopus</p>
	Sterilization & disinfection & Chemicals elimination	<p>pH 3.5~5.5 Acidic Water Level 2</p> <ul style="list-style-type: none"> ·Not suitable for drinking ·Anti-bacterial for tableware and floor cleaning. ·Eliminates the residual agricultural chemicals on fruits and vegetables when soaking them in acidic water. 	<p>Cheese Egg yolk Oats squid</p>

LCD DISPLAY INTRODUCTION

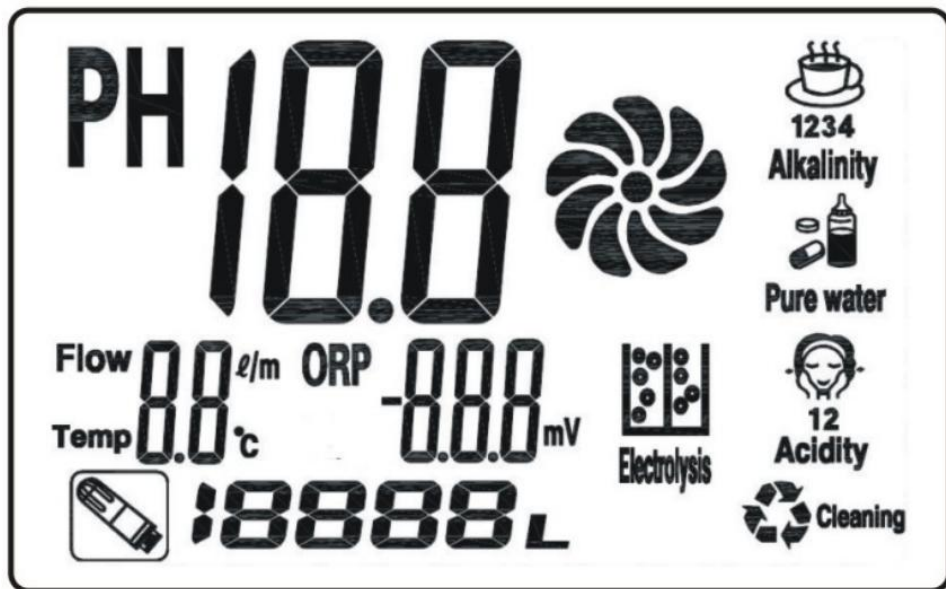

Alkaline water display: Alkaline 4 (purple), Alkaline 3 (dark blue), Alkaline 2 (light blue), Alkaline 1 (white)

Pure water display: Green

Acidic water display: Acidity 2 (red), Acidity 1 (yellow)

Flow rate: Displays the current rate of water flow through the machine

Temperature: Displays the current temperature of the water

PH: Showing output water pH value

ORP: Showing the output water oxidation reduction potential

Cleaning: The machine is cleaning

Electrolysis: The machine is electrolyzing

Impeller: The machine is working with the water passing through

PRINCIPLE OF OPERATION

The basic principle of the water ionizer is electrolysis of water to change the PH and Oxidation-Reduction Potential (ORP) to separate the hydrogen and the hydroxide ion. In general, the water cannot decompose into O₂ and H₂ in the state of nature, but according to Faraday law of electrolysis, if

adding cathode and anode into water. When the current is switched on, the water will be electrolyzed

The Anode materials are usually titanium and platinum. They are not easy to dissolve. The oxidation-reduction reaction of cathode and anode is as follows

$2\text{H}_2\text{O} + 2\text{e}^- = 2\text{OH}^- + \text{H}_2$ Alkaline electrolytic water with reductive

$\text{EO} = 0 - 0.0591\text{pH}$

$\text{H}_2\text{O} = 2\text{H}^+ + 1/2\text{O}_2 + 2\text{e}^-$ Acidic electrolytic water with oxidative

$\text{EO} = 1.228 - 0.0591\text{pH}$

After the hydrogen and oxygen are produced on the surface of the cathode and anode, the water around the electrodes become alkaline and acidic. At the same time, the ORP is changed. The porous semipermeable membrane or the semipermeable membrane that Cation-anion can selectively go through the insert into the two poles to limit the water. The acidic water with high concentration and oxidative will be collected from positive pole, the alkaline water with high concentration and reductive will be collected from negative pole. This is the operation principle of water ionizer.

FUNCTION SETTING

The following operations are limited to technician setting the machine only. Do not turn on the water tap when you are going to set the machine.

1. Alkaline Water Button: pH adjusting (to make displayed pH value and actual PH close)

Pressing and holding Alkaline Water Button for about 4 seconds, buzzer sounds

ding-a-dong, comes into Alkaline Water Level 1 pH adjusting and displaying "1.1 " (as shown in figure), Pressing Purified Water Button(+) and Acidic Water Button(-) to do cycle adjustment from 1 to 10.

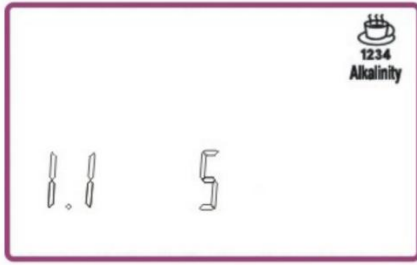

Alkaline1 Adjusting

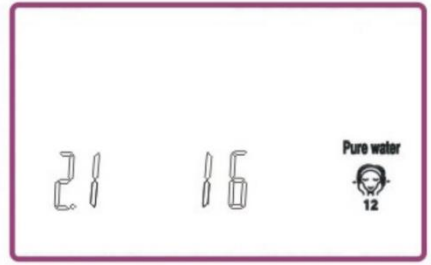

Acidic 1 Adjusting

When you press the Alkaline Water Button the second time, comes into Alkaline Water Level 2 PH adjusting and displaying "1.2" Pressing Purified Water Button (+)

and Acidic Water Button (-) to do cycle adjustment from 3 to 12.

When you press the Alkaline Water Button the third time, comes into Alkaline Water Level 3 pH adjusting and displaying "1.3 " Pressing Purified Water Button (+) and Acidic Water Button (-) to do cycle adjustment from

8, 10, 12, 14, 16, 18, 20, 22, to 24. When you press the Alkaline Water Button the fourth time, comes into Alkaline Water Level 4 pH adjusting and displaying "1.4" Pressing Purified Water Button (+) and Acidic Water Button (-) to do cycle adjustment from 18, 20, 22, 24, 26, 28, 30, 32, 34, 36, to 40

When you press the Alkaline Water Button the fifth time, comes into Acidic Water Level 1 pH adjusting and displaying "2.1 (as shown in figure)" Pressing Purified Water Button (+) and Acidic Water Button (-) to do cycle adjustment from 10, 12, 14, 16, 18, 20, 22, 24, 26, to 28.

When you press the Alkaline Water Button the sixth time, comes into Acidic Water Level 2 PH adjusting and displaying "2.2 " Pressing Purified Water Button (+) and Acidic. Water Button (-) to do cycle adjustment from 18, 20, 22, 24, 26, 28, 30, 32, 36, to 40

When you press the Alkaline Water Button the seventh time, the buzzer sounds, and the settings are saved and the ionizer will return to standby on the Alkaline Water Level 2.

Attention: The higher you set, the higher pH value you get.

2.Purified Water Button: Filter Life,Cleaning Setting,Voice Setting



Filter Life Setting

Pressing and holding Purified Water Button for about 4 seconds,the buzzer sounds ding-a-dong,comes to filter life setting,12 items are available.They are 1000,2000,3000,4000,5000,6000,7000,8000,9000,10000,11000,12000.Use Alkaline Water Button(+)and Acidic Water Button(-)to do cycle adjustment.

Specifications of filter life setting:

The filter life begins to count down when the machine starts.Life setting range is 1000L to 12000L----each level is 1000L.When filter life reaches the set value,the filter pattern flashes prompt.

1.Under the filter life setting state,if you don't press Alkaline Water Button (+)and Acidic Water Button(-)to adjust,the old memory of filter life will not be overwritten. If you press Alkaline Water Button(+)and Acidic Water Button(-)to adjust,the current filter life settings will directly return to zero. The input water flow rate should be over 0.8L/min,then it will drive the water flow.

sensor to start the water ionizer.If less than 0.8L/min,the water ionizer can't be turned on to work.Then you may need a pump to help.

2. When the filter life is expired, press the "Maintenance" 5 seconds "directly under the standby state, the setting value returns to zero.

Press the Purified Water Button the second time, goes to cleaning setting. Press Alkaline Water Button(+) and Purified Water Button(-) to do cycle adjustment among the "30,60,90,EL" four numerical.

Cleaning Setting Description:

When set to 30, means when the total discharge capacity reaches 30L, cleaning light flashes. If set to "EL", when the total water discharge capacity reaches 60L, cleaning light flashes, and automatic cleaning action will go ahead next time as the water connects.



Third pressing Purified Water Button to enter the voice language settings, setting items are "ENG, CHN". Press Alkaline Water Button(+) and Purified Water Button (-) to adjust.

ENG: Voice broadcasting in English. CHN: Voice broadcasting in other language.

Third pressing Purified Water Button to enter the voice and background music settings, setting items are "S1, S2, S3". Press Alkaline Water Button(+) and Purified Water Button(-) to adjust.

S1: Play voice and background music. S2: only play voice, no background music. S3: Turn off voice and background music.

Fourth pressing Purified Water Button to save the settings, and the ionizer will return to standby on the Alkaline Water Level 2.

3. Acidic Water Button: Settings on pH display - nominal settings have been preset in the factory, but you can adjust the electrolysis strength setting for each level as follows:

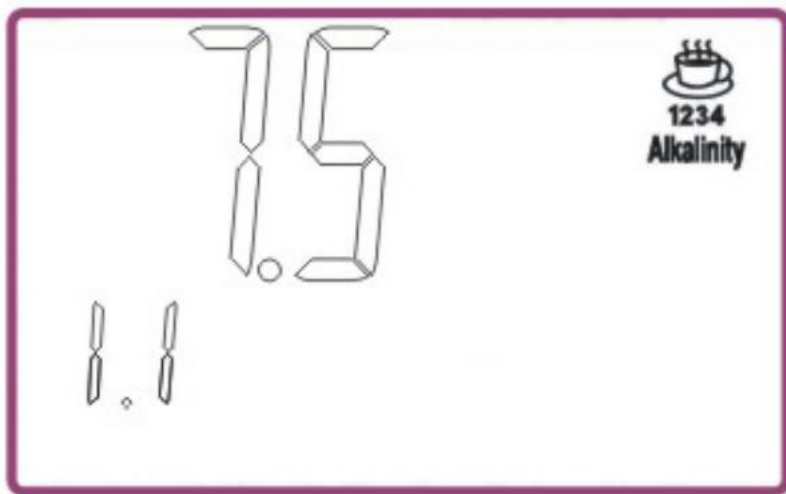

Press on the Acidic Water Button for about 4 seconds, the buzzer will give a tune to enter the pH adjustment on the Alkaline Water Level 1. It is displaying "1.1", as in the above picture. And press Alkaline Water Button to increase the level or the Purified Water Button to lower the electrolysis level to adjust the pH to "7.5, 8.0, 8.5, 9.0, 9.5", Etc.

Press the 2nd time on the Acidic Water Button to enter pH adjustment on the Alkaline Water Level 2. Repeat same procedure as above to set the strength levels for all settings.

PRECAUTIONS FOR USE

Before using this water ionizer, please read these precautions carefully. Please operate this water ionizer following the precautions to avoid the damages to the machine or your health.

City or municipal water is recommended. Well water is not recommended. Please replace the water filters timely, to assure the water quality is good for your health and machine's lifespan.

The input water flow rate should be over 0.8L/min, then it will drive the water flow sensor to start the water ionizer. If less than 0.8L/min, the water ionizer can't be turned on to work. Then you may need a pump to help.

Don't connect it with a water heater. Make sure the inlet water temperature is below 113 Fahrenheit degrees (45 Celsius degrees). Keep the machine away from high temperatures and direct sunlight.

Don't use water to rinse the machine directly, and don't use alcohol and other volatile solvents to wipe it, either. Please use a soft cloth with soapy water to wipe it gently. Don't use the aluminum or copper container for the alkaline or acidity water, as the water could be contaminated by these types of containers.

Don't disassemble the machine & components. Don't block, fold or break the outlet tube. When the machine is working, for the purpose of expelling water freely, don't keep the acidity water outlet tube in a high place. And the acidity water tube should be no more than 60cm in length.

Every morning before collecting alkaline water from the ionizer, allow the water to run for 10~30 seconds to flush out the water in the machine and filters. And the end of the day, it is suggested to flush for 10-15 seconds in the "Purified water" level and "Acidic Water" level to prevent scaling.

The ionized alkaline & acidic water should be used as soon as possible within 24 hours.

Don't take medicine with alkaline water. Use purified water. Don't drink acidic water.

Please disconnect the power plug when not using the machine for long period.

Please do not damage the power cord and power latch.

1. Ensure that the power cable and power latch are intact.
2. Do not bend or twist the power cable or power latch forcibly.
3. Do not drag the power cord.
4. The power cable cannot bear heavy loads.
5. Do not squeeze the power cable or clip the power cable to a certain place.

If the use of damaged power cord, latch will cause electric short circuit phenomenon, resulting in fire. Contact a professional if you need to repair

the power cord or latch.

When inserting the power plug, make sure that it is fully inserted. If the plug is not fully inserted, it can also cause electric shock or fire. If the latch is damaged or the socket is loose, do not use it again.

Remove the dust on the power latch regularly. If the dust accumulates on the power latch for a long time, it will cause an electric shock and cause a fire due to the humid air. Do not use volatile solvents such as alcohol when cleaning the machine. Wipe with a cotton cloth dipped in dishwashing liquid.

TROUBLESHOOTING

Issue 1:The power supply light is not on or LCD screen does not display.

Solution:Please check if electricity is connected properly and re-plug in the cord.

Issue 2:The machine keeps beeping(alarming).

(Note the symbols on the LCD display while the machine beeping)

Solution:If there is a"H1"displayed on the LCD,it means the tap water temperature is too high,please turn off the tap water and do not let HOT water enter the machine.

Issue 3:Touch control panel does not function or respond (but the machine can still work normally).

Solution:Please unplug the power cord and wait a minute,then plug in the power cord.After the power is re-applied,the unit should return to normal operation.Note:do not locate the ionizer near electromagnetic radiation appliances,ie microwave ovens.

Issue 4:Background light on LCD is not on and the LCD is dark.

Solution:the tap water pressure is LOW,please increase the water pressure and check if the filter blocked or not.Replace filters as needed.

Issue 5: Acidic /alkaline water or purified water does come out.

Solution: Please replace the water filters if needed. If water pressure is too LOW, please increase it. If "cleaning indicator" light is "ON", please initiate cleaning cycle.

Issue 6: There is some white sediment in the alkaline water.

Solution: The alkaline water after the production is usually whitish color, this is normal and the water is OK to drink.

Issue 7: A white film appears on the inner wall of the alkaline water container. Solution: This is a crystallization of calcium carbonate by gas in the air after the reaction of solid components of calcium. These white substances are normal when generating alkaline water. It does not imply there is anything wrong with the water. The water is OK to drink.

Note: If this condition persists, please use food grade citric acid to clean the plates or white vinegar. Allow the machine to soak for a few hours and flush thoroughly. Please see maintenance procedures.

Note: If the machine will not be used for a long period, please unplug the power cord, remove the filter and remove the Water Converter and water purifier. Drain thoroughly and place the filter in a sealed plastic bag and store in the refrigerator.

Issue 8: Alkaline water output amount reduces gradually.

Possible causes and solutions:

Inlet Water Pressure - make sure input water pressure is sufficient - above 40 psi. Filter blockage - please make sure filter life is OK and replace filters as needed. Excessive build up of calcium deposits in the outlet tube - please clean the outlet tube as needed. Soak in vinegar as needed.

Excessive build up of calcium deposits on the electrolysis plates - please contact customer service for support.

Made In China

VEVOR[®]

TOUGH TOOLS, HALF PRICE

Technical Support and E-Warranty Certificate

www.vevor.com/support