

Wall Lamp

Thank you for your purchase. Before assembling the lighting fixture, please read the instructions carefully.



1. Be sure to follow the instructions strictly for installation.
2. Do not change or discard any contents by yourself.

1. To avoid damage, please use the lamp within the specified voltage range.
(Rated voltage AC110-240V 50/60Hz)
2. Do not install it in high temperature or humid places.
3. To ensure safety, when the light needs to be repaired or inspected, please entrust qualified, licensed electrician to be responsible for it.
4. If there are any abnormalities, please cut off the power immediately and contact the seller.

Assembly & Installation Instructions

WARNING

To prevent electrical shock, make sure the power to the circuit is turned off at the main fuse box or circuit breaker utility box

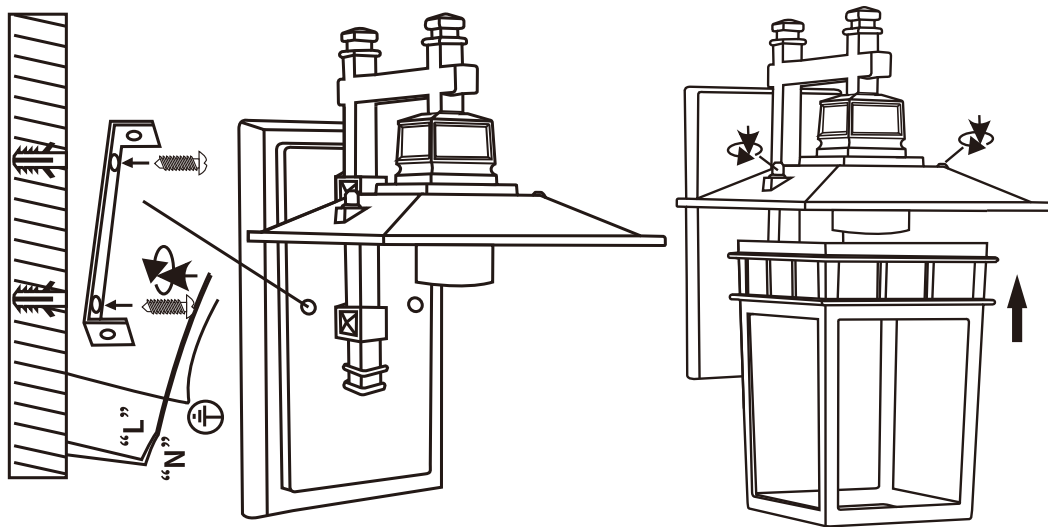

Pendant Light

Thank you for your purchase. Before assembling the lighting fixture, please read the instructions carefully.



1. Be sure to follow the instructions strictly for installation.
2. Do not change or discard any contents by yourself.

1. To avoid damage, please use the lamp within the specified voltage range.
(Rated voltage AC110-240V 50/60Hz)
2. The lighting fixture is meant for indoor use, dry locations only.
Do not install it in high temperature or humid places.
3. To ensure safety, when the light needs to be repaired or inspected, please entrust qualified, licensed electrician to be responsible for it.
4. If there are any abnormalities, please cut off the power immediately and contact the seller.

Assembly & Installation Instructions

WARNING

To prevent electrical shock, make sure the power to the circuit is turned off at the main fuse box or circuit breaker utility box

