

# **Universal Bypass Wardrobe Doors Illustrated Installation Instructions**



Congratulations on purchasing your new Cw® wardrobe door. Now that you have opened the package, we want you to verify that you have all the necessary hardware supplied with your door(s).

## Parts Check List:

### Part Description

Door Panels

Top Channel

Bottom Track

Wood Strip (located inside of Track)

#8 x 1 1/2" Screws

#8 x 1/2" Screws

Clear Plastic Bumpers

Concrete Nails

Penny Nails

Mirror Handles (not included with all models)

Mirror/Painted Glass Fascia (not included with all models)

Top Guides (not included with all models)

**Note:** Based upon application and/or panels used, the quantities and parts may vary. If you find that any parts are damaged or missing, please contact our Customer Service department at 661.257.1177.

Make sure that you have all the proper tools required to install your new wardrobe door.

## Tool Check List (Tools Not Included):

- Safety glasses and gloves
- Phillips screwdriver
- Tape measure
- Pencil
- Utility knife
- Electric drill
- Masonry drill bit set (see **Step 3, A3**)
- Drill bit set
- Miter box and hacksaw (with 32-tooth blade)
- Square
- Construction adhesive (see **Step 3, A2-3**)
- Screws and screw anchors (see **Step 3, A3**)
- Glass Cutter (for Fascia only)

Scan the QR code or follow the URL to access your model's Illustrated Parts Breakdown (IPB) and additional product information.

For more installation information:



[www.cwdoors.com/installation-instructions/](http://www.cwdoors.com/installation-instructions/)

## Step 1 Preparing Your Opening

Remove existing doors, brackets, top channel and bottom track. Your opening should be free of any clutter and debris. Ensure the area for the Top Channel has been prepped and ready for installation.

**Note:** Views and directions given in these instructions i.e., left, right, front, back, etc., are from the outside facing the wardrobe door or the opening.

## Step 2 Installing the Top Channel

**A.** Measure the opening at the top, from wall to wall.

**B.** Cut the Top Channel to the dimension you measured, using a miter box and hacksaw for a straight cut. Cut one end only.

**Note:** If your closet has wall jambs you may need to notch your Top Channel on each end.

**C.** When cut to proper length, align Top Channel flush to the top front of closet opening making sure that the front of the Top Channel is flush with outside walls or jamb boards. Hold the Top Channel in the desired position and with your pencil, mark where the pre-drilled holes are in the Top Channel (See **Figure 1**).

**Note:** If installing a Mirror or Painted Glass Fascia, install the Top Channel 1/4" back from outside wall to leave room for the Fascia.

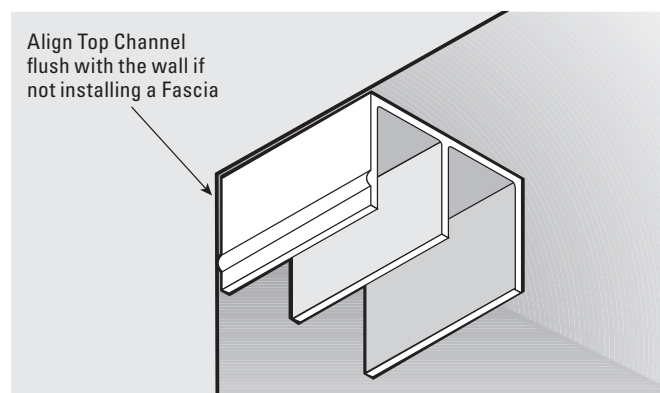

**Figure 1**

**D.** Remove the Top Channel and drill pilot holes using 1/8" drill bit where you made the pencil marks. Now install the Top Channel in place using #8 x 1 1/2" screws.

### Step 3 Installing the Bottom Track

**A.** Determine the type of flooring for this installation:

#### 1. Carpet

It is highly recommended that if you have carpet and do not have a cut-out in the carpet already, you should cut the carpet in order to install the Bottom Track directly to the floor. Use the utility blade to make a straight cut. We do not recommend installing the Bottom Track directly on top of carpet or padding.

#### 2. Concrete

Use Concrete Nails to attach Wood Strip to floor. Or, you may glue the Wood Strip down with construction adhesive (not included).

#### 3. Tile

Drill holes with a 3/16" masonry drill bit. Insert screw anchors and attach Wood Strip to floor with screws. Or, you may glue the Wood Strip down with construction adhesive. (Screws, anchors and adhesive are not included.)

#### 4. Wood

Use Penny Nails to attach Wood Strip to wood floor.

**B.** Measure opening at the bottom from wall -to-wall.

**Note:** If the baseboard molding continues into the opening, you may need to remove it so that the wardrobe doors will close flush to the wall.

**C.** Cut the new Bottom Track and Wood Strip to this dimension.

**D.** Find the correct offset measurement, using the offset measurement chart, for your particular model. From the front edge of the opening, measure using the offset from the chart and make a small pencil mark on the wall. Do this on both walls, i.e., right and left walls (See **Figure 2**).

## Offset Measurement Chart

Measurements (see chart below) will be from face of opening to front edge of Wood Strip.

**Note:** For optional Mirror or Painted Glass Fascia, add 1/4" to the wood strip offset measurement.

Model	Offset
Aristocrat™	2 1/4"
Aspen™	1 1/2"
Asprey®	1 1/2"
Aurora™/Aurora™ Plus	1 1/2"
Beaufort™	1 1/2"
Brittany®	1 3/8"
California Oak™	2 1/4"
Cary™	1 1/2"
Colonial™	1 1/2"
Concord™	1 1/2"
Crestview™	1 1/2"
Eclipse®	1 1/2"
Fantasy IV®	1 1/2"
Golden Oak™	2 1/4"
Majestic™	2"
Matrix™	1 1/2"
Oak Fantasy®	2 1/4"
Pacifica®	1 1/2"
Royal Maple™	2 1/4"
Royal Oak®	2 1/4"
Savoy™	1 1/2"
Serenity™	1 5/8"
Sequoia®	1 1/2"
Silhouette®	1 1/2"
Style Lite®	1 5/8"
Tranquility™	1 5/8"
Trim Line®	1 1/2"
Tudor®	1 1/2"
Tundra™	1 1/2"
Wilmington™	1 1/2"
York™	1 1/2"

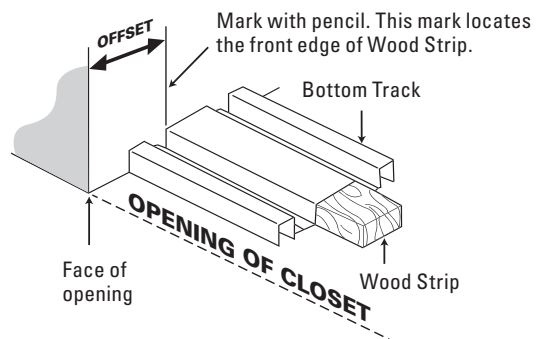

**Figure 2**

**E.** Place the front of the Wood Strip up to the pencil mark on wall (See **Figure 3**). Do this on both sides. Install the Wood Strip.

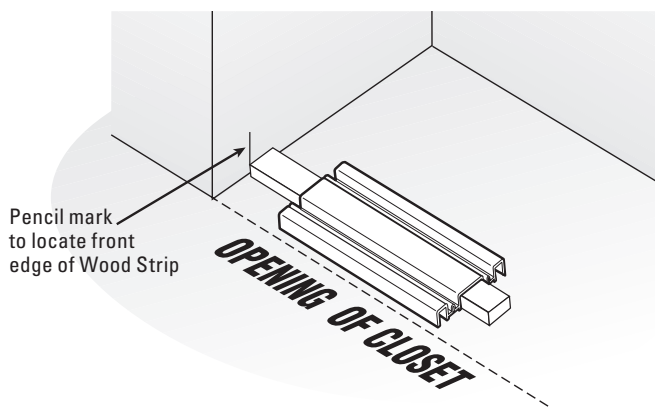

**Figure 3**

**F.** Cut the Bottom Track to your measurement of the inside closet opening. Place the Bottom Track over the Wood Strip and attach with four #8 x 1/2" Screws.

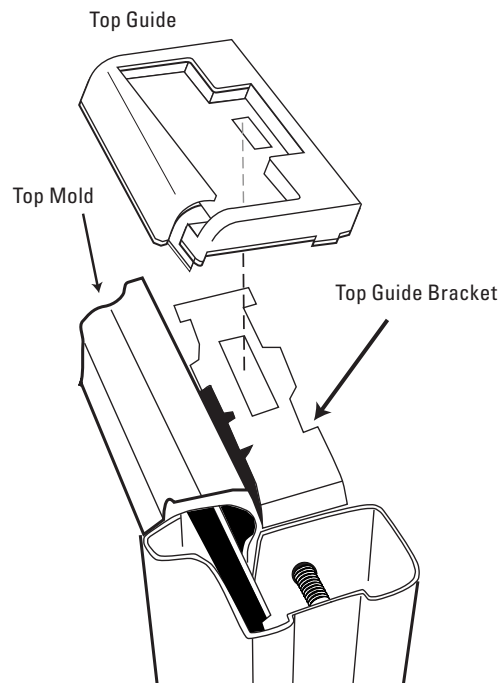

**Figure 4**

**C.** Pick up one Door Panel and, with the front side facing you, tilt the top of the Door Panel back and slip the Door Panel into the back runner of the Top Channel. Next, set the bottom of the Door Panel into the back runner of the Bottom Track.

**D.** For the front Door Panel, repeat C, but place the Door Panel into the front runner of the Top Channel and the front runner of the Bottom Track.

## Step 4 Installing the Door Panels

**A.** Make sure you have a pad or blanket to protect the Door Panels from scratches. Lay the Door Panels on the floor with the back side up. Locate one of the Wheel Assemblies on the bottom of a Door Panel. With a Phillips screwdriver, turn the adjusting screw clockwise to lower the roller. Do this until you have 3/4" of roller showing. Adjust both Wheel Assemblies on each Door Panel (This will avoid scratching the Bottom Track when installing the Door Panels).

**B.** For Aspen™, Beaufort™, Cary™, Colonial™, Savoy™, Tundra™, Wilmington™, and York™ models, insert Top Guide into Top Guide Bracket on top of Door Panels by firmly snapping into place (See **Figure 4**).

**Note:** Top Guides can be found in a bag attached to the back of each Panel.

## Step 5 Adjusting the Door Panels

### A. For models with exposed Wheel Assemblies

Slide the front Door Panel to the side closest to the room's entrance door (this is how the wardrobe doors will be in position to look their best). Look at the space between the door edge and the wall. You want the door edge and the wall to be flush. If you see space at the top or bottom edge of the Door Panel, turn the adjusting screw on top of the Wheel Assembly on the back of the Door Panel nearest the wall (See **Figure 5**). Turn the screw counterclockwise or clockwise until the Door Panel aligns flush with the wall. Repeat for each Door Panel.

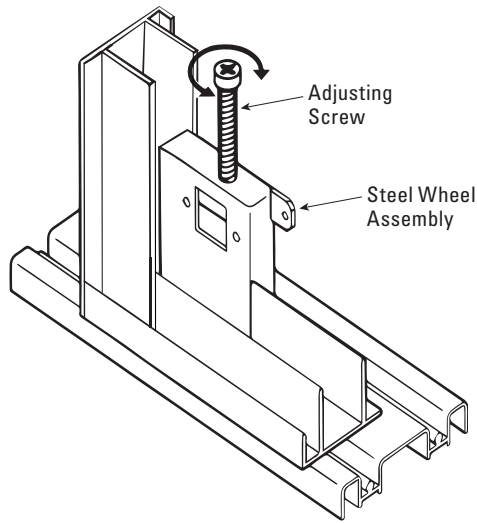

**Figure 5**

**B. For models with concealed Wheel Assemblies (Eclipse® and Silhouette®)**

If you see space at the top or bottom edge of the Door Panel, turn the adjusting screw through the adjustment hole at the bottom of the Door Panel nearest the wall. Turn the screw counterclockwise or clockwise until the Door Panel aligns flush with the wall. Repeat for each Door Panel (See **Figure 6**).

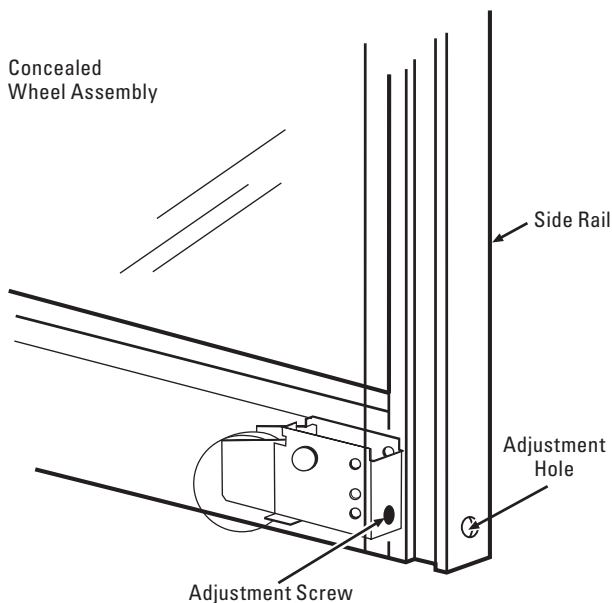
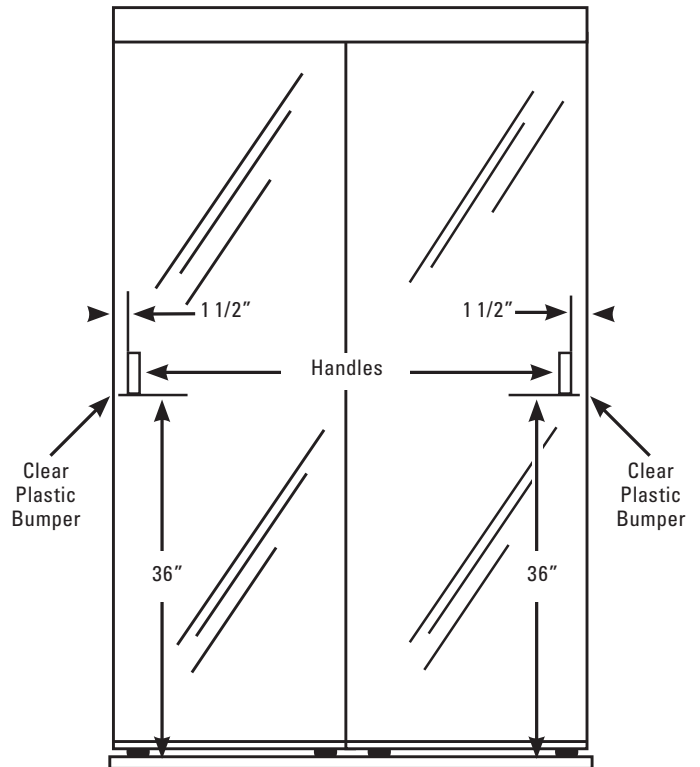

**Figure 6**

**Step 6 Installing the Mirror Handles**

**For Door Panels with Mirror Handles (Asprey®, Aurora™, Brittany®, Fantasy IV®, Style Lite® and Trim Line®)**

**A.** Clean Mirror in the area where the Mirror Handles will be applied. Peel film off the back of the Mirror Handles. Position each Mirror Handle 36" from the bottom of the Door Panel and 1-1/2" from the Side Mold on each Door Panel (See **Figure 7**).



**Figure 7**

**B.** If there are three Door Panels, place one Mirror Handle on the left side of the center Door Panel, and another Mirror Handle on the right side of the center Door Panel.

## Step 7 Installing the Bumpers

A. Peel film off the back of the Clear Plastic Bumpers and place on the edge of the Door Panel frame 36" up from the bottom of the Door Panel. The Clear Plastic Bumpers will cushion and protect the door and wall when you close the wardrobe doors (See **Figure 7**).

B. For **Eclipse®**, insert the top and bottom Bumpers by aligning the holes and firmly pressing them into place (See **Figure 8**).

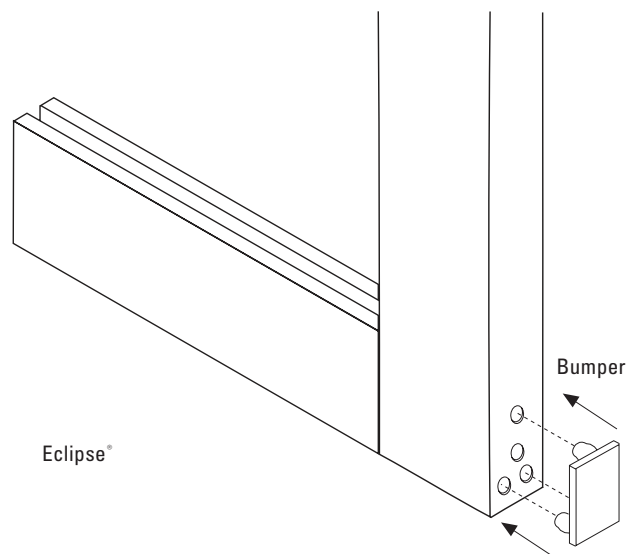

Figure 8

## Cutting and Installing a Mirror/Painted Glass Fascia

For your convenience, the Fascia comes with pre-applied two-way tape. Please follow these simple step-by-step instructions for a successful installation.

### Helpful hints and cautions to remember when installing your Mirror Fascia:

- The working temperature should be between 65° and 95° Fahrenheit. Always handle mirror with extreme caution, as it is glass and could easily cut you.

- For an installation where a flush Fascia is desired (an installation where the Fascia will be flush with the wall when complete), install the track and channel for your wardrobe doors an additional 1/4" back (from the normal dimension shown on the offset measurement chart, above) into the opening.

- When measuring and cutting the Fascia, it is always better to cut the Fascia slightly shorter than the desired length, as a tight fitting Fascia may chip or break if you attempt to force it into place.

A. Once you have installed your wardrobe doors, measure the length of the top channel for the desired length of your Fascia (for an installation where a flush Fascia is desired, set back the track and channel an additional 1/4" into the opening/closet to allow for the thickness of the Fascia).

B. Using a crayon or grease pencil, mark a fine line indicating where to cut the Fascia.

C. Place the fascia on a flat surface, face side up. Hold a ruler across the fascia to use as a cutting guide.

D. Hold the glass cutter as you would a pencil and, using the ruler as a guide, firmly score across the face of the fascia.

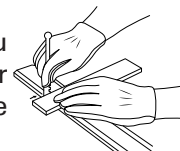

E. Check to make sure that the cut line shows clearly across the entire Fascia. If not, repeat Step D.

F. Position a pencil directly underneath the score mark and, using even pressure, push downward on each side of the mark until the Fascia breaks along the cut.

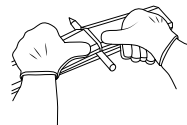

G. After the top channel has been installed, but before you install the Fascia, clean and dry the face of the top channel with glass cleaner to ensure proper adhesion.

H. After you have cut the Fascia, remove the backing on the two-way tape on the back of the Fascia (Caution: Be sure to remove all of the tape and avoid touching the backing to ensure complete adhesion).

I. Before you adhere the Fascia to the top channel, make sure the adhesive strip is on the top. The thickness of the foam adhesive strip will compensate for the “bump” which runs along the bottom of the top channel.

J. Position the Fascia to cover the top channel. Once you are satisfied with the location, press firmly. Continue to press firmly along the entire length of the Fascia until you are sure that it has properly adhered along the channel.

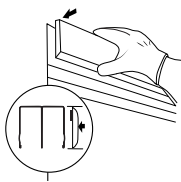

Thank you for making Cw® a part of your home. For additional inspiration and to learn more about our extensive line of products, we invite you to visit our website at [CwDoors.com](http://CwDoors.com).



[cwdoors.com](http://cwdoors.com)



[cwdoors.com](http://cwdoors.com)

# CwDoors.com

