

1000 WATT FOG MACHINE

USER MANUAL

USA/ États-Unis 1004189173



FOR INDOOR USE ONLY

DON'T USE IT AS A TOY

IMPORTANT SAFETY INSTRUCTION

READ AND SAVE THESE INSTRUCTIONS FOR FUTURE REFERENCE

IMPORTANT TIPS:

- The fog machine needs time to warm up before it can produce fog. Flip the O/I switch above the (C) Power Cable to start the warming process, this may take 3-5 minutes. The fog machine will be ready to produce fog when the light on the (B) Fog Switch activates. When filled with 1 liter of fog liquid, the fog machine will run for approximately 100 minutes before running out of fog liquid. Refill when fog liquid has been depleted.
- To produce fog, wait until the indicator light on the (B) Fog Switch is on, then flip the (B) Fog Switch to "I". Fog will flow until the fog machine needs to warm up again. To stop the fog early, flip (B) Fog Switch to "O".
- After each fog blast, the fog machine will need to warm up again. This can take 1-2 minutes. The fog machine will be ready to produce more fog when the light on the (B) Fog Switch lights up again.
- If you have any broken or missing parts, please contact SVI customer service from 8:30am to 5:30pm PST at 1-855-428-3921, email customerservice@svius.com, or call The Home Depot customer service at 1-855-HDHOLIDAY (1-855-434-6543) before returning to the store.
- Always make sure there is enough (E) Home Accents Holiday Fog Liquid in the tank before using the fog machine.

PARTS LIST

- A. Fog Machine
- B. Fog Switch
- C. Power Cable
- D. Cap
- E. Home Accents Holiday Fog Liquid (not included)
- F. Handle
- G. Handle Screw (2 Pieces)

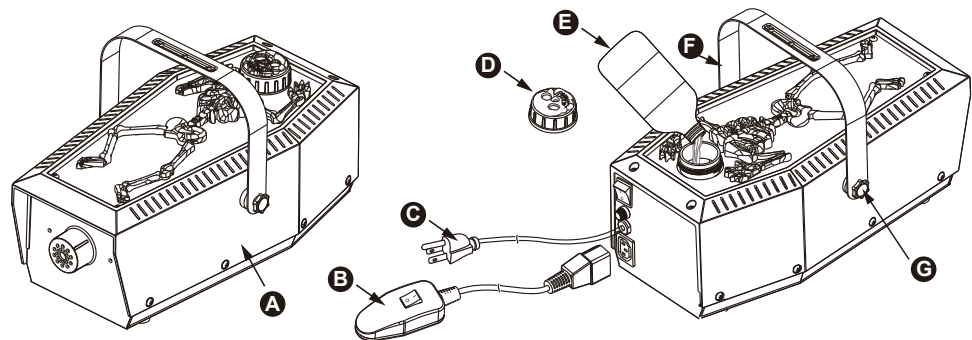

INSTRUCTION

1. Fasten the (F) Handle to the (A) Fog Machine by using the (G) Handle Screws.
2. Unscrew (D) Cap and add (E) Home Accents Holiday Fog Liquid, do not spill or fill with more than a liter of fog liquid.
3. Replace (D) Cap then plug (B) Fog Switch into (A) Fog Machine.
4. Plug (A) Fog Machine into outlet, activate the warming process by flipping the O/I switch on the (A) Fog Machine. Wait until (B) Fog Switch lights up, then activate with O/I switch to activate fog only when the (B) Fog Switch light is on. When the (B) Fog Switch is toggled "I", the fog will flow until the (B) Fog Switch light turns off. The light will turn on again in 1-2 minutes after the (A) Fog Machine has warmed up again.
Use a Home Accents Holiday Fog Timer (sold separately) to adjust the duration and frequency of each fog blast.

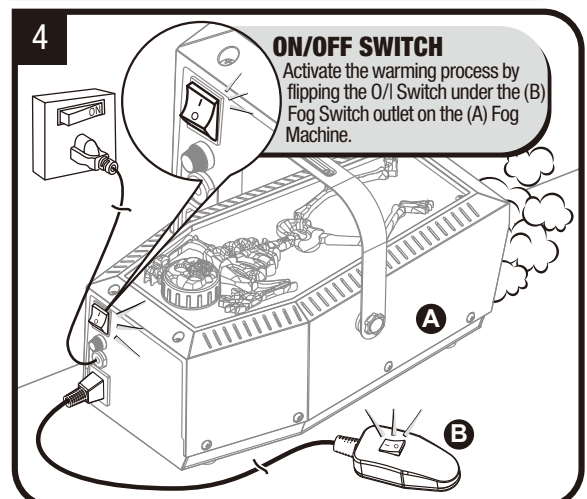
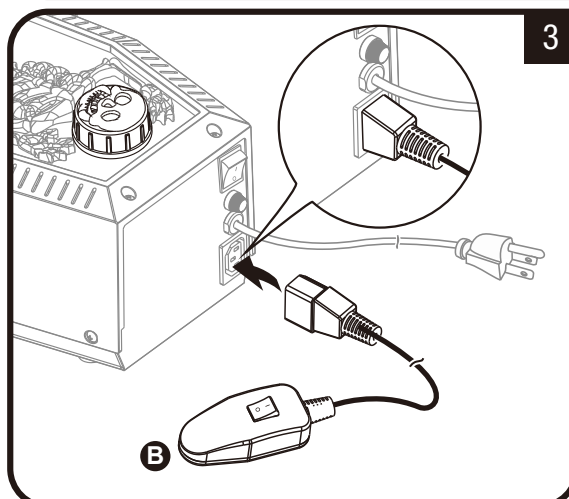
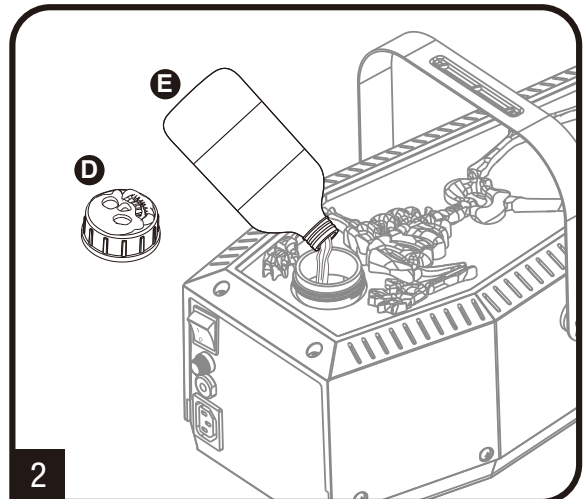
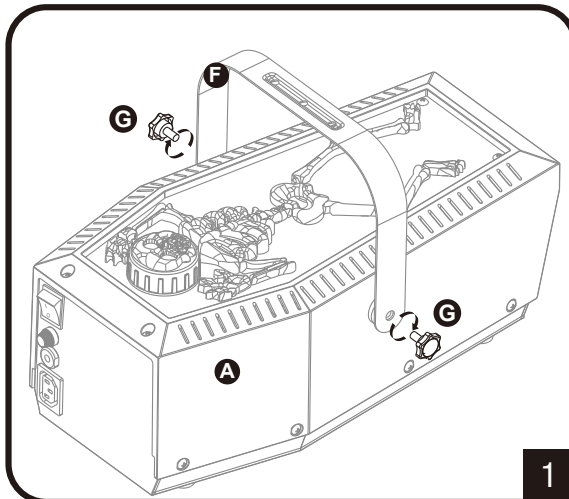

1. The two 'screws' near the bottom of the fog tank reservoir are actually sensors that will automatically stop the fog machine from functioning if the fog liquid lever drops below the sensor.

2. When adding fog liquid, the liquid level must exceed the position of the sensors so the machine can function properly. When the fog liquid level dips below one of these sensors, the machine will automatically stop. When this happens, more fog liquid should be added to bring the liquid level above the sensors.

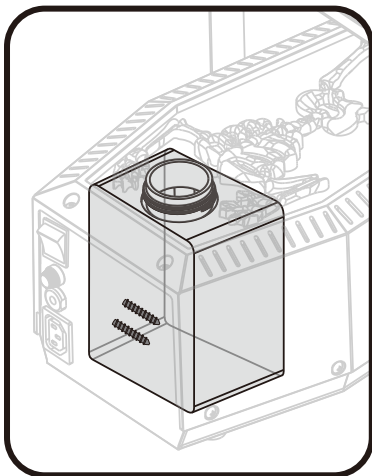

WARNING

To prevent risk of personal injury, fire, and electric shock.

- **Do not walk directly in front of the fog machine during and after operation.** Fog Liquid may condense on the surface directly in front of the dispenser creating a slippery surface and may cause injury. Use a dry cloth to clean the surface in front of the fog machine after operation. Place in an area with low foot traffic.
- Never leave unit unattended while plugged in. Unplug when not in use or refilling.
- Connect only to a properly grounded outlet.
- Place product on a flat, level HARD surface and connect the cord to prevent the product from overturning.
- For use only in covered areas. Keep unit dry, do not expose to rain or moisture.
- Leave enough space for good ventilation. Keep unit cool and away from other objects.
- Use only with Home Accents Holiday Fog Liquid (sold separately).
- Do not operate unit without Home Accents Holiday Fog Liquid.
- Pour Home Accents Holiday Fog Liquid carefully to avoid spills which could result in electric shock. Do not use if liquid spills onto unit. Let unit dry completely before plugging in.
- Do not overfill the liquid.
- Keep away from flames and flammable/explosive substances to avoid fire or explosions. Never pour flammable liquids such as gas, perfume etc. into the fog machine.
- Keep product and Home Accents Holiday Fog Liquid out of reach of children. Use only under adult supervision.
- Do not spray in the direction of flames or people. Stay at least 20 inches (50cm) from the nozzle at the front of the unit.
- Do not obstruct the nozzle.
- Do not open unit. No user serviceable parts inside, please refer to your vendor. Only an electrician can change the power cord.
- Clean unit before storage to avoid damages.

CAUTION

- Risk of burn, fire or electric shock.
- Please read instruction manual before using.
- Don't immerse in liquid.
- Not for space heating purposes.
- Changes or modifications not expressly approved by the party responsible for compliance could void user's authority to operate the equipment.

FUSE REPLACEMENT

If the Fog Machine does not work at all when it is connected to the power socket, then it is probably that the fuse has been blown.

- Risk of electric shock and fire. Disconnect from power socket before replacing the fuse.
- Turn the fuse knob counterclockwise to reveal the fuse.
- Replace the fuse with the same size and type fuse: 10A, 125V
- Place fuse in cover and reinstall by turning clockwise. Be sure not to overtighten.

MAINTENANCE & SERVICING

Use of fog liquids other than Home Accents Holiday Fog Liquid are not recommended and may result in blockage, leakage, or other damage to the unit.

INSPECTION

Before each use, check unit for any cracks in the enclosure, remote control, cords, and plugs. Make sure there are no exposed wires. Do not use if any of the above conditions are found.

CLEANING

Should you experience low fog output after many hours of continuous operation or after the machine has been idle or in storage for a long time, it is recommended to run a cleaning solution through the system to prevent the accumulation of particles in the heating element.

- While the unit is unplugged and cool, empty all Home Accents Holiday Fog Liquid from the machine and replace with 300 ml of distilled water. Activate the machine as one would normally and allow to run for 5-10 minutes.
- Run unit in a well-ventilated area until 5-10 minutes has passed.
- Drain the distilled water from the tank. Cleaning is now complete. All fog machines are prone to clogging due to the consistency of Home Accents Holiday Fog Liquid and the high temperatures at which it vaporizes. However, a well-maintained machine should provide years of reliable use.

STORAGE

It is important to remove all fluid from the unit when storing for an extended period of time.

- When the unit is unplugged and cool, empty all Home Accents Holiday Fog Liquid from the machine. Plug in unit and allow to warm as usual.
- Before storage, it is recommended to follow the CLEANING procedure available in this instruction sheet.
- Run unit in a well-ventilated area for 10-seconds to confirm tank is empty and dry.
- Store on a flat, level surface. Keep in a well-ventilated, cool and dry location.

For best performance, operate unit for 10-minutes every 3 months. Follow the Operation Instructions and Storage instructions accordingly.

ADDITIONAL INFORMATION

- It is normal for condensation to appear on the nozzle of the Fog Machine.
- A small amount of fog may spray during or after operation.

TROUBLESHOOTING

Issue	Correction
Fog machine will not produce fog	<ul style="list-style-type: none">• Ensure there is sufficient Home Accents Holiday Fog Liquid in the tank.• Ensure the fog machine is plugged into a working outlet.• Ensure the fog machine has been given 3-5 minutes to heat up.• Ensure the fuse is not blown. Follow instructions under Fuse Replacement section of manual .
Fog machine will not produce constant fog, it stops and starts.	This is how the fog machine is supposed to work. You will need to wait for the machine to reheat between fog bursts.
Fog output is low	<ul style="list-style-type: none">• Try cleaning the machine (details in "Cleaning" section).• Ensure there is sufficient Home Accents Holiday Fog Liquid in the tank.
Missing parts	Please call customer service at 1-855-HDHOLIDAY (1-855-434-6543) so a replacement can be sent to you.
Still experiencing an issue	Please call customer service at 1-855-HDHOLIDAY (1-855-434-6543) for further assistance.

TECHNICAL SPECIFICATIONS

FOG MACHINE

Item Code: 21SV21868
Model #: FM1000-ASH
Rating Voltage: AC120V, 60Hz
Power: 1000W
Ambient Temperature: -10 ~ 45°C
Fuse: 10A, 125V
Preheat Time: 3 ~ 5 Minutes
Tank Capacity: 1.1 Liter
Dimensions: L411 × W211 × H250 mm
L16.1 × W8.3 × H9.8 inch