

# Installation Guide

## Regular Duty System Tips

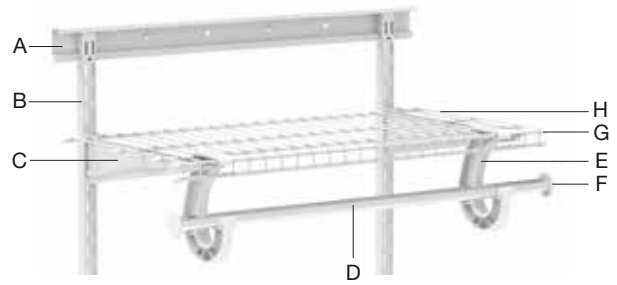

### Regular Duty System Components

- |                  |                               |
|------------------|-------------------------------|
| A. Hang Track    | E. Closet Rod Support Bracket |
| B. Vertical Rail | F. Closet Rod Endcap          |
| C. Shelf Bracket | G. Shelf Endcap               |
| D. Closet Rod    | H. Regular Duty Shelving      |

## 1 Choose Your Hardware

### STUDS

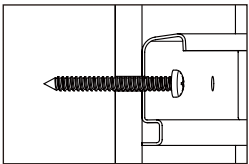

Secure to the wall with #12x2 in. panhead screws at stud locations.

### CONCRETE

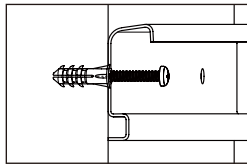

Drill 1/4 in. holes, insert 1/4 in. wall anchors and secure to the wall with #12x2 in. panhead screws.

### DRYWALL

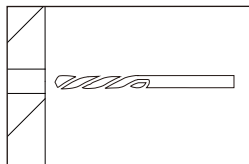

Drill a 1/2 in. hole in the drywall. If you hit a stud during drilling, use above stud hardware/instructions for each stud location.

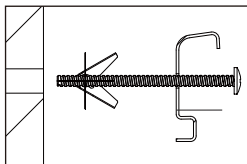

Insert bolt through hang track (or vertical rail/vertical rail joiner) then screw on 3/16 in. toggle. Install 3/16 in. toggles in each hole of the component you are attaching before attaching to the wall. Compress and pass the 3/16 in. toggles through the hole you drilled.

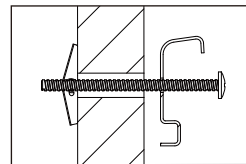

Allow the 3/16 in. toggle to spring apart behind the drywall.

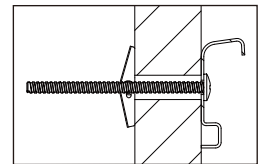

Screw the 3 in. bolt until tight to secure. Pull back on screw head for tension if 3/16 in. toggle is spinning behind wall. Install 3/16 in. toggles in each hole of components before attaching to wall.

## 2 Install Hang Tracks

- Determine your desired hang track configuration per your planned layout.
- Measure 84 in. from the floor and level the hang track. Use a pencil to mark each screw hole, marking at least every 16 in. apart (or closer) along hang track on the wall.

### 3 Install and Secure Vertical Rails

- Attach the vertical rails to the hang track slots as show in the diagram, utilizing a level to keep vertical rails straight/plumb. Ensure the center-to-center space is NO MORE than 24 in. apart and keep minimum space of 2 in. at the ends of the hang track.
- Determine the correct hardware to secure the vertical rail.

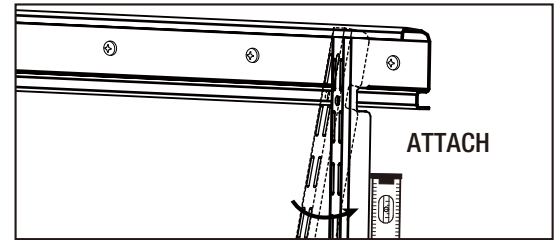

### 4 Install Brackets

- Insert shelf brackets to the vertical rails at your desired positions.

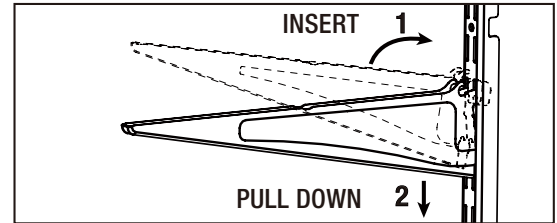

### 5 Install Shelves

- Make sure your shelves fit for your closet layout. Extra cuts may be required if shelves do not fit.
- Install shelf caps on the ends of the shelves.

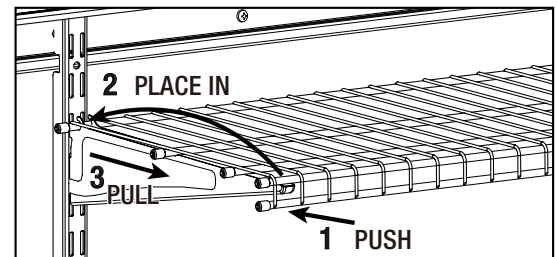

### 6 Install Rod Support Brackets and Rods

- Put the closet rod support bracket at an angle as the diagram shows and place the back part onto the horizontal rod. Max spacing between closet rod support brackets is 36 in. for the regular duty system.
- Place rod caps onto the ends of the rods and snap the rods into the rod support brackets.

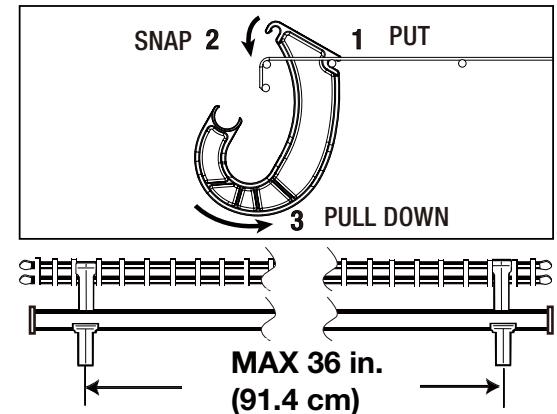

### Load Capacity

Maximum 45 lbs per linear foot (closet shelf and rod) / Maximum 20 lbs per linear foot for rod loading (when installed per manufacturer's instructions below):

- Drywall installation requires mounting into at least 1 stud.
- Drywall requirement for claimed load : ASTM C1396 Compliant, Minimun thickness 1/2 in.
- Maximum spacing between two vertical rails: 24 in. center-to-center spacing, as shown in "Plan Your Layout" section.
- Closet rod support bracket a maximum of 18 in. spacing.
- Installed per manufacturer's requirements.

### Warranty

This product is guaranteed to be free of defects in materials and workmanship for 2 years from the date of purchase. If this product is defective, call 1-800-305-1726 or return the product to the store from which it was purchased for a replacement. Guarantee does not include normal wear and tear.