









SYMMONS®  
the smart choice™

Location:



9601-PLR  
Shower System  
**Specification Submittal**

Specification	Modifications
<p>Shower system powered by the Temptrol® Pressure Balancing valve. Shower system shall include adjustable stop screw to limit handle turn, 1 mode showerhead with easy to clean rubber nozzles and standard 2.5 gpm (9.5 L/min) flow restrictor. Components shall be made from metal and nonmetallic construction, plated in standard polished chrome finish.</p> <div style="text-align: right;">   </div>	<ul style="list-style-type: none"> <li><input type="checkbox"/> <b>CG</b> -1.5 1.5 gpm (5.7 L/min) flow restrictor</li> <li><input type="checkbox"/> -2.0 2.0 gpm (7.6 L/min) flow restrictor</li> <li><input type="checkbox"/> -143 3 mode showerhead in place of standard head</li> <li><input type="checkbox"/> -145 5 mode showerhead in place of standard head</li> <li><input type="checkbox"/> -231 Super showerhead in place of standard head</li> <li><input type="checkbox"/> -295 Institutional showerhead (chrome only)</li> <li><input type="checkbox"/> -B Brass escutcheon (chrome only)</li> <li><input type="checkbox"/> -CHKS Integral check stops - for use in installations where a positive shut-off device is used downstream of mixing valve</li> <li><input type="checkbox"/> -D Brass dome cover (chrome only)</li> <li><input type="checkbox"/> -IPS 1/2" female IPS connections</li> <li><input type="checkbox"/>  -LAM Lever handle</li> <li><input type="checkbox"/>  -LP Loop handle</li> <li><input type="checkbox"/> -L/HD Less showerhead</li> <li><input type="checkbox"/> -OP 13" oval plate (PLR only)</li> <li><input type="checkbox"/> -REB Rebuild trim kit, includes TA-10 and TA-4</li> <li><input type="checkbox"/> -REV Reverse coring, hot on right, cold on left, for back to back installations</li> <li><input type="checkbox"/> -VP Vandal resistant escutcheon screws in place of standard screws</li> <li><input type="checkbox"/> -X Integral service stops - allows water shutoff at valve for service</li> </ul>
<p><b>Model Numbers</b></p>	
<ul style="list-style-type: none"> <li><input type="checkbox"/> <b>9601-PLR</b> <i>Origins shower system</i></li> <li><input type="checkbox"/> <b>9601-PLR-TRM</b> <i>Origins shower, trim only</i></li> <li><input type="checkbox"/> <b>46-2-BODY</b> <i>Temptrol Pressure Balancing tub/shower valve body</i></li> <li><input type="checkbox"/> <b>46-2X-BODY</b> <i>Temptrol Pressure Balancing tub/shower valve body with stops</i></li> </ul>	
<p><b>Finish Options</b></p>	
<ul style="list-style-type: none"> <li><input type="checkbox"/> <b>-STN</b> <i>Satin Nickel finish</i></li> </ul>	
<p><b>Compliance</b></p>	
<p>-ASME A112.18.1/CSA B125.1 -WaterSense 1.5 gpm (5.7 L/min) 2.0 gpm (7.6 L/min)</p>	<div style="text-align: right;">   </div>
<p><b>Warranty</b></p>	
<p><b>Limited Lifetime</b> - to the original end purchaser in consumer/residential installations. <b>5 Years</b> - for industrial/commercial installations. Refer to <a href="http://www.symmons.com/warranty">www.symmons.com/warranty</a> for complete warranty information.</p>	<p><b>Note:</b> Append appropriate -suffix to model number.</p>

## Dimensions

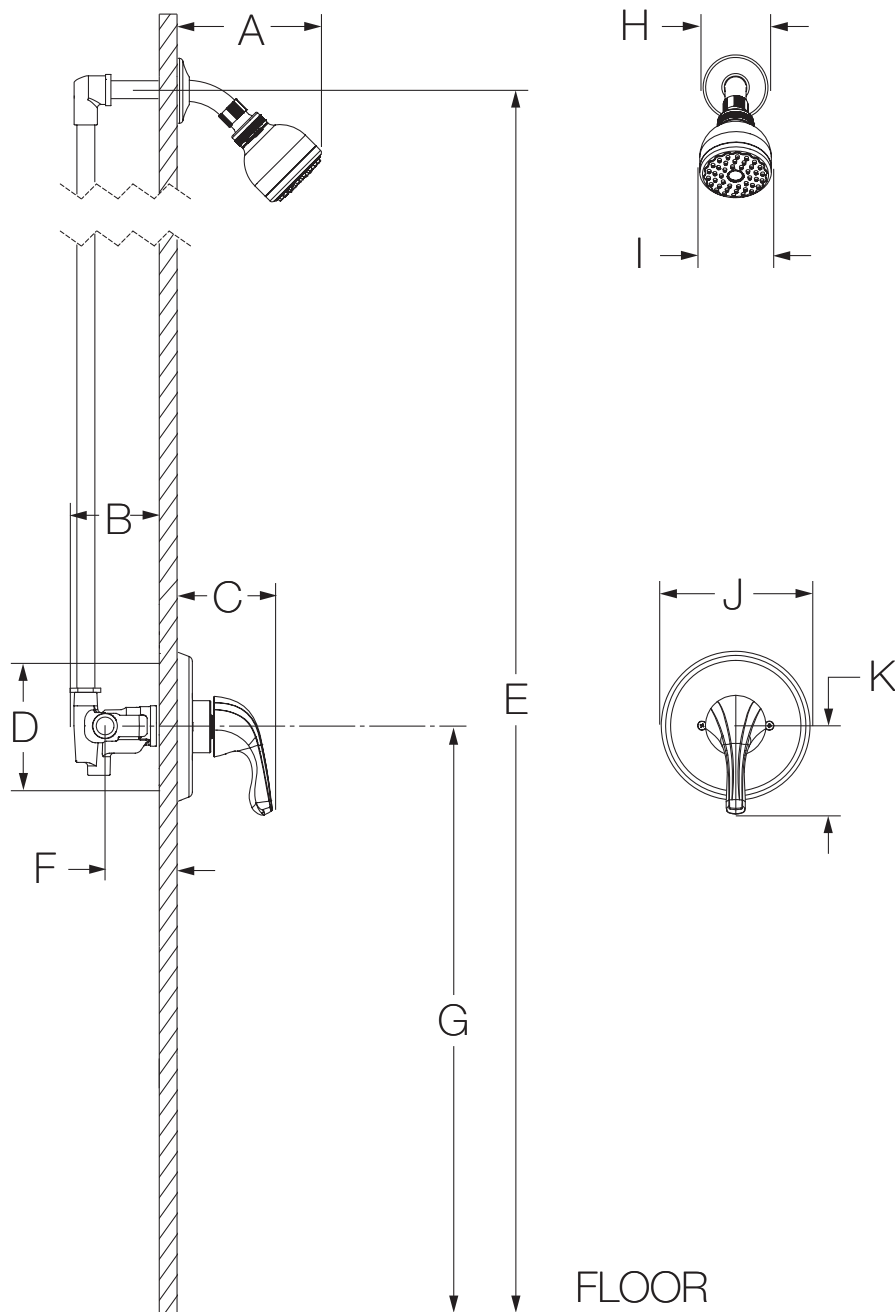







Measurements	
A	6-3/8", 162 mm
B	3-1/2", 89 mm
C	3-5/8", 92 mm
D	Shower Valve Hole Size Min. Ø 3", 76 mm Max. Ø 4", 102 mm
E	Ref. 77", 1956 mm
F	Rough-in 2-3/8" ± 1/2", 60 mm ± 13 mm
G	Ref. 42", 1067 mm
H	Ø 2-1/2", 64 mm
I	Ø 2-3/4", 70 mm
J	Ø 5-3/4", 146 mm
K	3-3/8", 86 mm

### Notes:

- 1) All dimensions measured from nominal rough-in (see F as reference).
- 2) Dimensions subject to change without notice.



Spécification	Modifications
<p>Le système de douche comprend la vanne à pression autorégularisée Temptrol®. Figurer la vis d'arrêt réglable pour limiter le tournage de la poignée, 1 pomme de douche avec facile à nettoyer les buses en caoutchouc et réducteur de débit régulier de 2,5 gpm (9,5 L/min). Les composants sont faits de matériaux métalliques et non métalliques au fini chrome poli standard.</p> <div style="text-align: right;">   </div>	<ul style="list-style-type: none"> <li><input type="checkbox"/> <b>CG</b> -1.5 Régulateur de débit de 1,5 gpm (5,7 L/min)</li> <li><input type="checkbox"/> -2.0 Régulateur de débit de 2,0 gpm (7,6 L/min)</li> <li><input type="checkbox"/> -143 Pomme de douche à 3 modes</li> <li><input type="checkbox"/> -145 Pomme de douche à 5 modes</li> <li><input type="checkbox"/> -231 Super pomme de douche</li> <li><input type="checkbox"/> -295 Pomme de douche institutionnelle</li> <li><input type="checkbox"/> -B Vanne de la rosace chrome laiton</li> <li><input type="checkbox"/> -CHKS Valve d'arrêt intégrée</li> <li><input type="checkbox"/> -D Couvercle en dôme chrome laiton</li> <li><input type="checkbox"/> -IPS Raccords IPS femelles de 1/2 po</li> <li><input type="checkbox"/>  -LAM Poignée du levier</li> <li><input type="checkbox"/>  -LP Poignée de boucle</li> <li><input type="checkbox"/> -L/HD Sans pomme de douche</li> <li><input type="checkbox"/> -OP Assiette ovale 13 po</li> <li><input type="checkbox"/> -REB L'ensemble de remise en état de la finition, incluant TA-10 et TA-4</li> <li><input type="checkbox"/> -REV Corps central inversé our installations dos à dos</li> <li><input type="checkbox"/> -VP Des vis anti-vandalisme de la rosace remplacent les vis régulières</li> <li><input type="checkbox"/> -X Robinet d'interruption du service</li> </ul>
<p><b>Numéro de modèle</b></p>	
<ul style="list-style-type: none"> <li><input type="checkbox"/> <b>9601-PLR</b> <i>Système de douche Origins</i></li> <li><input type="checkbox"/> <b>9601-PLR-TRM</b> <i>Garniture seulement de douche Origins</i></li> <li><input type="checkbox"/> <b>46-2-BODY</b> <i>Pression autorégularisée Temptrol</i></li> <li><input type="checkbox"/> <b>46-2X-BODY</b> <i>Pression autorégularisée robinet d'interruption du service Temptrol</i></li> </ul>	
<p><b>Options de finition</b></p>	
<ul style="list-style-type: none"> <li><input type="checkbox"/> <b>-STN</b> <i>Fini nickel satiné</i></li> </ul>	
<p><b>Conforme</b></p> <p>-ASME A112.18.1/CSA B125.1 -WaterSense 1.5 gpm (5.7 L/min) 2.0 gpm (7.6 L/min)</p> <div style="text-align: right;">   </div>	
<p><b>Garantie</b></p> <p><b>À vie limitée</b> - à l'acheteur original dans les installations du consommateur ou résidentielles. <b>5 ans</b> - pour des installations commerciales et industrielles. Se reporter au site <a href="http://www.symmons.com/warranty">www.symmons.com/warranty</a> (en anglais) pour l'information complète concernant la garantie.</p>	

**Remarque:** Juxtaposer le -suffixe approprié au numéro de modèle.

## Dimensions

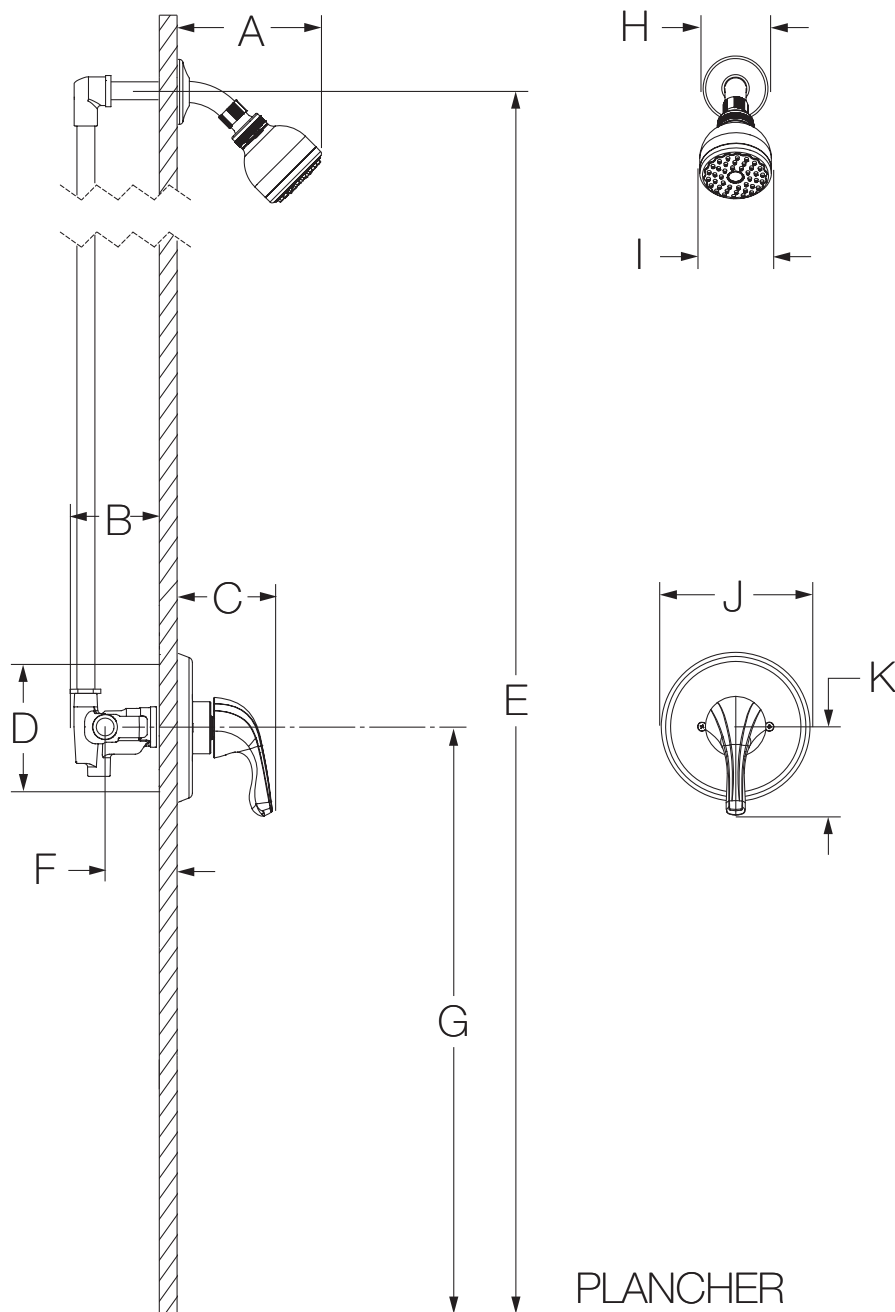

Mesures	
A	6-3/8 po, 162 mm
B	3-1/2 po, 89 mm
C	3-5/8 po, 92 mm
D	Taille du trou Min. Ø 3 po, 76 mm Max. Ø 4 po, 102 mm
E	Réf. 77 po, 1956 mm
F	Robinetterie brute 2-3/8 po ± 1/2 po, 60 mm ± 13 mm
G	Réf. 42 po, 1067 mm
H	Ø 2-1/2 po, 64 mm
I	Ø 2-3/4 po, 70 mm
J	Ø 5-3/4 po, 146 mm
K	3-3/8 po, 86 mm

### Remarques:

- 1) Toutes les dimensions sont mesurées à partir de la robinetterie brute nominale (voir F en référence).
- 2) Les dimensions sont sujettes à changer sans préavis.