

STEEL CLEVIS HANGER, STANDARD DUTY

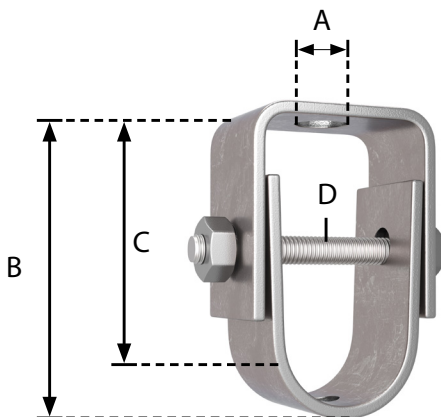

- Safely secures hanging or elevated pipes
- Durable electro zinc plated carbon steel
- Design allows for lateral and angular misalignment
- Designed for quick vertical adjustment
- Complies with SP-69 standards
- Simple installation



Part No.	Size	Rod Size	Max. Load	A	B	C	D
H68050	0.50"	0.37"	610 lbs	0.38"	2.88"	2.38"	0.25"
H68075	0.75"	0.37"	610 lbs	0.38"	3.19"	2.56"	0.25"
H68100	1"	0.37"	730 lbs	0.38"	3.38"	2.69"	0.25"
H68125	1.25"	0.37"	730 lbs	0.38"	3.75"	2.75"	0.25"
H68150	1.50"	0.37"	730 lbs	0.38"	4.06"	3.06"	0.25"
H68200	2"	0.37"	730 lbs	0.38"	4.50"	3.25"	0.25"
H68250	2.50"	0.50"	1350 lbs	0.50"	5.50"	4.06"	0.38"
H68300	3"	0.50"	1350 lbs	0.50"	6.13"	4.31"	0.38"
H68350	3.50"	0.50"	1350 lbs	0.50"	6.75"	4.69"	0.38"
H68400	4"	0.62"	1430 lbs	0.50"	7.63"	5.31"	0.38"
H68500	5"	0.62"	1430 lbs	0.63"	8.88"	6.06"	0.50"
H68600	6"	0.75"	1940 lbs	0.75"	10.00"	6.63"	0.50"
H68800	8"	0.87"	2000 lbs	0.75"	12.75"	8.38"	0.63"