

TOSHIBA

SMART AIR CONDITIONER USER MANUAL

IMPORTANT NOTE

Read the manual carefully before installing or connecting your air conditioner. Make sure to save this manual for future reference.

User Manual

1	DECLARATION OF CONFORMITY	4
2	SPECIFICATION	4
3	PRECAUTIONS	4
4	SYSTEM OVERVIEW	5
5	DOWNLOAD AND INSTALL THE APP	6
6	CREATE YOUR ACCOUNT	7
7	SET UNIT TO ACCESS POINT MODE	9
8	NETWORK CONFIGURATION	10
9	HOW TO USE THE APP	18
10	SPECIAL FUNCTIONS	21



CAUTION

- This device complies with Part 15 of the FCC Rules and RSS 210 of Industry & Science Canada. Operation is subject to the following two conditions: (1) this device may not cause harmful interference, and (2) this device must accept any interference received, including interference that may cause undesired operation.
- Only operate the device in accordance with the instructions supplied. This device complies with FCC and IC radiation exposure limits set forth for an uncontrolled environment. In order to avoid the possibility of exceeding the FCC and IC radio frequency exposure limits, human proximity to the antenna shall not be less than 20cm (8 inches) during normal operation.
- Changes or modifications not expressly approved by the party responsible for compliance could void the user's authority to operate the equipment.



WARNING

This equipment has been tested and found to comply with the limits for a Class B digital device, pursuant to Part 15 of the FCC Rules. These limits are designed to provide reasonable protection against harmful interference in a residential installation. This equipment generates uses and can radiate radio frequency energy and, if not installed and used in accordance with the instructions, may cause harmful interference to radio communications.

However, there is no guarantee that interference will not occur in a particular installation. If this equipment does cause harmful interference to radio or television reception, which can be determined by turning the equipment off and on, the user is encouraged to try to correct the interference by one or more of the following measures:

- Reorient or relocate the receiving antenna.
- Increase the separation between the equipment and receiver.
- Connect the equipment into an outlet on a circuit different from that to which the receiver is connected.
- Consult the dealer or an experienced radio/TV technician for help.

1. DECLARATION OF CONFORMITY

We hereby declare that this AC is in compliance with the essential requirements and other relevant provisions of Directive 1999/5/EC.

2. SPECIFICATION

Model: OSK102

Standard: IEEE 802.11 b/g/n

Antenna Type: External omnidirectional Antenna

Frequency: 2.4 GHz (wireless)

Maximum Transmitted Power: 15 dBm Max

Dimensions: 55 x 24 x 8 (mm)

Operation Temperature: 0°C ~ 45°C / 32°F ~ 113°F.

Operation Humidity: 10% ~ 85%

Power Input: DC 5V/300 mA

3. PRECAUTIONS

1. Supports operating systems: iOS 7+ or Android 4+.
2. In the event of a OS update, there may be a delay between the update of the OS and a related software update during which your OS may or may not be supported until a new version is released. Your specific mobile phone or problems in your network may prevent the system from working and Toshiba will not be responsible for any problems that could be caused by incompatibility or network issues.
3. This Smart AC only supports WPA-PSK/WPA2-PSK (recommended) encryption. Please check the Toshiba Lifestyle website, us.toshiba-lifestyle.com, for updated information.
4. To ensure proper scanning of the QR code, your smart phone must have at least a 5-megapixel camera.
5. Due to unstable network connectivity, requests may time out. If this happens, re-run the network configuration.

-
- Due to unstable network connectivity, commands may time out. If this happens, the smartphone app and the actual product may display conflicting information. The information displayed on the actual product is always the most accurate available. Refresh the app to re-sync.

i NOTE

Toshiba will not be responsible for any problems that could be caused by incompatibility or network issues, your wireless router and mobile phone.

4. SYSTEM OVERVIEW

Devices required to use the Smart AC:

- Smart Phone with compatible iOS or Android system.
- Wireless Router
- Smart Air Conditioner

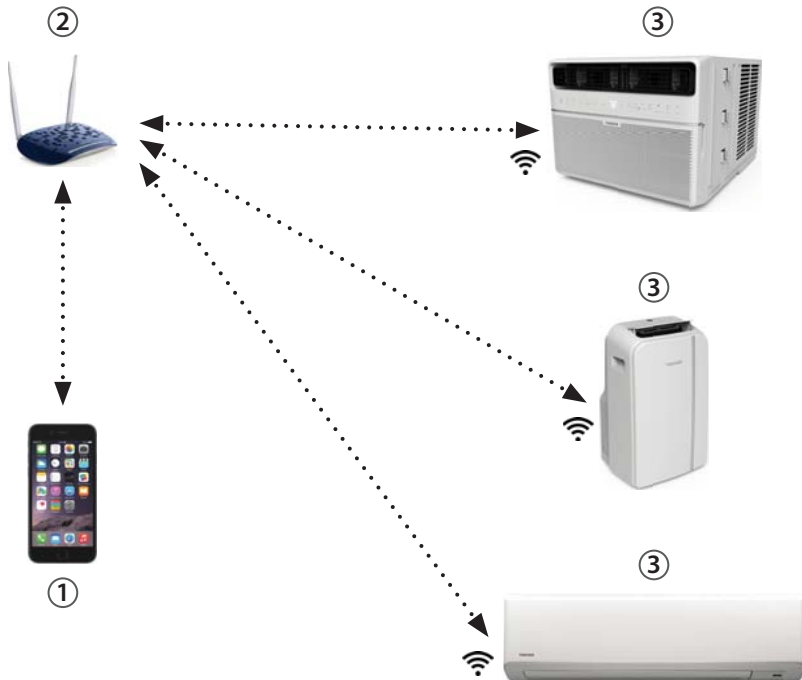

5. DOWNLOAD AND INSTALL THE APP

Android QR code



Apple QR code



Scan to download app.

- You can also go to Google Play or App Store and search for the latest compatible app. For more information, please refer to Toshiba Lifestyle website: us.toshiba-lifestyle.com.

NOTE

All the images in this manual are for reference only, your product and app may look slightly different. The actual product and app instructions and indications have to be considered.

6. CREATE YOUR ACCOUNT

- Make sure your smartphone is connected to your wireless router and your wireless router has a working internet connection.
- It is recommended to activate your account immediately to be able to recover your password by email.

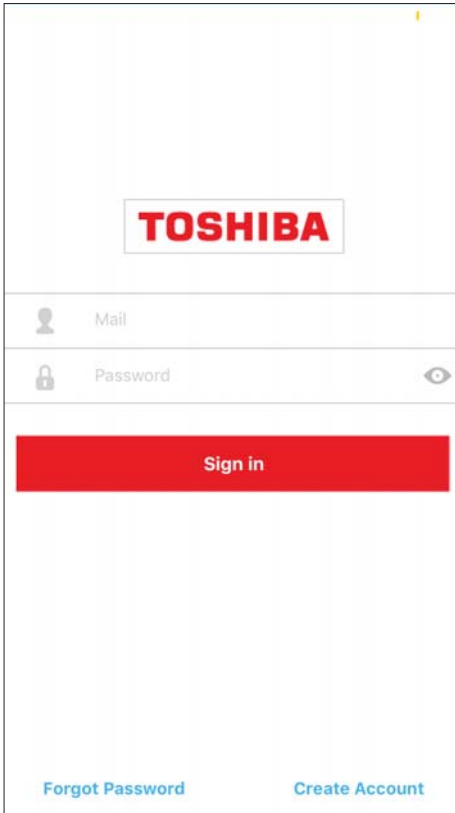

6.1 Press "Create Account".

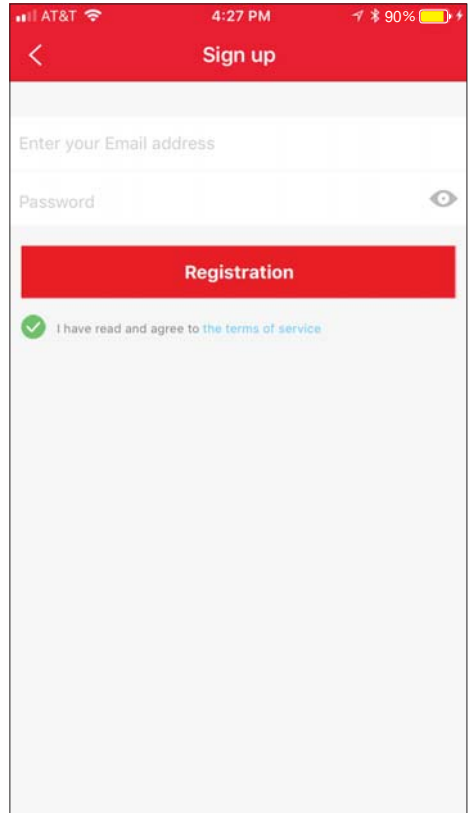

6.2 Enter your email address and password.

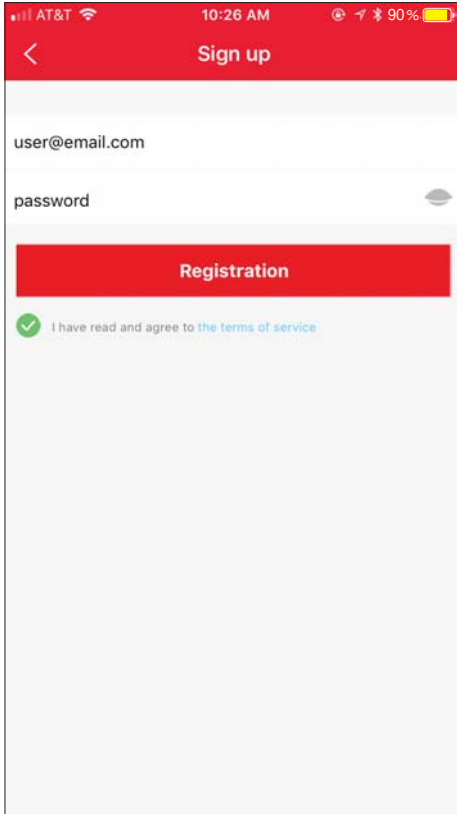

6.3 Press “Registration”.

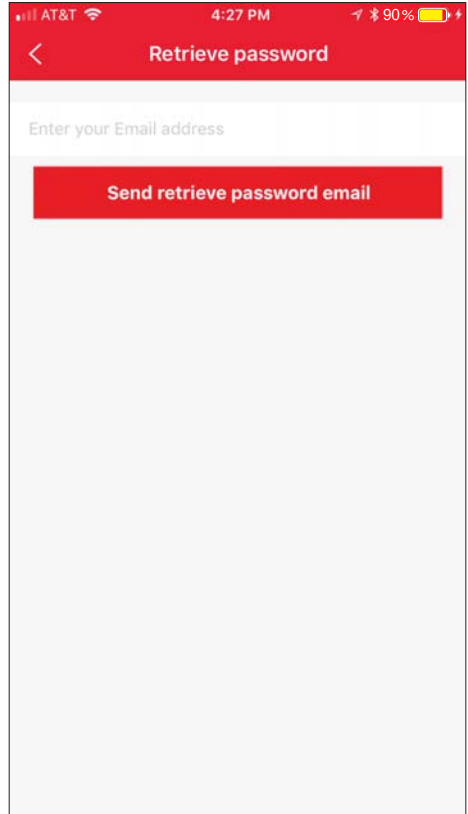

6.4 If you forget your password, press “Forgot password?” on the main menu and enter your email address. Then press “Send retrieve password email”.

NOTES

- Make sure your smartphone is able to connect to the wireless network which will be used.
- Make sure also that the device is not connecting to other networks in range.

7. SET UNIT TO ACCESS POINT MODE

Connect the unit to power supply, press and hold VENT ANGLE /SWING (on Portable AC) or WIFI/WIRELESS (on Window AC) buttons for 3-5 seconds. The unit will enter Access Point mode and the display will show "AP". Proceed to the next step.

NOTE

On units which include a remote control with an "LED" button, you can also use the remote controller by pressing the LED button 7 times.

NOTE

When the unit is in "AP" / Access Point mode, the remote controller is inactive. It is necessary to finish the network configuration, turn the AC off and on again or wait for 8 minutes for the unit to leave "AP" mode automatically.

8. NETWORK CONFIGURATION

8.1 Log in with your account.

8.2 Please press “+ Add Device” on the app’s “Home” screen.



8.3 Choose network configuration method

- **Scan QR Code method:**
 - For Android devices, please follow step 8.4 to complete configuration.
- **Setup Method:**
 - Please follow step 8.5 to complete configuration.

8.4 For Android (Scan QR code method)

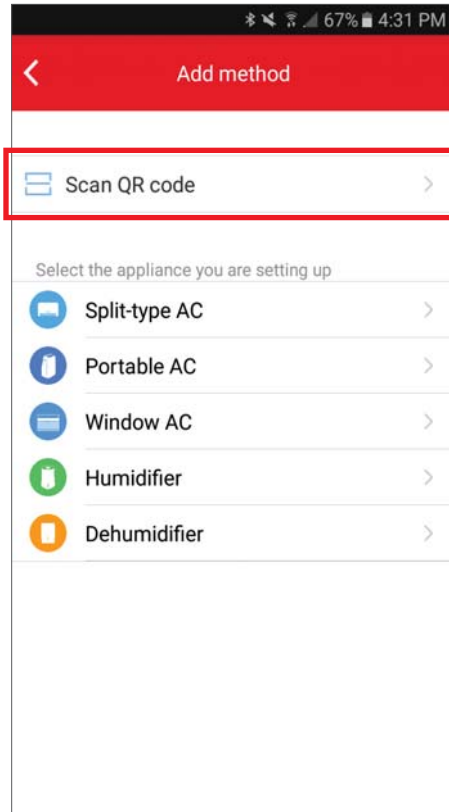

8.4.1 Press "Scan QR Code".



8.4.2 Scan the QR code found on the air conditioner.

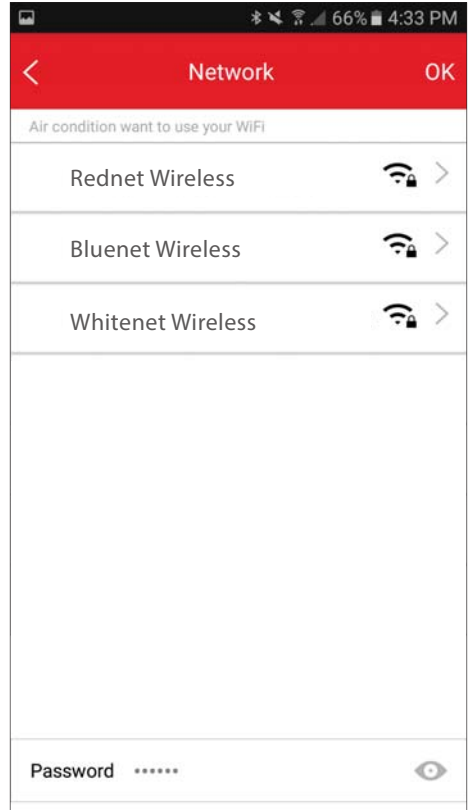

8.4.3 Select your preferred wireless network, enter your password, and press "OK".

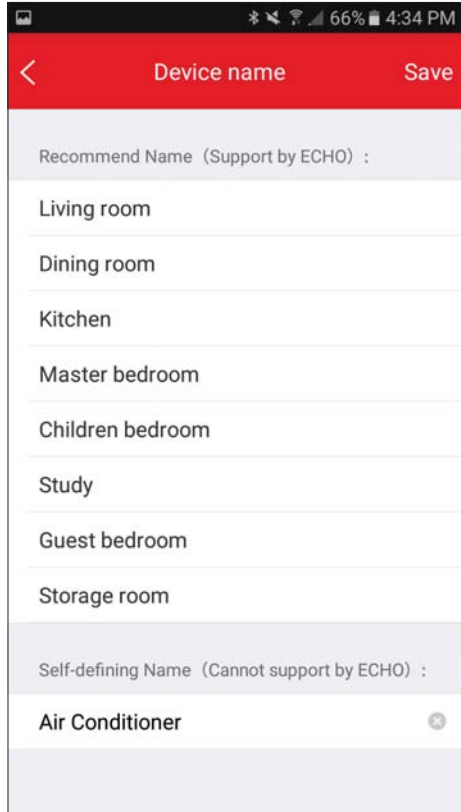

8.4.4 Name your unit.

8.5 Setup Method.

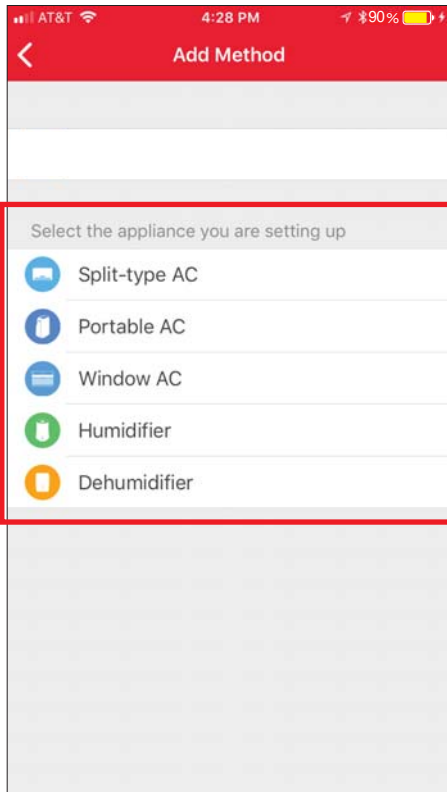

8.5.1 Select your AC type.



8.5.2 Turn the air conditioner on, then wait for 5 seconds before continuing.

Back Window AC Quit

WIFI TIMER SLEEP MODE

- Press and hold the "WIFI" button for more than 3 seconds until the device displays the word "AP", Then, click "Next"

Reminder: For special models, you need to refer to the product specification

2 / 4

Next

8.5.3 Press and hold VENT ANGLE/ SWING (on Portable AC) or WIFI/ WIRELESS (on Window AC) buttons for 3-5 seconds. The unit will enter Access Point mode and the display will show "AP".

Back Window AC Quit

WLAN

net_ac_xxxx

- Go to the phone's "WLAN" settings, use the password "12345678" to connect to the network "net_ac_xxxx"

Reminder: If "net_ac_xxxx" network is not found on the WLAN, check whether the device is in AP mode. If not, Try again

3 / 4

Next

8.5.4 Go to your phone's wireless network settings, connect to the network named "net_ac_xxxx", and use the password "12345678".

i NOTE

On Portable AC, you can also use the remote controller by pressing the LED button 7 times.



8.5.5 Return to the “Toshiba” App, select your preferred wireless network, and type in your password. Then press “Start Configuration”.

8.5.6 The app will show you the progress. If there is a failure, please check your network settings and unit and try again.

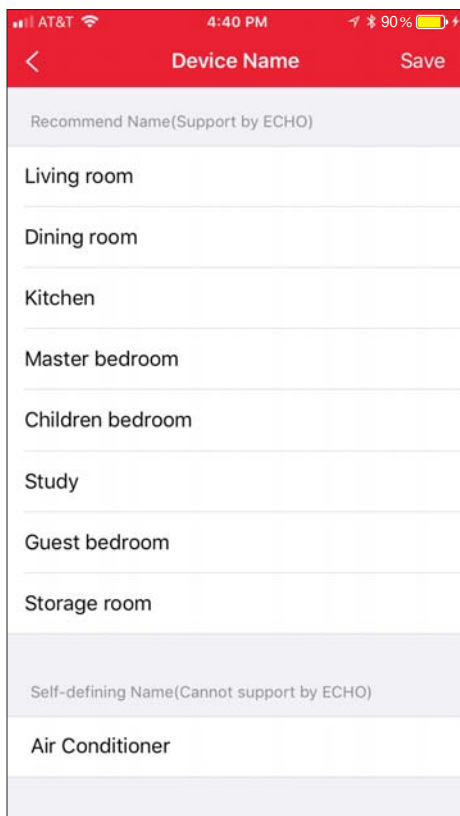

8.5.7 Name your unit.

NOTES

- When finishing network configuration, the app will indicate success by displaying a message.
- In unstable network connections, the products may still appear on the app as "offline". If this happens, wait for it to show up on the device list or turn the air conditioner's power off. After 30 seconds, turn the unit back on and wait a few minutes before checking again. If the unit is still offline, try the pairing process again.

9. HOW TO USE THE APP

Log in and select your unit to control it from wherever you are from your smart phone.

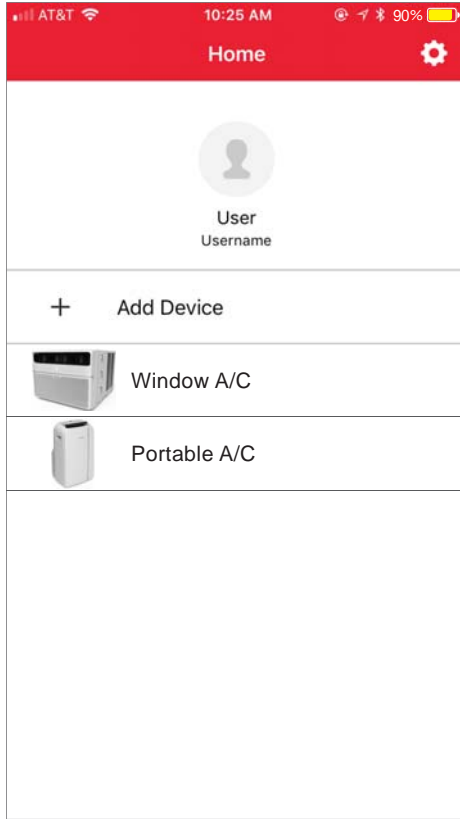

USING THE APP

①
BACK ARROW:
Use this arrow to take you back to the main screen.

②
UNIT NAME:
This is the name of the unit you are currently controlling.

③
FUNCTION:
Use this button to access functions such as the timer and sleep curve.

④
TEMPERATURE AND MODE DISPLAY:
This display shows what temperature and mode the air conditioner is set to.

⑤
FAN SPEED DISPLAY:
This display shows the current fan speed setting.

⑥
INDOOR TEMPERATURE:
This display shows the current temperature indoors.

⑦
POWER:
Use this button turn the unit on and off.



⑧
MODE:
Use this button to switch between modes. Modes include: AUTO, DRY, FAN, COOL, and HEAT.

⑨
FAN SPEED:
Use this button to switch between fan speeds. Fan speeds include: AUTO, LOW, MEDIUM, and HIGH.

⑩
TURBO:
Use this button to turn the TURBO mode on and off.

⑪
ECO:
Use this button to turn the ECO mode on and off.

⑫
HORIZONTAL SWAY:
Use this button to turn horizontal sway on and off.

⑬
VERTICAL SWAY:
Use this button to turn the vertical sway on and off.

⑭
DEGREES:
Use this button to change between degrees Fahrenheit and Celsius.

i NOTE

Every function may not be supported by your model. Please refer to your product's user manual for more details.



Auto mode



Cool mode



Dry mode



Fan mode

10. SPECIAL FUNCTIONS

Including: Timer on, Timer off, Sleep curve, Check, Energy monitor, Check body.

NOTE

Not all models display all functions. Please check your product's user manual for more details. If a function is not available, it will not be displayed on the function list in the app.

Timer on / Timer off

With this function, you can manually select what time you would like the air conditioner to turn on/off. Additionally, you can select which days you would like the timer to apply to.

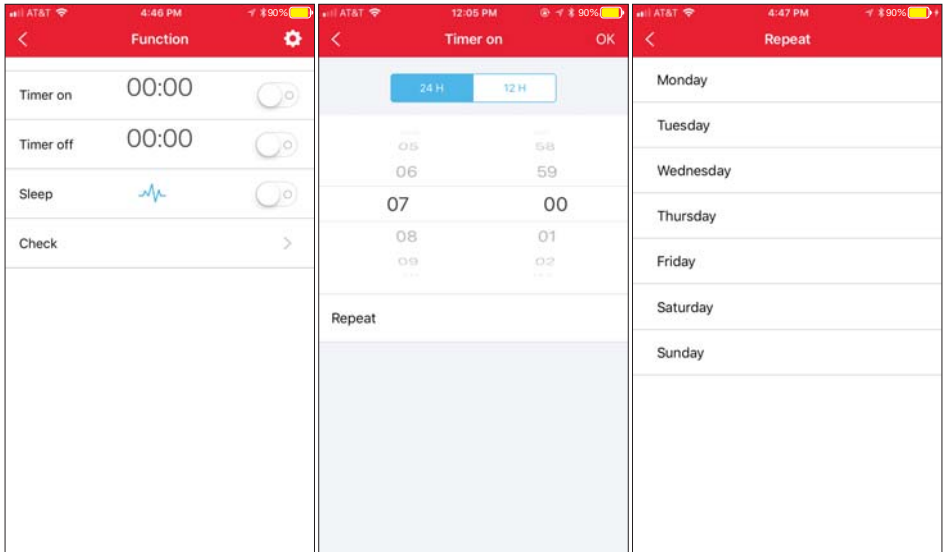

Customized Sleep Curve

With this function, you can customize your air conditioner's settings for each hour that you are asleep.



Self Diagnosis - "Check" Function

With this function, you can run a self-diagnosis. The app will show a report on key items and their status.

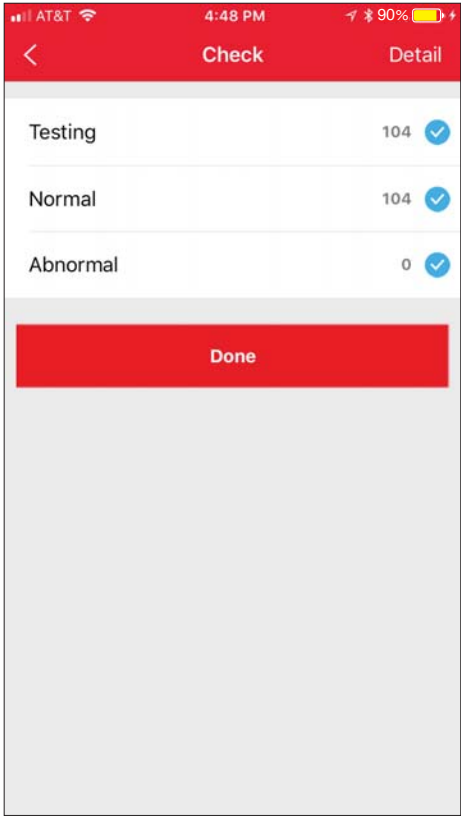

TOSHIBA