

INSTALLATION INSTRUCTIONS

PASSAGE™ 60" x 72" FRAMELESS SHOWER DOOR MODEL: AM801703400 SERIES

*American
Standard*

Thank you for selecting American Standard – the benchmark of fine quality for over 100 years. To ensure this product is installed properly, please read these instructions carefully before you begin. Certain installations may require professional help. Also be sure your installation conforms to local codes.

Visit <http://www.americanstandard-us.com/passage-collection> for coordinating products.

Visit https://youtu.be/GXpYwYBU_2c for step by step video instructions.

INSTALLATION PREPARATION









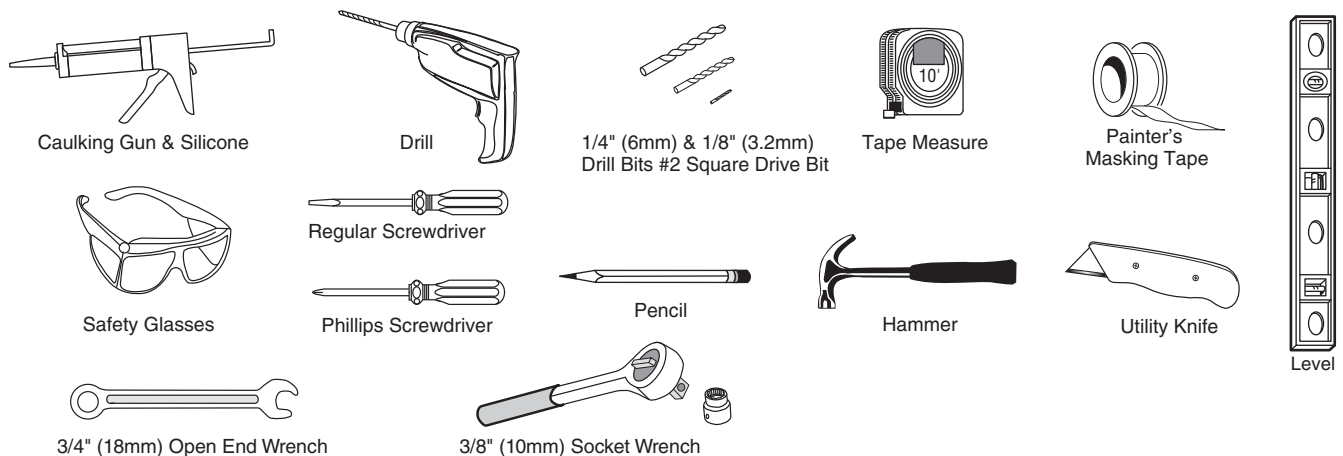







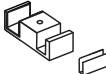



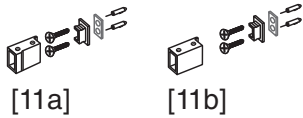

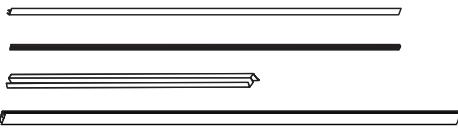
- Please unpack carefully and identify all parts needed for installation by using the Box Contents page as a reference. Inspect the product and report any damages or missing parts immediately to customer care by calling 800-442-1902. Follow the prompts for consumer/shower doors.
- These Passage shower doors were developed to be installed with the Passage shower base and Passage shower walls. If you are using a different base and walls, you may need additional hardware and tools to complete the installation.
- The Passage shower door dimensions are nominal and meant for a standard 60" (1524mm) alcove. Alcove sizes may vary based on stud and wall material thickness. Please double check your measurements prior to starting your install.
- Handle the glass panels carefully and protect the edges. Unequal pressure applied during installation can cause cracking or breakage, and the sharp corners on the glass panels can cause damage to the wall or floor materials.
- Ensure adequate wall support is provided to area where shower door is to be installed.
- Shower base and wall material must be installed prior to the door installation.
- Wear protective equipment during installation to avoid injury.
- Please keep these instructions for after care and customer service details.

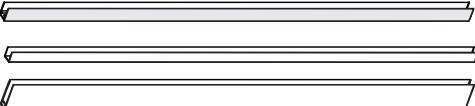
⚠ WARNING: Product is heavy and REQUIRES TWO PEOPLE for installation.

⚠ WARNING: TEMPERED GLASS CANNOT BE DRILLED, CUT OR MODIFIED.

REQUIRED TOOLS AND MATERIALS

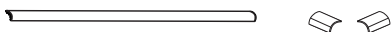

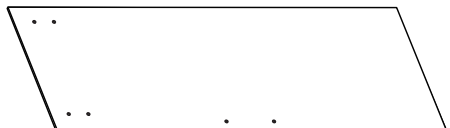
| BOX CONTENTS | | | |
|---|---|---|---|
| [1] 1x Horizontal Rail | ➔ |  |  |
| 1 Installation Instructions | ➔ | |  |
| [2] 1x Door Handle | ➔ |  |  |
| [3] 1x Pan Head Screw M4x35 [4] 1x Wall Anchor [5] 1x Screw Cover Cap [6] 1x Bottom Guide [7] 1x Shim | ➔ |  |  |
| [8] 2x Rollers | ➔ |  | |
| [9] 2x Fixed Panel Fasteners [10] 2x Door Panel Guards | ➔ |  |  |
| [11] 2x Wall Connectors [12] 2x Connector Base Mounts [13] 2x Cushions [14] 4x Wall Anchors [15] 4x Flat Head Screws M5x35 [33] 1x Limit Block | ➔ |  |  |
| [16] 1x Side Gasket [17] 1x Water Deflector [18] 1x Bottom Door Gasket [19] 1x Magnetic Seal | ➔ |  |  |
| [20] 1x Post [21] 1x Sliding Wall Post [22] 1x Fixed Wall Post | ➔ |  |  |
| [23] 7x Screws M4x35 [24] 7x Wall Anchors | ➔ | |  |
| [25] 3x Screws M4x10 [26] 3x Screw Cover Caps | ➔ | |  |
| [27] 4x Channel Shims [28] 1x U Channel | ➔ |  |  |
| [29] 1x Aluminum Seal [30] 2x Connectors | ➔ |  |  |
| [31] 1x Fixed Panel | ➔ | |  |
| [32] 1x Sliding Door Panel | ➔ | |  |

ASSEMBLY DRAWING

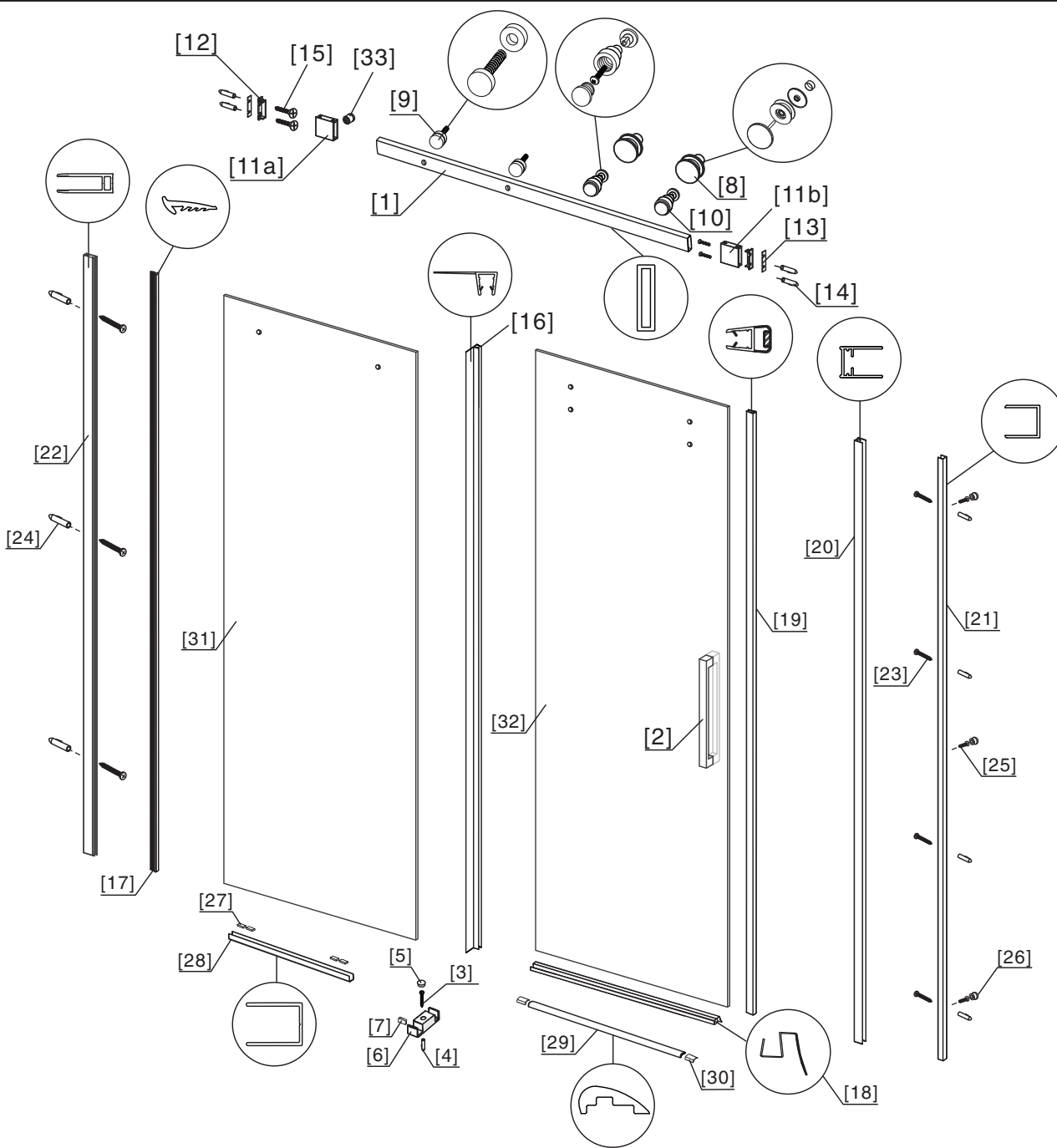

- | | | |
|------------------------------|-------------------------------|----------------------------|
| [1] 1x Horizontal Rail | [12] 2x Connector Base Mounts | [23] 7x Screws M4x35 |
| [2] 1x Door Handle | [13] 2x Cushions | [24] 7x Wall Anchors |
| [3] 1x Screws M4x35 | [14] 4x Wall Anchors | [25] 3x Screws M4x10 |
| [4] 1x Wall Anchor | [15] 4x Screws M5x35 | [26] 3x Screw Cover Caps |
| [5] 1x Screw Cover Cap | [16] 1x Side Gasket | [27] 4x Channel Shims |
| [6] 1x Bottom Guide | [17] 1x Water Deflector | [28] 1x U Channel |
| [7] 1x Shim | [18] 1x Bottom Door Gasket | [29] 1x Aluminum Seal |
| [8] 2x Rollers | [19] 1x Magnetic Seal | [30] 2x Connectors |
| [9] 2x Fixed Panel Fasteners | [20] 1x Post | [31] 1x Fixed Panel |
| [10] 2x Door Panel Guards | [21] 1x Sliding Wall Post | [32] 1x Sliding Door Panel |
| [11] 2x Wall Connectors | [22] 1x Fixed Wall Post | [33] 1x Limit Block |

1

In Step 1, we will cover attaching the connector base mounts and the wall posts for the stationary glass door panel.

This will require parts 11, 12, 13, 14, 15, 21, 22, 23 and 24.

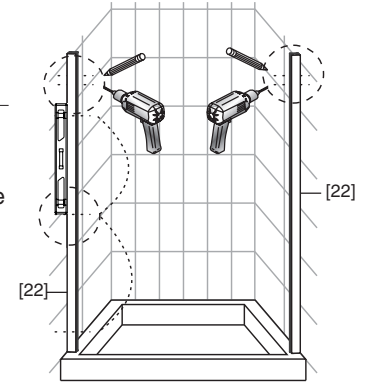

NOTE: The Passage Shower Door can be installed with the fixed door panel on the left or right hand side. The illustrations below show the door assembled with the handle on the right side of the shower. If the door is to be assembled so that the handle is on the left side, the instructions and procedures will need to be reversed in those areas.

1a. Using the fixed wall post as a guide, determine approximate location of connector by measuring 15/16" (23mm) from the edge of the shower base [22]. Orient the wall post facing out. Ensure the fixed wall post is plumb.

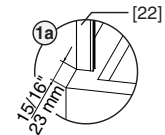

1b. Mark top 2 hole locations in the Fixed Wall Post [22] onto shower wall, then remove post and set aside.

NOTE: The 2 top holes in the Fixed Wall Post [22] are used for marking where to drill holes as a template for Connector Base Mounts [12] on both left and right sides of shower, not for mounting screws.

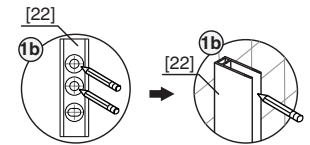

1c. Drill a 1/4" (6mm) pilot hole (if using Wall Anchors [14]) at each of the 2 marked locations.

NOTE: Depending on wall surface material, other forms of attachment or hardware sizes may be necessary.

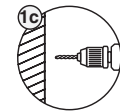

1d.

- Insert Wall Anchors [14] into pilot holes of wall.
- Remove Connector Base Mounts [12] from Wall Connectors [11 a & b]
- Place a clear plastic Cushion [13] between the Base Mount [12] and shower wall, keeping the finished, chrome plated edge of Base Mount [12] facing inside shower. Screw into place using 2 M5x35 Flathead Screws [15].
- Repeat steps 1a-1d for mounting Connector Base Mount on opposite side of shower, keeping the finished chrome plated edge of base facing outside of shower.

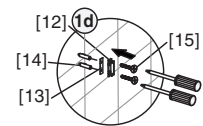

NOTE: Refer to Assembly Drawing on page 3 for part recognition. 11a chrome plated parts face inside the shower and 11b chrome plated parts face out.

1e. Once both Connector Base Mounts [12] are secured to the wall, place Fixed Wall Post [22] on side of shower that will hold the Fixed Glass Panel [31] and mark approximately 3/16" (5mm) from threshold edge of shower base and plumb.

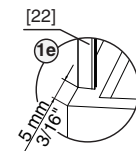

1f. Mark 3 holes along the length not previously used in the Fixed Wall Post [22] pre-drilled with slight oval (Ref. 1b) onto the shower wall.

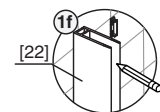

1g. Drill 1/4" (6mm) pilot hole (if using Wall Anchors [14]) at each marked location.

NOTE: Depending on wall surface material, other forms of attachment or hardware sizes may be necessary.

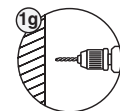

1h. Insert Wall Anchors [14] into pilot holes. Place Fixed Post [22] into position and secure to wall using 3 M4 x 35mm [23] head screws.

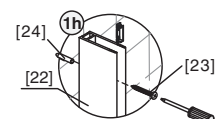

2

In Step 2, we will cover installing the floor U Channel and Bottom Guide.

This will require parts 3, 4, 5, 6, 7, 21, 23, 28, 31 and 32.

- 2a.** Place U Channel [28] and Bottom Guide [6] on the Fixed Wall Post [21] side on the edge of the shower base threshold.

NOTE: The smaller side of the Bottom Guide is meant to hold the Fixed Panel [31] (with the rubber Shim [7]), while the larger side is meant to hold the sliding Door Panel [32] (without rubber Shim [7]).

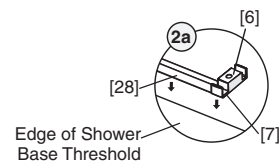

- 2b.** Align U Channel [28] and Bottom Guide [6] with center of Fixed Wall Post [21] keeping the same distance from the showers threshold edge.

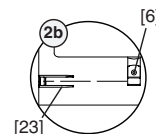

- 2c.** Mark a line on the outside of the U Channel, also marking center mounting hole of Bottom Guide on shower threshold.

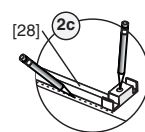

- 2d.** Remove protective paper from adhesive tape on bottom of U Channel [28].

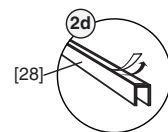

- 2e.** Place U Channel back onto threshold at marked line and press down to hold securely in place.

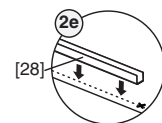

- 2f.** Drill pilot hole for the center mounting hole for the Bottom Guide using 1/4" (6mm) drill bit.

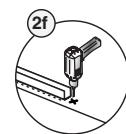

- 2g.** Apply clear silicone sealant to wall anchor, then insert Wall Anchor [4] into pilot hole and fasten Bottom Guide [6] using M4x35 [3] Pan Head Screw.

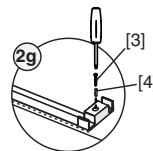

- 2h.** Cover screw hole in Bottom Guide using Screw Cover Cap [5].

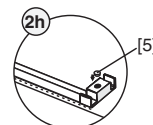

3

In Step 3, we will cover the assembly and installation of the fixed door panel.

This will require parts 6, 7, 17, 21, 22, 23, 24, 27, 28 and 31.



NOTE: Product is heavy and REQUIRES TWO PEOPLE for installation.

3a. Ensure clear Shim [7] is in groove on Bottom Guide [6] for Fixed Panel side.

NOTE: Place a minimum of 2 clear channel shims in bottom of U channel.

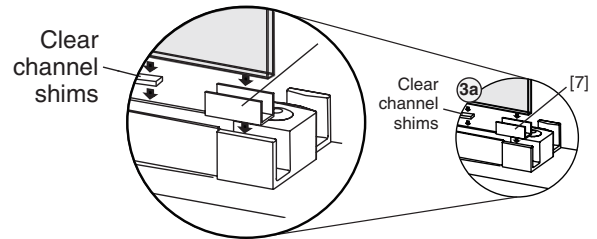

3b. Carefully place Fixed Panel [31] fully into U Channel [28] and Fixed Wall Post [22].

NOTE: Identify the fixed door panel by the 2 holes at the top of the glass panel. Refer to Assembly drawing [31].

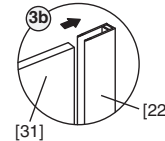

3c. Check that Fixed Panel is fully and securely in place and panel is at far end (close to flush) on groove of Bottom Guide.

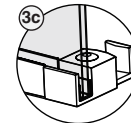

3d. Once panel is leveled and in place, insert Water Deflector [17] on inside shower between Fixed Panel [31] and Fixed Wall Post [22].

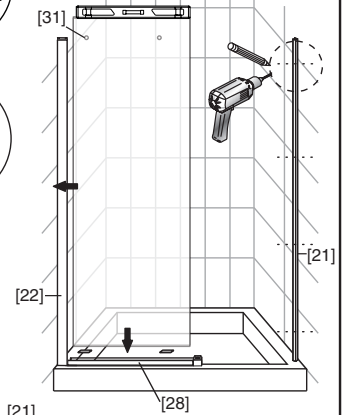
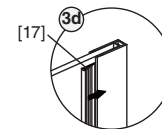

4

In Step 4, we will cover the installation of the sliding door post.

This will require parts 21, 23 and 24.

4a. To install Sliding Wall Post [21] place on opposite side of shower entrance wall and mark approximately 1-5/8" (42mm) from threshold edge of shower base. Remove wall post and set aside.

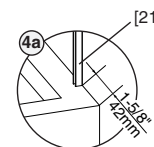

4b. Ensure Sliding Wall Post is plumb, then mark all 4 screw hole locations.

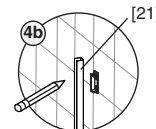

4c. Drill pilot hole at each marked location using a 1/4" (6mm) drill bit (if using Wall Anchors [24]).

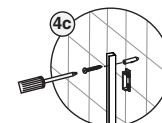

4d. Insert Wall Anchors [24], place Wall Post into position and screw using M4x35 [23].

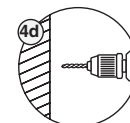

5

In Step 5, we will cover the installation of the horizontal rails and wall connectors.

This will require parts 1, 9, 11a, 12, 31 and 33.

5a. Screw Limit Block [33] to Wall Connector [11a].

NOTE: Wall Connector [11a] has a threaded hole on one side to accommodate the Limit Block.

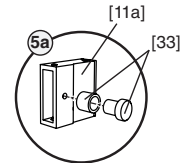

5b. Attach Wall Connector with Limit Block to Connector Base Mount [12] on the Fixed Panel [31] side of shower and tighten 2 allen screws using supplied hex allen key.

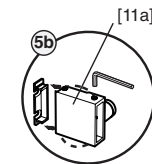

5c.

- Slide second Wall Connector [11b] onto end of Horizontal Rail [1] (opposite 2 threaded holes) keeping chrome plated edge with American Standard logo facing outside shower. Loosely tighten allen screws.
- Insert opposite end of Horizontal Rail [1] (end with 2 threaded holes facing Fixed Panel) into Wall Connector [11a].
- Align threaded holes in Rail with holes in glass of Fixed Panel [31].
- Then slide opposite Wall Connector [11b] onto Connector Base Mount on other side of shower and loosely tighten allen screws of Wall Connector [11b] to hold in place.

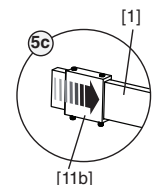

5d. Insert threaded end of Fixed Panel Fastener [9] through glass hole of Fixed Panel [31] from outside of shower, keeping plastic bushing in center of glass. Place other end of Fastener on opposite side of glass Panel and into the threaded end of Fastener, ensuring clear washers contact both sides of glass. Then turn Fixed Panel Fastener into one of the threaded holes of the Horizontal Rail [1]. Repeat for second Fastener and tighten until both Fasteners securely hold onto glass Panel and Horizontal Rail.

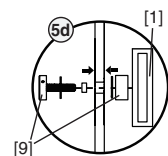

5e. Tighten Fixed Panel Fastener in place using hex allen key as a handle.

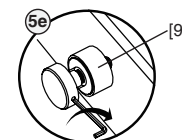

5f. Slide second Wall Connector [11b] onto Connector Base Mount [12] and tighten allen screws to securely hold in place.

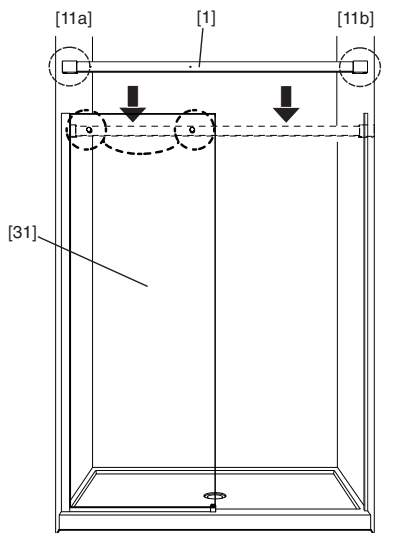
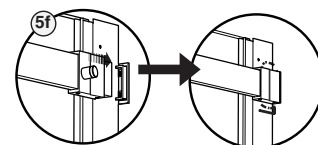

6

In Step 6, we will cover assembling the rollers and sliding glass panel door.

This will require parts 2, 8, 18 and 32.

6a. Separate door handles [2] by removing brass connector with threaded stem from handles. Place the round bushing and clear square gasket over the threaded stem and onto the Sliding Door Panel [32] keeping clear washers between the glass panel. Then place the other handle over brass connector.

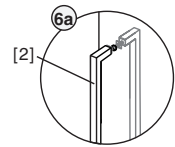

6b. Tighten allen screws to secure Door Handle in place.

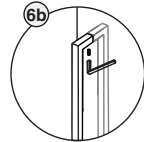

6c. Remove 10mm metal nut and 18mm plastic retainer from Roller [8] and carefully place threaded end into hole of outside facing Sliding Door Panel [32] keeping clear plastic washer between roller and glass panel. From inside shower side of panel, place 18mm plastic retainer into threads of Roller and into hole of glass Panel. Turn to tighten.

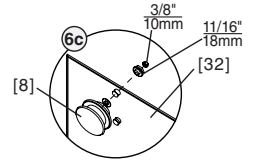

6d. Attach metal nut and tighten using 10mm socket and 18mm open end wrench for plastic retainer. **Repeat steps 6c and 6d on opposite side.**

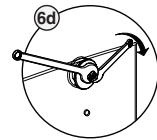

6e. Slide Bottom Door Gasket [18] onto bottom of sliding Door Panel [32] keeping the wider flap to the inside of shower area.

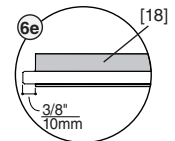

6f. If necessary, cut or trim the Door Gasket material about 3/8" (10mm) off the edge of the sliding Door Panel.

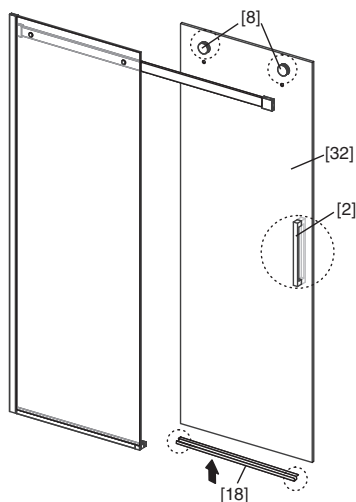
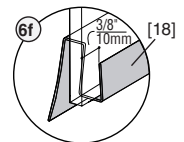



NOTE: Product is heavy and REQUIRES TWO PEOPLE for installation.

- 7a.** Carefully place Sliding Door Panel [32] onto Horizontal Rail [1] from inside of shower area and onto the Rollers [8].

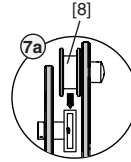

- 7b.** Ensure bottom of Sliding Door Panel [32] onto Horizontal Rail [1] from inside of shower area and onto the Rollers [8].

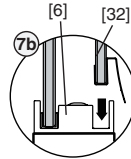

7c.

- Remove threaded cover cap off Door Panel Guard [10] and remove retaining screw inside with Philips head screw driver, separating the 2 parts. **Do not lose plastic spacer between these two parts.**
- With supplied 2 clear plastic washers, place one washer over one end of Panel Guard [10] and one washer over the other end and place through hole of Sliding Door Panel [32] with thicker end facing outside shower. Insert Philips head screw back into place and tighten.

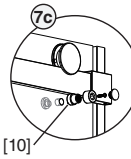

NOTE: If screw does not go back into threads, the 2 pieces are keyed and it may be necessary to turn the parts 180 degrees.

- 7d.** Door Panel Guards [10] can be adjusted so they are as close to the Horizontal Rail [1] as possible to prevent door from juping off the Horizontal Rail. It may be necessary to place hex allen key into one of the holes of the Door Panel Guard [10] to act as a handle or lever while making adjustments to the Door Panel. Place threaded cover cap back onto Door Panel Guard. Repeat for other Door Panel Guard.

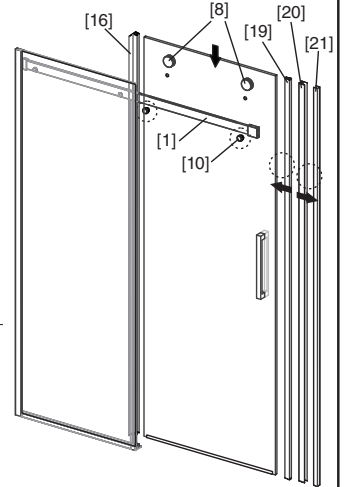
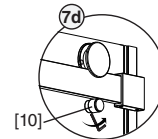

- 7e.** Attach Magnetic Seal [19] onto Door Handle side of Panel and snap into place.

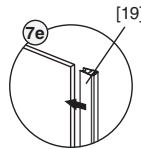

- 7f.** Attach Post [20] with three holes facing inside of the shower over Sliding Wall Post [21] and snap into place.

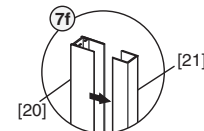

- 7g.** Attach Side Gasket [16] to opposite side of Sliding Door Panel [32] keeping wider side toward outside of shower area.

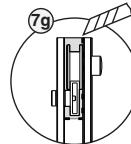

- 7h.** It may be necessary to trim a portion of Side Gasket [16] near the top to accommodate spacing for the Horizontal Rail [1].

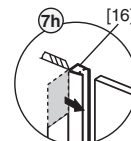

8

In Step 8, we will cover adjusting the Sliding Door Panel [32].

8a. Once all assembly is completed, it may be necessary to adjust the Sliding Door Panel [32] for proper operation. This can be achieved by adjusting Rollers [8] attached to the Sliding Door Panel [32] by loosening the metal nut on the Roller.

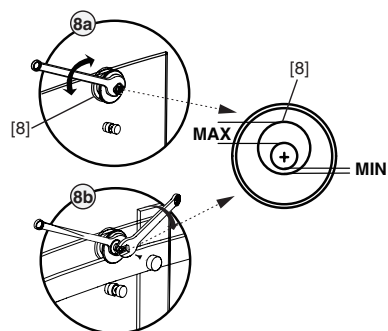

8b. Use a 10mm socket to slightly loosen the metal nut on the Roller and an 18mm open end wrench to turn the plastic retainer, providing an oblong effect when adjusting or turning, causing the door to move up or down at that location. Adjustments can be done to both Rollers to obtain proper door sliding operation and fit.

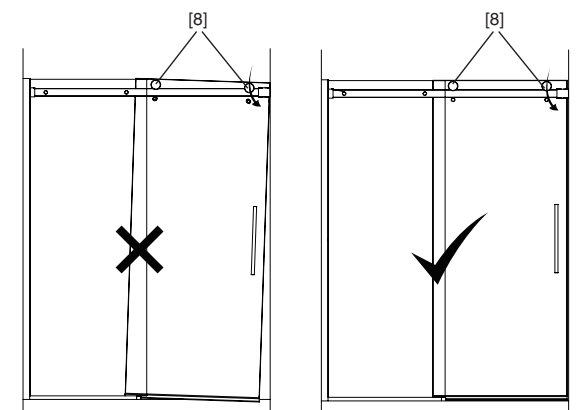

9

In Step 9, we will cover installing the Aluminum Seal [29].

9a. Position the Aluminum Seal [29] at the entrance floor/Sliding Door Panel [32] side of the shower in-line with the Fixed Panel [31]. Apply a bead of adhesive in the groove or underside of the Aluminum Seal and place back at shower entrance keeping the sloping side of the seal pointing inside the shower area.

9b. Two connector [30] ends are supplied to cover any gaps at the 2 ends of the Aluminum Seal which can be placed on the left and right side pointing inside the shower area.

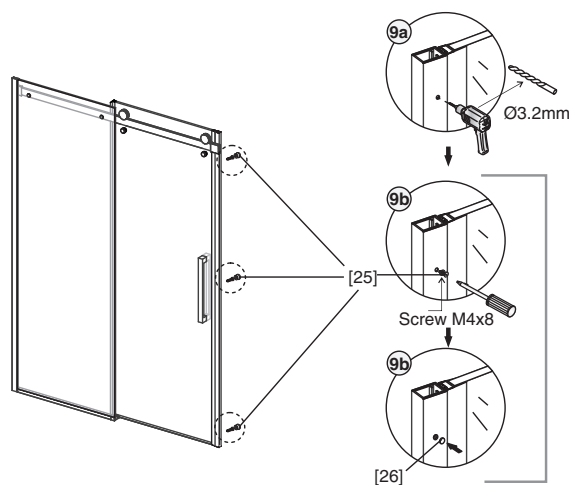

10 In Step 10, we will cover attaching the hardware to the Sliding Wall Post.

This will require parts 20, 21 and 26.

10a. Three hole locations are predrilled into the Post [20] and can be used to mark drill locations in the Sliding Wall Post [21] from the inside of shower. Remove Post and drill marked locations using a 1/8" (3.2mm) drill bit.

10b. Place Post [20] back onto Sliding Wall Post [21] and use 3 supplied M4x8 screws, placing white plastic cups through each screw to hold Screw Cover Caps [26]. Screw and secure Post into place onto the Sliding Wall Post.

10c. Cover each screw head with a Screw Cover Cap [26] to finish.

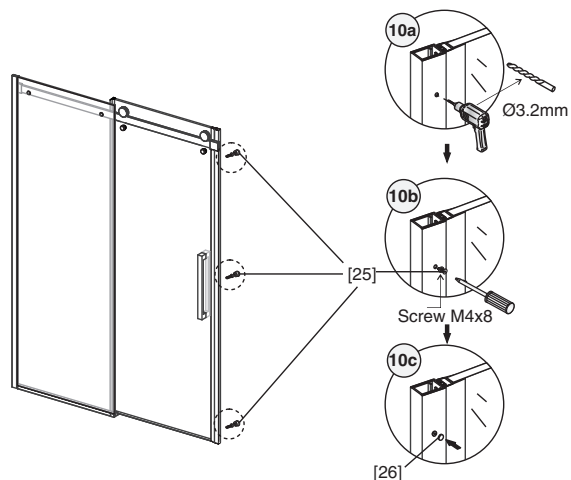

11 In Step 11, we will cover applying silicone to seal your shower doors.

11a. Apply silicone at all inside and outside locations as shown. Allow 24 hours for silicone to dry before use.

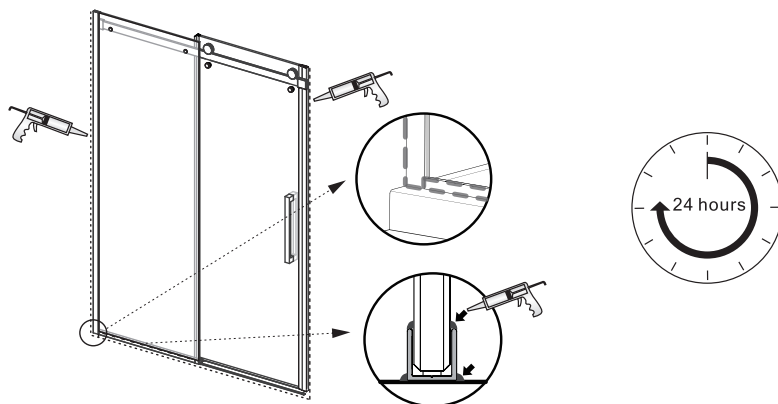

MAINTENANCE:

Two primary materials are used to manufacture your new American Standard shower enclosure: tempered glass and anodized aluminum. To assure a long lasting finish on the enclosure, wipe it down with a towel after each use.

For occasional, more concentrated cleaning efforts **Lysol Non-Abrasive Bathroom Cleaner** works extremely well. Be sure that any over spray falling on the aluminum frame is rinsed thoroughly and dried. Many over-the-counter cleaners, if applied to the aluminum and left on, will harm the metal finish and cause permanent damage even though their directions indicate safe use on shower doors. Never use a scouring agent to clean the aluminum.

AS AMERICA, INC. LIMITED LIFETIME WARRANTY FOR SHOWER DOORS

AS America, Inc. ("American Standard") warrants to the original consumer purchaser that it will, at its sole option, repair or replace this product or any part of this product, if it confirms that the product is defective in materials or workmanship under normal use and maintenance for the lifetime of this product.

This warranty does not apply to commercial installations. Commercial installations shall have a limited warranty of 3 year(s).

This limited warranty DOES NOT COVER the following:

1. Defects or damage arising from shipping, installation, alterations, accidents, abuse, misuse, lack of proper maintenance and use of other than genuine American Standard replacement parts, in all cases whether caused by a plumbing contractor, service company, the owner or any other person.
2. Deterioration through normal wear and tear.
3. HARD WATER DAMAGE, OR DAMAGES RESULTING FROM ABUSE OR MISUSE OR FROM FAILURE TO INSTALL OR MAINTAIN THIS PLUMBING PRODUCT IN ACCORDANCE WITH THE WRITTEN INSTRUCTIONS FURNISHED BY AS AMERICA, INC.
4. USE OF CLEANING PRODUCTS CONTAINING CALCIUM HYPO CHLORITE (CHLORINE), SCOURING POWDERS OR PADS SHALL NOT BE COVERED.
5. THE USE OF SCENTED CANDLES IN CLOSE PROXIMITY WITH THIS PRODUCT CAN RESULT IN PERMANENT STAINING OF THE FINISH.
6. Expense of normal maintenance.
7. All costs of removal, transportation, labor, reinstallation or other costs including postage and/or shipping costs to obtain warranty service shall be paid by the consumer.
8. ANY LIABILITY FOR CONSEQUENTIAL OR INCIDENTAL DAMAGES, ALL OF WHICH ARE HEREBY EXPRESSLY DISCLAIMED. ANY IMPLIED WARRANTIES, INCLUDING THOSE OF MERCHANTABILITY OR FITNESS FOR PURPOSE INTENDED ARE SPECIFICALLY EXCLUDED. (Some jurisdictions do not allow limitations on how long an implied warranty lasts, or the exclusion or limitation of incidental or consequential damages, so these limitations and exclusions may not apply to you.)
9. Responsibility for compliance with local code requirements ARE EXCLUDED FROM THIS WARRANTY. (Since local code requirements vary greatly distributors, dealers, installation contractors and users of plumbing products should determine whether there are any code restrictions on the installation or use of a specific product.)

This limited warranty gives you specific legal rights. You may have other statutory rights that vary from state to state or from province to province, in which case this limited warranty does not affect such statutory rights.

For service under this warranty, it is suggested that a claim be made through the contractor or dealer from or through whom the product was purchased, or that a service request (including a description of the product model and of the defect) be sent to the following with proof of purchase or original receipt:

In the United States:

American Standard Brands
1 Centennial Ave
Piscataway, New Jersey 08854
Attention: Director of Consumer Affairs

For residents of the United States, warranty information may also be obtained by calling the following toll free number: (800) 442-1902
www.americanstandard.com

In Canada:

LIXIL Canada ULC
5900 Avebury Rd.
Mississauga, Ontario
Canada L5R 3M3

Toll Free: (800) 387-0369
www.americanstandard.ca

In Mexico:

American Standard B&K Mexico
S. de R.L. de C.V.
Via Morelos #330
Col. Santa Clara
Ecatepec 55540 Edo. Mexico
Toll Free: 01-800-839-1200
www.americanstandard.com.mx